

NORTH

M.R. LODGE

T.W.D. STEELE

A.J. LODGE
17575-266a

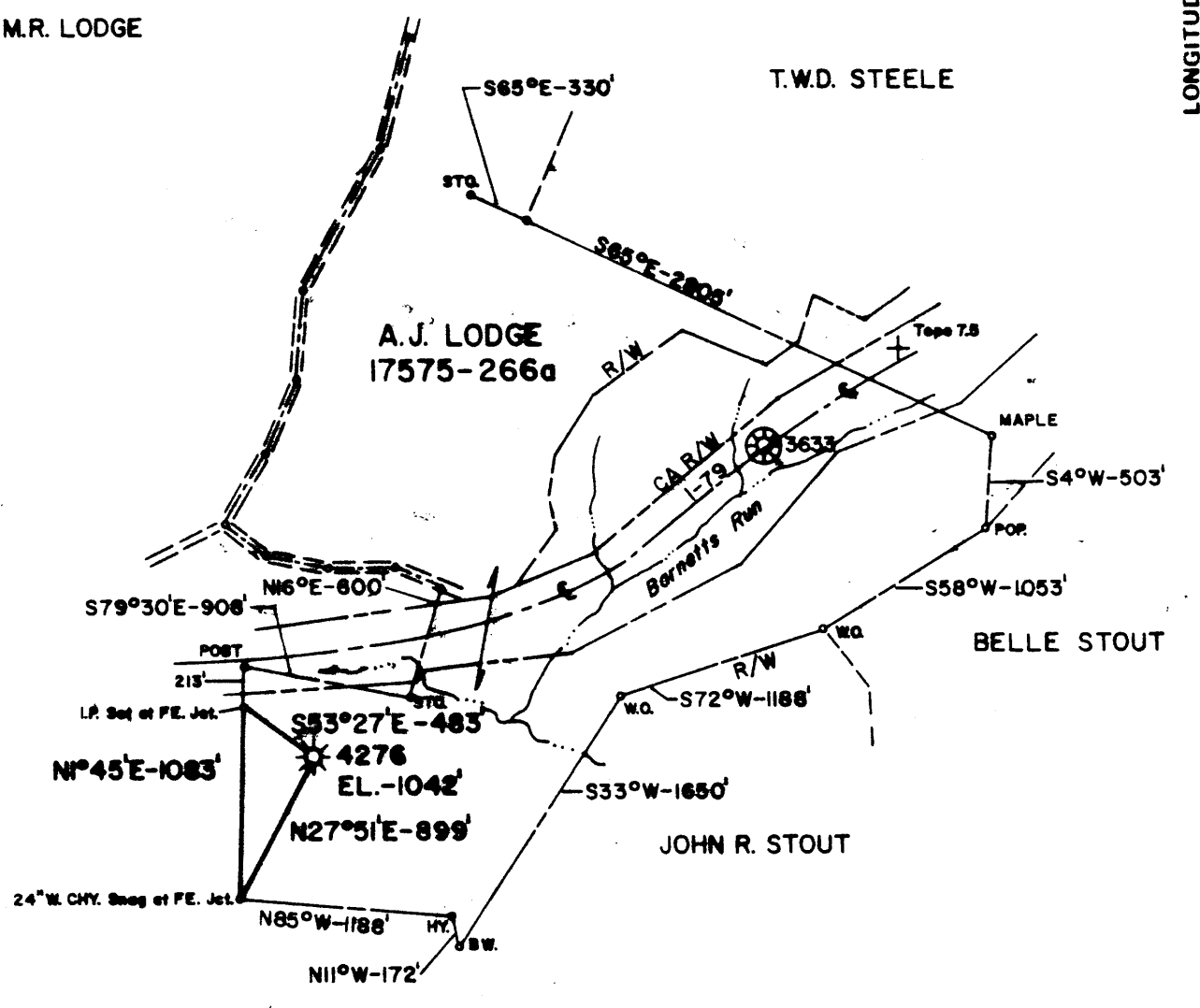

MAP SHEET-QH9134,FF4280200 FB-2209PG.27-28

FILE NO. _____
 DRAWING NO. _____
 SCALE 1" = 1000'
 MINIMUM DEGREE OF ACCURACY 1 in 200'
 PROVEN SOURCE OF ELEVATION BM = Chiseled "I" on Road Culvert, Clarksburg Topo,

I THE UNDERSIGNED, HEREBY CERTIFY THAT THIS PLAT IS CORRECT TO THE BEST OF MY KNOWLEDGE AND BELIEF AND SHOWS ALL THE INFORMATION REQUIRED BY LAW AND THE REGULATIONS ISSUED AND PRESCRIBED BY THE DEPARTMENT OF MINES.
 (SIGNED) Danell M Radcliffe
 R.P.E. _____ L.L.S. 74

PLACE SEAL HERE

STATE OF WEST VIRGINIA
 DEPARTMENT OF MINES
 OIL AND GAS DIVISION



DATE DECEMBER 20, 1984
 OPERATOR'S WELL NO. 4276
 API WELL NO. _____
47 - 033 - 1406-PP-Fr
 STATE COUNTY PERMIT

(+) DENOTES LOCATION OF WELL ON UNITED STATES TOPOGRAPHIC MAPS
 WELL TYPE: OIL ___ GAS X LIQUID INJECTION ___ WASTE DISPOSAL ___
 (IF "GAS,") PRODUCTION ___ STORAGE X DEEP ___ SHALLOW ___
 LOCATION: ELEVATION 1042 WATER SHED BARNETTS RUN
 DISTRICT SIMPSON COUNTY HARRISON
 QUADRANGLE CLARKSBURG 75
 SURFACE OWNER: J.H. LODGE ET AL. ACREAGE 266a
 OIL & GAS ROYALTY OWNER A.J. LODGE NOW MARY H. LODGE, AS LEASE ACREAGE 266a
 LEASE NO. 17575
 PROPOSED WORK: DRILL ___ CONVERT ___ DRILL DEEPER ___ REDRILL ___ FRACTURE OR STIMULATE ___ PLUG OFF OLD FORMATION ___ PERFORATE NEW FORMATION ___ OTHER PHYSICAL CHANGE IN WELL (SPECIFY) _____

PLUG AND ABANDON X CLEAN OUT AND REPLUG ___
 TARGET FORMATION _____ ESTIMATED DEPTH _____
 WELL OPERATOR CON GAS TRANS CORP DESIGNATED AGENT W.A. FOX
 ADDRESS 445 WEST MAIN STREET ADDRESS 445 WEST MAIN STREET
CLARKSBURG, WEST VIRGINIA CLARKSBURG, WEST VIRGINIA

JUL 01 1985

HARR-1406-P

3/1/85

3550'

CODE _____ CARD _____ PLOT _____

LATITUDE 39°20'00"

LONGITUDE 80°15'00"

8690

NORTH

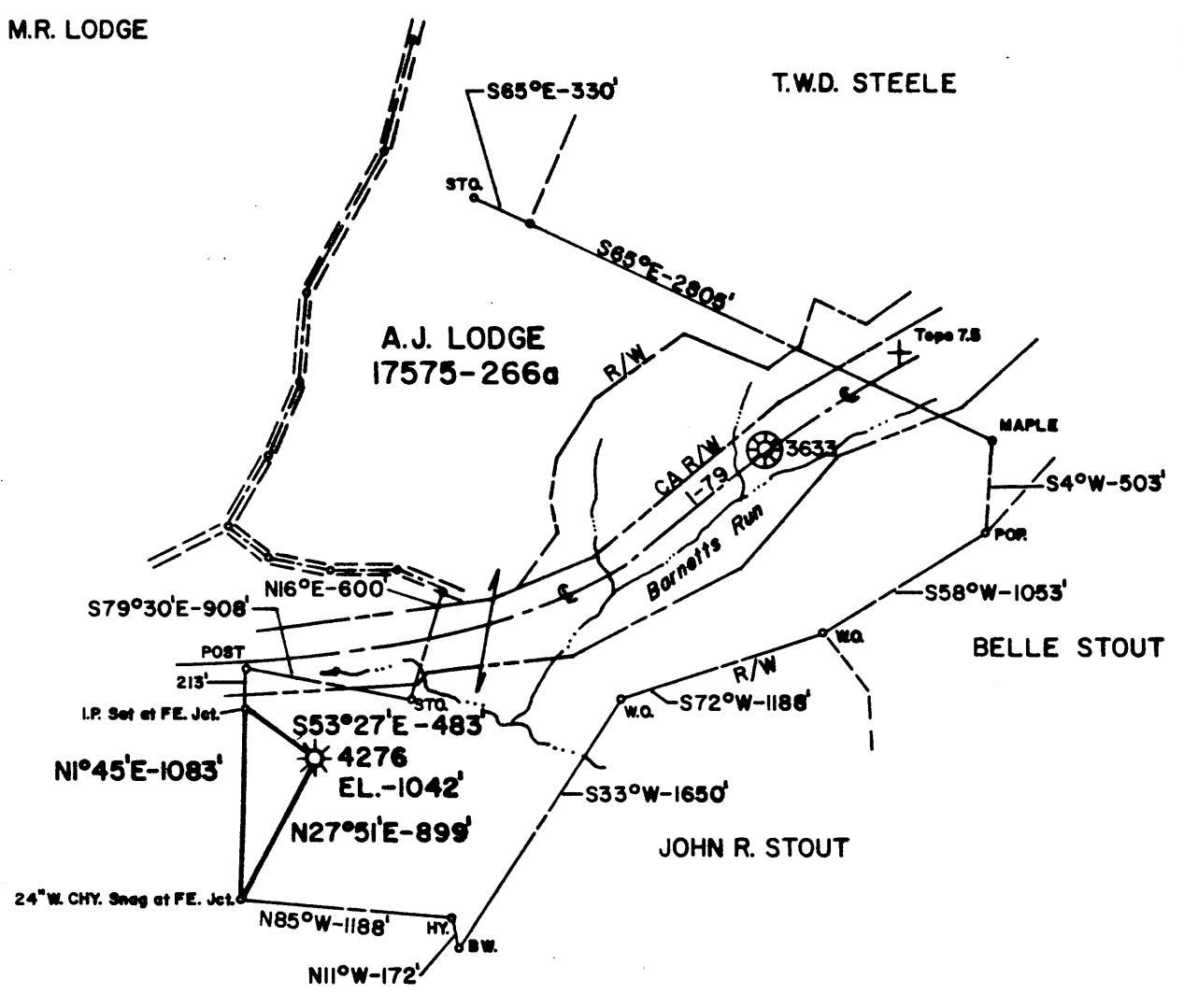

MAP SHEET-Q119134, FF4280200 FB-2209PG.27-28

FILE NO. _____
 DRAWING NO. _____
 SCALE 1" = 1000'
 MINIMUM DEGREE OF ACCURACY 1 in 200'
 PROVEN SOURCE OF ELEVATION BM=Chiseled "□" on Road Culvert, Clarksburg Topo, 75

I THE UNDERSIGNED, HEREBY CERTIFY THAT THIS PLAT IS CORRECT TO THE BEST OF MY KNOWLEDGE AND BELIEF AND SHOWS ALL THE INFORMATION REQUIRED BY LAW AND THE REGULATIONS ISSUED AND PRESCRIBED BY THE DEPARTMENT OF MINES.
 (SIGNED) Danell M. Radcliffe
 R.P.E. _____ L.L.S. 74

PLACE SEAL HERE

STATE OF WEST VIRGINIA
 DEPARTMENT OF MINES
 OIL AND GAS DIVISION



DATE DECEMBER 20, 19 84
 OPERATOR'S WELL NO. 4276
 API WELL NO. _____
47 - 033 - 1406-P
 STATE COUNTY PERMIT

(+) DENOTES LOCATION OF WELL ON UNITED STATES TOPOGRAPHIC MAPS
 WELL TYPE: OIL ___ GAS X LIQUID INJECTION ___ WASTE DISPOSAL ___
 (IF "GAS,") PRODUCTION ___ STORAGE X DEEP ___ SHALLOW ___
 LOCATION: ELEVATION 1042 WATER SHED BARNETTS RUN
 DISTRICT SIMPSON COUNTY HARRISON
 QUADRANGLE CLARKSBURG 75
 SURFACE OWNER J.H. LODGE ET AL. ACREAGE 266a
 OIL & GAS ROYALTY OWNER A.J. LODGE Now MARY H. LODGE, Ad. LEASE ACREAGE 266a
 LEASE NO. 17575
 PROPOSED WORK: DRILL ___ CONVERT ___ DRILL DEEPER ___ REDRILL ___ FRACTURE OR STIMULATE ___ PLUG OFF OLD FORMATION ___ PERFORATE NEW FORMATION ___ OTHER PHYSICAL CHANGE IN WELL (SPECIFY) _____

PLUG AND ABANDON X CLEAN OUT AND REPLUG ___
 TARGET FORMATION _____ ESTIMATED DEPTH _____
 WELL OPERATOR CON. GAS TRANS CORP. DESIGNATED AGENT W.A. FOX
 ADDRESS 445 WEST MAIN STREET ADDRESS 445 WEST MAIN STREET
 CLARKSBURG WEST VIRGINIA CLARKSBURG WEST VIRGINIA

LATITUDE

39° 20' 00"

00, 51 08

LONGITUDE

1.635
0.67W

7.5 OGIS topo location

7.5' loc 15' loc 1.635
(calc.) 0.67W

Company CNG 4276

Farm A. J. Lodge

Elev. 1130' top est.
1042' ground

Quad Clarkburg/Clark SE

County Harrold

District Simpson

WELL LOCATION MAP

File No. 033-1406

FILE COPY
RECEIVED
APR 1 1985



1) Date: January 22, 19 85
 2) Operator's Well No. 4276
 3) API Well No. 47 033 1406 Frac
 State County Permit

STATE OF WEST VIRGINIA
 DEPARTMENT OF MINES, OIL AND GAS DIVISION
 OIL & GAS DIVISION
 DEPT. OF MINES
 APPLICATION FOR A WELL WORK PERMIT

- 4) WELL TYPE: A Oil / Gas /
 B (If "Gas", Production / Underground storage / Deep / Shallow)
 5) LOCATION: Elevation: 1042' Watershed: Barnetts Run
 District: Simpson 8 County: Harrison Quadrangle: Clarksburg 297
 6) WELL OPERATOR Consolidated Gas Transmission Corp. 10900 7) DESIGNATED AGENT W. A. Fox
 Address 445 West Main Street Address 445 West Main Street
Clarksburg, West Virginia Clarksburg, West Virginia
 8) OIL & GAS INSPECTOR TO BE NOTIFIED 9) DRILLING CONTRACTOR:
 Name Stephen Casey Name I. L. Morris
 Address Rt. 2, Box 232-D Address Glenville, WV
Jane Lew, WV 26378
 10) PROPOSED WELL WORK: Drill / Drill deeper / Redrill / Stimulate /
 Plug off old formation / Perforate new formation /
 Other physical change in well (specify) See attachment no attachment avail.
 11) GEOLOGICAL TARGET FORMATION, See attachment
 12) Estimated depth of completed well, See attachment feet
 13) Approximate strata depths: Fresh, None feet; salt, feet.
 14) Approximate coal seam depths: None Is coal being mined in the area? Yes / No /

15) CASING AND TUBING PROGRAM

CASING OR TUBING TYPE	SPECIFICATIONS					FOOTAGE INTERVALS		CEMENT FILL-UP OR SACKS (Cubic feet)	PACKERS
	Size	Grade	Weight per ft.	New	Used	For drilling	Left in well		
Conductor									Kinds
Fresh water									
Coal	<u>6 5/8</u>						<u>1358</u>		Sizes
Intermediate									
Production	<u>4 1/2</u>	<u>K-55</u>	<u>10.5</u>	<u>X</u>		<u>See attachment</u>			Depths set
Tubing									
Liners									Perforations: Top Bottom
									Unknown at this time.

OFFICE USE ONLY
 DRILLING PERMIT

Permit number 47-033-1406 Frac Date June 21 19 85

This permit covering the well operator and well location shown below is evidence of permission granted to drill in accordance with the pertinent legal requirements subject to the conditions contained herein and on the reverse hereof. Notification must be given to the District Oil and Gas Inspector, (Refer to No. 8) Prior to the construction of roads, locations and pits for any permitted work. In addition, the well operator or his contractor shall notify the proper district oil and gas inspector 24 hours before actual permitted work has commenced.)

The permitted work is as described in the Notice and Application, plat, and reclamation plan, subject to any modifications and conditions specified on the reverse hereof.

Permit expires June 21, 1987 unless well work is commenced prior to that date and prosecuted with due diligence.

Bond: <u>45</u>	Agent: <u>SW</u>	Plat: <u>MW</u>	Casing <u>MW</u>	Fee <u>285</u>
--------------------	---------------------	--------------------	---------------------	-------------------

Margaret J. Nasse
 Administrator, Office of Oil and Gas

NOTE: Keep one copy of this permit posted at the drilling location.

See the reverse side of the APPLICANT'S COPY for instructions to the well operator.

File

