

9

LATITUDE

39° 25' 00"

100, 08.08

LONGITUDE

2.42S

0.16W

7.5 OGIS topo location

7.5' loc	<u>✓</u>	15' loc	<u>2.42S</u>
		(calc.)	<u>0.16W</u>

Company Pennzoil 2

Farm Jesse Grant

Elev. 1295 topog. cont.

Quad Folsom / Cynth. EC

County Harrison

District Sardin

WELL LOCATION MAP

File No. 033-1834

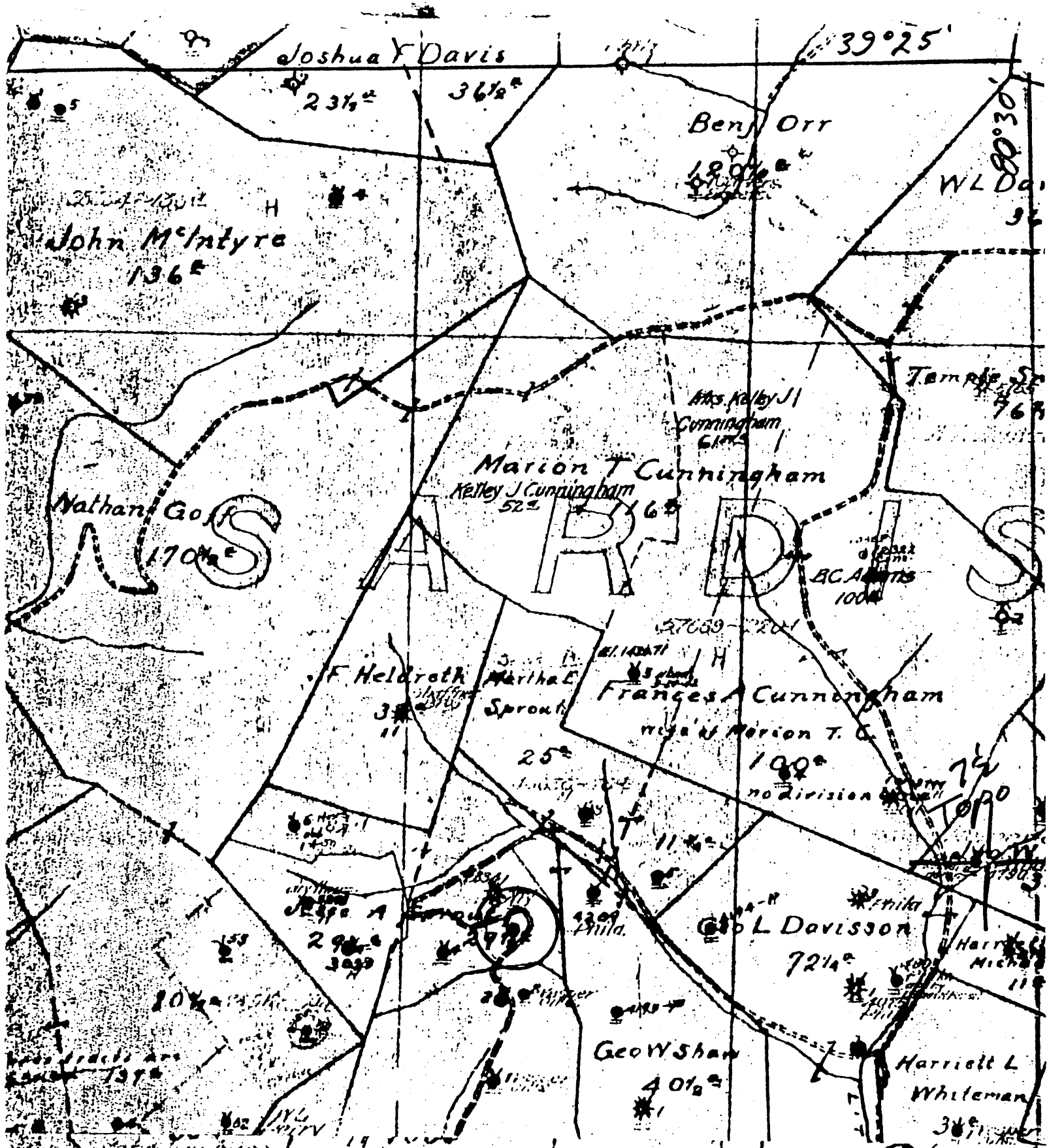

(+) DENOTES LOCATION OF WELL ON UNITED STATES TOPOGRAPHIC MAPS

FORM IV-6  
(8-78)  
N39 S5 E7



STATE OF WEST VIRGINIA  
DEPARTMENT OF MINES  
OIL AND GAS DIVISION

DATE 1-26, 1979  
OPERATOR'S WELL NO. 2  
API WELL NO. 47-033-1834  
STATE COUNTY PERMIT

WELL TYPE: OIL  GAS \_\_\_\_\_ LIQUID INJECTION \_\_\_\_\_ WASTE DISPOSAL \_\_\_\_\_  
( IF "GAS", PRODUCTION \_\_\_\_\_ STORAGE \_\_\_\_\_ DEEP \_\_\_\_\_ SHALLOW  )  
LOCATION: ELEVATION \_\_\_\_\_ WATER SHED Little Rock Camp Rus  
DISTRICT Sardis COUNTY Harrison  
QUADRANGLE Folsom 7 1/2

SURFACE OWNER \_\_\_\_\_ ACREAGE \_\_\_\_\_  
OIL & GAS ROYALTY OWNER \_\_\_\_\_ LEASE ACREAGE \_\_\_\_\_  
LEASE NO. \_\_\_\_\_

PROPOSED WORK: DRILL \_\_\_\_\_ CONVERT \_\_\_\_\_ DRILL DEEPER \_\_\_\_\_ REDRILL \_\_\_\_\_ FRACTURE OR STIMULATE \_\_\_\_\_ PLUS OFF OLD FORMATION \_\_\_\_\_ PERFORATE NEW FORMATION \_\_\_\_\_ OTHER PHYSICAL CHANGE IN WELL (SPECIFY) \_\_\_\_\_

PLUG AND ABANDON \_\_\_\_\_ CLEAN OUT AND REPLUG \_\_\_\_\_  
TARGET FORMATION \_\_\_\_\_ ESTIMATED DEPTH \_\_\_\_\_

WELL OPERATOR Pennzoil Company DESIGNATED AGENT James A. Crews  
ADDRESS P. O. Box 1588 ADDRESS P. O. Box 1588  
Parkersburg, WV 26101 Parkersburg, WV 26101

Well No. 2 *Yessie A Sprout* Farm.  
 Lease No. *Sarant* District *Harrison* County.  
 Rig built by *D P O Co*  
 Well drilled by *D P O Co* Contractor.  
 Began drilling *March 26 1913* Completed *June 4 1913*

ROCK FORMATION	TOP	BOTTOM	REMARKS
Pittsburg Coal	985	992	
Little Limestone	1330	1430	
Rig "	1500	1580	
Side sand	1585	1663	
Salt "	1860	1920	
Water	1910		
Maxon sand	2060	2120	
Water	2100		
Little Limestone	2130	2230	
Rig "	2230	2281	
Rig Limestone	2281	2431	
Side	2291	2306	
Sandy sand	2830	2840	
Gravel foot	2860	2884	
Shelly "	2454	2983	
Stray	2997	3068	
London	3074		
Oil	3086	3090	
Total depth		3090	

*Shot 5-11 39-40 gals @ 300 ft. - Pumped 1800 ft from bottom*

**CASING RECORD**

Size	CHARGED TO WELL		PUT IN WELL		PULLED OUT		LEFT IN WELL		Transferred before Completion		Left at Well Not in Use	
	Feet	In.	Feet	In.	Feet	In.	Feet	In.	Feet	In.	Feet	In.
10			199									
8 3/4			1320		303							
6 3/8			1925									
5 1/2			2864									

Production 1  
 First 24 Hours  
 Bbls. Signed *F. J. Crocker* Sept