

WW-7
8-30-06



West Virginia Department of Environmental Protection
Office of Oil and Gas

WELL LOCATION FORM: GPS

API: 47-033-01930 WELL NO.: 1 (KE O6)

FARM NAME: Robinson, I

RESPONSIBLE PARTY NAME: XTO Energy, Inc.

COUNTY: Harrison DISTRICT: Eagle - 04

QUADRANGLE: Wallace - 655

SURFACE OWNER: Kimberly Ann Stevens

ROYALTY OWNER: WV Wesleyan College, Richard C Brook Trust, Delbert Gail Robinson, Jim C. Hamer Company

UTM GPS NORTHING: 4366116.6

UTM GPS EASTING: 552320.7 GPS ELEVATION: 319 m (1045')

The Responsible Party named above has chosen to submit GPS coordinates in lieu of preparing a new well location plat for a plugging permit or assigned API number on the above well. The Office of Oil and Gas will not accept GPS coordinates that do not meet the following requirements:

1. Datum: NAD 1983, Zone: 17 North, Coordinate Units: meters, Altitude: height above mean sea level (MSL) – meters.
2. Accuracy to Datum – 3.05 meters
3. Data Collection Method:

Survey grade GPS _____: Post Processed Differential _____

Real-Time Differential _____

Mapping Grade GPS : Post Processed Differential

Real-Time Differential _____

4. **Letter size copy of the topography map showing the well location.**

I the undersigned, hereby certify this data is correct to the best of my knowledge and belief and shows all the information required by law and the regulations issued and prescribed by the Office of Oil and Gas.

Signature

Project Manager
Title

July 5, 2016
Date
Office of Oil and Gas
Department of Environmental Protection

RECEIVED
Office of Oil and Gas
JUL 22 2016

08/26/2016

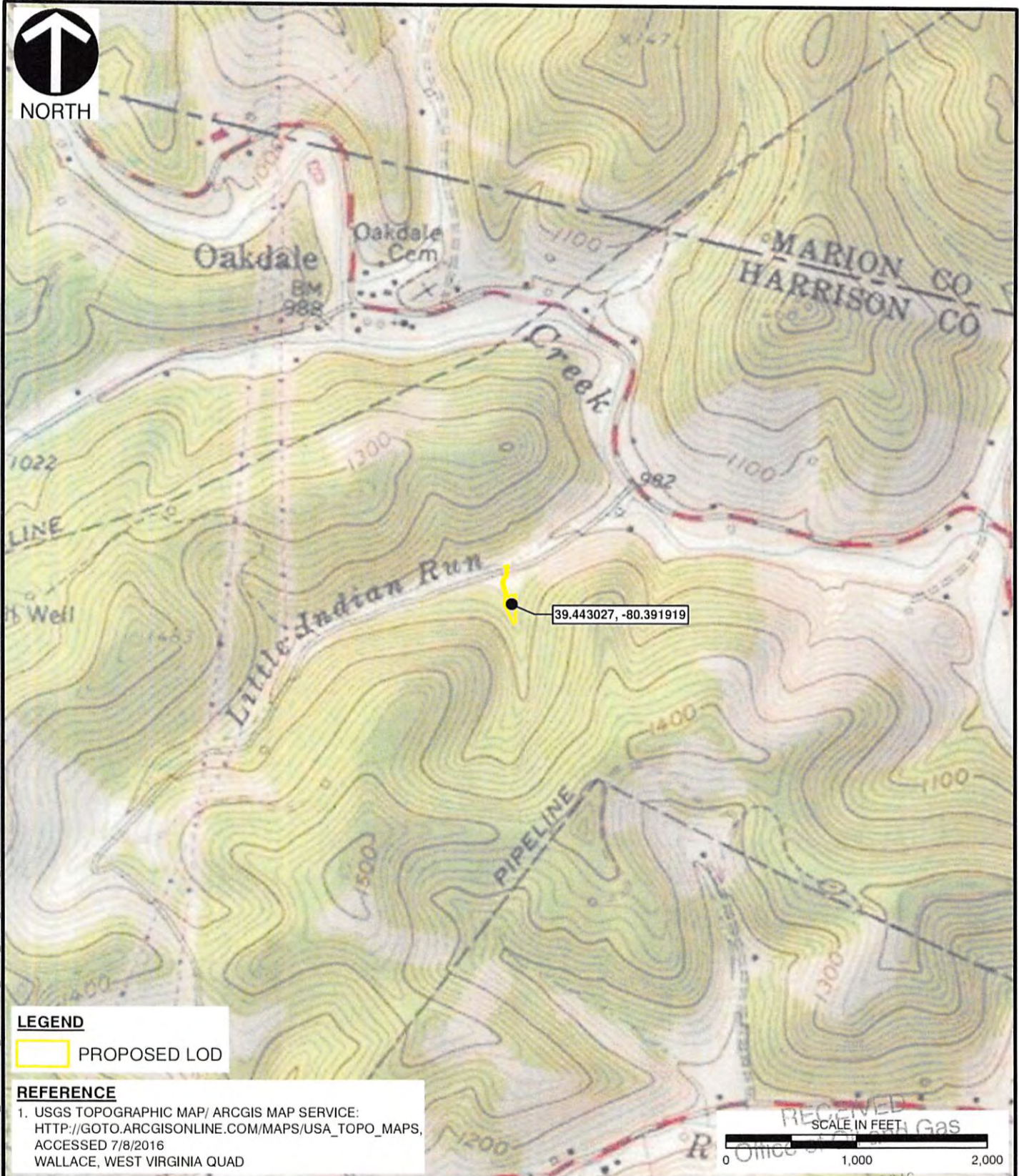

LEGEND
 PROPOSED LOD

REFERENCE
 1. USGS TOPOGRAPHIC MAP/ ARCGIS MAP SERVICE:
[HTTP://GOTO.ARCGISONLINE.COM/MAPS/USA_TOPO_MAPS](http://gto.arcgis.com/maps/usa_topo_maps),
 ACCESSED 7/8/2016
 WALLACE, WEST VIRGINIA QUAD

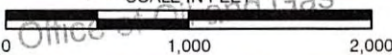
RECEIVED
 SCALE IN FEET

 0 1,000 2,000

I:\svr-bridgeport\161-210-GIS\Maps\Task_0001\NWP_3161210_0001_FIG1_NWP3_SITE.mxd - 7/8/2016 - 8:15:13 AM (ghuckuck)



Civil & Environmental Consultants, Inc.
 600 Marketplace Avenue, Suite 200 - Bridgeport, WV 26330-9121
 Ph: 304-933-3119 • Toll: 855-488-9539 • Fax: 304-933-3327
www.cecinc.com

XTO ENERGY, INC.
 ROBINSON I,1 WELL PLUGGING
 HARRISON COUNTY, WEST VIRGINIA
 WV Department of Environmental Protection

USGS SITE LOCATION MAP

| | | | |
|------------------|--------------------|--------------------------|--------------|
| DRAWN BY: GSK | CHECKED BY: JDK | APPROVED BY: SAC | FIGURE NO: 1 |
| DATE: 07/08/2016 | SCALE: 1" = 1,000' | PROJECT NO: 161-210.0001 | 08/26/2016 |