

MAXWELL LEASE WELL NO. 3HM

LONGITUDE 80°20'00"

9,315'

3HM WELL TIES		
LINE	BEARING	DISTANCE
L1	N 02°08'46" W	4232.05'
L2	N 14°45'23" E	2524.34'
L3	N 20°00'00" W	5290.00'
L4	S 64°40'28" W	331.53'



WELL NO. 3HM TOP HOLE	
STATE PLANE COORDINATES (NORTH ZONE NAD '27)	
N. 265,036	E. 1,754,372
TOP HOLE (NAD 27)	
LAT=(N) 39°13'29.9"	LONG=(W) 80°22'01.3"
TOP HOLE (NAD 83)	
LAT=(N) 39°13'28.3"	LONG=(W) 80°22'00.6"
TOP HOLE UTM (NAD 83)	
(N) 4,341,883	(E) 554,653
WELL NO. 3HM LANDING POINT	
STATE PLANE COORDINATES (NORTH ZONE NAD '27)	
N. 265,236	E. 1,753,210
LANDING POINT (NAD 27)	
LAT=(N) 39°13'29.8"	LONG=(W) 80°22'16.1"
LANDING POINT (NAD 83)	
LAT=(N) 39°13'30.1"	LONG=(W) 80°22'15.4"
LANDING POINT UTM (NAD 83)	
(N) 4,341,938	(E) 554,298
WELL NO. 3HM BOTTOM HOLE	
STATE PLANE COORDINATES (NORTH ZONE NAD '27)	
N. 270,207	E. 1,751,400
BOTTOM HOLE (NAD 27)	
LAT=(N) 39°14'18.8"	LONG=(W) 80°22'39.7"
BOTTOM HOLE (NAD 83)	
LAT=(N) 39°14'19.1"	LONG=(W) 80°22'39.0"
BOTTOM HOLE UTM (NAD 83)	
(N) 4,343,443	(E) 553,722

REFERENCES



NOTES ON SURVEY

1. TIES TO WELLS, REFERENCES, AND CORNERS ARE BASED ON GRID NORTH FOR THE WV STATE PLANE COORDINATE SYSTEM NORTH ZONE NAD '27.
2. LEASE BOUNDARY SHOWN HEREON TAKEN FROM DEED BOOK 142 PAGE 484 AND ADJOINING DEEDS.
3. SURFACE OWNER AND ADJOINER INFORMATION TAKEN FROM THE ASSESSOR AND COUNTY CLERK RECORDS OF HARRISON COUNTY IN JULY, 2012.
4. WELL LAT./LONG. (NAD'27) ESTABLISHED BY DGPS(SURVEY GRADE).

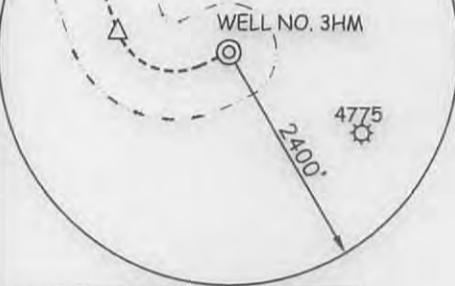

I THE UNDERSIGNED, HEREBY CERTIFY THAT THIS PLAT IS CORRECT TO THE BEST OF MY KNOWLEDGE AND BELIEF AND SHOWS ALL THE INFORMATION REQUIRED BY LAW AND THE REGULATIONS ISSUED AND PRESCRIBED BY THE DIVISION OF ENVIRONMENTAL PROTECTION.

P.S. 677 *Gregory A. Smith*



(+) DENOTES LOCATION OF WELL ON UNITED STATES TOPOGRAPHIC MAPS.
 DATE APRIL 3, 20 13
 REVISED DATE SEPTEMBER 3, 20 13
 OPERATORS WELL NO. MAXWELL 3HM
 API WELL NO. 47 - 33 - MOD 05741 H6A
 STATE COUNTY PERMIT

MINIMUM DEGREE OF ACCURACY 1 / 200 FILE NO. 7995P3HMR3(448-13)
 PROVEN SOURCE OF ELEVATION DGPS (SUBMETER MAPPING GRADE) SCALE 1" = 2,000'

STATE OF WEST VIRGINIA
 DIVISION OF ENVIRONMENTAL PROTECTION
 OFFICE OF OIL AND GAS

WELL TYPE: OIL GAS LIQUID INJECTION WASTE DISPOSAL IF "GAS" PRODUCTION STORAGE DEEP SHALLOW

LOCATION: ELEVATION 1,462' WATERSHED WEST FORK RIVER
 DISTRICT UNION COUNTY HARRISON QUADRANGLE MOUNT CLARE 7.5'

SURFACE OWNER LYNCH FARM, LLC ACREAGE 37.5±
 ROYALTY OWNER WBM PROPERTIES LLC, ET AL ACREAGE 748, 42, 44.21, 73.75, 97.5, & 132±

PROPOSED WORK: DRILL CONVERT DRILL DEEPER REDRILL FRACTURE OR STIMULATE PLUG OFF OLD FORMATION PERFORATE NEW FORMATION PLUG AND ABANDON CLEAN OUT AND REPLUG OTHER

PHYSICAL CHANGE IN WELL (SPECIFY) TARGET FORMATION MARCELLUS
 ESTIMATED DEPTH 7,590' TVD / TMD 13,695'

WELL OPERATOR PDC MOUNTAINEER, LLC DESIGNATED AGENT JAMIE HAGA
 ADDRESS 120 GENESIS BOULEVARD BRIDGEPORT, WV 26330 ADDRESS 120 GENESIS BOULEVARD BRIDGEPORT, WV 26330

11/08/2013

COUNTY NAME PERMIT

MAXWELL LEASE WELL NO.'S 1HM - 6HM

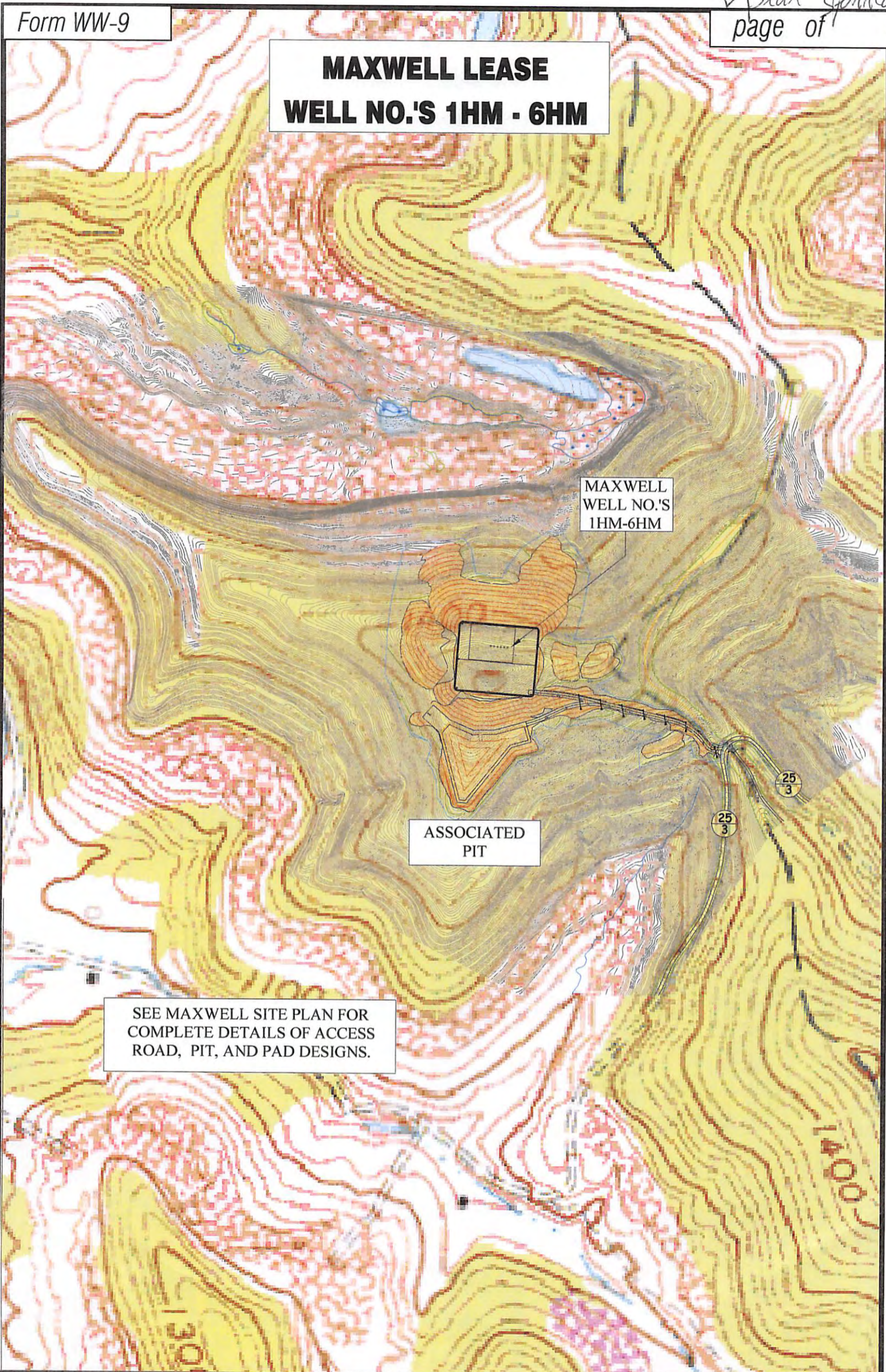

MAXWELL
WELL NO.'S
1HM-6HM

ASSOCIATED
PIT

SEE MAXWELL SITE PLAN FOR
COMPLETE DETAILS OF ACCESS
ROAD, PIT, AND PAD DESIGNS.

Professional Energy Consultants
A DIVISION OF SMITH LAND SURVEYING

SURVEYORS PROJECT MGMT. **SLS** ENGINEERS ENVIRONMENTAL

226 West Main St
P.O. Box 150
Glennville, WV 26031
(815) 482-5831

56665 Diller Bottom Road
Shelbyville, OH 43087
(740) 671-9911

HONESTY. INTEGRITY. QUALITY

TOPO SECTION OF USGS
MOUNT CLARE 7.5' QUADRANGLE



DRAWN BY C.P.M.	FILE NO. 7995	DATE 03-28-13	CADD FILE: 7995REC.DWG
--------------------	------------------	------------------	---------------------------