

Antero Resources
Well No. Lee Unit 1H
Antero Resources
Corporation

(⊙) Denotes location
of well on
United States
topographic maps

I, the undersigned, hereby certify that this plat is correct to the best of my knowledge and belief and shows all the information required by law and the rules issued and prescribed by the Department of Environmental Protection.

Kenneth J. Plum
Kenneth J. Plum, P.S. 2216

Tax Map 321 Parcels

Par	Owner	DB/Pg	Acres
1	26	Christine R. Utter	1314/417 19.75
2	37	Hubert Jr. & Lorena Bland	1307/1209 28.50
3	34	Tillman Lee Williams	1322/1056 5.40
4	22.1	Earl Dixon	1062/878 3.17
5	35	Tillman Lee Williams	1322/1054 9.35
6	25	Tillman Lee Williams	1322/1054 8.17
7	25.1	Fannie Mae	1457/140 4.45
8	28.2	Loren Brad Strother	1296/353 1.39
9	28.3	Nancy E. Farr	1362/580 1.99
10	28	John & Marianne Clevenger	1409/419 13.15
11	28.4	Nancy E. Farr	1439/36 0.18
12	18.3	Sharon D. Emerson	1424/1174 1.03
13	27	City of Salem	642/123 1.50
14	28.1	Patricia A. Collins	1060/1140 1.46
15	37.1	Roberta G. Zwiebel	F104/780 0.98
16	38	Robert & Shirley Bowen	941/478 0.78
17	38.1	John & Marianne Clevenger	1247/289 4.17
18	14	Arthur & Linda Lunsford	1004/1150 1.20
19	24	Gary & Janette Alderman	1421/1212 0.78

Well Location References

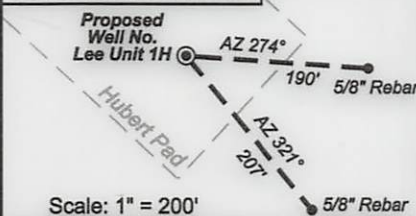

Line	Bearing	Distance
L1	S 57°57' W	1653.1'
L2	S 72°23' E	2304.9'
L3	S 25°47' E	1301.8'
L4	S 18°06' E	1762.3'
L5	S 06°17' E	1133.3'

Note: It appears 14 water wells were found within 2000' of proposed well. No occupied dwellings or buildings 2,500 square feet or larger used to house or shelter dairy cattle or poultry husbandry are located within 625' of the center of the well pad.

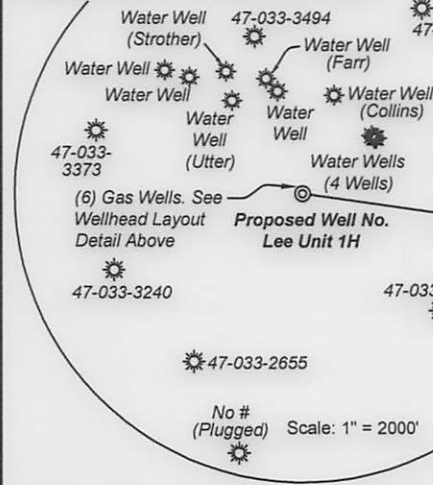

Legend

- ⊙ Proposed gas well
- ⊙ Found corner, as noted
- Surface boundary (approx.)
- Existing Road
- Interior surface tracts (approx.)
- Creek or Drain
- Existing Fenceline

Notes:
West Virginia Coordinate System of 1927, North Zone based upon Differential GPS Measurements.
 Well No. Lee Unit 1H Top Hole coordinates are
 N: 276,137.30 Latitude: 39°15'11.87"
 E: 1,699,774.19 Longitude: 80°33'36.69"
 Bottom Hole coordinates are
 N: 284,647.68 Latitude: 39°16'35.50"
 E: 1,695,669.31 Longitude: 80°34'30.17"
UTM Zone 17, NAD 1983
 Top Hole Coordinates: Bottom Hole Coordinates:
 N: 4,344,987.760m N: 4,347,559.615m
 E: 537,963.211m E: 536,669.448m
 Plat orientation and corner and well references are based upon the grid north meridian.
 Well location references are based upon the magnetic meridian.



FILE NO: 10-30-G-13
 DRAWING NO: 10-13 Lee 1H Well
 SCALE: 1" = 1200'
 MINIMUM DEGREE OF ACCURACY:
 Submeter
 PROVEN SOURCE OF ELEVATION:
 WVDOT, Bridgeport, WV

STATE OF WEST VIRGINIA
 DEPARTMENT OF ENVIRONMENTAL PROTECTION
OFFICE OF OIL AND GAS

DATE: July 29 2013
 OPERATOR'S WELL NO. Lee Unit 1H
 API WELL NO: H6A
 47 - 033 - 05788
 STATE COUNTY PERMIT

WELL TYPE: OIL GAS LIQUID INJECTION WASTE DISPOSAL
 (IF GAS) PRODUCTION: STORAGE DEEP SHALLOW
 LOCATION: ELEVATION: 1376' WATERSHED: Patterson Fork QUADRANGLE: Salem
 DISTRICT: Tenmile COUNTY: Harrison
 SURFACE OWNER: Hubert Jr. & Lorena Bland J. Moses Raad, et al ACREAGE: 28.5 234.342
 ROYALTY OWNER: DEPI, et al; Victor G. Taylor; Valma L. Arters, et vir; Jacob Ford LEASE NO: DV019191; 21030; 21620 ACREAGE: 283; 55.5; 55; 447
 PROPOSED WORK: DRILL CONVERT DRILL DEEPER FRACTURE OR STIMULATE PLUG OFF OLD FORMATION
 PERFORATE NEW FORMATION OTHER PHYSICAL CHANGE IN WELL (SPECIFY) TVD 7,600'
 PLUG AND ABANDON CLEAN OUT AND REPLUG TARGET FORMATION: Marcellus Shale ESTIMATED DEPTH: MD 17,900'

WELL OPERATOR: Antero Resources Corporation DESIGNATED AGENT: Dianna Stamper - CT Corporation System
 ADDRESS: 1625 17th Street ADDRESS: 5400 D Big Tyler Road
 Denver, CO 80202 Charleston, WV 25313

CANCELLED
 02/05/2016



west virginia department of environmental protection

Office of Oil and Gas
601 57th Street SE
Charleston, WV 25304
(304) 926-0450
(304) 926-0452 fax

Earl Ray Tomblin, Governor
Randy C. Huffman, Cabinet Secretary
www.dep.wv.gov

January 22, 2016

FINAL INSPECTION REPORT

Well Permit Cancelled

ANTERO RESOURCES CORPORATION,

The FINAL INSPECTION REPORT for the CANCELLED permit, API Well Number: 47-3305788, issued to ANTERO RESOURCES CORPORATION, and listed below has been received in this office. The permit has been cancelled as of 1/21/2016.

James Martin
Chief

Operator: ANTERO RESOURCES CORPORATION
Operator's Well No: LEE UNIT 1H
Farm Name: BLAND, HUBERT JR. & LORENA
API Well Number: 47-3305788
Date Issued: 10/09/2013

Date Cancelled: 01/21/2016

Promoting a healthy environment.

02/05/2016

INSPECTORS PERMIT SUMMARY FORM

GPS YES [] NO []

DATE STARTED/LOCATION: _____ OPERATOR: ANTERO RESOURCES CORPORATI
 DRILLING COMMENCED: _____ FARM: BLAND, HUBERT JR. & LORENA BI
 TO DATE: _____ DEPTHS: _____ Well No: LEE UNIT 1H
 WATER DEPTHS: _____ COAL DEPTHS _____

QUESTIONS FOR THIS REPORT ARE IN ACCORDANCE OF WV CODE 22-6-30 AND REGULATIONS 35CSR 4-12.1 AND 35CSR 4-16 AND THE GENERAL WATER POLLUTION CONTROL PERMIT.

POINTS ARE TO BE GIVEN UP TO MAXIMUM AS SHOWN BASED ON PERFORMANCE.

1. DID OPERATOR GIVE PROPER NOTICE TO INSPECTOR BEFORE THE FOLLOWING:
 - A. CONSTRUCTION YES [] NO [] (2_PTS) (4_PTS) _____
 - B. DRILLING YES [] NO [] (2_PTS)
2. WAS THE TIMBER CUT, STACKED, AND BRUSH USED FOR SEDIMENT BARRIERS BEFORE DIRT WORK STARTED? YES [] NO [] (2_PTS) (4_PTS) _____
3. ARE ALL LOCATION AND/OR ROAD BANKS BEING SLOPED? YES [] NO [] (4_PTS) (4_PTS) _____
4. CONSTRUCTIONS:
WERE THE FOLLOWING SEDIMENT CONTROL STRUCTURES PROPERLY INSTALLED/MAINTAINED?
 - A. ROAD DITCHES (1)_ (2)_ (3)_ (4)_ (PTS) B. CROSS DRAINS (1)_ (2)_ (3)_ (4)_ (5)_ (PTS)
 - C. CULVERTS (1)_ (2)_ (3)_ (4)_ (5)_ (PTS) D. CREEK CROSSINGS (1)_ (2)_ (3)_ (PTS)
 - E. DIVERSION DITCHES (1)_ (2)_ (3)_ (PTS) F. BARRIERS (1)_ (2)_ (3)_ (PTS)
 - G. TEMPORARY SEEDING YES [] NO [] (10_PTS)

POINTS AVAILABLE FOR QUESTION 4: (33_PTS) _____

5. HAS TOP SOIL (IF ANY) BEEN STOCKED PILED? YES [] NO [] (2_PTS) (2_PTS) _____
6. IS THE PIT PROPERLY INSTALLED AND MAINTAINED? YES [] NO [] (9_PTS) (9_PTS) _____
7. RECLAMATION:
 - A. ROADWAY (1)_ (2)_ (3)_ (PTS) B. LOCATION (1)_ (2)_ (3)_ (PTS)
 - C. PITS (1)_ (2)_ (3)_ (PTS) D. PIPELINES (1)_ (2)_ (3)_ (PTS)
 - E. TANK DIKES (1)_ (2)_ (3)_ (PTS) F. API INSTALLED YES [] NO [] (3_PTS)
 - G. ADEQUATE SEEDING MATERIALS (1)_ (2)_ (3)_ (PTS)
 - H. WAS SEED BED ADEQUATE (1)_ (2)_ (3)_ (PTS)

POINTS AVAILABLE FOR QUESTION 7: (24_PTS) _____

8. WAS RECLAMATION COMPLETED WITHIN:
6 MTHS OF TD 6_PTS ONLY; 4 MTHS OF TD 12_PTS ONLY; 2 MTHS OF TD 19_PTS ONLY;
POINTS AVAILABLE FOR QUESTION 8: (19_PTS) _____

TOTAL MAXIMUM POSSIBLE SCORE OF 99.

TOTAL RECLAMATION SCORE: _____

1/21/2016
DATE RELEASED

[Signature]
INSPECTOR'S SIGNATURE

RECORD INSPECTIONS TO THIS WELL ON PAGE 2

Cancel