

# J OSBORN HSOP 16 203

## PAGE 2 OF 2

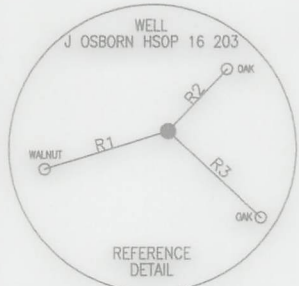

AS-DRILLED LOCATIONS UTM 17-NAD83(M)
SURFACE HOLE LOCATION (SHL)
N:4346578.589 E:567469.576
APPROX LANDING POINT (LP)
N:4343444.065 E:568313.987
BOTTOM HOLE LOCATION (BHL)
N:4341445.599 E:569051.542

**NOTES:**

1. There are no water wells or developed springs within 250' of proposed well.
2. There are no existing buildings within 625' of proposed well.
3. Proposed well is greater than 100' from perennial stream, wetland, pond, reservoir or lake.
4. There are no native trout streams within 300' of proposed well.
5. Proposed well is greater than 1000' from surface/groundwater intake or public water supply.
6. It is not the purpose or intention of this plat to represent surveyed locations of the surface or mineral parcels depicted herein. The location of the boundary lines, as shown, are based on record deed descriptions, field evidence found and/or tax map position, unless otherwise noted.

LINE	BEARING	DISTANCE
R1	S 72°36'39" W	228.12'
R2	N 43°37'20" E	150.12'
R3	S 46°54'51" E	224.15'
R4	N 15°32'40" W	974.20'
R5	N 29°30'21" E	998.47'
R6	N 47°38'00" E	1657.68'

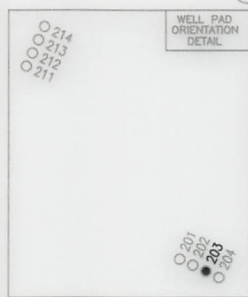

**THRASHER**

THE THRASHER GROUP, INC.  
600 WHITE OAKS BLVD.  
BRIDGEPORT, WV 26330  
PHONE 304-624-4108

JANUARY 20, 2022

**AS DRILLED PLAT**

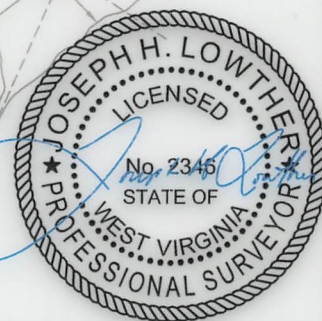



BHL is located on topo map 11,117 feet south of Latitude: 39°15'00"  
 SHL is located on topo map 9,392 feet south of Latitude: 39°17'30"

BHL is located on topo map 9,521 feet west of Longitude: 80°10'00"  
 SHL is located on topo map 2,767 feet west of Longitude: 80°12'30"

	SURFACE OWNER	DIST-TM/PAR
1	JUDY M. OSBORN (LE) (JUDY M. OSBORN IRREVOCABLE TRUST)	15-330/5
2	CHARLES THOMAS DAVIS II, ET AL	15-330/4
3	CHARLES THOMAS DAVIS II, ET AL	15-330/5.1
4	CHARLES E. REED 1/2 INTEREST GERALD W. BURNER ET AL 1/2 INTEREST	15-330/25
5	PAUL E. BALL	15-330/29
6	MICHAEL A. & ROBERTA OSBORN	15-350/4.2
7	MICHAEL A. & ROBERTA OSBORN	15-330/26.1
8	JASON OSBORN	15-350/4.3
9	RUSSELL E. RUTAN JR. & DOROTHY L. & JOHN TIMOTHY BELOTTE	15-350/5
10	GOBEL G. OSBORN JR. (LE) (MICHAEL BRUCE & JASON OSBORN)	15-350/6
11	R. MARK & DIANA L. HACKETT	15-350/18
12	DONALD N. & CYNTHIA J. MCHENRY	15-350/16.2
13	CALEB L. & JENNIFER L. CUTRIGHT	15-350/17.8
14*	BRIAN J. & ANDREA L. MILLS	15-350/17.7
15*	BRIAN J. & ANDREA L. MILLS	15-350/17.6
16*	GARY & MARGARET WHEELER	15-350/17.2
17*	BRIAN J. & ANDREA L. MILLS	15-350/17.5
18*	JASON MICHAEL SLEETH	15-350/17.1
19*	CALEB L. & JENNIFER L. CUTRIGHT	15-350/17.3
20*	JAY D. & TIFFANY B. WILLAMS	15-350/27.1
21*	JAY D. & TIFFANY BROOKE WILLIAMS	15-350/26.1
22*	LEWIS FRANKLIN & PAMELA MULLEN	15-350/25
23	CALEB L. CUTRIGHT	15-350/16.7
24	CHRISTOPHER F. & PAMELA MULLEN	15-350/25.3
25	LEWIS FRANKLIN & PAMELA MULLEN	15-350/27
26	CHARLES W. CLEVINGER IRR TRUST	15-370/13
27	SHAWN R. NEWBROUGH	15-370/21
28	EIP III WEST VIRGINIA LLC	15-371/7.1
29	EIP III WEST VIRGINIA LLC	15-371/7
30*	EIP III WEST VIRGINIA LLC	15-370/29

	LESSOR	DIST-TM/PAR
A	GOBEL OSBORN, ET AL	15-330/5
B	CHARLES THOMAS DAVIS, ET UX	15-330/4
C	GEORGE T. FARIS, ET AL	15-330/3
D	JOHN B. WEBB ET AL	15-330/25
E	THE BOARD OF EDUCATION OF THE COUNTY OF HARRISON	15-330/29
F	MARY ALICE HAFER REV TRUST MICHAEL A. OSBORN ET UX	15-330/26.1
G	MARY ALICE HAFER	15-330/26
H	NORVIL D. LANTZ	15-350/5
J	ALDERSON BROADDUS COLLEGE & AMP FUND III, LP	15-350/6
K	MARY LANCASTER CASTILLO ET AL	15-350/18
L	REBECCA A. COMPTON; JAMES MICHAEL COMPTON & JENNIFER NORA COMPTON	15-350/16.2 15-350/17.7 15-350/17.6 15-350/17.8 15-350/17.5 15-350/17.2 15-350/17.3 15-350/17.1
M	GRAFTON COAL COMPANY	P/O 15-350/25.3
N	LEWIS FRANKLIN MULLEN	P/O 15-350/26.1 15-350/25 15-350/25
P	W. R. JOHNSON ET AL	15-350/27 15-350/27.1 15-370/13
Q	N. D. PARKS ET AL	15-370/29 15-371/7 15-371/7.1 15-370/21



AS-DRILLED LOCATIONS UTM 17-NAD83(M)	
SURFACE HOLE LOCATION (SHL)	
N:4346578.589	E:567469.576
APPROX LANDING POINT (LP)	
N:4343444.065	E:568313.987
BOTTOM HOLE LOCATION (BHL)	
N:4341445.599	E:569051.542

# THRASHER

THE THRASHER GROUP, INC.  
 600 WHITE OAKS BLVD.  
 BRIDGEPORT, WV 26330  
 PHONE 304-624-4108

## AS DRILLED PLAT

SEE PAGE 2 FOR PLAT DUE TO LENGTH OF LATERAL

FILE #: J OSBORN HSOP 16 203 AS DRILLED  
 DRAWING #: J OSBORN HSOP 16 203 AS DRILLED  
 SCALE: 1" = 2000'  
 MINIMUM DEGREE OF ACCURACY: 1/2500  
 PROVEN SOURCE OF ELEVATION: U.S.G.S. MONUMENT THOMAS 1498.81'

I, THE UNDERSIGNED, HEREBY CERTIFY THAT THIS PLAT IS CORRECT TO THE BEST OF MY KNOWLEDGE AND BELIEF AND SHOWS ALL THE INFORMATION REQUIRED BY LAW AND THE REGULATIONS ISSUED AND PRESCRIBED BY THE DEPARTMENT OF ENVIRONMENTAL PROTECTION.

Signed: *Joseph H. Lowther*  
 R.P.E.: \_\_\_\_\_ L.L.S.: P.S. No. 2346

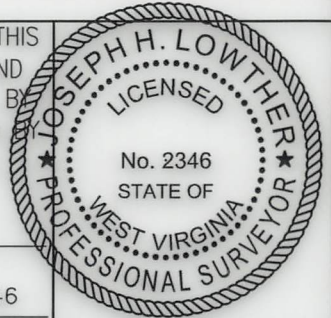

(+) DENOTES LOCATION OF WELL ON UNITED STATES TOPOGRAPHIC MAPS WVDEP  
 OFFICE OF OIL & GAS  
 601 57TH STREET  
 CHARLESTON, WV 25304



DATE: JANUARY 20, 2022  
 OPERATOR'S WELL #: J OSBORN HSOP 16 203 AS DRILLED  
 API WELL #: 47 33 5941  
 STATE COUNTY PERMIT

Well Type:  Oil  Waste Disposal  Production  Deep  
 Gas  Liquid Injection  Storage  Shallow

WATERSHED: SIMPSON CREEK ELEVATION: 1163.30'±

COUNTY/DISTRICT: HARRISON / SIMPSON QUADRANGLE: ROSEMONT, WV 7.5'

SURFACE OWNER: JUDY M OSBORN (LE) (JUDY M OSBORN IRREVOCABLE TRUST) ACREAGE: 70.00±

OIL & GAS ROYALTY OWNER: GOBEL OSBORN, ET AL ACREAGE: 1,607.99±

DRILL  CONVERT  DRILL DEEPER  REDRILL  FRACTURE OR STIMULATE   
 PLUG OFF OLD FORMATION  PERFORATE NEW FORMATION  PLUG & ABANDON   
 CLEAN OUT & REPLUG  OTHER CHANGE  (SPECIFY): AS DRILLED

TARGET FORMATION: MARCELLUS ESTIMATED DEPTH: TVD: 7,478.68'± TMD: 24,873.00'±

WELL OPERATOR ARSENAL RESOURCES DESIGNATED AGENT GARY SHORT  
 Address 6031 WALLACE ROAD EXTENSION, SUITE 300 Address 633 WEST MAIN ST.  
 City WEXFORD State PA Zip Code 15090 City BRIDGEPORT State WV Zip Code 26330