

HG Energy II Appalachia, LLC
Well No. 1207 N-4H



Page 1 of 2

I, the undersigned, hereby certify that this plat is correct to the best of my knowledge and belief and shows all the information required by law and the rules issued and prescribed by the Department of Environmental Protection.

Dwayne D. Matheny, P.S. 2070

Notes: Well No. 1207 N-4H
West Virginia Coordinate System of 1927, North Zone based upon Differential GPS Measurements.
Top Hole coordinates
Latitude: 39°09'07.84"
Longitude: 80°24'09.82"
Bottom Hole coordinates
Latitude: 39°11'25.74"
Longitude: 80°25'09.40"
UTM Zone 17, NAD 1983
Top Hole Coordinates
N: 4,333,947.253m
E: 551,821.870m
Bottom Hole Coordinates
N: 4,338,085.832m
E: 550,168.862m
Plat orientation and corner and well references are based upon the grid north meridian. Well location references are based upon the magnetic meridian.

BTM LATITUDE 39 - 12 - 30
TOP LATITUDE 39 - 10 - 00



TOP LONGITUDE 80 - 22 - 30
BTM LONGITUDE 80 - 25 - 00

5,268' to Top Hole

6,502' to Bottom Hole

Notes:
Well No. 1207 N-4H
UTM NAD 1983 (USSF)
Top Hole Coordinates
N: 4,218,630.63"
E: 1,809,779.42"
Landing Point Coordinates
N: 4,218,985.70"
E: 1,809,794.18"
Bottom Hole Coordinates
N: 4,232,536.60"
E: 1,805,005.78"

Well Location References Not to Scale

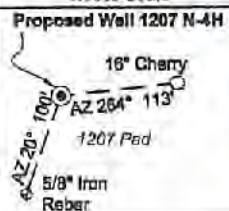

Legend

- Proposed gas well
- Well Reference, as noted
- Monument, as noted
- Existing Well, as noted
- Existing Plugged Well, as noted
- Digitized Well, as noted
- Creek or Drain
- Existing Road
- Surface boundary (approx.)
- Interior surface tracts (approx.)

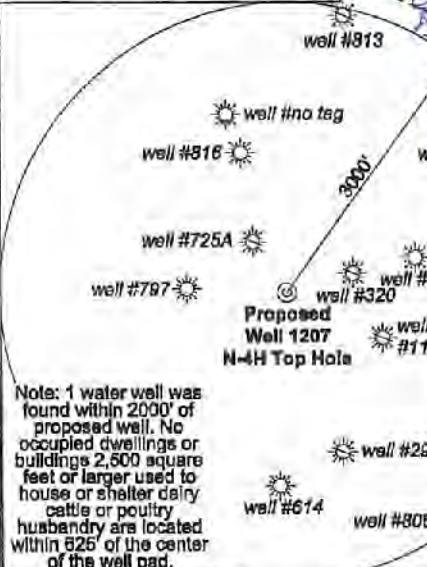

Note: 1 water well was found within 2000' of proposed well. No occupied dwellings or buildings 2,500 square feet or larger used to house or shelter dairy cattle or poultry husbandry are located within 525' of the center of the well pad.

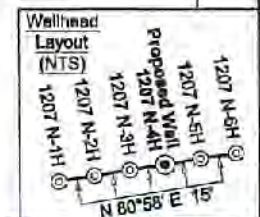

ID	Lease
1	J.B. Gusman, et al
2	A.J. Smith, et ux
3	Dora B. McWhorter, et al
5	A.C. Thrash, et al
7	Max Gaston, et al
8	Charles H. Gaston, et al
9	Leeman Maxwell, et al
10	Leeman Maxwell, et al
11	Camella Y. Morris, et al
12	WV Conservation Committee
13	Rachel S. Hershey, et al
14	Robert & Betty Stevenson, et al
15	Hiram J. Bumside
16	Joseph Chevront, et al
18	Charles H. Washburn
20	Union National Bank, et al
22	Venca Ward, et al
23	Roscoe Allman, et ux
24	Zina M. Davis, et al
6S	Union National Bank, et al

Tag	Bearing	Dist.
L1	S 01°03' E	1,177.1'
L2	S 22°43' W	1,304.3'
L3	S 83°36' W	2,139.1'
L4	N 59°10' W	1,153.5'
L5	N 02°23' E	355.5'

FILE NO: 296-36-G-18
DRAWING NO: 1207 N-4H Well Plat
SCALE: 1" = 2000'
MINIMUM DEGREE OF ACCURACY: Submeter
PROVEN SOURCE OF ELEVATION: CORS, Bridgeport, WV



DATE: August 8 20 19
OPERATOR'S WELL NO. 1207 N-4H
API WELL NO
47 - 033 - 0511
STATE COUNTY PERMIT

WELL TYPE: OIL GAS LIQUID INJECTION WASTE DISPOSAL
(IF GAS) PRODUCTION: STORAGE DEEP SHALLOW
LOCATION: ELEVATION: 1,344' WATERSHED: Middle West Fork Creek QUADRANGLE: West Milford
DISTRICT: Grant / Union COUNTY: Harrison
SURFACE OWNER: HG Energy II Appalachia, LLC ACREAGE: 89.07
ROYALTY OWNER: Dora B. McWhorter, et al LEASE NO: ACREAGE: 103.00
PROPOSED WORK: DRILL CONVERT DRILL DEEPER FRACTURE OR STIMULATE PLUG OFF OLD FORMATION
 PERFORATE NEW FORMATION OTHER PHYSICAL CHANGE IN WELL (SPECIFY) 7,145' TVD
 PLUG AND ABANDON CLEAN OUT AND REPLUG TARGET FORMATION: Marcellus Shale ESTIMATED DEPTH: 21,977' MD

WELL OPERATOR: HG Energy II Appalachia, LLC DESIGNATED AGENT: Diana C. White
ADDRESS: 5260 Dupont Road ADDRESS: 5260 Dupont Road
Parkersburg, WV 26101 Parkersburg, WV 26101

No.	TM / Par	Ac.	Owner	Bk / Pg		
1	445 / 5	89.07	HG Energy II Appalachia, LLC	— / —		
2	445 / 13	132.852	Mickey Pettito	WB175 / 1153		
3	445 / 3	64.00	Lisa M. Nutter	WB887 / 445		
4	445 / 12	64.50				
5	445 / 5.1	3.38	David W. Lohr	1531 / 421		
6	425 / 28	32.30	WV State Conservation Commission	WB33 / 148		
7	445 / 2	84.57	Lisa M. Nutter	WB887 / 445		
8	445 / 25	194.90	Linda J. Maxwell Revocable Trust	1302 / 793		
9	445 / 24	19.80				
10	425 / 5	173.80	WV State Conservation Commission	WB33 / 148		
	425 / 7	5.50				
11	445 / 25.2	83.189	Laurinda R. Beckstead	1420 / 941		
12	425 / 4	4.35	Robert W. & Jennifer L. Delaney	1501 / 21		
13	425 / 4.4	1.99	Paul R. & Linda R. Beatty	1284 / 1121		
14	425 / 25.1	5.45				
15	425 / 4.2	3.14				
16	425 / 4.1	2.02				
17	425 / 3	14.00				
18	405 / 78	57.68			WV State Conservation Commission	WB33 / 148
19	405 / 75	202.18			William Michael McDonald	1377 / 99
20	425 / 4.3	30.50	Lauminda Raye Beckstead	1177 / 651		
21	405 / 67	38.10	Terence L. Washburn, et al	1438 / 989		
22	405 / 59	43.40	Terence L. Washburn	1294 / 433		
23	405 / 69	62.35	James D. McWhorter	— / —		
24	405 / 61	12.00	Samuel S. Stark	1327 / 1048		
25	405 / 60	18.12				
26	408 / 68	2.47	James D. McWhorter	1505 / 1158		
27	385 / 81	85.50	Buffalo Lake Development, LLC	1528 / 685		
28	405 / 4	20.17	Betty Jo & Kyle Fridley	1233 / 244		
29	405 / 69.3	4.0	Jeremy T. & Erin N. Bowers	1497 / 897		
30	405 / 1.4	25.07	Joseph Workman	1377 / 1131		
31	405 / 1.3	10.48				
32	405 / 69.1	0.72	Roberta K. Cotril	1373 / 505		
33	405 / 6	21.93	James Ivan McDonald	1347 / 1133		
34	405 / 4	20.17	Betty Jo & Kyle Fridley	1233 / 244		
35	405 / 62	66.24	Evelyn M. Ward LE	— / —		
36	405 / 5	6.05	James Ivan McDonald	1229 / 370		
37	405 / 1	0.94	Brandon T. Leary	1488 / 749		
38	405 / 8	10.19	Larry W. & Dorothy L. Dstamore	1188 / 714		
39	405 / 6.1	1.06	George F. & Helen M. Peterson	1379 / 1146		
	405 / 6.2	0.52				
40	405 / 28.1	0.88	William & Cynthia Marsh	1139 / 446		
41	405 / 28.2	0.74	Eugene D. Wilson	957 / 247		
42	405 / 28.4	0.405	John & Linda Cathell	980 / 697		
	405 / 28.8	0.140				
43	405 / 26	3.759	Margaret L. Phillips	1177 / 635		
44	405 / 62.1	74.30	John & Mary Stenger	1402 / 334		
45	405 / 4.1	0.94	James Ivan McDonald	1229 / 370		
46	405 / 70	3.452	Michael A. & Carleen	1527 / 649		
	405 / 70.1	3.452				
47	405 / 71	2.97	Eugene & Violet A. Debarr	1109 / 97		
48	405 / 71.1	1.485	Kathy D. Bennett	1109 / 97		
49	405 / 62.10	2.08	Danny J. & Deborah J. Miller	1505 / 8		
50	405 / 62.8	2.63	Michael T. Jr & Ramona J. Morris	1627 / 376		
51	405 / 62.3	1.26	Wayne & Naomi McHenry	1537 / 486		
52	405 / 72	4.32	Sandra W. & Willard Miller	1031 / 554		
53	405 / 72.1	4.32	Melissa Barker	1403 / 68		
	405 / 62.4	0.99				
54	405 / 62.7	0.48	Tricia A. & Jeremy L. Dobbins	1336 / 980		
	405 / 62.9	0.74				
	405 / 73	45.00				
55	405 / 74	107.78	Marry Lou Smith	WB177 / 1179		
	405 / 80	90.97				
	405 / 81	42.00				
56	425 / 6	105.55	WV Dept. of Natural Resources	WB85 / 624		
	425 / 14	73.60				
	425 / 15	40.85				
57	425 / 13	9.00	Penny L. Hill	1481 / 53		
58	425 / 5	61.50	WV State Conservation Comm.	WB33 / 148		
59	425 / 8	151.09	James L. Sellers Family Revocable Trust	1480 / 728		
	425 / 8.1	13.481				

60	425 / 27	26.40	Marva Shaperd	WB166 / 413
	425 / 28	19.92		
61	425 / 12	42.30	Antonio P. LLC	1503 / 291
	425 / 16	122.25		
	425 / 17	48.00		
62	425 / 11	6.29	Linda Snyder	1124 / 768
	425 / 11.1	5.12		
63	425 / 10	9.60	Joy L. Jarrett	1272 / 348
64	425 / 10.1	3.10	Robert R. & Debbie A Partain	1308 / 553
65	425 / 9	3.88	Leslie S. Riggelman	WB127 / 660
66	425 / 8.3	1.408	Melanie S. & Jay A. Morris	1386 / 660
67	425 / 8.2	0.39	Linda & Mark Wilfong	1438 / 93
68	425 / 20	3.00	Jeffery L. & Parry S. Harvey	1394 / 607
69	425 / 21	15.26	Juddith H. Russell	1212 / 1074
70	425 / 22	1.00	Duck Creek Mission Church Trust	1024 / 964
71	425 / 9.1	4.22	Sharon Campbell	1374 / 1083
72	425 / 9.2	4.66	Michael & Cecilia Daughtory	1543 / 1305
73	385 / 82.1	10.05	Lloyd W. Brake Jr. Trust	1427 / 141
74	405 / 6	21.93	James Ivan McDonald	1347 / 113
75	405 / 83	1.01	Pamala M. Puddister	1277 / 279
76	405 / 63.2	42.47	Larry D. Meyers Revocable Trust	W191/1279
77	405 / 63.6	42.47	John P. & Virginia R. Markley	1353 / 1084
78	405 / 63.7	1.00	Robert J. Jr. & Joyce B. Markley	1560 / 310
79	405 / 63.5	4.00	Charles F. & Dawn L. Grow	1495 / 523
80	405 / 63.10	4.00	Kimberly K. & John T. Lough	1518 / 822
81	425 / 23.3	0.54	Rhonda R. & George P. Koutsobaris	1420 / 93
	425 / 28.1	0.27		
82	405 / 28	2.60	David Allen Bunch	W173/1273
83	405 / 27	1.04	Betty Fridley	W160/268
	405 / 28.8	1.04		
84	405 / 89	3.50	Megan & Chad Fincham	1524 / 645

FILE NO: 296-36-G-18
DRAWING NO: 1207 N-4H Well Plat
SCALE: 1" = 2000'
MINIMUM DEGREE OF ACCURACY: Submeter
PROVEN SOURCE OF ELEVATION: CORS, Bridgeport, WV



DATE: August 8 20 19
OPERATOR'S WELL NO. 1207 N-4H
API WELL NO
47 — 033 05911
STATE COUNTY PERMIT

WELL TYPE: OIL GAS LIQUID INJECTION WASTE DISPOSAL
(IF GAS) PRODUCTION: STORAGE DEEP SHALLOW
LOCATION: ELEVATION: 1,344' WATERSHED: Middle West Fork Creek QUADRANGLE: West Milford
DISTRICT: Grant / Union COUNTY: Harrison
SURFACE OWNER: HG Energy II Appalachia, LLC ACREAGE: 89.07
ROYALTY OWNER: Dora B. McWhorter, et al LEASE NO: ACREAGE: 103.00
PROPOSED WORK: DRILL CONVERT DRILL DEEPER FRACTURE OR STIMULATE PLUG OFF OLD FORMATION
 PERFORATE NEW FORMATION OTHER PHYSICAL CHANGE IN WELL (SPECIFY) 7,145' TVD
 PLUG AND ABANDON CLEAN OUT AND REPLUG TARGET FORMATION: Marcellus Shale ESTIMATED DEPTH: 21,977' MD

WELL OPERATOR: HG Energy II Appalachia, LLC DESIGNATED AGENT: Diane C. White
ADDRESS: 5260 Dupont Road ADDRESS: 5260 Dupont Road
Parkersburg, WV 26101 Parkersburg, WV 26101