

HG Energy II Appalachia, LLC
Well No. Antonio 1206 N-3H
As-Drilled

No.	TM / Par	Owner	Bk / Pg	Ac.
1	426 / 72	Charles R. & Franklin L. Sutton	1301 / 98	30.00
2	426 / 71	Antonio P., LLC	1503 / 291	233.35
3	446 / 1	Antonio P., LLC	1503 / 291	24.10
4	446 / 2	Antonio P., LLC	1503 / 291	43.89
5	446 / 3	Antonio P., LLC	1503 / 291	200.00
6	426 / 63	Charles R. & Franklin L. Sutton	1301 / 98	51.33
7	426 / 38	Antonio P., LLC	1503 / 291	50.75
8	426 / 39	Antonio P., LLC	1503 / 291	50.00
9	426 / 37	Antonio P., LLC	1503 / 291	54.00
10	426 / 13	Antonio P., LLC	1503 / 291	149.74
11	425 / 16	Antonio P., LLC	1503 / 291	122.25
12	406 / 28	Antonio P., LLC	1503 / 291	176.82
13	405 / 82	Jim K. Stutler	1563 / 89	206.52

Tag	Bearing	Dist.
L1	N 75°55' W	3,486.5'
L2	N 53°02' E	1,537.1'
L3	S 89°01' E	2,905.8'
L4	S 71°12' E	1,536.7'

Notes:
 Well No. Antonio 1206 N-3H
 UTM NAD 1983 (USSF)
 Top Hole Coordinates
 N: 14,220,784.42'
 E: 1,815,504.48'
 Landing Point Coordinates
 N: 14,220,574.96'
 E: 1,815,604.26'
 Bottom Hole Coordinates
 N: 14,229,807.10'
 E: 1,812,331.52'

Notes: Well No. Antonio 1206 N-3H
 West Virginia Coordinate System of
 1927, North Zone
 based upon Differential GPS
 Measurements.
 Top Hole coordinates
 Latitude: 39°09'28.85"
 Longitude: 80°22'57.03"
 Bottom Hole coordinates
 Latitude: 39°10'58.28"
 Longitude: 80°23'36.56"
 UTM Zone 17, NAD 1983
 Top Hole Coordinates
 N: 4,334,503.760m
 E: 553,366.872m
 Bottom Hole Coordinates
 N: 4,337,253.879m
 E: 552,399.752m
 Plat orientation and corner and well
 references are based upon the grid
 north meridian.
 Well location references are based
 upon the magnetic meridian.

Note: 1 Pond and Zero water wells were
 found within 2000' of proposed well. No
 occupied dwellings or buildings 2,500 square
 feet or larger used to house or shelter dairy
 cattle or poultry husbandry are located within
 625' of the center of the well pad.

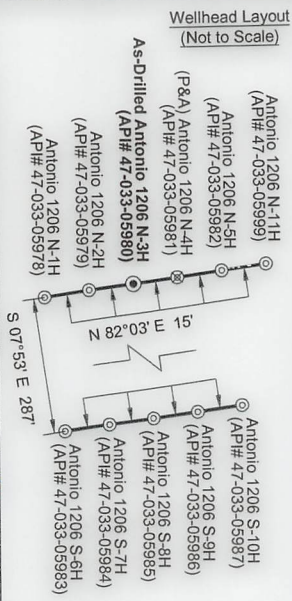

5,239' to Bottom Hole

2,129' to Top Hole

BTM LATITUDE 39 - 12 - 30
 TOP LATITUDE 39 - 10 - 00

LONGITUDE 80 - 22 - 30
 3,151' to Top Hole

9,277' to Bottom Hole



ID	Lease
3	C. Earl Snider, et al
4	Alton Bell, et al
16	Lewis M. Stout, et al
18	H.D. Smith, et al
19	Suzanne D. Simmons, et al
22	Rachel S. Hershey, et al
24	Mary A. Lowther, et al
25	Porter Maxwell, et al
26	Marcella R. Bond, et al

I, the undersigned, hereby certify
 that this plat is correct to the best of
 my knowledge and belief and contains
 all the information required by law
 and the rules issued and prescribed
 by the Department of Environmental
 Protection.

Dwayne D. Matheny
 Dwayne D. Matheny, P.S. 2070

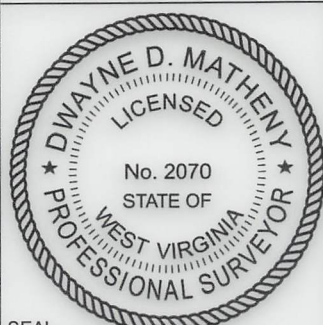

SEAL

Legend

- ⊙ Proposed gas well
- ⊕ Well Reference, as noted
- ⊗ Monument, as noted
- ⊙ Existing Well, as noted
- ⊙ Existing Plugged Well, as noted
- ⊙ Digitized Well, as noted
- Creek or Drain
- Existing Road
- Surface boundary (approx.)
- Interior surface tracts (approx.)

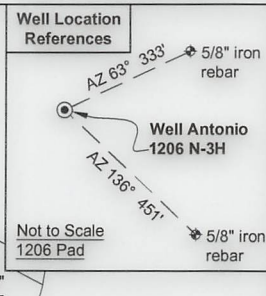

FILE NO: 06-36-12-G-H-19
 DRAWING NO: Antonio 1206 N-3H As-Drilled
 SCALE: 1" = 1500'
 MINIMUM DEGREE OF ACCURACY:
 Submeter
 PROVEN SOURCE OF ELEVATION:
 CORS, Bridgeport, WV

STATE OF WEST VIRGINIA
 DEPARTMENT OF ENVIRONMENTAL PROTECTION
OIL AND GAS DIVISION

DATE: December 6 2021
 OPERATOR'S WELL NO. Antonio 1206 N-3H
 API WELL NO
 47 - 033 - 05980
 STATE COUNTY PERMIT

WELL TYPE: OIL GAS LIQUID INJECTION WASTE DISPOSAL
 (IF GAS) PRODUCTION: STORAGE DEEP SHALLOW

LOCATION: ELEVATION: 1,350' WATERSHED: Middle West Fork Creek
 DISTRICT: Grant QUADRANGLE: West Milford
 SURFACE OWNER: Charles R. & Franklin L. Sutton COUNTY: Harrison
 ROYALTY OWNER: Charles R. Sutton LEASE NO: ACREAGE: 30.00
 PROPOSED WORK: DRILL CONVERT DRILL DEEPER FRACTURE OR STIMULATE PLUG OFF OLD FORMATION
 PERFORATE NEW FORMATION OTHER PHYSICAL CHANGE IN WELL (SPECIFY) _____
 PLUG AND ABANDON CLEAN OUT AND REPLUG TARGET FORMATION: Marcellus Shale ESTIMATED DEPTH: 17,322' MD 7,506' TVD

WELL OPERATOR: HG Energy II Appalachia, LLC DESIGNATED AGENT: Diane C. White
 ADDRESS: 5260 Dupont Road ADDRESS: 5260 Dupont Road
 Parkersburg, WV 26101 Parkersburg, WV 26101