

WELLS NO. 201-202  
 PIPE CONSTRUCTION & REFINING CO.  
 J.W. SPROUT  
 SADDIS

HARRISON  
 Green, W.Va.

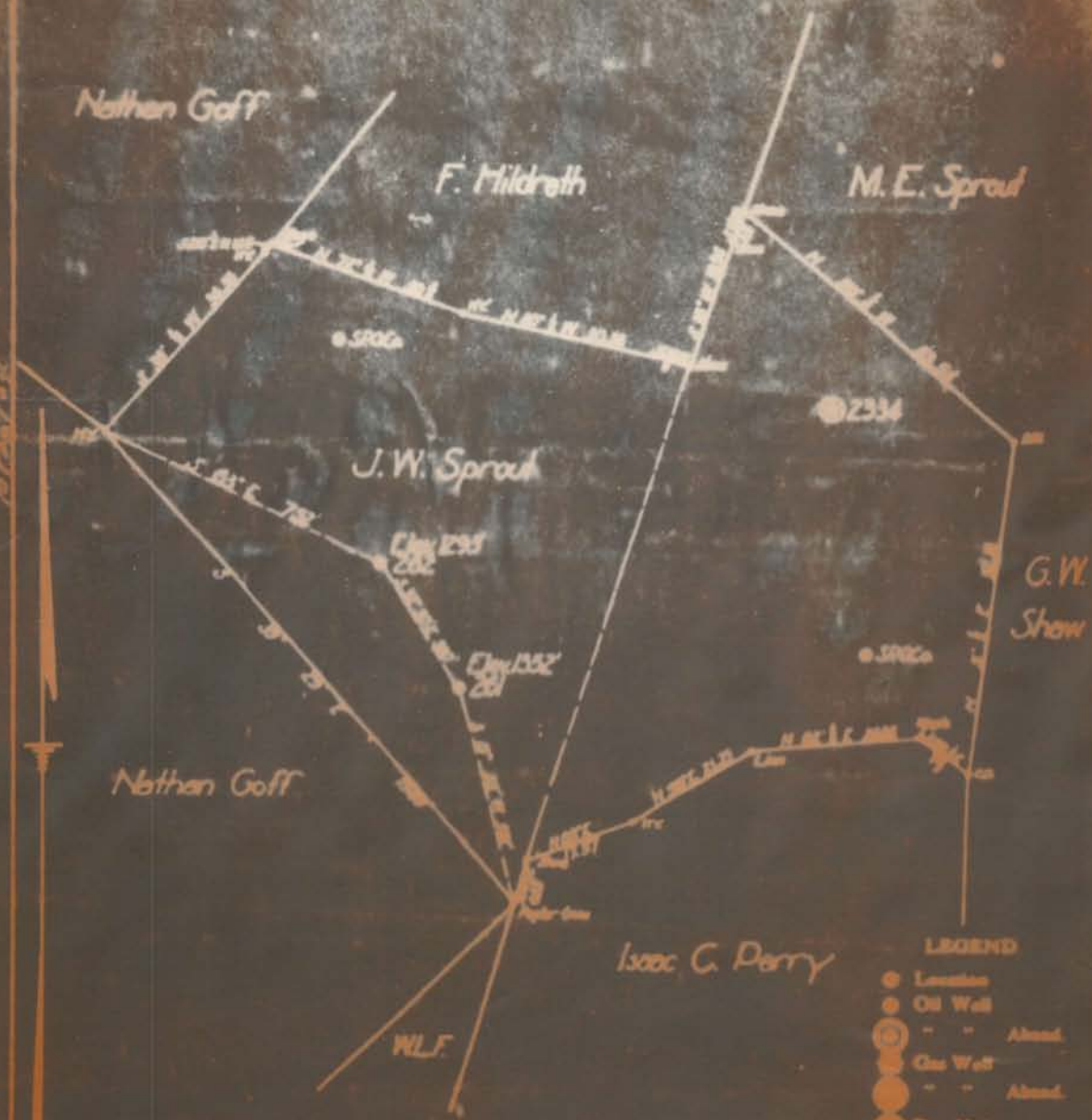

**LEGEND**

- Location
- Oil Well
- " " Ahead.
- Gas Well
- " " Ahead.
- Dry Hole

Field Book No. 56392  
 Scale 1"=200'  
 Oct. 12, 1936

HAR-210-A

Geological Certificate

I, the undersigned, hereby certify that this map is correct and shows all the information to the best of my knowledge and belief, acquired by me and my assistants at the proper time of when made.

## WEST VIRGINIA DEPARTMENT OF MINES

## OIL AND GAS DIVISION

## PRELIMINARY DATA SHEET NO. 1

Pitze No. \_\_\_\_\_ Well No. 1  
J. M. Reed & Wm. Mosser Company of Salem, W. Va. H C & R #261  
 on the J. W. Sprout Farm

containing 30 acres. Location \_\_\_\_\_  
Sardin District, in Harrison County, West Virginia

The surface of the above tract is owned in fee by Genil Cunningham  
Wallace, W. Va. Route #2, address, and the mineral rights are owned by \_\_\_\_\_ of \_\_\_\_\_

The oil and gas privileges are held under lease by the above named company, and this well is drilled under permit \_\_\_\_\_ issued by the West Virginia Department of Mines, Oil and Gas Division \_\_\_\_\_

Elevation of surface at top of well, 1308 Spirit \_\_\_\_\_

The number of feet of the different sized casings used in the well.

	feet	also	Wood conductor
<u>1488</u> feet <u>8 1/2"</u> size, ran <u>2368</u> feet <u>6-5/8"</u> stand rig			
<u>3072</u> feet <u>7-3/16"</u> size, ran <u>3187</u> feet <u>2"</u> stand rig			
_____ feet _____ size, ran _____ feet _____ stand rig			
_____ number of _____ also, set at _____			
_____ number of _____ also, set at _____			
_____ is casing perforated at _____ feet to _____ feet			
_____ is casing perforated at _____ feet to _____ feet			

Coal was encountered at 768 feet, thickness 36 inches, and at 1065 feet, thickness 40 inches, and at \_\_\_\_\_ feet, thickness \_\_\_\_\_ inches

Liners were used as follows: (Give details) \_\_\_\_\_

HAR-210-A

Name	Color	Character	Oil, Gas or Water	Top			
Native Coal				526			
Pittsburgh Coal				1045			
Little Dunkard Sand				1371			
Big Dunkard Sand				1560			
First Salt Sand				1834			
Second Salt Sand		Water	1844	1988			
Maxon Sand		Water	1988	2165			
Little Lime				2294			
Pencil Cave				2301			
Big Lime				2303			
Big Injun Sand				2372			
		Gas	2373 & 2384				
Gantz Sand				2888			
Fifty Foot Sand				2935			
Thirty Foot Sand				3022			
Gordon Stray Sand				3051			
Gordon Sand		Show gas	3119	3154			
		Oil	3175				
		Gas	3160 & 3171				

shot  
Well was shot at

3071-3077

feet; well was shot

shot  
Fresh water at

salt  
feet; fresh water at

producing  
Well was

dry



AFFIDAVIT IN TRIPLICATE TO TIME AND MANNER OF PLUGGING AND FILLING WELL (REQUIRED BY SECTION 8, ARTICLE 4, CHAPTER 22 OF THIS CODE) WEST VIRGINIA DEPARTMENT OF MINES OIL AND GAS DIVISION

NO COAL OPERATIONS IN THIS SECTION.

RAAD & MOSES, NAME OF WELL OPERATOR

SALEM, W. VA. COMPLETE ADDRESS

AUG. 11, 1935. DATE

WELL AND LOCATION

SARDIS HARRISON

Well No. #1.

J. W. SPROUT

AFFIDAVIT TO BE MADE IN TRIPLICATE. ONE COPY TO BE MAILED BY REGISTERED MAIL TO THE DEPARTMENT. ONE COPY TO BE MAILED TO EACH COAL OPERATOR'S HOME OFFICE. THE THIRD COPY (AND EXTRA COPIES IF REQUIRED) TO BE MAILED TO EACH COAL OPERATOR'S HOME OFFICE AT THE TIME OF THE MAILING.

AFFIDAVIT

STATE OF WEST VIRGINIA, COUNTY OF HARRISON

vs: B. A. MITCHELL & A. S. FAIRBANKS

and being first duly sworn according to law depose and say that they are experienced in the work of plugging and filling oil and gas wells and were employed by RAAD & MOSES and participated in the work of plugging and filling the above well, that on the 11th day of OCT., 1935, and that this well was plugged and filled in the following manner:

Manner in which sand was plugged: FILLED HOLE with clay mud to 3031' above gordon sand and cement and wood plug was placed. The filling hole to 3031' - 20' above gordon Stray Sand after 1 1/2" casing removed. Installed permanent bridge at 2504-30' below big layers and filled hole with mud & clay to 2370' - reved 6 5/8" casing and completed filling the hole 2350' and placed cement plug. Bridged hole to 1463' and filled with mud and Clay to 1463' and placed cement & wood plug. Moved 8 1/2" casing and continued filling the hole to 1079-30' below Stray Sand.

Manner in which coal was plugged: then filled with cement to Pittsburgh Coal Seam and then filled hole with mud & clay to the next higher coal seam then filled with cement to 504-20' above the Coal seam, and from that point to the surface the hole was filled with mud & Clay - and concrete monument erected over the hole as follows:

a Monument erected 30 inches by 30 square and 12 inches deep with a post 9 inches square with the following wording:

Description of monument: RAAD & MOSES, SPROUTS

THE ABOVE DESCRIPTIONS MUST BE IN DETAIL AND IN ACCORDANCE WITH THE PROVISIONS OF SECTION 8, ARTICLE 4, CHAPTER 22 OF THIS CODE.

and that the work of plugging and filling said well was completed on the 11th day of August, 1935.

Handwritten signatures and initials at the bottom of the page.