

LATITUDE 39° 20'

LONGITUDE 80° 30'

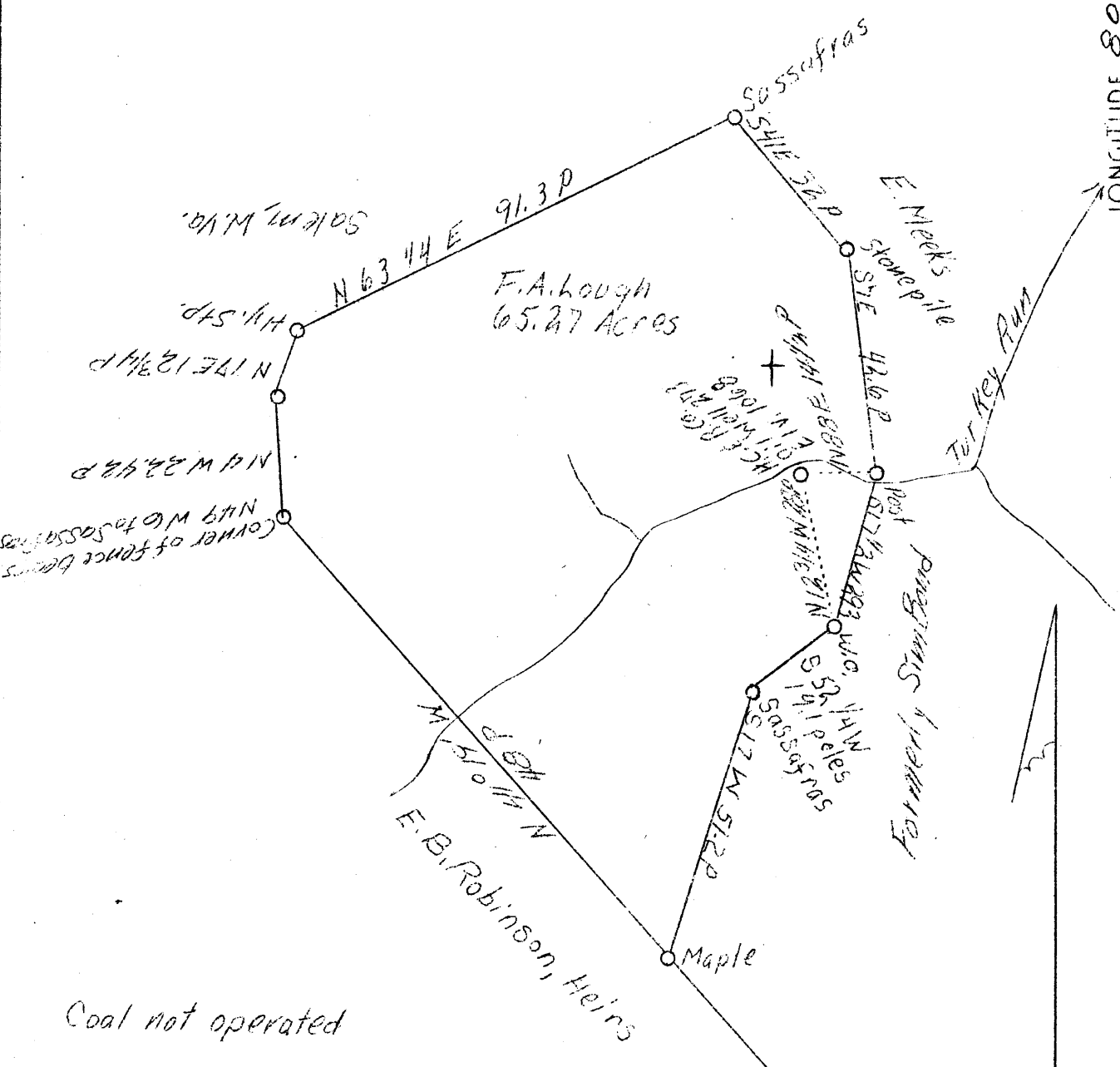

Coal not operated

3.62S  
2.24W

Company Raad & Moses 3178  
 Address Salem, W.Va.  
 Farm F.A. Lough  
 Acres 65.27  
 Well(Farm)No. 3  
 El.(S. L.) 1068  
 Quadrangle Centerpoint  
 County Harrison  
 District Tennile  
 Eng. C. C. Fittro S.E.  
 Eng. Reg. No. 818  
 File No. XYZ  
 Drawing No. 111  
 Date 5/6/1939  
 Scale 1" - 30 Poles

STATE OF WEST VIRGINIA  
 Department of Mines  
 OIL AND GAS DIVISION  
 Charleston

WELL LOCATION MAP  
 File No. HAY-483-A

x Denotes location of well on U.S. Topographic Maps, scale 1 to 62,500, latitude and longitude lines being represented by border lines as shown.  
 - Denotes one inch spaces on border line of original tracing.