

Scale 1" = 800 Feet

Longitude 80° 30'

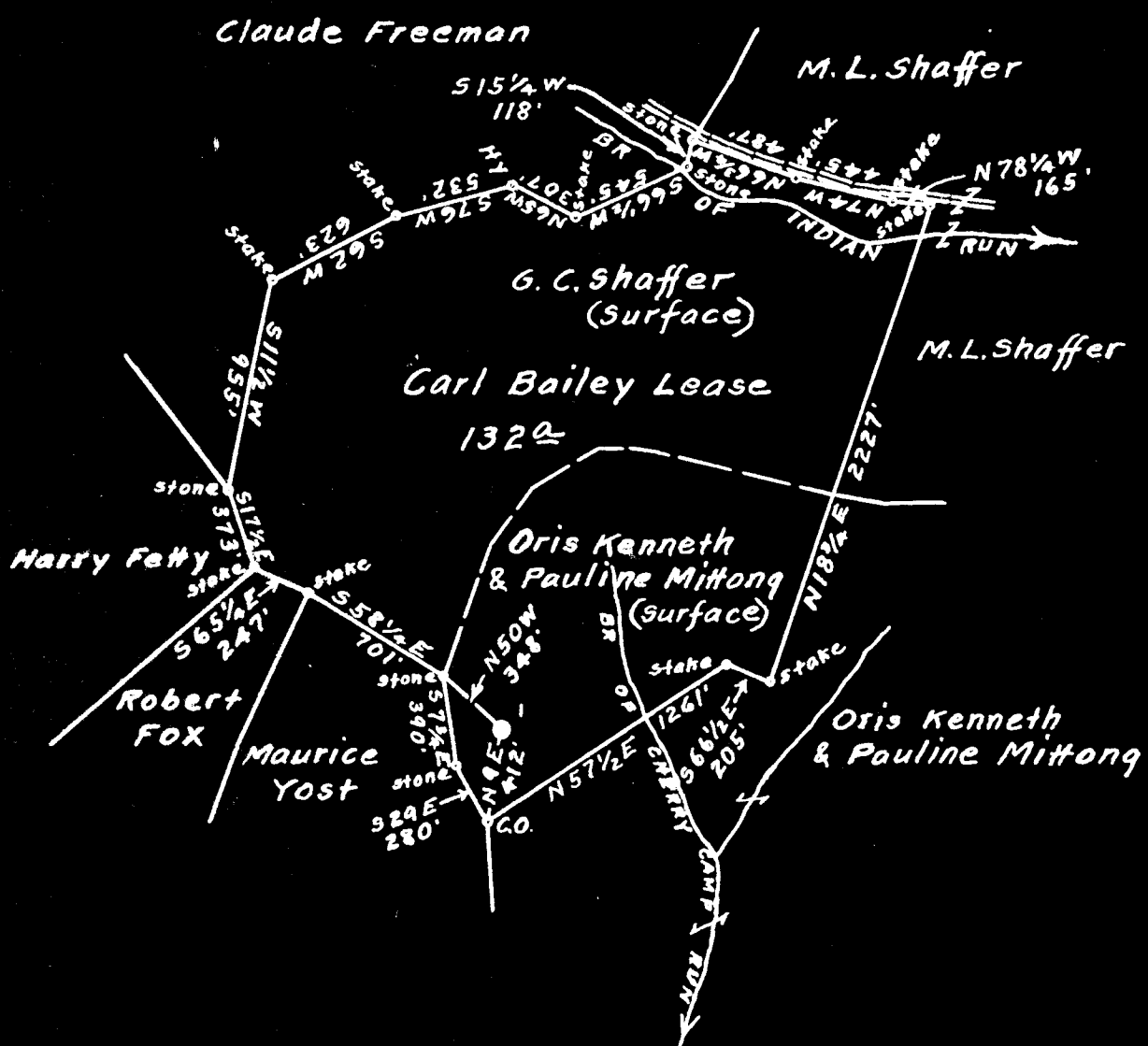

S 1.54
W 2.80

Surface owned by Oris Kenneth & Pauline Mittonq.
Address: Mr. Oris Kenneth Mittonq, Bristol, W. Va.
Coal owned by Virginia A. Tetrick.
Address: Mrs. Virginia A. Tetrick, P.O. Box No. 267.
Clarksburg, W. Va.

- New Location...
- Drill Deeper.....
- Abandonment.....

On 800' Map N29. Sqs. S10 E4.

Company Salem Supply Co.
 Address Salem, W. Va.
 Farm Carl Bailey
 Tract _____ Acres 132 Lease No. _____
 Well (Farm) No. 1 Serial No. _____
 Elevation (Spirit Level) Floor 1321.12
Ground - 1317.92
 Quadrangle Centerpoint
 County Harrison District Tenmile
 Engineer Bluworth Haines
 Engineer's Registration No. 2221
 File No. _____ Drawing No. _____
 Date July 7th, 1950, Scale 1" = 800 Feet

STATE OF WEST VIRGINIA
 DEPARTMENT OF MINES
 OIL AND GAS DIVISION
 CHARLESTON

WELL LOCATION MAP
 FILE NO. HAR-1415-A-1

+ Denotes location of well on United States Topographic Maps, scale 1 to 62,500, latitude and longitude lines being represented by border lines as shown.

- Denotes one inch spaces on border line of original tracing.

CARL BAILEY NO. 1 WELL.

1415A

Tennile District, Harrison County, W. Va.

By Salem Supply Co., Salem, W. Va.

Abandoned under permit Har-.....-A7

On.....acres.

Elevation,' L.

Drilling commenced and completed June, 1919.

6⁵/₈" casing, 1958'; 5³/₁₆" 2491'; all left in.

Coal was encountered at 1070-1076'.

Oil well. Record to Dept. of Mines not dated or stamped.

Record to RCF from Mrs. Griffith Sept. 9, 1950. Old File No. 1213.

	Top.	Bottom.
Pittsburgh Coal	1070	- 1076
Little Dunkard Sand	1450	- 1485
Big Dunkard Sand	1537	- 1605
Maxton Sand	2310	- 2330
Little Lime	2333	- 2345
Big Lime	2355	- 2400
Big Injun Sand	2400	- 2510
50-Ft. Sand	2894	- 2923
30-Ft. Sand	3022	- 3065
Gordon Stray Sand	3119	- 3135
Gordon Sand (oil, 3154 and 3164')	3150	- 3170
Total depth		3170



STATE OF WEST VIRGINIA
DEPARTMENT OF MINES
OIL AND GAS DIVISION

1113

WELL RECORD

Permit No. 4412-1415-A

Oil or Gas Well _____
(KIND)

Company Salem Supply Co.
Address Salem, W. Va.
Farm Carl Bailey Acres _____
Location (waters) _____
Well No. One Elev. _____
District Ten Mile County Harrison
The surface of tract is owned in fee by _____
Address _____
Mineral rights are owned by _____
Address _____
Drilling commenced 6- 1913
Drilling completed 6- 1913
Date Shot _____ From _____ To _____
With _____
Open Flow _____ /10ths Water in _____ Inch
_____ /10ths Merc. in _____ Inch
Volume _____ Cu. Ft.
Rock Pressure _____ lbs. _____ hrs.
Oil _____ bbls., 1st 24 hrs.
Fresh water _____ feet _____ feet
Salt water _____ feet _____ feet

Casing and Tubing	Used in Drilling	Left in Well	Packers
Size			
16			Kind of Packer
18			
10			Size of
8 1/4		1958	
6 1/2		2491	Depth set
5 3/16			
3			Perf. top
2			Perf. bottom
Liners Used			Perf. top
			Perf. bottom

CASING CEMENTED _____ SIZE _____ No. Ft. _____ Date _____
COAL WAS ENCOUNTERED AT 1070 FEET 72 INCHES
_____ FEET _____ INCHES FEET _____ INCHES
_____ FEET _____ INCHES FEET _____ INCHES

Formation	Color	Hard or Soft	Top	Bottom	Oil, Gas or Water	Depth Found	Remarks
Fgh Coal			1070	1076			
Lt. Dunkard			1450	1485			
Big "			2537	1605			
Maxon			2310	2330			
Lt. Lime			2333	2345			
Big Line			2355	2400			
Injun			2400	2510			
50ft.			2894	2923			
30ft.			3022	3065			
Gordon Stray			3119	3135	011	3154	
Gordon			3150	3170	"	3164	
Total Depth				3170			