



New Location
 Drill Deeper
 Abandonment

Company **F. S. S. PIPE AND SUPPLY CO.**
 Address Chamber of Commerce Building, Charleston, West Va.
 Farm Benjamin F. Lowe
 Tract Acres 94.8 Lease No.
 Well (Farm) No. Two Serial No.
 Elevation (Spirit Level) 1066
 Quadrangle Clarkburg
 County Harrison District Clay

STATE OF WEST VIRGINIA
 DEPARTMENT OF MINES
 OIL AND GAS DIVISION
 CHARLESTON

WELL LOCATION MAP
 FILE NO. HAR-1591-B

+ Denotes location of well on United States Topographic Maps, scale 1 to 62,500, latitude and longitude lines being represented

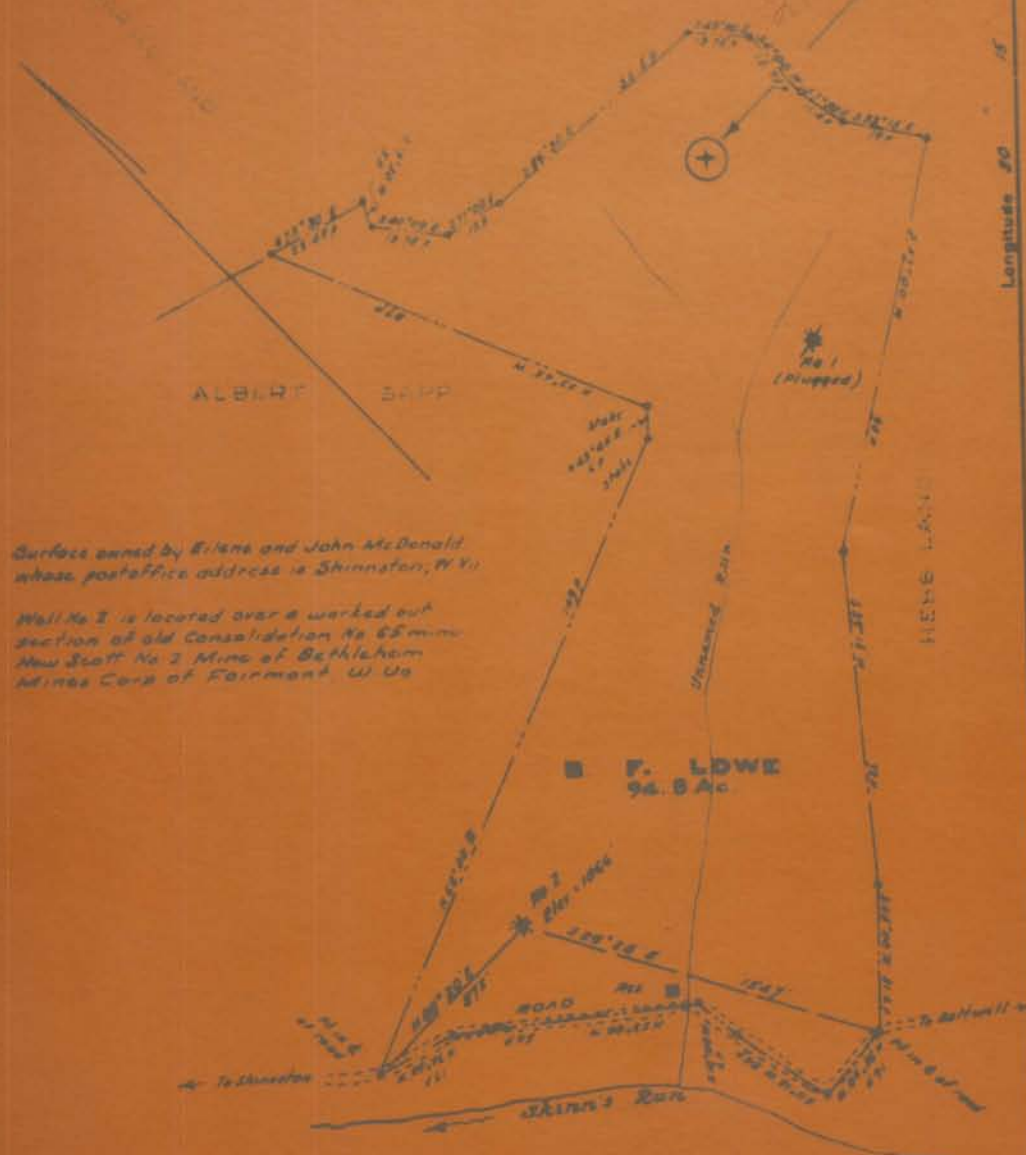

New Location

Oil Dealer

Abandonment

Company **F. E. S. PIPE AND SUPPLY CO.**

Address **Corner of Commercial Building, Charleston, West Va.**

Farm **Benjamin F. Lowe**

STATE OF WEST VIRGINIA
DEPARTMENT OF MINES
OIL AND GAS DIVISION
CHARLESTON

	<u>Top</u>	<u>Bottom</u>	<u>Remarks</u>
Bottoming in	20	128	16' to 10' to 10'
1st	520	540	
2nd	572	575	
3rd	820	860	
4th	867	915	3' or less water from 910'
5th	935	950	
6th	1025	1200	2' or less reduced at 1230
7th	1508	1515	
8th	1515	1520	
9th	1520	1562	
10th	1562	1667	Gravel 1604-1607
50 ft	2068	2092	
30 ft	2128	2150	
London Clay	2263	2275	
London	2405	2430	Low 2410
4th	2448	2490	2450
5th	2490	2497	2491
6th	2570	2574	Oil 2570
7th		2600	



Casing	Put in Well	Pulled out	Left in.
10"	167'	—	167' cemented
6 3/8"	1586'	—	1586'
5 1/2"	2600'	—	2600' (1115 feet) working found to bottom.
5 7/8"	There is 5" casing in well but don't know just where it was set.		