

Latitude 38° 35'

Longitude 81° 35'

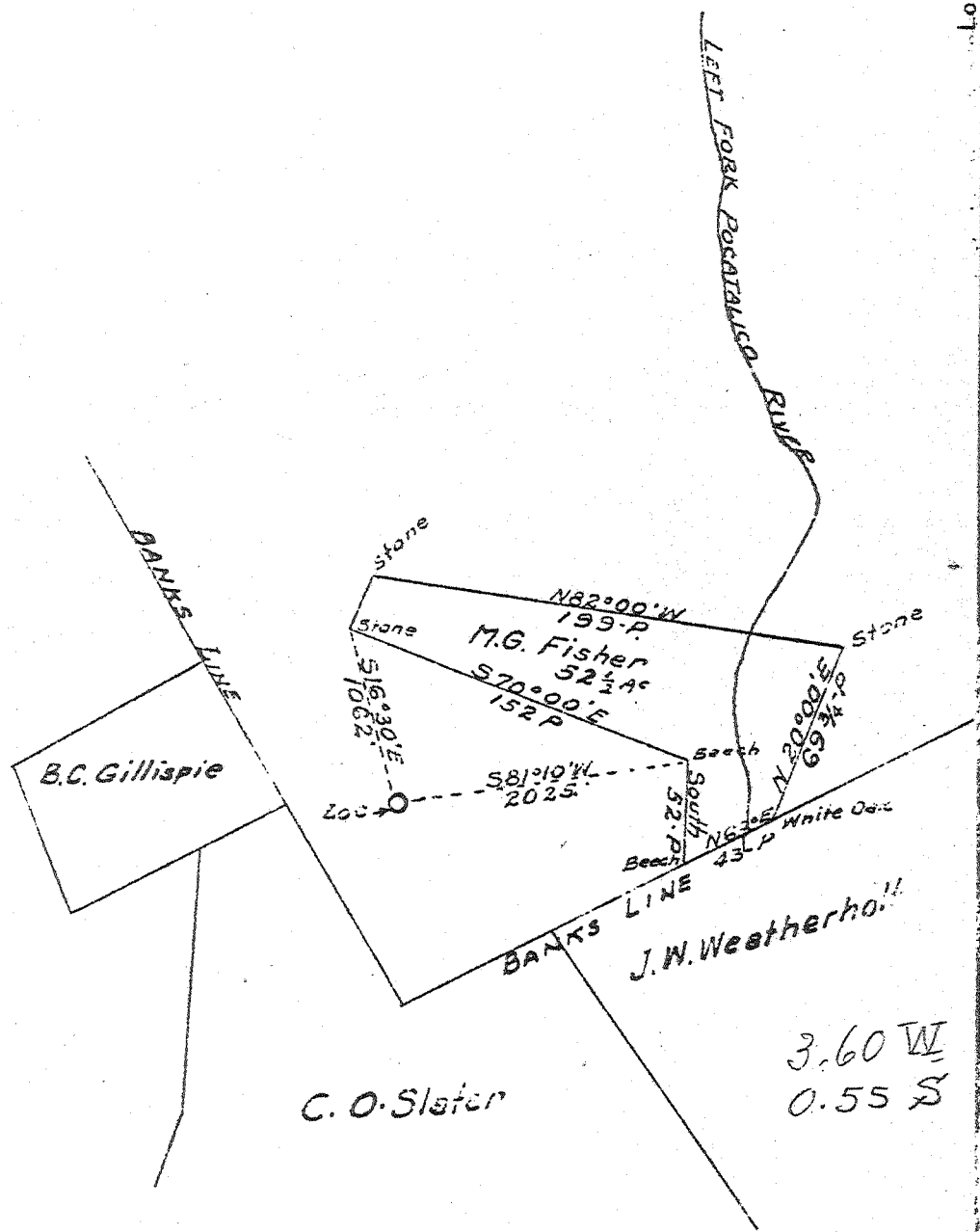

New Location  $\oplus$   
 Drill Deeper  
 Abandonment

Company GODFREY L. CABOT INC  
 Address 600 UNION BLDG. CHARLESTON WVA  
 Farm THE PUTNAM COMPANY  
Part of 2,200 Ac  
 Tract \_\_\_\_\_ Acres \_\_\_\_\_ Lease No. 3-464  
 Well (Farm) No. 7 Serial No. 942  
 Elevation (Spirit Level) 840 Bar. 944.36  
 Quadrangle KENNA 50  
 County JACKSON District RIPLEY  
 Engineer Charles M. Starn  
 Engineer's Registration No. 975  
 File No. \_\_\_\_\_ Drawing No. \_\_\_\_\_  
 Date MARCH 20 1940 Scale 1" = 1320'

STATE OF WEST VIRGINIA  
 DEPARTMENT OF MINES  
 OIL AND GAS DIVISION  
 CHARLESTON

WELL LOCATION MAP  
 FILE NO. JAC-77

$\oplus$  Denotes location of well on United States Topographic Maps, scale 1 to 62,500, latitude and longitude lines being represented by border lines as shown.  
 — Denotes one inch spaces on border line of original tracing.

6-6-192

V

WEST VIRGINIA DEPARTMENT OF MINES  
OIL & GAS DIVISION  
W E L L R E C O R D

Permit No. Jac-77  
Kenna S. W. Quad.

Gas Well

		CASING & TUBING
Company	Godfrey L. Cabot, Inc.	10 812 143
Address	Charleston, W. Va.	8 2150 2150
Farm	Putnam Company ACRES -	7 2140
Well No.	7 - Serial 942 ELEV. 944.36	5 5138 5138
District	Riplay - Jackson County	2 5278 5278
Surface & Mineral	-	
Commenced	April 10, 1940	10x12 Casing Shoe.
Completed	Aug. 31, 1940	Csg. Shoe & 2000# Aquagel
Shot	9/10/40 - depth 5229 to 5261 - 40 cts.	Hook wall packer used.
Open Flow	Before shot 1,590,000 c.f. After shot 4,300,000 c.f.	Casing & Packer pulled out.
Rock Pressure	Oriskany (B.S.) 1510 lbs. 72 hrs. (A.S.) 1525 lbs. 72 hrs.	5-1/2 B.H. Packer 3500# Aquagel
Fresh Water	110 - 1 blr. per hr.	
Salt Water	1595 & 1660 - hole full	

Surface	0	5		Lime	2200	2225
Red Rock	5	15		Slate	2225	2535
Sand	15	65		Brown Shale	2535	2541
Slate	65	125	FW 110	Berea	2541	2550
Red Rock	125	145		Lime	2560	2600
Sand	145	160		Slate & Shell	2600	2920
Slate	160	178		Slate	2920	3000
Red Rock	178	210		Slate & Shells	3000	3605
Slate	210	240		Lime	3605	3640
Red Rock	240	260		Slate	3640	3690
Slate	260	300		Lime	3690	3740
Red Rock	300	330		Slate	3740	3775
Lime	330	410		Brown Shale	3775	3790
Slate	410	525		Slate & Shells	3790	4075
Red Rock	525	600		Brown Shale	4075	4100
Slate	600	615		Slate & Shell	4100	4235
Red Rock	615	675		Brown Shale	4235	4330
Slate	675	712		Slate & Shell	4330	4400
Lime	712	722		White Slate	4400	4800
Slate	722	725		Brown Shale	4800	5030
Lime	725	769		White Slate	5030	5050
Sand	769	791		Black Shale	5050	5113
Red Rock	791	795		Corniferous	5113	5222
White Slate	795	805		Oriskany	5222	5268
Lime	805	820		Black Lime	5268	5278
Slate	820	835		Total Depth		5278
Sand	835	865				
Slate	865	930				
Lime	930	960				
Sand	960	970				
Slate	970	975				
Lime	975	996				
Sand	996	1045				
Slate	1045	1130				
Lime	1130	1141				
Black Slate	1141	1150				
Lime	1150	1166				
Sand	1166	1190				
Slate	1190	1195				
Sand	1195	1245				
Slate	1245	1482				
Lime	1482	1592				
Slate	1492	1500				
Lime	1500	1580				
Salt Sand	1580	1860				
Slate	1860	1900				
Maxton Sand	1900	2030				
Big Lime	2030	2085				
Injun Sand	2085	2130				
Lime	2130	2160				
Slate & Shells	2160	2200				

Gas 2543 light show  
" 4240 light show  
" 5105 wouldn't gauge

GAUGES IN ORISKANY SAND - before shot:

8/22/40	231 M	at 5229	in 2"
8/23/40	260 M	at 5234	in 2"
8/25/40	253 M	at 5241	in 2"
8/26/40	1090 M	at 5246	in 6"
8/27/40	3449 M	at 5252	in 6"
8/28/40	2727 M	at 5260	in 6"
8/29/40	2587 M	at 5264	in 6"
8/30/40	2439 M	at 5268	in 6"
8/31/40	2112 M	at 5270	in 6"
9/ 3/40	1590 M	at 5278	in 6"

GAUGES AFTER SHOT:

9/3/40	4270 M	10 min.	after shot
"	4500 M	15 "	" "
"	4300 M	20 "	" "

415