

New Location...   
 Drill Deeper.....   
 Abandonment.....

Company H.D. Wells Oil & Gas 943  
 Address Box 1785, Charleston, W. 25326  
 Farm C.W. & S.G. STARCHER  
 Tract \_\_\_\_\_ Acres 1172 Lease No. 10496  
 Well (Farm) No. 11 Serial No. 5233  
 Elevation (Spirit Level) \_\_\_\_\_ 60  
 Quadrangle RIPLEY 15 Day 7.5  
 County JACKSON District WASHINGTON  
 Engineer E.A. Cunningham  
 Engineer's Registration No. 659  
 File No. 62-87 Drawing No. \_\_\_\_\_  
 Date MAR. 3, 1943 Scale 1" = 1320'

STATE OF WEST VIRGINIA  
 Division of Environmental Protection  
 Office of Oil & Gas  
 Notes: W.V.  
**WELL LOCATION MAP**  
H.D. Wells No. 47-035-0044-W

+ Denotes location of well on United States Topographic Maps, scale 1 to 62,500, latitude and longitude lines being represented by border lines as shown. JUL 28 1994  
 - Denotes one inch spaces on border line of original tracing.

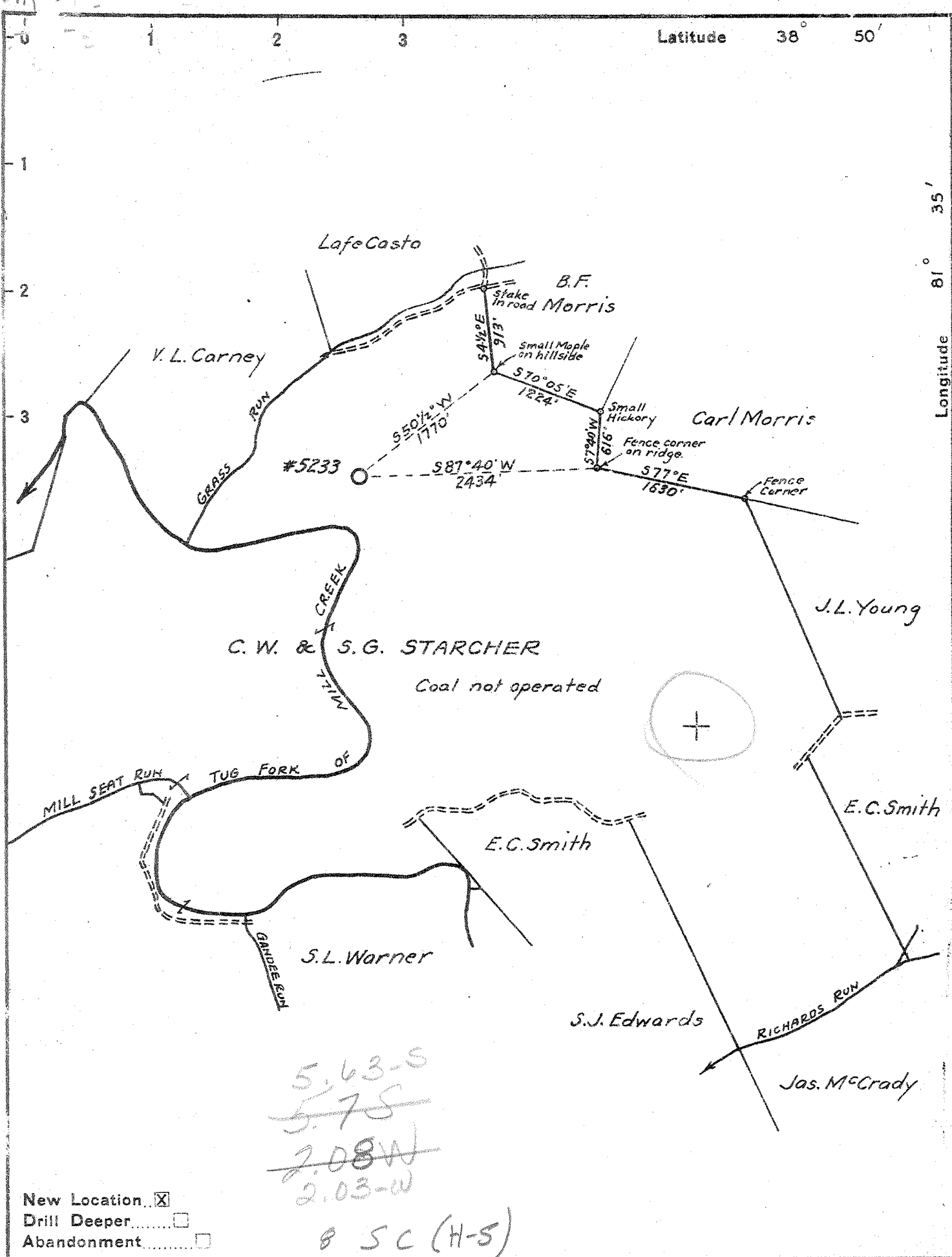

New Location   
 Drill Deeper   
 Abandonment

5.63-S  
 5.75  
 2.08W  
 2.03-W

B 5 C (H-5)

Company	UNITED FUEL GAS CO.
Address	CHARLESTON, W.VA.
Farm	C.W. & S.G. STARCHER
Tract	Acres 1172 Lease No. 10496
Well (Farm) No.	11 Serial No. 5233
Elevation (Spirit Level)	824' L
Quadrangle	RIPLEY - SC
County	JACKSON District WASHINGTON
Engineer	A. Cunningham
Engineer's Registration No.	659
File No.	62-87 Drawing No.
Date	MAR. 3, 1943 Scale 1" = 1320'

STATE OF WEST VIRGINIA  
 DEPARTMENT OF MINES  
 OIL AND GAS DIVISION  
 CHARLESTON

WELL LOCATION MAP  
 FILE NO. JAG-441

+ Denotes location of well on United States Topographic Maps, scale 1 to 62,500, latitude and longitude lines being represented by border lines as shown.  
 - Denotes one inch spaces on border line of original tracing.

Deep Well

Berea 2469-2489

Corniferous Ln 5070-5186

Orikt 5186-5219

TD 5219

Comp Feb 4, 1944

Dry in Orikt

110 Min Berea

PERMIT ISSUED 3-15-43

RECEIVED

## C. W. AND S. G. STARCHER NO. 11 (5233) W.VA.

Washington District, Jackson County, W. Va.  
 By United Fuel Gas Co., Charleston, W. Va.  
 Map Square 62-87. Drilled under permit Jac-441.  
 Completed Feb. 4, 1944.  
 Elevation, 829.10' L.  
 Bore gas, 2451-2455', 8/10 W. 2", 119 M.  
 Shale gas, 3310-3315', no test taken.  
 Criskany - salt water, 5215-5219', raised 150' in 70 hrs.  
 Criskany gas show at 5209', not enough to test.  
 Completion reported to Dept. of Mines (filed) Feb. 14, 1944.  
 Record to ROT from Mrs. Griffith June 9, 1944.

	Top.	Bottom.
Surface	0	10
Red rock	10	180
Slate	180	190
Sand	190	260
Red rock	260	280
White slate	280	312
Sand	312	332
Red rock	332	365
Sand	365	400
Red rock	400	420
Slate	420	438
Red rock	438	476
White slate	476	500
Lime shells	500	545
Slate	545	595
Sand	595	664
Red rock	664	677
Sand	677	695
Red rock	695	710
Sand	710	738
Red rock	738	766
Lime	766	780
Red rock	780	803
Slate	803	812
Lime	812	870
Sand	870	898
Slate and shells	898	965
White sand	965	995
Slate	995	1028
Sand	1028	1153
Blue slate	1153	1170
Lime	1170	1176
Sand	1176	1198
Slate	1198	1201
Sand	1201	1242
Coal	1242	1249
Sand	1249	1346
Slate and shells	1346	1365
Sand	1365	1410
Slate and shells	1410	1440
Sand	1440	1471
Slate and shells	1471	1558
Sand	1558	1820

(OVER)

	Top.	Bottom.
Slate	1820	- 1822
✓ Big line	1822	- 1961
White slate	1961	- 1984
✓ Big Injun Sand	1984	- 2048
White slate	2048	- 2052
Black line	2052	- 2057
Slate	2067	- 2072
Black line	2072	- 2110
Slate and shells	2110	- 2432
✓ Brown shale	2432	- 2449
✓ Berea Sand	2449	- 2469 (69-891)
Slate and shells	2469	- 3310
Slate and shells	3315	- 3960
Brown shale	3960	- 4300
White slate	4300	- 4748
Brown shale	4748	- 5070
✓ Fossiliferous line	5070	- 5186
✓ Criskany Sand	5186	- 5219
Total depth (SLM)		5219

475

5070	5186
829	829
<u>4241</u>	<u>4357</u>

State of West Virginia  
Division of Environmental Protection  
Section of Oil and Gas

Well Operator's Report of Well Work

Farm name: MORRIS, DELPHA Operator Well No.: STARCHER #5233

LOCATION: Elevation: 829.10 Quadrangle: GAY

District: RIPLEY County: JACKSON  
Latitude: 14480 Feet South of 38 Deg. 47Min. 30 Sec.  
Longitude 10590 Feet West of 81 Deg. 35 Min. 0 Sec.

Company: WELLS, H. D. OIL & GAS EX  
POST OFFICE BOX 1785  
CHARLESTON, WV 25326-0000

Agent: HARLEY D. WELLS

Inspector: GLEN ROBINSON  
Permit Issued: 07/27/94  
Well work Commenced: 9/21/94  
Well work Completed: 9/23/94  
Verbal Plugging  
Permission granted on:  
Rotary X Cable \_\_\_\_\_ Rig  
Total Depth (feet) 3900  
Fresh water depths (ft) CASED  
Salt water depths (ft) CASED

Is coal being mined in area (Y/N)? N  
Coal Depths (ft): N/A

Casing & Tubing Size	Used in Drilling	Left in Well	Cement Fill Up Cu. Ft.
2 3/8"	3822'	3822'	

OPEN FLOW DATA

Producing formation DEVONIAN SHALE Pay zone depth (ft) 4748-5070  
Gas: Initial open flow SHOW MCF/d Oil: Initial open flow 0 Bbl/d  
Final open flow 60 MCF/d Final open flow 0 Bbl/d  
Time of open flow between initial and final tests 72 Hours  
Static rock Pressure 101 psig (surface pressure) after 72 Hours

Second producing formation BEREA Pay zone depth (ft) 2449-2469  
Gas: Initial open flow SHOW MCF/d Oil: Initial open flow 0 Bbl/d  
Final open flow 60 MCF/d Final open flow 0 Bbl/d  
Time of open flow between initial and final tests 72 Hours  
Static rock Pressure 60 psig (surface pressure) after 72 Hours

NOTE: ON BACK OF THIS FORM PUT THE FOLLOWING: 1). DETAILS OF PERFORATED INTERVALS, FRACTURING OR STIMULATING, PHYSICAL CHANGE, ETC. 2). THE WELL LOG WHICH IS A SYSTEMATIC DETAILED GEOLOGICAL RECORD OF ALL FORMATIONS, INCLUDING COAL ENCOUNTERED BY THE WELLBORE.

For: WELLS, H. D. OIL & GAS EXP. & DEV. INC.  
By: [Signature]  
Date: 10/18/94

DRILLED OUT PLUG AT 2489' TO TOTAL DEPTH OF 3900'.  
NATURAL FLOW OF GAS ST 3350' AND 3325'.  
NO STIMULATION; OPEN HOLE  
RAN 3822' OF 2 3/8" TUBING.

cut 7" At  
4535  
BRIDGE HOLE,  
2489

JAC-441  
JAC-441

U-5233

C. W. & S. G. Starcher  
United Fuel Gas Company  
Washington District, Jackson County, W. Va.  
Map Squares 62-87  
Commenced  
Completed 2-4-44  
Elevation 8291.0 L

CASING

13-3/8"	740'
10-3/4"	1172'
8-5/8"	2100'
7"	5094'

Surface	0	10
Red Rock	10	180
Slate	180	190
Sand	190	260
Red Rock	260	280
White Slate	280	312
Sand	312	332
Red Rock	332	365
Sand	365	400
Red Rock	400	420
Slate	420	438
Red Rock	438	476
White Slate	476	500
Lime Shells	500	545
Slate	545	595
Sand	595	664
Red Rock	664	677
Sand	677	695
Red Rock	695	710
Sand	710	738
Red Rock	738	766
Lime	766	780
Red Rock	780	803
Slate	803	812
Lime	812	870
Sand	870	892
Slate & Shells	898	965
White Sand	965	995
Slate	995	1028
Sand	1028	1153
Blue Slate	1153	1170
Lime	1170	1176
Sand	1176	1198
Slate	1198	1201
Sand	1201	1242
Coal	1242	1249
Sand	1249	1346
Slate & Shells	1346	1365
Sand	1365	1410
Slate & Shells	1410	1440
Sand	1440	1471
Slate & Shells	1471	1558
Sand	1558	1820
Slate	1820	1822
Sand	1822	1981
White Sand	1981	1984
White Sand	1984	2048
White Slate	2048	2052
Black Lime	2052	2057
Slate	2057	2072

Berea gas 2451-2455 8/10 W 2" 119 M.  
Shale gas 3310-3315; no test taken.  
Oriskany - Salt water 5215-5219, raised  
150' in 70 hrs.  
Oriskany gas show @ 5209, not enough to  
test.

Black Lime	2072-2110
Slate & Shells	2110-2432
Brown Shale	2432-2449
Berea Sand	2449-2469
Slate & Shells	2469-3310
Slate & Shells	3315-3960
Brown Shale	3960-4300
White Slate	4300-4748
Brown Shale	4748-5070
Corniferous Lime	5072-5186
Oriskany Sand	5186-5219
T.D. 5219 SLW	

5094



2451  
2374  
77

dup of plan  
2465



*rev 7/19/94*

035-0441-w

Issued 07/27/94

Expires 07/27/96

STATE OF WEST VIRGINIA  
DEPARTMENT OF ENERGY, DIVISION OF OIL AND GAS  
WELL WORK PERMIT APPLICATION

1) Well Operator: H. D. WELLS OIL & GAS EXP. & DEV., INC. <sup>943</sup> 5290<sup>0</sup> (3) 362

Operator's Well Number: STARCHER #5233 3) Elevation: 829.10

Well type: (a) Oil \_\_\_ / or Gas X /

(b) If Gas: Production \_\_\_ / Underground Storage \_\_\_ /  
Deep \_\_\_ / Shallow X /

Proposed Target Formation(s): BROWN SHALE 441

Proposed Total Depth: 4400 feet

7) Approximate fresh water strata depths: 180'

8) Approximate salt water depths: 1670'

9) Approximate coal seam depths: NONE

10) Does land contain coal seams tributary to active mine? Yes \_\_\_ / No X /

11) Proposed Well Work: DRILL OUT PLUG AT 2469'; CLEAN OUT HOLE TO 4400';  
RUN 4 1/2" AND CEMENT

12)

CASING AND TUBING PROGRAM

TYPE	SPECIFICATIONS		FOOTAGE INTERVALS		CEMENT	
	Size	Grade	Weight per ft.	For drilling	Left in well	Fill-up (cu. ft.)
Conductor	13 3/8"			740'	740'	
Fresh Water	10 3/4"			1172'	1172'	
Coal						
Intermediate	8 5/8"			2100'	2100'	
Production	4 1/2"			4,400'	4,400'	2,000'-38CSR-11
Tubing						
Liners						

*Existing from Well Records*

*38CSR 18-11.7*

PACKERS : Kind \_\_\_\_\_  
Sizes \_\_\_\_\_  
Depths set \_\_\_\_\_

For Division of Oil and Gas Use Only

Fee(s) paid:  Well Work Permit  Reclamation Fund  WPCP  
Plat  WW-9  WW-2B  Bond Blanket  Agent

*2519  
25*

(Type)

**RECEIVED**  
OFFICE OF OIL AND GAS

JUL 19 1994

1) Date: JULY 7, 1994  
2) Operator's well number  
STARCHER #5233  
3) API Well No: 47 - 035 - 0441-W  
State - County - Permit

WV Division of Environmental Protection  
STATE OF WEST VIRGINIA  
DEPARTMENT OF ENERGY, DIVISION OF OIL AND GAS

NOTICE AND APPLICATION FOR A WELL WORK PERMIT

- |  |   |
|--|---|
| <p>4) Surface Owner(s) to be served:</p> <p>(a) Name <u>DELPHA MORRIS</u><br/>Address <u>BOX 7</u><br/><u>STATTS MILLS, WV 25279</u></p> <p>(b) Name _____<br/>Address _____</p> <p>(c) Name _____<br/>Address _____</p> | <p>5) (a) Coal Operator:</p> <p>Name <u>N/A</u><br/>Address _____</p> <p>(b) Coal Owner(s) with Declaration</p> <p>Name <u>N/A</u><br/>Address _____</p> <p>Name _____<br/>Address _____</p> <p>(c) Coal Lessee with Declaration</p> <p>Name <u>N/A</u><br/>Address _____</p> |
| <p>6) Inspector <u>GLEN P. ROBINSON</u><br/>Address <u>BOX 1</u><br/><u>BELLEVILLE, WV 26133</u><br/>Telephone (304)- <u>863-8766</u></p>  |   |

TO THE PERSON(S) NAMED ABOVE TAKE NOTICE THAT:

\_\_\_\_\_ Included is the lease or leases or other continuing contract or contracts by which I hold the right to extract oil and gas OR

X Included is the information required by Chapter 22B, Article 1, Section 8(d) of the Code of West Virginia (see page 2)

I certify that as required under Chapter 22B of the West Virginia Code I have served copies of this notice and application, a location plat, and accompanying documents pages 1 through \_\_\_\_\_ on the above named parties, by:

- X Personal Service (Affidavit attached)
- \_\_\_\_\_ Certified Mail (Postmarked postal receipt attached)
- \_\_\_\_\_ Publication (Notice of Publication attached)

I have read and understand Chapter 22B and 38 CSR 11-18, and I agree to the terms and conditions of any permit issued under this application.

I certify under penalty of law that I have personally examined and am familiar with the information submitted on this application form and all attachments, and that based on my inquiry of those individuals immediately responsible for obtaining the information, I believe that the information is true, accurate, and complete.

I am aware that there are significant penalties for submitting false information, including the possibility of fine and imprisonment.

Well Operator H. D. WELLS OIL & GAS EXP. & DEV., INC.  
By: [Signature]  
Its: PRESIDENT  
Address P.O. BOX 1785  
CHARLESTON, WV 25326  
Telephone (304) 346-2829

Subscribed and sworn before me this 7<sup>th</sup> day of July, 1994

[Signature] Notary Public  
My commission expires November 20, 1995