

**Notes:**  
 This Map is For  
 Well Location Only &  
 Does Not Represent  
 A Complete Property Survey.

NO HOUSES OR WATER WELLS WITHIN 200'

FB 2670 PG. 31-32

(+) DENOTES LOCATION OF WELL ON UNITED STATES TOPOGRAPHIC MAPS (7 1/2')

FILE NO. \_\_\_\_\_  
 DRAWING NO. 7295  
 SCALE 1" = 200'  
 MINIMUM DEGREE OF  
 ACCURACY 1/200  
 PROVEN SOURCE OF  
 ELEVATION USGS BM "R 103  
1956" ELEV. 612.24

I THE UNDERSIGNED, HEREBY CERTIFY THAT  
 THIS PLAT IS CORRECT TO THE BEST OF MY  
 KNOWLEDGE AND BELIEF AND SHOWS ALL THE  
 INFORMATION REQUIRED BY LAW AND THE REGU-  
 LATIONS ISSUED AND PRESCRIBED BY THE DEPART-  
 MENT OF ENERGY.

(SIGNED) [Signature]  
 R.P.E. \_\_\_\_\_ L.L.S. 798

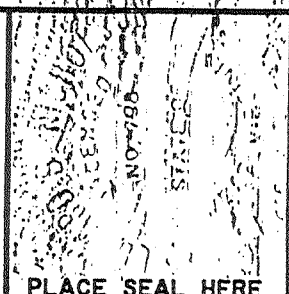

**STATE OF WEST VIRGINIA**  
 DIVISION OF ENVIRONMENTAL  
 PROTECTION  
 SECTION OF OIL & GAS



DATE NOVEMBER 15, 2002  
 OPERATOR'S WELL NO. 7295  
 API WELL NO. \_\_\_\_\_

WELL TYPE: OIL \_\_\_\_\_ GAS X LIQUID INJECTION \_\_\_\_\_ WASTE DISPOSAL \_\_\_\_\_  
 (IF "GAS,") PRODUCTION \_\_\_\_\_ STORAGE X DEEP \_\_\_\_\_ SHALLOW \_\_\_\_\_  
 LOCATION: ELEVATION 669 WATER SHED MUD RUN OF SANDY CREEK  
 DISTRICT RAVENSWOOD COUNTY JACKSON  
 QUADRANGLE SANDYVILLE COORDINATES LAT: 38°52'55" LONG: 81°41'25"  
 SURFACE OWNER VIRGIL & GWENDOLYN ASHBY ACREAGE 5.37  
 OIL & GAS ROYALTY OWNER ALTA CORINNE MASEK LEASE ACREAGE 37.5  
 COAL OWNER \_\_\_\_\_ LEASE NO. 1052783

PROPOSED WORK: DRILL \_\_\_\_\_ CONVERT \_\_\_\_\_ DRILL DEEPER \_\_\_\_\_ REDRILL \_\_\_\_\_ FRACTURE OR  
 STIMULATE \_\_\_\_\_ PLUG OFF OLD FORMATION \_\_\_\_\_ PERFORATE NEW  
 FORMATION \_\_\_\_\_ OTHER PHYSICAL CHANGE IN WELL (SPECIFY) Storage Recondition

PLUG AND ABANDON \_\_\_\_\_ CLEAN OUT AND REPLUG \_\_\_\_\_  
 TARGET FORMATION \_\_\_\_\_ ESTIMATED DEPTH \_\_\_\_\_  
 WELL OPERATOR COLUMBIA GAS TRANSMISSION CORP DESIGNATED AGENT PAUL AMICK  
 ADDRESS PO Box 1273, Charleston, WV 25325-1273 ADDRESS PO Box 1273, Charleston, WV 25325-1273

10010418 EIGHTEEN  
 1008121  
 COUNTY NAME JAC  
 PERMIT 04875

DEEP WELL 9-0 ELK-POCA (SISSONVILLE) (192)

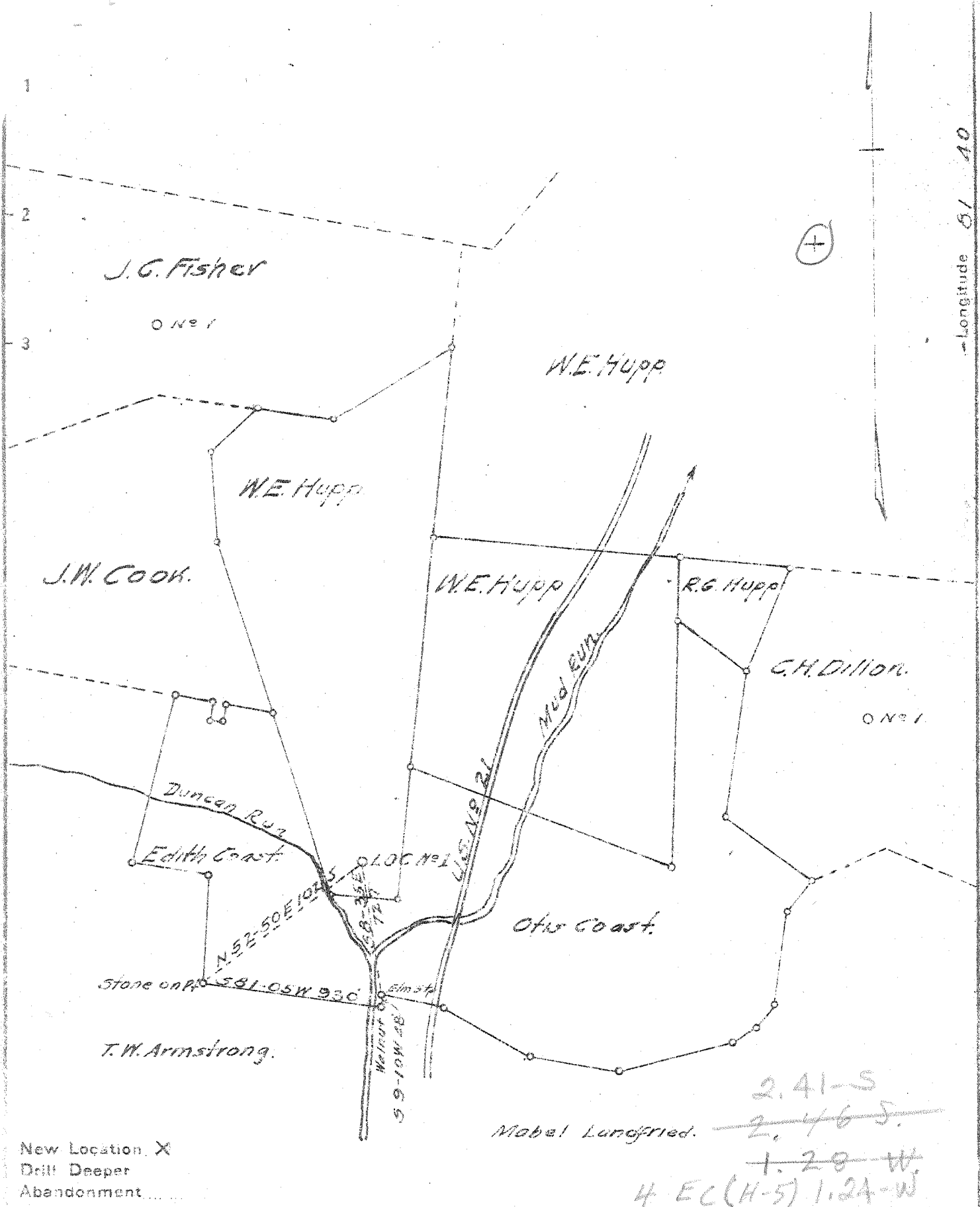

New Location X  
 Drill Deeper  
 Abandonment

2.41-S  
~~2.46-S~~  
~~1.28-W~~  
 4 EC(H-5) 1.24-W

Company United Carbon Co.  
 Address Charleston, W.V.A.  
 Farm W.E. Hupp et al.  
 Tract \_\_\_\_\_ Acres 186 Lease No. 3559  
 Well (Farm) No. ONE Serial No. 1293  
 Elevation (Spirit Level) 682 (Ground)  
 Quadrangle Ripley NW WC  
 County Jackson District Ravenwood  
 Engineer H. J. Smith  
 Engineer's Registration No. 710  
 File No. \_\_\_\_\_ Drawing No. \_\_\_\_\_  
 Date Apr 20-1945 Scale 1:660

STATE OF WEST VIRGINIA  
 DEPARTMENT OF MINES  
 OIL AND GAS DIVISION  
 CHARLESTON

WELL LOCATION MAP  
 FILE NO. JAC-487

+ Denotes location of well on United States Topographic Maps, scale 1:62,500 latitude and longitude lines being represented by border lines as shown.

Denotes one inch spaces on border line of tracing.

No Sample 6 to Mr. Deep Well

WEST VIRGINIA DEPARTMENT OF MINES  
OIL & GAS DIVISION  
W E L L R E C O R D

Permit No. Jac 487  
Ripley Quad.

Gas Well  
CASING & TUBING

Company	United Carbon Company			
Address	Box 1913, Charleston 27, W.Va.			
Farm	W.E. Hupp et al Acres 186	16	16	16
Location	Mud Run of Sandy Creek	13 5/8	590	Same
Well No.	1 ( 1293) Elev. 675. 3	10 1/2	1138'9	0
District	Ravenswood Jackson County	8 5/8	2004	Same
Surface		7 OD	4757	Same
Mineral	W.E. Hupp et al, Sandyville, W.Va.			
Commenced	May 26, 1945	2 3/8	4851	4851
Completed	Aug. 11, 1945			
Not shot				
Volume	Gas Well			Casing cemented: 8 5/8
Rock Pressure	1740lbs. 24 hrs.			1258'
Fresh Water	250			7" 4657'
Salt Water	1265 H.F.			

Red Rock	0	60
Shell	60	70
Red Rock	70	110
Slate Blue	110	130
Shell	130	150
Red Rock	150	200
Slate Blue	200	230
Sand	230	290
Slate Blue	290	300
Red Rock	300	315
Shell	315	340
Red Rock	340	350
Sand Shell	350	375
Red Rock	375	400
Slate	400	420
Red Rock	420	475
Sand <i>1 1/2 P.H. Sand?</i>	475	545
Slate Black	545	550
Lime Sandy	550	590
Slate	590	615
Sand <i>1 1/2 P.H. Sand?</i>	615	700
Slate Blue	700	710
Red Rock	710	725
Sand	725	740
Red Rock	740	800
Slate Shells	800	975
Slate Black	975	990
Slate Shell	990	1075
Lime Shell	1075	1090
Slate Shell	1090	1240
Slate Black	1240	1252
Lime	1252	1262
Sand	1262	1325
Slate & Shells	1325	1360
Sand	1360	1405
Slate	1405	1450
Sand	1450	1485
Slate	1485	1570
Salt Sand	1570	1700
Big Lime	1700	1855
Slate White <i>340</i>	1855	1878
Injun Sand	1878	1994
Slate Shell	1994	2330
Shale Brown	2330	2340
Berea Shell	2340	2350
Slate & Shells	2350	2600
Shale Brown <i>441</i>	2600	3650
Slate & Shells	3650	3860
Shale Brown	3860	4080
Slate White	4080	4520
Shale Brown	4520	4745
Corniferous Lime <i>463</i>	4745	4854
Oriskany Sand	4854	4871
TOTAL DEPTH <i>475</i>		4871

4745 4854  
625 675  

---

4070 4179

WR-35  
Rev (5-01)

DATE: 3/9/04  
API #: 47-035-00487

State of West Virginia  
Department of Environmental Protection  
Office of Oil and Gas

*mt*

Well Operator's Report of Well Work

Farm name: Arthur Aylers

Operator Well No.: Ripley #7295

LOCATION: Elevation: 669'

Quadrangle: Sandyville, WV

District: Ravenswood County: Jackson  
Latitude: 72800 Feet South of 38 Deg. 52 Min. 55 Sec.  
Longitude: 6500 Feet West of 81 Deg. 41 Min. 25 Sec.

Company: Columbia Gas Transmission

	Casing & Tubing	Used in drilling	Left in well	Cement fill up Cu. Ft.
Address: RR 2 Box 138				
Sandyville, WV 25275				
Agent: Paul Amick				
Inspector: Larry Parrish				
Date Permit Issued: 12/9/03				
Date Well Work Commenced: 12/17/03				
Date Well Work Completed: 2/19/04				
Verbal Plugging:				
Date Permission granted on:				
Rotary Cable Rig				
Total Depth (feet): 4871				
Fresh Water Depth (ft.):				
Salt Water Depth (ft.):				
Is coal being mined in area (N/Y)? No				
Coal Depths (ft.):				

RECEIVED  
Office of Oil & Gas  
Office of Chief  
MAR 15 2004  
WV Department of Environmental Protection

OPEN FLOW DATA

Producing formation **Oriskany Sandstone** Pay zone depth (ft) **4851' to 4871'**  
Gas: Initial open flow N/A Gas Storage MCF/d Oil: Initial open flow N/A Gas Storage Bbl/d  
Final open flow N/A Gas Storage MCF/d Final open flow N/A Gas Storage Bbl/d  
Time of open flow between initial and final tests N/A Gas Storage Hours  
Static rock Pressure N/A Gas Storage psig (surface pressure) after N/A Gas Storage Hours

Second producing formation \_\_\_\_\_ Pay zone depth (ft) \_\_\_\_\_  
Gas: Initial open flow \_\_\_\_\_ MCF/d Oil: Initial open flow \_\_\_\_\_ Bbl/d  
Final open flow \_\_\_\_\_ MCF/d Final open flow \_\_\_\_\_ Bbl/d  
Time of open flow between initial and final tests \_\_\_\_\_ Hours  
Static rock Pressure \_\_\_\_\_ psig (surface pressure) after \_\_\_\_\_ Hours

NOTE: ON BACK OF THIS FORM PUT THE FOLLOWING: 1). DETAILS OF PERFORATED INTERVALS, FRACTURING OR STIMULATING, PHYSICAL CHANGE, ETC. 2). THE WELL LOG WHICH IS A SYSTEMATIC DETAILED GEOLOGICAL RECORD OF ALL FORMATIONS, INCLUDING COAL ENCOUNTERED BY THE WELLBORE.

Signed: *John V. McCallister*  
By: John V. McCallister  
Date: 3/9/04

JAC 0487

APR 30 2004

12/23/03 - Hydrofractured Oriskany Sandstone using;  
1000 gal 28% Hcl  
428 bbls H2O  
28,846# 20/40 sand  
173,000 scf N2  
ATP 3600 psig  
ATR 14 bpm

No earthen pit constructed.  
All fluids hauled to L.A.D. in Wheeling, WV