

New Location
 Drill Deeper
 Abandonment Issued 5-3-69

Map Sh 43W S40W69 FB 922 P-3-4

Company Consolidated Gas Supply Corp.
Hope Natural Gas Co.
 Address Clarksburg, W.Va.
 Farm C.W. Baier
 Tract _____ Acres 162 Lease No. 50139
 Well (Farm) No. _____ Serial No. 9332
 Elevation (Spirit Level) 968'
 Quadrangle Ravenswood
 County Jackson District Union
 Engineer W.M. Bowers
 Engineer's Registration No. 900
 File No. _____ Drawing No. _____
 Date 1-11-49 Scale 1"=40P

STATE OF WEST VIRGINIA
 DEPARTMENT OF MINES
 OIL AND GAS DIVISION
 CHARLESTON

WELL LOCATION MAP
 FILE NO. JAC-654-20.-P

+ Denotes location of well on United States Topographic Maps, scale 1 to 62,500, latitude and longitude lines being represented by border lines as shown.

- Denotes one inch spaces on border line of original tracing.

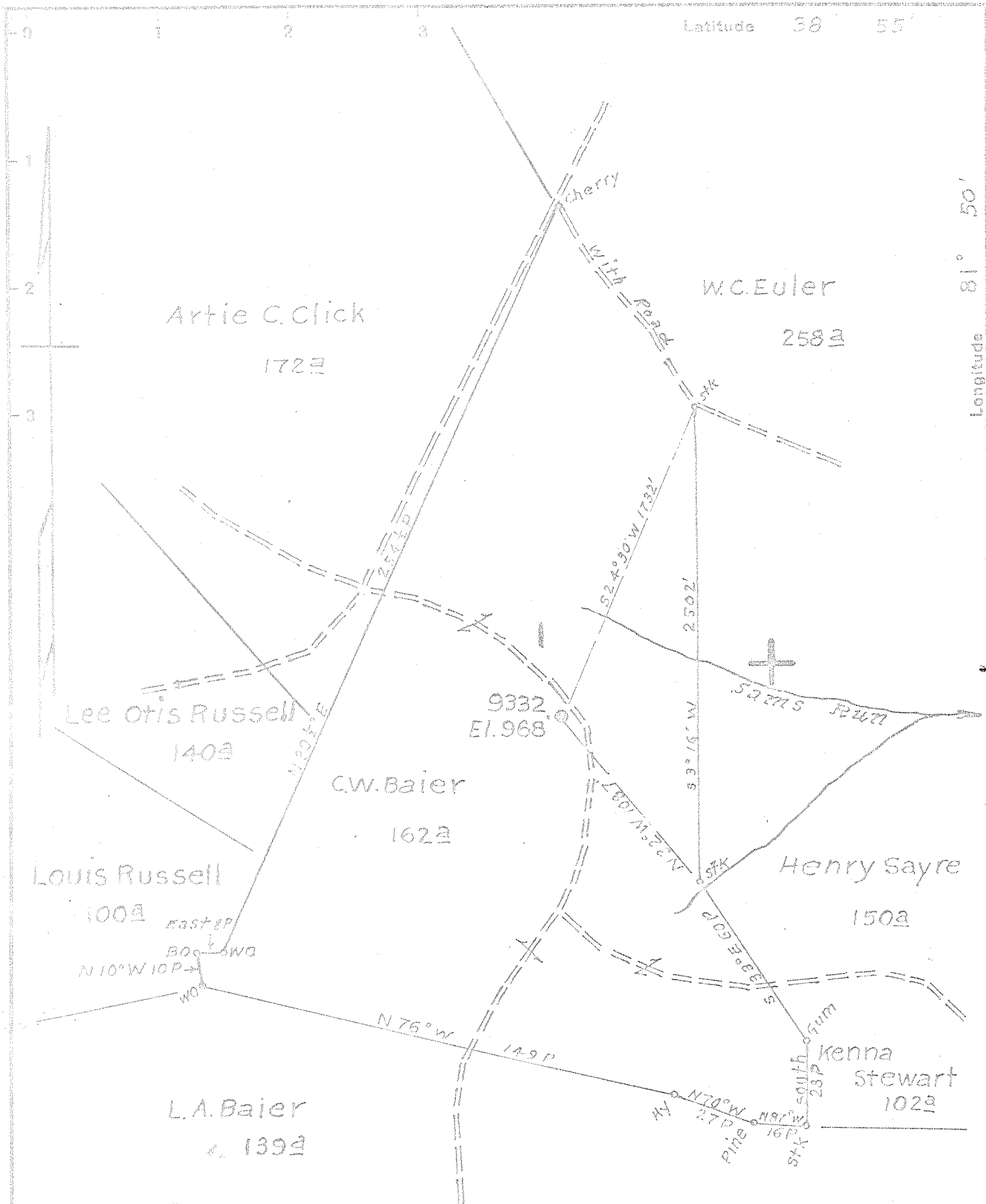

New Location
 Drill Deeper 2-24-69
 Abandonment

Map Sh 43W S40 W69 FB 922 P-3-4

Company Consolidated Gas Supply Corp.
Hopewell Natural Gas Co.
 Address Clarksburg, W.Va.
 Farm C.W. Baier
 Tract _____ Acres 162 Lease No. 50139
 Well (Farm) No. _____ Serial No. 9332
 Elevation (Spirit Level) 968'
 Quadrangle Ravenswood C
 County Jackson District Union
 Engineer W.M. Bowers
 Engineer's Registration No. 700
 File No. _____ Drawing No. _____
 Date 1-11-49 Scale 1" = 200'

STATE OF WEST VIRGINIA
 DEPARTMENT OF MINES
 OIL AND GAS DIVISION
 CHARLESTON

WELL LOCATION MAP
 FILE NO. JAC-654-00

+ Denotes location of well on United States Topographic Maps, scale 1 to 62,500, latitude and longitude lines being represented by border lines as shown.
 - Denotes one-inch spaces on border line of original tracing.

WEST VIRGINIA DEPARTMENT OF MINES
OIL & GAS DIVISION
W E L L R E C O R D

Permit No. Jac 654		Gas Well
Ravenswood Quad.		CASING & TUBING
Company	Hope Natural Gas Company	
Address	445 West Main St., Clarksburg, W.Va.	
Farm	C.W. Baier Acres 162	16 20 20
Location		13 497 497
Well No.	9332 Elev. 968	10 1178 1178
District	Union Jackson County	8 1/2 2126 2126
Surface		6 5/8 3203 3203
Mineral		
Commenced	Nov. 14, 1949	Casing cemented:
Completed	Jan. 5, 1950	10" 12 bags gol.
Date shot	1-6-50 Depth 3760 to 3961	8" 21 bags gol.
	with 2000 lbs. gelatin	7" 28 bags cement
Volume	1,309,000 C.F.	8 bags gol.
Rock Pressure	790 lbs. --- hrs.	
Fresh Water	None	No coal recorded
Salt Water	1370'; 1790' HF	

Sand	0	30	Lime		2111	2235
Red Rock	30	60	Slate Shell		2255	2393
Sand	60	80	Brown Shale		2393	2410
Slate	80	90	Berea		2410	2430
Red Rock	90	185	Slate		2430	2450
Lime	185	205	Lime		2450	2462
Red Rock	205	260	Slate Shell		2462	3520
Sand	260	280	Brown Shale	-441	3520	3607
Red Rock	280	315	Slate Shell		3607	3760
Sand	315	330	Brown Shale		3760	3950
Red Rock	330	375	Total depth			3961
Sand	375	405				
Red Rock	405	420	Gas	3877, 87, 97, 3910-3920		
Sand	420	430				
Slate	430	440				
Sand	440	475				
Red Rock	475	485				
Sand	485	505				
Slate	505	515				
Red Rock	515	520				
Slate	520	540				
Lime	540	570				
Slate	570	585				
Sand	585	595				
Red Rock	595	623				
Slate Shell	623	740				
Red Rock	740	762				
Slate	762	810				
Red Rock	810	825				
Slate	825	965				
Red Rock	965	982				
Slate	982	992				
Red Rock	992	1000				
Sand - Big Dunford?	1000	1090				
Slate	1090	1143				
Sand	1143	1145				
Slate	1145	1164				
First Salt	1164	1303				
Slate	1304	1360				
Second Salt	1360	1450				
Slate Shell	1450	1578				
Stray	1578	1605				
Slate	1605	1660				
Third Salt	1660	1710				
Slate	1710	1735				
Maxon - 2 4th Salt?	1735	1815				
Big Lime	1815	1915				
Slate	1915	1947				
Kooner } 3rd	1947	1962				
Slate	1962	1978				
Big Injun	1978	2111				

441

1971



STATE OF WEST VIRGINIA
DEPARTMENT OF MINES
OIL AND GAS DIVISION

- Rotary
- Spudder
- Cable Tools
- Storage

Drill Deeper

Quadrangle Ravenswood

Permit No. JAC-654 DD-P

WELL RECORD

Oil or Gas Well DRY
(KIND)

Company Consolidated Gas Supply Corporation
 Address 445 W. Main St., Clarksburg, W. Va.
 Driller C. W. Baier Acres 162
 Location (waters) _____
 Well No. 9332 Elev. 968'
 District Union County Jackson
 The surface of tract is owned in fee by _____
 Address _____
 Mineral rights are owned by _____
 Address _____
 Drilling commenced 4-11-69
 Drilling completed 5-03-69
 Date Shot Not Shot From _____ To _____
 With _____
 Open Flow /10ths Water in _____ Inch
 /10ths Merc. in _____ Inch
 Volume No Gas _____ Cu. Ft.
 Rock Pressure None _____ lbs. _____ hrs.
 _____ None _____ bbls., 1st 24 hrs.
 WELL ACIDIZED (DETAILS) No
 WELL FRACTURED (DETAILS) No

Casing and Tubing	Used in Drilling	Left in Well	Packers
Size			Kind of Packer
16			
13			
10	3203	1049	Size of
8 1/4	2126	2126	
6 5/8			Depth set
5 3/16	4412	1015	
4 1/2			
3			Perf. top
2			Perf. bottom
Liners Used			Perf. top
			Perf. bottom

Attach copy of cementing record. None
 CASING CEMENTED _____ SIZE _____ No. Ft. _____ Date _____
 Amount of cement used (bags) _____
 Name of Service Co. _____
 COAL WAS ENCOUNTERED AT None FEET _____ INCHES _____
 FEET _____ INCHES FEET _____ INCHES
 FEET _____ INCHES FEET _____ INCHES
 RESULT AFTER TREATMENT (Initial open Flow or bbls.) _____
 ROCK PRESSURE AFTER TREATMENT _____ HOURS _____
 Fresh Water None _____ Feet _____ Salt Water None _____ Feet _____
 Producing Sand _____ Depth _____

Formation	Color	Hard or Soft	Top	Bottom	Oil, Gas or Water	Depth	Remarks
Started drlg. @				3961'			
Brown Shale			3520'	4455'	No Gas or Water		
Ferrous Lime	Onondaga		4455'	4466'			
Total Depth Drlg.			463	4466'			
Plugged and abandoned account of bad hole.				4455 968 3487			
			4466 3961 505	Sootage dried also expl. sootage			

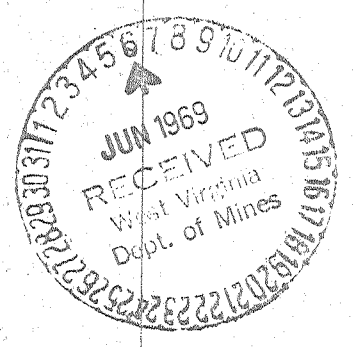

Consolidated Gas Supply Corporation
445 West Main Street
Clarksburg, West Virginia 26301
June 5, 1969