

Minimum Error of Closure 1' IN 200'

Source of Elevation ABUTMENT R.R. BRIDE LITTLE SANDY 584.00

I, the undersigned, hereby certify that this map is correct to the best of my knowledge and belief and shows all the information required by paragraph 6 of the rules and regulations of the oil and gas section of the mining laws of West Virginia.

Fracture
 New Location
 Drill Deeper
 Abandonment

Signed: L. J. Dyer
 Squares: N B E W

Map No. Issued 12-30-69

Transferred to R & S Gas & Oil, Inc., from Pargas, Inc., 7-8-69--Transferred by

Company R & S GAS, INC. OCTOBER 8, 1969

Address BOX 186, BIPLY, WEST VIRGINIA

Farm BERNICE M. DEEM

Tract Acres 83 Lease No. _____

Well (Farm) No. 1 Serial No. _____

Elevation (Spirit Level) 572.83

Quadrangle RAVENSWOOD NE

County JACKSON District GRANT

Engineer L. J. Dyer

Engineer's Registration No. 804

File No. _____ Drawing No. _____

Date 1-3-69 Scale 1" = 80 FEET

STATE OF WEST VIRGINIA
 DEPARTMENT OF MINES
 OIL AND GAS DIVISION
 CHARLESTON

WELL LOCATION MAP
 FILE NO. JAC-1177-P

+ Denotes location of well on United States Topographic Maps, scale 1 to 62,500, latitude and longitude lines being represented by border lines as shown.

- Denotes one inch spaces on border line of original tracing.

Deep Well

5/11/69

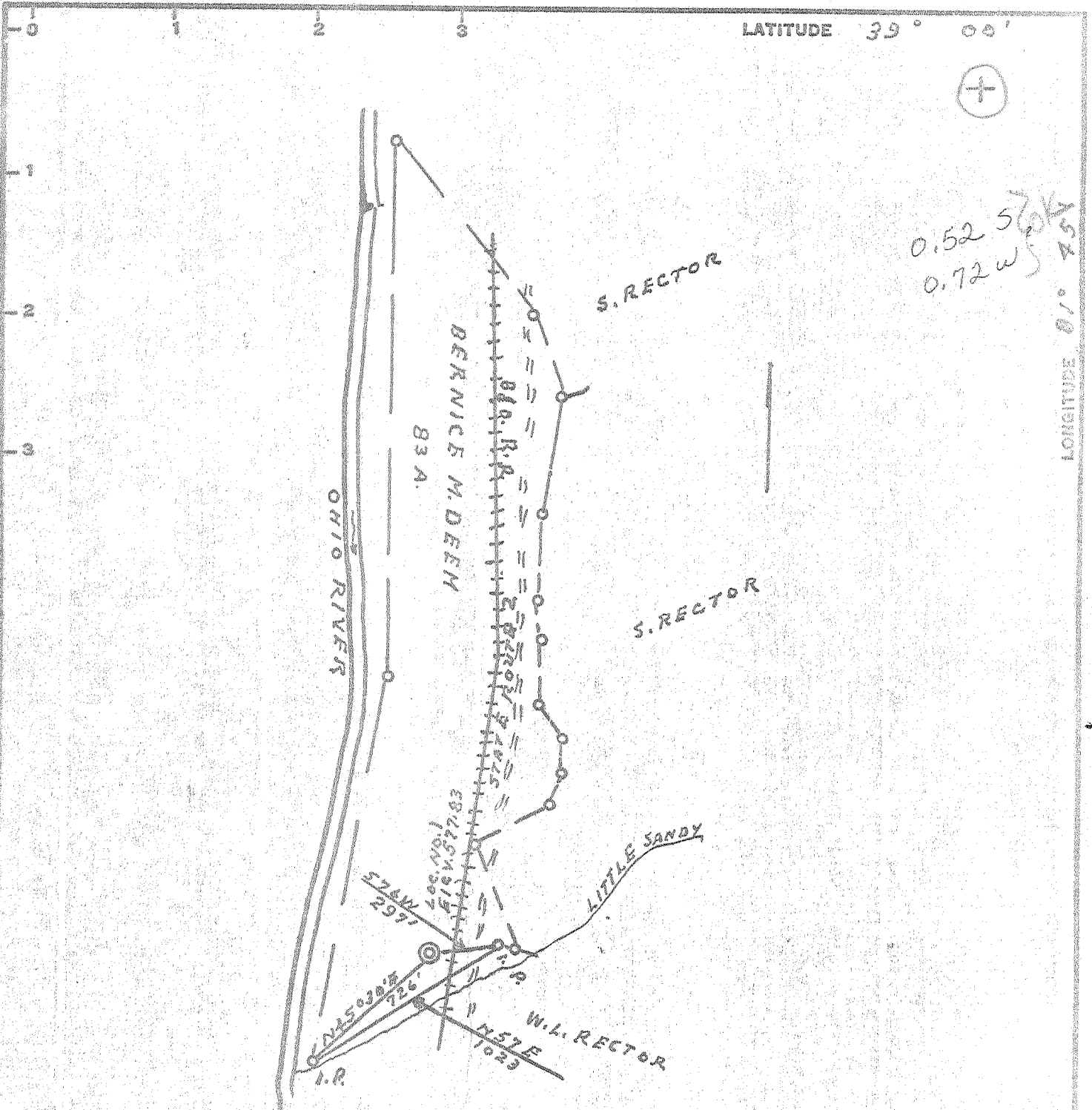

0.52 S
0.72 W

LONGITUDE 81° 45'

Minimum Error of Closure 1' IN 200'

Source of Elevation ABUTMENT R.R. BRIDGE LITTLE SANDY 584.00

I, the undersigned, hereby certify that this map is correct to the best of my knowledge and belief and shows all the information required by paragraph 6 of the rules and regulations of the oil and gas section of the mining laws of West Virginia.

- Fracture
- New Location
- Drill Deeper
- Abandonment

Signed: L. F. Dye
Squares: N S E W

Map No.

Transferred to R & S Gas & Oil, Inc.
 Company R & S GAS INC.
 Address 2702 Deseret Drive Charleston, West Virginia
 Farm BERNICE M. DEEM
 Tract _____ Acres 83 Lease No. _____
 Well (Farm) No. 1 Serial No. _____
 Elevation (Spirit Level) 577.83
 Quadrangle RAVENSWOOD NE
 County JACKSON District GRANT
 Engineer L. F. Dye
 Engineer's Registration No. 806
 File No. _____ Drawing No. _____
 Date 4-28-69 Scale 1" = 40 POLES

STATE OF WEST VIRGINIA
 DEPARTMENT OF MINES
 OIL AND GAS DIVISION
 CHARLESTON

WELL LOCATION MAP
 FILE NO. JAC-1177

+ Denotes location of well on United States Topographic Maps, scale 1 to 62,500, latitude and longitude lines being represented by border lines as shown.

- Denotes one inch spaces on border line of original tracing.

Deep Well (Newburg)
 JUL 18 1969



STATE OF WEST VIRGINIA
DEPARTMENT OF MINES
OIL AND GAS DIVISION

- Rotary
- Spudder
- Cable Tools
- Storage

Quadrangle Ravenswood

Permit No. Jac- 1177

WELL RECORD

Oil or Gas Well Dry
(KIND)

Company <u>Pargas, Inc.</u>	Casing and Tubing	Used in Drilling	Left in Well	Packers
Address <u>Ripley, W. Va.</u>	Size			
Farm <u>Deem</u> Acres <u>83</u>	18	39'	39'	Kind of Packer
Location (waters)	16	61'	61'	
Well No. <u>1</u> Elev <u>579.83</u> DF <u>13</u>	10	286'		Size of
District <u>Grant</u> County <u>Jackson</u>	8 1/4	1528'		
The surface of tract is owned in fee by	6 5/8	4150'	1050'?	Depth set
Address	5 3/16			
Mineral rights are owned by	4 1/2			
Address	3			Perf. top
Drilling commenced	2			Perf. bottom
Drilling completed <u>12 - 21 - 69</u>	Liners Used			Perf. top
Date Shot From To				Perf. bottom
With				

Open Flow /10ths Water in _____ Inch

Open Flow /10ths Merc. in _____ Inch

Volume _____ Cu. Ft.

Rock Pressure _____ lbs. _____ hrs.

Oil _____ bbls., 1st 24 hrs.

WELL ACIDIZED (DETAILS) _____ FEET _____ INCHES _____ FEET _____ INCHES

WELL FRACTURED (DETAILS) _____ FEET _____ INCHES _____ FEET _____ INCHES

RESULT AFTER TREATMENT (Initial open Flow or bbls.) _____

ROCK PRESSURE AFTER TREATMENT _____ HOURS

Fresh Water _____ Feet

Producing Sand _____ Depth _____

Attach copy of cementing record.

CASING CEMENTED 7" SIZE No. Ft. _____ Date _____

Amount of cement used (bags) 15

Name of Service Co. (Operator)

COAL WAS ENCOUNTERED AT 750 FEET 3/4 INCHES

Formation	Color	Hard or Soft	Top	Bottom	Oil, Gas or Water	Depth	Remarks
River Sand			0	61			
Sand			61	125			
Red Rock			125	140			
Blue Shale			140	165			
Red Rock			165	198			
Sand			198	205			
Slate			205	215			
Red Rock			215	255			
Sand			255	335			
Slate			335	405			
Sand			405	445			
Slate			445	460			
Red Rock			460	498			
Sand			498	524			
Red Rock			524	575			
Slate			575	615			
Red Rock			615	650			
Slate			650	655			
Red Rock			655	720			
Sand			720	745			

Formation	Color	Hard or Soft	Top	Bottom	Oil, Gas or Water	Depth Found	Remarks
Slate			745	750			
✓ Coal			750	753			
Slate			753	808			
Sand			808	827			
Lime			827	837			
Sand			837	915			
Slate			915	1035			
Sand			1035	1065			
Slate			1065	1096			
Sand			1096	1120			
Slate			1120	1215			
Sand			1-15	1230			
Slate			1230	1260			
Brak Lime			1260	1298			
Slate			1298	1338			
Sand			1338	1435			
Lime - <i>Biglime?</i>			1435	1520			
Slate Shells			1520	2550			
Shells			2550	3070	Gas blow at 2600,		blew down
Brown Shale			3070	3235	to nothing		
Grey Slate			3235	3380			
Brown Shale			3380	3560			
Grey Slate			3560	3895			
Brown Shale			3895	4150		4900	
✓ Corniferous - 463			4150	4245		4245	
Oriskany			4245	4260		655	
Lime - <i>Haldenberg?</i>			4260	4647			
Lime & Dolomite			4647	4900			
Williamsport "Newberg"			4900	4948	show oil		
Lime & Dolomite McKenzie			4948		water	5090	
		Total Depth	5110'				

545
4900
598
5352

Date _____ 19__

APPROVED _____, Owner

By _____ (Title)