

15' loc - 4.98
~~2.10 S~~ 39
 1.74 W

ACCURACY: 1/200 P

Source of Elevation TOP OF KNOB (1002')

- New Location
- Drill Deeper
- Abandonment
- Fracture
- Redrill

I, the undersigned, hereby certify that this map is correct to the best of my knowledge and belief and shows all the information required by paragraph 6 of the rules and regulations of the oil and gas section of the mining laws of West Virginia.

Budgette Oil & Gas Co. for:

Chet Waterman

Company ATLANTIC INTERNATIONAL OIL CORP
 Address COLUMBUS, OHIO 1 1/2 Spring St.
 Farm DALE ARMSTRONG TRACT 25302
 Tract _____ Acres 100 Lease No. _____
 Well (Farm) No. 2 Serial No. _____
 Elevation (Spirit Level) 949.12'
 Quadrangle RIPLEY NW
 County JACKSON District RAVENSWOOD
 Engineer CHET WATERMAN
 Engineer's Registration No. 3788
 File No. 72003-116 Drawing No. _____
 Date 3/30/72 Scale 1" = 30 P

STATE OF WEST VIRGINIA
 DEPARTMENT OF MINES
 OIL AND GAS DIVISION
 CHARLESTON

WELL LOCATION MAP
 FILE NO. JAC-1334-P

— Denotes location of well on United States Topographic Maps, scale 1 to 62,500, latitude and longitude lines being represented by border lines as shown.
 — Denotes one inch spaces on border line of original tracing.

47-035

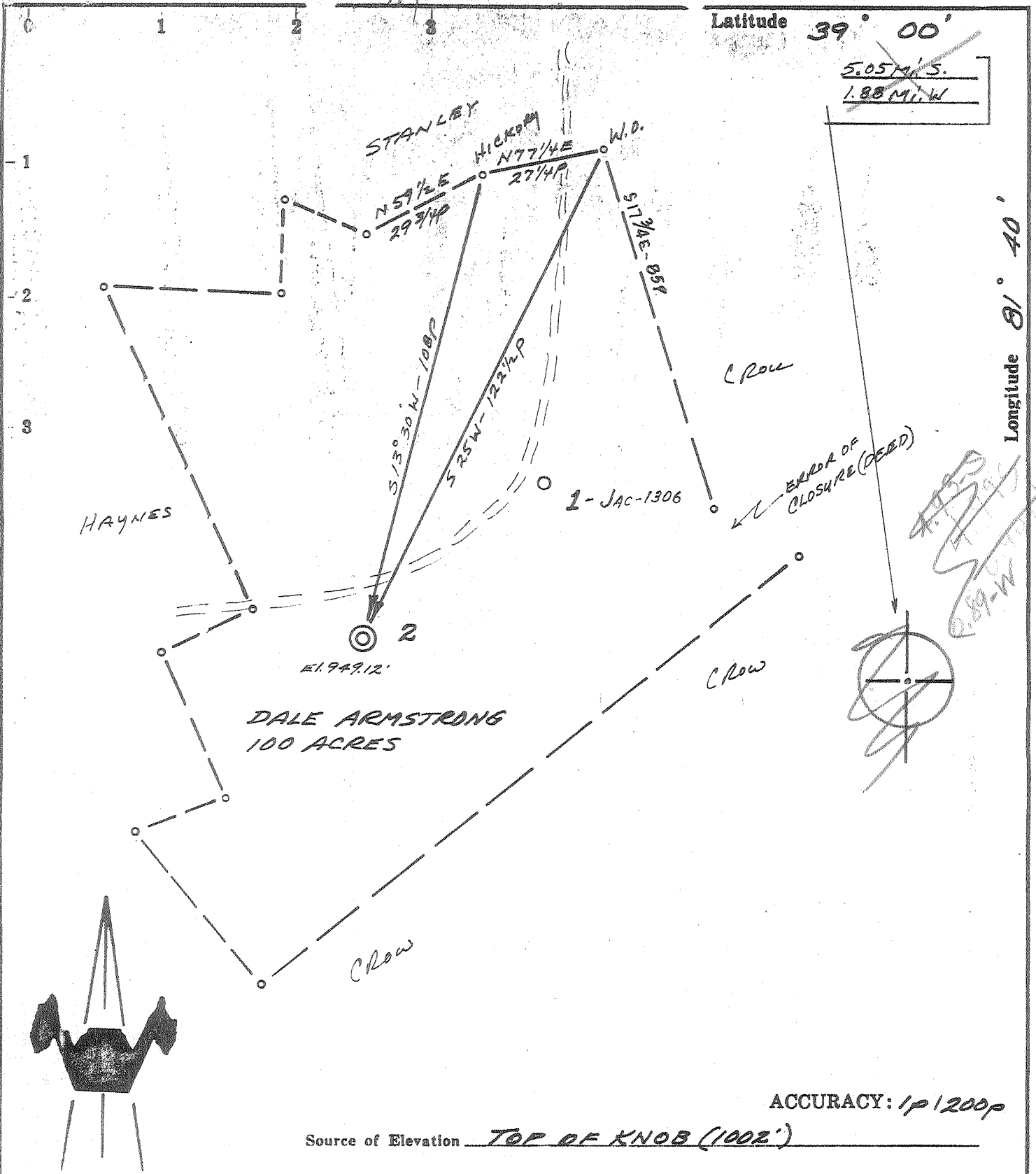

ACCURACY: 1 P / 200 P

Source of Elevation TOP OF KNOB (1002')

I, the undersigned, hereby certify that this map is correct to the best of my knowledge and belief and shows all the information required by paragraph 6 of the rules and regulations of the oil and gas section of the mining laws of West Virginia.

Chet Waterman

- New Location
- Drill Deeper
- Abandonment
- Fracture
- Redrill

Company ATLANTIC ~~INTERNATIONAL~~ OIL CORP.

Address COLUMBUS, OHIO

Farm DALE ARMSTRONG

Tract Acres 100 Lease No. _____

Well (Farm) No. 2 Serial No. _____

Elevation (Spirit Level) 949.12'

Quadrangle RIPLEY NW

County JACKSON District RAVENSWOOD

Engineer CHET WATERMAN

Engineer's Registration No. 3788

File No. 72003-116 Drawing No. _____

Date 3/30/72 Scale 1" = 30 P

STATE OF WEST VIRGINIA
DEPARTMENT OF MINES
OIL AND GAS DIVISION
CHARLESTON

WELL LOCATION MAP
FILE NO. JAC-1334

+ Denotes location of well on United States Topographic Maps, scale 1 to 62,500, latitude and longitude lines being represented by border lines as shown.

— Denotes one inch spaces on border line of original tracing.

Deep Well (New)

39-00
1-54



RECEIVED

JAN 16 1973

STATE OF WEST VIRGINIA
DEPARTMENT OF MINES

OIL & GAS DIVISION
DEPT. OF MINES

OIL AND GAS DIVISION 3

- Notary
- Spudder
- Cable Tools
- Storage

Quadrangle Ripley

Permit No. JAC-1334

WELL RECORD

Oil or Gas Well GAS (KIND)

Company <u>Atlantic-International Oil Corporation</u>	Casing and Tubing	Used in Drilling	Left in Well	Packers
Address <u>1000 Uxlin Avenue, Columbus, Ohio 43212</u>	Size			
Farm <u>Dale Armstrong</u> Acres	16			Kind of Packer
Location (waters) <u>Silverton</u>	13			
Well No. <u>2</u> Elev. <u>1002'</u>	10	<u>600' Cemented to Surface</u>		
District <u>Ravenswood</u> County <u>Jackson</u>	8 1/4	<u>1070'</u>	<u>1070'</u>	
The surface of tract is owned in fee by <u>Dale Armstrong et al</u>	6 3/4	<u>2250'</u>	<u>2250'</u>	Depth set
Address <u>Silverton, W. Va</u>				
Mineral rights are owned by <u>Dale Armstrong et al</u>	5 3/16			
Address <u>Silverton, W. Va</u>	4 1/2	<u>5760' Cemented 50 bags</u>		
Drilling commenced <u>May 10, 1972</u>	3			Perf. top
Drilling completed <u>September 22, 1972</u>	2			Perf. bottom
Date Shot From To	Liners Used			Perf. top
With				Perf. bottom
Open Flow /10ths Water in Inch	Attach copy of cementing record.			
/10ths Merc. in Inch	CASING CEMENTED <u>4 1/2</u> SIZE <u>5760'</u> No. Ft. <u>9/25/72</u> Date			
Volume <u>10 - MMCFD natural</u> Cu. Ft.	Amount of cement used (bags) <u>50 bags</u>			
Rock Pressure <u>2,000</u> lbs. hrs.	Name of Service Co. <u>Halliburton Services</u>			
Oil bbls., 1st 24 hrs.	COAL WAS ENCOUNTERED AT <u>none</u> FEET INCHES			
WELL ACIDIZED (DETAILS)	FEET INCHES FEET INCHES			
WELL FRACTURED (DETAILS)	FEET INCHES FEET INCHES			

RESULT AFTER TREATMENT (Initial open Flow or bbls.) 10,000 Mcf

ROCK PRESSURE AFTER TREATMENT HOURS

Fresh Water Feet Salt Water Feet

Producing Sand NEWBURG Depth 5760'

Formation	Color	Hard or Soft	Top	Bottom	Oil, Gas or Water	Depth	Remarks
Red R			Surface	130'			
Slate			130'	160			
Red R			160	260			
Slate			260	300			
Red R			300	395			
Sand			395	450			
Red R			450	500			
Sand			500	560			
Red R			560	620			
Slate			620	645			
Red R			645	675			
Slate			675	740			
Sand			740	815			
Slate			815	920			
Sand			920	980			
Slate			980 980	1035			
Red R			1035	1080			
Shale			1080	1260			
Pink R		OVER	1260	1280			

Formation	Color	Hard or Soft	Top	Bottom	Oil, Gas or Water	Depth Found	Remarks
Sand			1380'	1410'			
Shale			1410	1500			
Sand			1500	1620			
Shale			1620	1736			
Lime			1736	1750			
Slate			1750	1814			
Sand			1814	1832			
Slate			1832	1878			
Sand			1878	1940			
Lime - <i>Bigline</i>			1940	2078			
Shale			2078	2086			
Sand - <i>Injun</i>			2086	2200			Hole full water 2119'
Slate			2200	2205			
Sand			2205	2250			
Slate & Shells			2250	2340			
Shale - <i>Brown</i>			2340	2360			
Sand - <i>Brown</i>			2360	2368			
Slate & Shells			2368	4520			
Shale - <i>Brown</i>			4520	4578			
Shale - <i>Dark</i>			4578	4928			
Lime - <i>Huttersville</i>		463	4928	5020	PI - 4905 = 5020		
Sand - <i>Crabony</i>		hard	5020	5078	PI - 5020 = 5040		
Lime - <i>HELDERBERG</i>		SALINA	5078	5760			
Newburg Sand			5760 T.D.				

535

Gas - 5760'

4905
1002
3903

5020
1002
4018

5055
1002
4053

P.I. card indicates TP @ 5764 and gas interval from 5761 to 5764.

Date Jan 15, 1973

APPROVED Atlantic International Oil Corp.



STATE OF WEST VIRGINIA
DEPARTMENT OF MINES

RECEIVED

MAY 8 1972

OIL & GAS DIVISION
DEPT. OF MINES

OIL AND GAS WELL PERMIT APPLICATION

TO THE DEPARTMENT OF MINES,
Charleston, W. Va.

DATE April 11th, 1972

Surface Owner _____
Address _____
Mineral Owner Dale Armstrong
Address H. I. Ravenswood, W. Va
Coal Owner _____
Address _____
Coal Operator _____
Address _____

Company Atlantic International
Oil Corporation
Address 1000 Urlin Ave., Columbus, Ohio
Farm Dale Armstrong Acres 100
Location (waters) Beatty's Run of Sandy Creek
Well No. 2 Elevation 949.12 Sp.
District Ravenswood County Jackson
Quadrangle Ripley

THIS PERMIT MUST BE POSTED AT THE WELL SITE
all provisions being in accordance with Chapter 22,
of the W. Va. Code, the location is hereby approved
for drilling. This permit shall expire if
operations have not commenced by Sept. 8, 1972.

INSPECTOR TO BE NOTIFIED Jud
Burdette
Sisonville, W. Va PH: 984-9263

D. J. Fodde
Deputy Director - Oil & Gas Division

GENTLEMEN:

The undersigned well operator is entitled to drill upon the above named farm or tract of land for oil and gas, having fee title thereto, (or as the case may be) under grant or lease dated Sept 5 1966 by Dale Armstrong made to Atlantic Int'l Corp and recorded on the 4 day of May 1967 in Jackson County, Book 105 Page 20

X NEW WELL _____ DRILL DEEPER _____ REDRILL _____ FRACTURE OR STIMULATE
_____ OIL AND GAS WELL ORIGINALLY DRILLED BEFORE JUNE 5, 1969.

The enclosed plat was prepared by a registered engineer or licensed land surveyor and all coal owners and/or operators have been notified as of the above date.

The above named coal owners and/or operator are hereby notified that any objection they wish to make, or are required to make by Section 3 of the Code, must be received by, or filed with the Department of Mines within ten (10) days. *

Copies of this notice and the enclosed plat were mailed by registered mail, or delivered to the above named coal operators or coal owners at their above shown respective address _____ day _____ before, or on the same day with the mailing or delivery of this copy to the Department of Mines at Charleston, West Virginia.

Very truly yours, A. Snyder
(Sign Name) ATLANTIC INTERNATIONAL OIL CORP.
Well Operator

Address _____
of _____
Well Operator _____
1000 Urlin Avenue Street
Columbus, Ohio 43212 City or Town
_____ State

*SECTION 3 If no objections are filed or found by the Department of mines, within said period of ten days from the receipt of notice and plat by the department of mines, to said proposed location, the department shall forthwith issue to the well operator a permit reciting the filing of such plat, that no objections have been made by the coal operators or found thereto by the department and that the same is approved and the well operator authorized to proceed.

BOMB DRILL

Jac - 1334 PERMIT NUMBER

Snyder

THIS IS AN ESTIMATE ONLY
ACTUAL INFORMATION WILL BE SUBMITTED ON OG-10 UPON COMPLETION

PROPOSED WORK ORDER TO _____ DRILL DEEPEN _____ FRACTURE-STIMULATE _____
 DRILLING CONTRACTOR: (If Known) _____ RESPONSIBLE AGENT: _____
 NAME Hilton I. Bever NAME _____
 ADDRESS 119 E. 5th St., Williamstown, WV ADDRESS 614 _____
 TELEPHONE 304-375-7800 TELEPHONE 488-5519 _____
 ESTIMATED DEPTH OF COMPLETED WELL: Newberg ROTARY _____ CABLE TOOLS _____
 PROPOSED GEOLOGICAL FORMATION: 5800 _____
 TYPE OF WELL: OIL _____ GAS _____ COMB. _____ STORAGE _____ DISPOSAL _____
 RECYCLING _____ WATER FLOOD _____ OTHER _____

TENTATIVE CASING PROGRAM:

CASING AND TUBING SIZE	USED FOR DRILLING	LEFT IN WELL	CEMENT FILL UP OR SACKS - CUBIC FT.
20 - 16			
13 - 10	500	500	Cement to Surface.
9 - 5/8			
8 - 5/8	1250		
7	2300		
5 1/2			
4 1/2	5900	5900	1000' -
3			Perf. Top
2			Perf. Bottom
Liners			Perf. Top
			Perf. Bottom

APPROXIMATE FRESH WATER DEPTHS 450 FEET SALT WATER _____ FEET
 APPROXIMATE COAL DEPTHS _____
 IS COAL BEING MINED IN THE AREA? _____ BY WHOM? _____

TO DRILL:

SUBMIT FIVE (5) COPIES OF OG - 1, \$100.00 PERMIT FEE, PERFORMANCE BOND AND PERMANENT COPY OF PLAT.

TO DRILL DEEPER OR REDRILL:

SUBMIT FIVE (5) COPIES OF OG - 1, SHOWING ORIGINAL PERMIT NUMBER AND PERFORMANCE BOND. ON WELLS DRILLED PRIOR TO 1929, A PERMANENT COPY OF THE PLAT AND THE ORIGINAL WELL RECORD MUST ALSO BE SUBMITTED.

TO FRACTURE - STIMULATE:

OIL AND/OR GAS WELL ORIGINALLY DRILLED BEFORE JUNE 5, 1929, FIVE (5) COPIES OG - 1, PERFORMANCE BOND, PERMANENT PLAT AND ORIGINAL WELL RECORD.

OIL AND/OR GAS WELL ORIGINALLY DRILLED ON AND/OR AFTER JUNE 5, 1929, FIVE COPIES OG - 1, SHOWING ORIGINAL PERMIT NUMBER, AND PERFORMANCE BOND.

Required forms must be filed within ninety (90) days of completion for bond release. Inspector to be notified twenty-four (24) hours in advance.

The following waiver must be completed by the coal operator if the permit is to be issued within ten days of receipt thereof.

WAIVER: I the undersigned, Agent for _____ Coal Company, Owner or Operator of the coal under this lease have examined and place on our mine maps this proposed well location.

We the _____ Coal Company have no objections to said well being drilled at this location, providing operator has complied with all rules and regulations in Articles 4, 5, and 7, Chapter 22 of the West Virginia Code.

 For Coal Company

 Official Title