



DRILLING CONTRACTOR:

STATE OF WEST VIRGINIA  
DEPARTMENT OF MINES, OIL AND GAS DIVISION

OIL AND GAS WELL PERMIT APPLICATION

- 4) WELLTYPE: A Oil \_\_\_\_\_ / Gas X /  
B (If "Gas", Production X / Underground storage \_\_\_\_\_ / Deep \_\_\_\_\_ / Shallow X /)
- 5) LOCATION: Elevation: 861' Watershed: Grass Lick Run  
District: Ripley County: Jackson Quadrangle: Ripley
- 6) WELL OPERATOR Kaiser Exploration and Mining Co. (I) DESIGNATED AGENT R. A. Pryce  
Address P. O. Box 8 Address Same  
Ravenswood, WV 26164
- 7) OIL & GAS ROYALTY OWNER Raymond R. Casto et al  
Address Rt. 1, Box 14  
Ravenswood, WV 26164  
Acreage 168.3
- 8) SURFACE OWNER Same  
Address \_\_\_\_\_  
Acreage 152.71
- 9) FIELD SALE (IF MADE) TO:  
Address \_\_\_\_\_
- 10) OIL & GAS INSPECTOR TO BE NOTIFIED  
Name Homer Dougherty  
Address Linden Rt., Box 3A, Looneyville, WV
- 11) COAL OPERATOR None  
Address \_\_\_\_\_
- 12) COAL OPERATOR None  
Address \_\_\_\_\_
- 13) COAL OWNER(S) WITH DECLARATION ON RECORD:  
Name None  
Address \_\_\_\_\_
- 14) COAL LESSEE WITH DECLARATION ON RECORD:  
Name None  
Address \_\_\_\_\_
- 15) PROPOSED WORK: Drill X / Drill deeper \_\_\_\_\_ / Redrill \_\_\_\_\_ / Fracture or stimulate \_\_\_\_\_  
Plug off old formation \_\_\_\_\_ / Perforate new formation \_\_\_\_\_  
Other physical change in well (specify) \_\_\_\_\_
- 16) GEOLOGICAL TARGET FORMATION, Devonian Brown Shale
- 17) Estimated depth of completed well, 5031 feet
- 18) Approximate water strata depths: Fresh, 361 feet; salt, \_\_\_\_\_ feet.
- 19) Approximate coal seam depths: \_\_\_\_\_ Is coal being mined in the area? Yes \_\_\_\_\_ / No \_\_\_\_\_

20) CASING AND TUBING PROGRAM

CASING OR TUBING TYPE	SPECIFICATIONS					FOOTAGE INTERVALS		CEMENT FILL-UP OR SACKS (Cubic feet)	PACKERS
	Size	Grade	Weight per ft.	New	Used	For drilling	Left in well		
Conductor									Kinds
Fresh water	10 3/4"			X		400 <del>250</del>	400 <del>250</del>	150 sks class A	to surface
Coal								65 sks 50/50	pozmix
Intermediate	7"			X		2271	2271	100 sks class A	
Production	4 1/2"			X		5031	5031	225 sks 50/50	pozmix
Tubing									Perforations:
Liners									Top Bottom

- 21) EXTRACTION RIGHTS  
Check and provide one of the following:  
 Included is the lease or leases or other continuing contract or contracts by which I hold the right to extract oil or gas.  
 The requirement of Code 22-4-1-(c) (1) through (4). (See reverse side for specifics.)
- 22) ROYALTY PROVISIONS  
Is the right to extract, produce or market the oil or gas based upon a lease or other continuing contract or contracts providing for flat well royalty or any similar provision for compensation to the owner of the oil or gas in place which is not inherently related to the volume of oil or gas so extracted, produced or marketed? Yes  No
- If the answer above is No, nothing additional is needed. If the answer is Yes, you may use Affidavit Form IV-60.
- 23) Required Copies (See reverse side.)
- 24) Copies of this Permit Application and the enclosed plat and reclamation plan have been mailed by registered mail or delivered by hand to the above named coal operator, coal owner(s), and coal lessee on or before the day of the mailing or delivery of this Permit Application to the Department of Mines at Charleston, West Virginia.
- Notary: \_\_\_\_\_  
My Commission Expires \_\_\_\_\_
- Signed: R.A.P.  
Its: General Manager

OFFICE USE ONLY

Permit number 47-035-1874 DRILLING PERMIT Date July 25 83

This permit covering the well operator and well location shown below is evidence of permission granted to drill in accordance with the pertinent legal requirements subject to the conditions contained herein and on the reverse hereof. In addition, the well operator or his contractor shall notify the proper district oil and gas inspector 24 hours before actual permitted work has commenced.

Permit expires July 25, 1985 unless drilling is commenced prior to that date and prosecuted with due diligence.

NOTE: Keep one copy of this permit posted at the drilling location.

Bound:	Agent:	Plat:	Casing:	Fee:
	<u>[Signature]</u>	<u>[Signature]</u>	<u>[Signature]</u>	<u>964275</u>

Robert Stewart  
Administrator, Office of Oil and Gas





IV-9  
(Rev 8-81)

DATE June 22, 1983

WELL NO. KEM #435

State of West Virginia

API NO. 47 - 035 - 1874

Department of Mines  
Oil and Gas Division

CONSTRUCTION AND RECLAMATION PLAN

COMPANY NAME Kaiser Exploration and Mining Co DESIGNATED AGENT R. A. Pryce

Address P. O. Box 8, Ravenswood, WV Address Same

Telephone 273-5371 Telephone \_\_\_\_\_

LANDOWNER Raymond Casto SOIL CONS. DISTRICT Western

Revegetation to be carried out by Kaiser Exploration and Mining Company (Agent)

This plan has been reviewed by Western SCD. All corrections and additions become a part of this plan: June 24 1983 (Date)  
Wayne H. Hughes (SCD Agent)

ACCESS ROAD

LOCATION

Structure <u>Cross Drains</u>	(A)	Structure <u>None required</u>	(1)
Spacing <u>135', 60'</u>		Material _____	
Page Ref. Manual <u>2-4</u>		Page Ref. Manual _____	
Structure _____	(B)	Structure _____	(2)
Spacing _____		Material _____	
Page Ref. Manual _____		Page Ref. Manual _____	
Structure _____	(C)	Structure _____	(3)
Spacing _____		Material _____	
Page Ref. Manual _____		Page Ref. Manual _____	

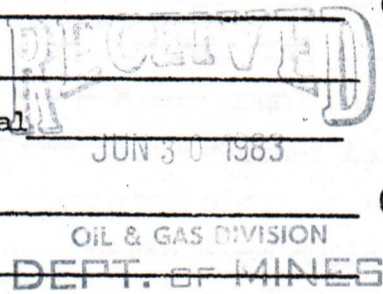

All structures should be inspected regularly and repaired if necessary. All commercial timber is to be cut and stacked and all brush and small timber to be cut and removed from the site before dirt work begins.

REVEGETATION

<u>Treatment Area I</u>	<u>Treatment Area II</u>
Lime <u>4</u> Tons/acre or correct to pH _____	Lime <u>Same as Area I</u> Tons/acre or correct to pH _____
Fertilizer <u>14-14-14</u> <u>600</u> lbs/acre (10-20-20 or equivalent)	Fertilizer _____ lbs/acre (10-20-20 or equivalent)
Mulch <u>Hay</u> <u>2</u> Tons/acre	Mulch _____ Tons/acre
Seed* <u>81% Orchard Grass/15% Ryegrass</u> <u>16</u> lbs/acre	Seed* _____ lbs/acre
<u>Kentucky 31 Fescue</u> <u>16</u> lbs/acre	_____ lbs/acre
<u>Red Clover</u> <u>8</u> lbs/acre	_____ lbs/acre

\*Inoculate all legumes such as vetch, trefoil and clovers with the proper bacterium. Inoculate with 3X recommended amount.

PLAN PREPARED BY Vincent Wood 09/08/2023  
ADDRESS 116 Post Avenue  
Ripley, WV 25271  
PHONE NO. 372-2709

NOTES: Please request landowner's cooperation to protect new seedling for one growing season. Attach separate sheets as necessary for comments.



ATTACH OR PHOTOCOPY SECTION OF INVOLVED TOPOGRAPHIC MAP. QUADRANGLE RIPLEY

**LEGEND**





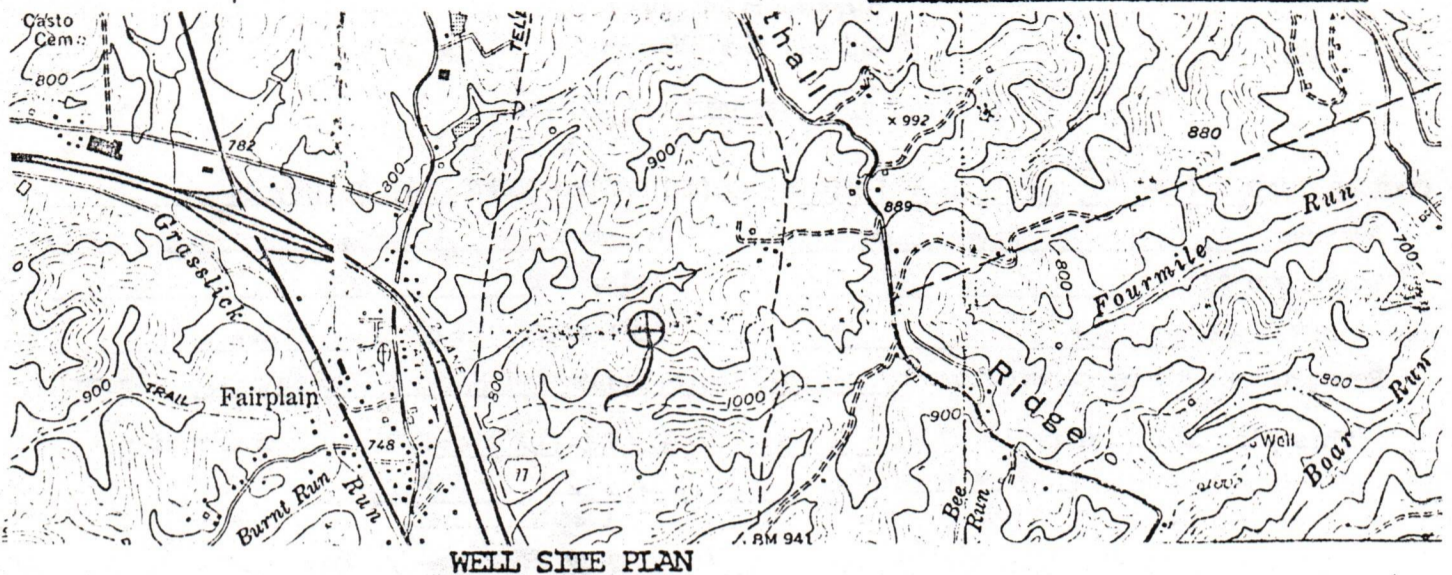





Well Site 

Access Road 



... to include well location, existing access road, roads to be constructed, well site, drilling pits and necessary structures numbered or lettered to correspond with the first part of this plan. Include all natural drainage.

**LEGEND**

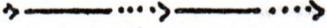
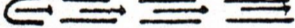
Property boundary 	Diversion 
Road 	Spring 
Existing fence 	Wet spot 
Planned fence 	Building 
Stream 	Drain pipe 
Open ditch 	Waterway 

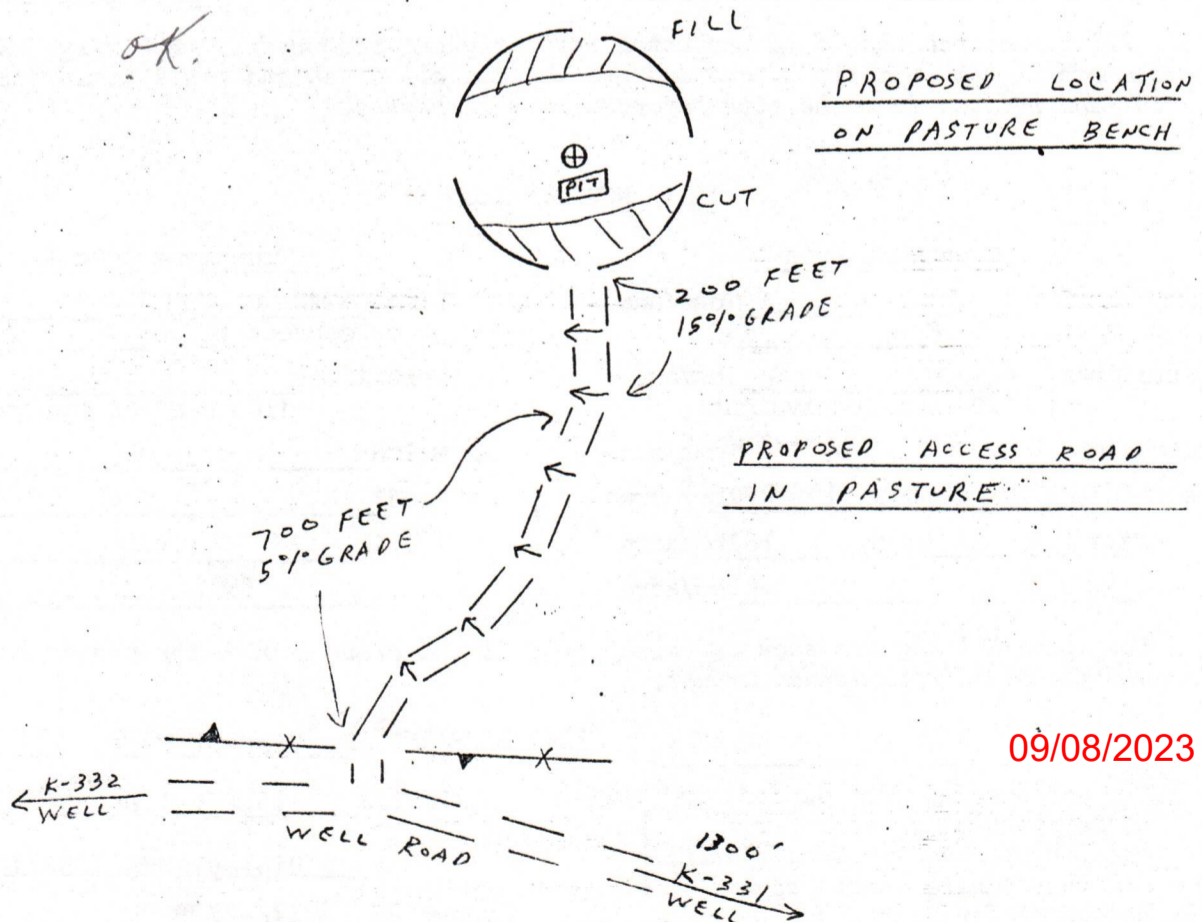

09/08/2023

Temp fence required if pastured



1) Date: June 27, 1983  
2) Operator's Well No. KEM #435  
3) API Well No. 47  
State County Permit

STATE OF WEST VIRGINIA  
DEPARTMENT OF MINES, OFFICE OF OIL & GAS  
NOTICE OF APPLICATION FOR A WELL WORK PERMIT

4) SURFACE OWNER(S) OF RECORD TO BE SERVED

- (i) Name Raymond R. Casto et al  
Address Rt. 1, Box 14  
Ravenswood, WV 26164
- (ii) Name Lewis Casto  
Address Fairplain Rt.,  
Ripley, WV 25271
- (iii) Name \_\_\_\_\_  
Address \_\_\_\_\_

5 (i) COAL OPERATOR None  
Address \_\_\_\_\_

5 (ii) COAL OWNER(S) WITH DECLARATION ON RECORD:  
Name None  
Address \_\_\_\_\_

Name \_\_\_\_\_  
Address \_\_\_\_\_

5 (iii) COAL LESSEE WITH DECLARATION ON RECORD:  
Name None  
Address \_\_\_\_\_

TO THE PERSON(S) NAMED ABOVE: You should have received this Form and the following documents:

- (1) The Application for a Well Work Permit on Form IV-2(B) (or Form IV-4 if the well is to be plugged, which sets out the parties involved in the drilling or other work, and describes the well and its location and, if applicable, the proposed casing and cementing program;
- (2) The plat (surveyor's map) showing the well location on Form IV-6; and
- (3) The Construction and Reclamation Plan on Form IV-9 (unless the well work is only to plug a well), which sets out the plan for erosion and sediment control and for reclamation for the site and access road.

THE REASON YOU RECEIVED THESE DOCUMENTS IS THAT YOU HAVE RIGHTS REGARDING THE APPLICATION WHICH ARE SUMMARIZED IN THE "INSTRUCTIONS" ON THE REVERSE SIDE OF THE COPY OF THE APPLICATION (FORM IV-2(B) OR FORM 4, DESIGNATED FOR YOU. HOWEVER, YOU ARE NOT REQUIRED TO TAKE ANY ACTION AT ALL.

Take notice that under Chapter 22 of the West Virginia Code, the undersigned well operator proposes to file or has filed this Notice and Application and accompanying documents for a Well Work Permit with the Administrator of the Office of Oil and Gas, West Virginia Department of Mines, with respect to a well at the location described on attached Application and depicted on attached Form IV-6. Copies of this Notice, the Application, the plat, and the Construction and Reclamation Plan have been mailed by registered or certified mail or delivered by hand to the person(s) named above (or by publication in certain circumstances) on or before the day of mailing or delivery to the Administrator.

6) EXTRACTION RIGHTS

Check and provide one of the following:

- Included is the lease or leases or other continuing contract or contracts by which I hold the right to extract oil or gas.
- The requirement of Code 22-4-1-(c) (1) through (4). (See reverse side for specifics.)

7) ROYALTY PROVISIONS

Is the right to extract, produce or market the oil or gas based upon a lease or leases or other contract or contracts providing for flat well royalty or any similar provision for compensation to the owner of the oil or gas in place which is not inherently related to the volume of oil or gas so extracted, produced or marketed? Yes No

If the answer above is No, nothing additional is needed. If the answer is Yes, you may use Affidavit Form IV-60.

See the reverse side for line item instructions, and for instructions concerning the required copies of the Notice and Application, plat, and Construction and Reclamation Plan.

The truth of the information on the Notice and Application is verified and sworn to and the Notice is signed on behalf of the Well Operator in my County and State by

R. A. Pryce  
this 27 day of June, 1983.  
My commission expires 12-01, 1985.

Smith Ann Halbert  
Notary Public, Jackson County,  
State of West Virginia

WELL

OPERATOR Kaiser Exploration and Mining Co.

By R. A. P.  
Its General Manager  
Address P. O. Box 8  
Ravenswood, WV 26164  
Telephone 304-273-5371

RECEIVED

JUN 30 1983

OIL & GAS DIVISION  
DEPT. OF MINES

09/08/2023



I N S T R U C T I O N S T O A P P L I C A N T

CONCERNING THE LINE ITEMS:

- 1) Date of Notice.
- 2) Your well name and number.
- 3) To be filled out by the Office of Oil & Gas.
- 4) & 5) Use separate sheet if necessary.
- 4) Surface owner(s) of record to be served with Notice and Application. However, see also Code § 22-4-1b(b) if "more than three tenants in common or other co-owners of interest described in subsection (a) of this section hold interests in such lands".
- 5(i) "Coal Operator" means any person, firm, partnership, partnership association or corporation that proposes to or does operate a coal mine.
- 5(ii, iii) See Code § 22-4-20.
- 6) See Code § 22-4-11(c). However, in lieu of filing the lease(s) or other continuing contract(s), the Applicant may fill out the information in the space provided below.
- 7) See Code § § 22-4-11(d, e).

CONCERNING THE REQUIRED COPIES FOR FILING AND SERVICE:

Filing. Code § 22-4-1k and Regulation 7.02 provide that the original and required copies of the Notice and Application must be filed with the Administrator, accompanied by (i) a plat in the form prescribed by Regulation 11, (ii) a bond in one of the forms prescribed by Regulation 12, or in lieu thereof the other security allowed by Code § 22-4-1k(d) and the reclamation required by Code § 22-4-12b and Regulation 23, (iv) unless previously paid on the same well, the fees required by Code § 22-4-1a(c) and 22-3-12a, and (v) if applicable, the consent required by Code § 22-4-8a from the owner of any water well on dwelling within 200 feet of the proposed well.

Service. In addition, service must be made on the surface owner(s) and the person(s) with an interest in the coal. See Code § § 22-4-1m, 22-4-2, 22-4-2a, and 22-4-2b.

---

INFORMATION SUPPLIED UNDER CODE § 22-4-11(d)  
IN LIEU OF FILING LEASE(S) AND OTHER CONTINUING CONTRACT(S)

Under the oath required to make the verification on the obverse side of this Notice, I depose and say that I am the person who signed the Notice for the Applicant, and that--

- (1) the tract of land is the same tract described in the Application to which this Notice applies, partly or wholly depicted in the accompanying plat, and described in the Construction and Reclamation Plan;
- (2) the parties and recordation data (if recorded) for lease(s) or other continuing contract(s) by which the Applicant claims the right to extract, produce or market the oil or gas are as follows:

Grantor, lessor, etc.      Grantee, lessee, etc.      Royalty      Book Page

Kaiser Exploration and Mining Co. Raymond Casto et al 1/8 of prevailing 181//67  
field price



035- 1874

RECEIVED

JUN 30 1983

OIL & GAS DIVISION  
DEPT. OF MINES

AFFIDAVIT OF PERSONAL SERVICE

STATE OF West Virginia,  
COUNTY OF JACKSON :

The undersigned, being first duly sworn, says that the undersigned served a copy of (1) Notice of Application, (2) "Surface Owner's Copy" Application for a Well Work Permit, (3) plat showing well location (Form IV-6), and (4) the Construction and Reclamation Plan (Form IV-9) for operator's Well No. KEM 435 located in Ripley District, JACKSON County, West Virginia, upon Raymond R. Casto & Grace A. Casto, Lewis R. Casto and Barbara H. Casto, by handing to them (him, her, them) the copies in JACKSON County, State of WEST VIRGINIA on the 29<sup>th</sup> day of JUNE, 1983.

R. G. Patton

Taken, subscribed and sworn before me this 29<sup>th</sup> day of June, 1983.

My commission expires October 14, 1991.

Mary Ann Bardin  
Notary Public

(IF NOTARIZED OUTSIDE  
THE STATE AFFIX SEAL)



JUN 30 1983

1) Date: June 27 19 83

2) Operator's Well No. KEM #435

3) API Well No. 47 235 1874 State County Permi

OIL & GAS DIVISION  
STATE OF WEST VIRGINIA  
DEPARTMENT OF MINES, OFFICE OF OIL & GAS

APPLICATION FOR A WELL WORK PERMIT

- 4) WELL TYPE: A. Oil \_\_\_ / Gas x /  
B. (If "Gas", Production x / Underground storage \_\_\_ / Deep \_\_\_ / Shallow x /
- 5) LOCATION: Elevation: 861' Watershed Grass Lick Run  
District: Ripley County: Jackson Quadrangle: Ripley
- 6) WELL OPERATOR Kaiser Exploration and Mining Co. 7) DESIGNATED AGENT R. A. Pryce  
Address P. O. Box 8 Address Same  
Ravenswood, WV 26164
- 8) OIL & GAS INSPECTOR TO BE NOTIFIED 9) DRILLING CONTRACTOR:  
Name Homer Dougherty Name Clint Hurt & Associates  
Address Linden Rt., Box 3A Address P. O. Box 388  
Looneyville, WV Elkview, WV 25071
- 10) PROPOSED WELL WORK: Drill x / Drill Deeper \_\_\_ / Redrill \_\_\_ / Stimulate \_\_\_ /  
Plug off old formation \_\_\_ / Perforate new formation \_\_\_ /  
Other physical change in well (specify) \_\_\_\_\_
- 11) GEOLOGICAL TARGET FORMATION, Devonian Brown Shale
- 12) Estimated depth of completed well (or actual depth of existing well), 5031 feet
- 13) Approximate water strata depths: Fresh, \_\_\_ feet; salt, \_\_\_ feet.
- 14) Approximate coal seam depths: \_\_\_\_\_ Is coal being mined in the area? Yes \_\_\_ / No \_\_\_
- 15) CASING AND TUBING PROGRAM

CASING OR TUBING TYPE	SPECIFICATIONS					FOOTAGE INTERVALS		CEMENT FILL-UP OR SACKS (Cubic feet)	PACKERS
	Size	Grade	Weight per ft.	New	Used	For drilling	Left in well		
Conductor									Kinds
Fresh water	10 3/4"			X		250	250	225 sks class A to surface	
Coal								65 sks 50/50	Sizes 50 mix
Intermediate	7"			X		2271	2271	100 sks class A	
Production	4 1/2"			X		5031	5031	225 sks 50/50	Depths 50 mix
Tubing									
Liners									Perforations: Top Bottom

The law requires a comment period for surface owners. However, the permit can be issued in less than 15 days from the filing of the Application (or less than 5 days if the Application is to plug a well), if the surface owner(s) of record sign(s) the following "Voluntary Statement of No Objection" on a facsimile of this surface owner's copy of the Application.

VOLUNTARY STATEMENT OF NO OBJECTION

I hereby state that I have read the instructions to surface owners on the reverse side of this Application for a Well Work Permit, and that I have received copies of (1) a Notice of Application for a Well Work Permit on Form IV-2(A), (2) an Application for a Well Work Permit on Form IV-2(B), (3) a survey plat on Form IV-6, and (4) a Construction and Reclamation Plan on Form IV-9, all for proposed well work on my surface land as described therein.

I further state that I have no objection to the planned work described in these materials, and I have no objection to a permit being issued based on those materials.

(For execution by corporation, partnership, etc.)

(For execution by natural persons)

NAME: \_\_\_\_\_  
By \_\_\_\_\_  
Its \_\_\_\_\_ Date: \_\_\_\_\_

Lewis B. Caste Date: June 29, 1983  
(Signature)  
Barbara H. Caste Date: June 29, 1983  
(Signature)  
Raymond B. Caste  
Shirley A. Caste

09/08/2023



INSTRUCTIONS TO SURFACE OWNERS  
AND  
EXPLANATION OF METHODS AND TIME LIMITS TO COMMENT  
ON OIL AND GAS WELL WORK PERMIT

The well operator named in the Notice and this Application and the attached materials is applying for a permit from the State to do oil or gas well drilling or other well work. You are being served with these materials because surface owners have the right to file comments before the permit is issued. (NOTE: If the surface tract is owned by more than three persons, in multiple heirship for example, then these materials were served on you because your name appeared on the Sheriff's tax ticket on the land or because you actually occupy the surface tract. In either case, you may be the only owner who will actually receive these materials.) Permit will be good for 24 months. See Chapter 22, Article 4 of the W. Va. Code.

If you do not own any interest in the surface tract, please forward these materials to the true owner immediately if you know who it is. Also, please notify the well operator named in the materials and the Administrator of the Office of Oil and Gas in the West Virginia Department of Mines immediately.

**NOTE:** You are not required to file any comment at all.

Where to file comments and obtain additional information:

Administrator of the Office of Oil and Gas  
West Virginia Department of Mines  
1615 Washington Street East  
Charleston, WV 25311  
(304) 348-2057

Who may file comments? If you wish to file comments, you must be an owner of record of (1) an interest in the surface tract on which the well already is or is about to be located, or (2) an interest in any other surface tract under the same oil or gas lease which will be utilized for roads or other land disturbances.

Time limits for comments. The law requires these materials to be personally served or mailed to you on or before the date the operator files his Application. You have **FIFTEEN (15) DAYS** after the filing date to file your comments as provided in Methods for Filing Comments below. (This time is changed to **FIVE (5) DAYS** from the filing date if the permit is only to plug a well.) You may call the Administrator's office at the above telephone number to be sure of the date. However, if you have been contacted by the well operator, and if you have signed a "voluntary statement of no objection" to any of the planned work described in these materials, then the permit may be issued at any time.

Comments must be in writing. Your comments should include your name, address and telephone number, the well operator's name and well number, and the approximate location of the proposed well site including district and county from the Application. You may add other documents, such as sketches, maps or photographs to support your comments.

Methods for filing comments. Comments must be filed in person or received in the mail at the Administrator's office by the time stated above. Check with your postmaster to ensure adequate delivery time or to arrange special expedited handling.

The Administrator for Oil and Gas has the power to deny or condition a well work permit based on your comments on the following grounds:

- "(1) The proposed well work will constitute a hazard to the safety of persons; or
- "(2) The plan for soil erosion and sediment control is not adequate or effective; or
- "(3) Damage would occur to publicly owned lands or resources; or
- "(4) The proposed well work fails to protect fresh water sources or supplies."

If you want a copy of the permit as it is finally issued, or a copy of the order denying the permit, you should request a copy from the Administrator.

List of Water Testing Laboratories. The Administrator maintains a list of water testing laboratories which you can hire to test your water to establish water quality prior to and after drilling. Contact the Administrator's office or an Oil and Gas Inspector to obtain a copy of the list.

09/08/2023



8-81)

RECEIVED  
JAN 19 1984



OIL & GAS DIVISION State of West Virginia  
DEPT. OF MINES Department of Mines  
Oil and Gas Division

Date November 10, 1983  
Operator's Well No. KEM-435  
Farm Raymond R. Casto  
API No. 47 - 035 - 1874

WELL OPERATOR'S REPORT  
OF  
DRILLING, FRACTURING AND/OR STIMULATING, OR PHYSICAL CHANGE

WELL TYPE: Oil \_\_\_ / Gas X / Liquid Injection \_\_\_ / Waste Disposal \_\_\_ /  
(If "Gas," Production X / Underground Storage \_\_\_ / Deep \_\_\_ / Shallow X /)

LOCATION: Elevation: 861' Watershed Grass Lick Run  
District: Ripley County Jackson Quadrangle Ripley

COMPANY Kaiser Exploration and Mining Company

ADDRESS P.O. Box 8, Ravenswood, WV 26164

DESIGNATED AGENT Robert A. Pryce

ADDRESS P.O. Box 8, Ravenswood, WV 26164

SURFACE OWNER Raymond R. Casto et al

ADDRESS Rt. 1, Box 14, Ravenswood, WV 26164

MINERAL RIGHTS OWNER Same

ADDRESS Same

OIL AND GAS INSPECTOR FOR THIS WORK Homer

Dougherty ADDRESS Linden Rt., Box 3A, Looneyville, WV

PERMIT ISSUED \_\_\_\_\_

DRILLING COMMENCED 10/5/83

DRILLING COMPLETED 10/10/83

IF APPLICABLE: PLUGGING OF DRY HOLE ON CONTINUOUS PROGRESSION FROM DRILLING OR REWORKING. VERBAL PERMISSION OBTAINED ON \_\_\_\_\_

Casing & Tubing	Used in Drilling	Left in Well	Cement fill up Cu. ft.
Size 20-16 Cond.			
13-10" 3/4		401'	300 sks Class A; cement to surface.
9 5/8			
8 5/8			
7		2279'	100 sks 50/50 pozmix; 100 sks Class A
5 1/2			
4 1/2		4337'	200 sks 50/50 pozmix.
3			
2			
Liners used			

GEOLOGICAL TARGET FORMATION Devonian Brown Shale Depth 5031 feet

Depth of completed well 4390 feet Rotary X / Cable Tools \_\_\_\_\_

Water strata depth: Fresh NA feet; Salt NA feet Drilled on fluid

Coal seam depths: None Is coal being mined in the area? No

OPEN FLOW DATA

Producing formation Devonian Brown Shale Pay zone depth 3480-4335 feet

Gas: Initial open flow Trace Mcf/d Oil: Initial open flow - Bbl/d

Final open flow 210 combined Mcf/d Final open flow - Bbl/d

Time of open flow between initial and final tests \_\_\_\_\_ hours

Static rock pressure 1125 Combined psig (surface measurement) after \_\_\_\_\_ hours shut in

(If applicable due to multiple completion--)

09/08/2023

Second producing formation Berea Sandstone Pay zone depth 2553-2561 feet

Gas: Initial open flow Trace Mcf/d Oil: Initial open flow - Bbl/d

Final open flow 210 combined Mcf/d Oil: Final open flow - Bbl/d

Time of open flow between initial and final tests \_\_\_\_\_ hours

Static rock pressure 1125 combined psig (surface measurement) after \_\_\_\_\_ hours shut in

(Continue on reverse side)

JACK 1874



15 OF PERFORATED INTERVALS, FRACTURING OR STIMULATING, PHYSICAL CHANGE, ETC.  
 4/83 - Devonian Brown Shale perforations: 1st Stage: 4090-4335, shot selectively, 20 holes, .39" diameter. 2nd Stage: 3480-3969, shot selectively, 20 holes, .39" diameter.

10/19/83 - 1st Stage: Foam fracture breakdown with N<sub>2</sub> at 1500 psig. Treat with 10 BPM and 25,000 scf/min at 2553 psig. 60,000# of 20/40 sand. 230 bbls sand laden and 296 total bbls. 625,000 scf of N<sub>2</sub>. ISIP = 1800 psig; 5 min SIP = 1470 psig.  
2nd Stage: Foam fracture. Breakdown with foam at 2670 psig. Treat with 10 BPM and 25,000 scf/min at 2780-2890 psig. 60,000# of 20/40 sand. 262 bbls sand laden and 312 bbls total. 775,000 scf of N<sub>2</sub>. ISIP = 2200 psig. 5 min SIP = 1810 psig.  
3rd Stage: Berea Sandstone fracture. Foam fracture. Breakdown with foam at 2380 psig. Treat with 4 BPM and 10,000 scf/min at 2200-2150 psig. 60,000# of 20/40 sand. 259 bbls sand laden and 331 bbls total. ISIP = 1800 psig. 5 min SIP = 1760.  
 Perforations at 2555-2563, 3 **WELL LOG** holes/ft, 24 holes, .41" diameter.

FORMATION	COLOR	HARD OR SOFT	TOP FEET	BOTTOM FEET	REMARKS
					Including indication of all fresh and salt water, coal, oil and gas
Shale			0	280	
Sand			280	352	
Siltstone and Shale			352	720	
Sand			720	744	
Siltstone and Sand			744	1212	
Sand			1212	1296	
Shale and Siltstone			1296	1764	
Salt Sands			1764	1884	
Big Lime (Greenbriar)			1884	2058	
Shale			2058	2080	
Big Injun Sandstone			2080	2180	
Shale			2180	2530	
Coffe Shale (Sunbury)			2530	2552	
Berea Sandstone			2552	2564	
Shale			2564	3800	s/g at 3480, 3520, 3600
Brown Shale			3800	4356	s/g at 3830
Shale			4356	4393	TD

(Attach separate sheets as necessary)

\_\_\_\_\_  
 KAISER EXPLORATION AND MINING COMPANY  
 Well Operator

09/08/2023

By: R.A.P.

Date: November 10, 1983

Note: Regulation 2.02(i) provides as follows:  
 "The term 'log' or 'well log' shall mean a systematic detailed geological record of all formations, including coal, encountered in the drilling of a well."



STATE OF WEST VIRGINIA  
DEPARTMENT OF MINES  
OIL AND GAS WELLS DIVISION

RECEIVED

AUG 22 1983

OIL & GAS DIVISION  
DEPT. OF MINES

INSPECTOR'S WELL REPORT

Permit No. 035-1874

Oil or Gas Well \_\_\_\_\_  
(KIND)

Company Kaiser Exp. & Mining Co.  
 Address Ravenswood, W.Va.  
 Farm Raymond Casbo  
 Well No. Kem 435  
 District Ripley County Jackson  
 Drilling commenced Built Location  
 Drilling completed \_\_\_\_\_ Total depth \_\_\_\_\_  
 Date shot \_\_\_\_\_ Depth of shot \_\_\_\_\_  
 Initial open flow \_\_\_\_\_ /10ths Water in \_\_\_\_\_ Inch  
 Open flow after tubing \_\_\_\_\_ /10ths Merc. in \_\_\_\_\_ Inch  
 Volume \_\_\_\_\_ Cu. Ft.  
 Rock pressure \_\_\_\_\_ lbs. \_\_\_\_\_ hrs.  
 Oil \_\_\_\_\_ bbls., 1st 24 hrs.  
 Fresh water \_\_\_\_\_ feet \_\_\_\_\_ feet  
 Salt water \_\_\_\_\_ feet \_\_\_\_\_ feet

CASING AND TUBING	USED IN DRILLING	LEFT IN WELL	PACKERS
Size			
16			Kind of Packer _____
13			
10			Size of _____
8 1/4			
6 3/4			Depth set _____
5 3/16			
3			Perf. top _____
2			Perf. bottom _____
Liners Used			Perf. top _____
			Perf. bottom _____

CASING CEMENTED \_\_\_\_\_ SIZE \_\_\_\_\_ No. FT. \_\_\_\_\_ Date \_\_\_\_\_  
 NAME OF SERVICE COMPANY \_\_\_\_\_  
 COAL WAS ENCOUNTERED AT \_\_\_\_\_ FEET \_\_\_\_\_ INCHES  
 \_\_\_\_\_ FEET \_\_\_\_\_ INCHES FEET \_\_\_\_\_ INCHES  
 \_\_\_\_\_ FEET \_\_\_\_\_ INCHES FEET \_\_\_\_\_ INCHES

Drillers' Names Inspected loc. at Request of Mrs Mrs. Lynch  
 adjacent land owners. The Lynches do not want  
 Remarks: any Run off of any kind to get on their land.  
Met with personell of Kem. Gas. Asked them to cut  
Ditches Below location with sediment catch Basin to control  
Run off. Also to contain everything on loc. During Drilling  
and after Fracturing to flow Well Back in tanks.  
Kem Will Move Dozer Back on loc. 8/16/83.

8/15/83  
DATE

Homes H. Dougherty  
DISTRICT WELL INSPECTOR

09/08/2023

8/26/83  
DATE

Homes H. Dougherty  
DISTRICT WELL INSPECTOR







STATE OF WEST VIRGINIA  
DEPARTMENT OF MINES  
OIL AND GAS WELLS DIVISION

RECEIVED

OCT 19 1983

OIL & GAS DIVISION  
DEPT. OF MINES

INSPECTOR'S WELL REPORT

Permit No. 035 1874

Oil or Gas Well \_\_\_\_\_  
(KIND)

Company Kaiser Exploration

Address \_\_\_\_\_

Farm R.R. Castro

Well No. 435

District \_\_\_\_\_ County \_\_\_\_\_

Drilling commenced \_\_\_\_\_

Drilling completed 10 11 83 Total depth 4390

Date shot \_\_\_\_\_ Depth of shot \_\_\_\_\_

Initial open flow \_\_\_\_\_ /10ths Water in \_\_\_\_\_ Inch

Open flow after tubing \_\_\_\_\_ /10ths Merc. in \_\_\_\_\_ Inch

Volume \_\_\_\_\_ Cu. Ft.

Rock pressure \_\_\_\_\_ lbs. \_\_\_\_\_ hrs.

Oil \_\_\_\_\_ bbls., 1st 24 hrs.

Fresh water \_\_\_\_\_ feet \_\_\_\_\_ feet

Salt water \_\_\_\_\_ feet \_\_\_\_\_ feet

CASING AND TUBING	USED IN DRILLING	LEFT IN WELL	PACKERS
Size			
16			Kind of Packer _____
13			
10			Size of _____
8 1/4			
6 5/8			Depth set _____
5 3/16			
3			Perf. top _____
2			Perf. bottom _____
Liners Used			Perf. top _____
			Perf. bottom _____

CASING CEMENTED \_\_\_\_\_ SIZE \_\_\_\_\_ No. FT. \_\_\_\_\_ Date \_\_\_\_\_

NAME OF SERVICE COMPANY \_\_\_\_\_

COAL WAS ENCOUNTERED AT \_\_\_\_\_ FEET \_\_\_\_\_ INCHES

\_\_\_\_\_ FEET \_\_\_\_\_ INCHES FEET \_\_\_\_\_ INCHES

\_\_\_\_\_ FEET \_\_\_\_\_ INCHES FEET \_\_\_\_\_ INCHES

Drillers' Names Rodney Shoots Hunt Rig # 2

Remarks: 10 11 83 TO 4390 Logging at 7:47 AM.  
10 9 83 2278' 7" Cement 100 SKS 50/50 poZ 10% Salt 100 SKS  
Regular root 3% coal plug down 3:15 AM. 10 9 83

10 11 83  
DATE

Jerry Tepe 09/08/2023  
DISTRICT WELL INSPECTOR







STATE OF WEST VIRGINIA  
DEPARTMENT OF MINES  
OIL AND GAS WELLS DIVISION

RECEIVED

OCT 12 1983

INSPECTOR'S WELL REPORT

Permit No. 035 1874

OIL & GAS DIVISION  
DEPT. OF MINES  
Oil or Gas Well \_\_\_\_\_  
(KIND)

Company <u>Kaiser Exploration + Mining</u>	CASING AND TUBING	USED IN DRILLING	LEFT IN WELL	PACKERS
Address _____	Size			
Farm <u>R.R. Castro</u>	16			Kind of Packer _____
Well No. _____	13			
District _____ County <u>Jackson</u>	10			Size of _____
Drilling commenced _____	8 1/4			
Drilling completed _____ Total depth _____	6 1/2			Depth set _____
Date shot _____ Depth of shot _____	5 3/16			
Initial open flow _____ /10ths Water in _____ Inch	3			Perf. top _____
Open flow after tubing _____ /10ths Merc. in _____ Inch	2			Perf. bottom _____
Volume _____ Cu. Ft.	Liners Used			Perf. top _____
Rock pressure _____ lbs. _____ hrs.				Perf. bottom _____
Oil _____ bbls., 1st 24 hrs.	CASING CEMENTED _____ SIZE _____ No. FT. _____ Date _____			
Fresh water _____ feet _____ feet	NAME OF SERVICE COMPANY _____			
Salt water _____ feet _____ feet	COAL WAS ENCOUNTERED AT _____ FEET _____ INCHES			
	_____ FEET _____ INCHES _____ FEET _____ INCHES			
	_____ FEET _____ INCHES _____ FEET _____ INCHES			

Drillers' Names Rodney Sheets

Remarks: 10 5 83 moving onto location, looked closely at location at request of neighbor - no apparent problem with (suspected) runoff.

10 5 83  
DATE

[Signature]  
DISTRICT WELL INSPECTOR  
09/08/2023



Form 26  
2/16/82

STATE OF WEST VIRGINIA  
DEPARTMENT OF MINES  
OIL AND GAS WELLS DIVISION  
**INSPECTOR'S PLUGGING REPORT**

Permit No. \_\_\_\_\_ Well No. \_\_\_\_\_

COMPANY \_\_\_\_\_ ADDRESS \_\_\_\_\_

FARM \_\_\_\_\_ DISTRICT \_\_\_\_\_ COUNTY \_\_\_\_\_

Filling Material Used \_\_\_\_\_

Liner		Location		Amount	Packer	Location	
PLUGS USED AND DEPTH PLACED				BRIDGES		CASING AND TUBING	
CEMENT-THICKNESS	WOOD-SIZE	LEAD	CONSTRUCTION-LOCATION	RECOVERED	SIZE	LOST	

Drillers' Names \_\_\_\_\_

Remarks: \_\_\_\_\_

\_\_\_\_\_ DATE I hereby certify I visited the above well on this date.



STATE OF WEST VIRGINIA  
DEPARTMENT OF MINES  
OIL AND GAS WELLS DIVISION

RECEIVED

OCT 19 1983

OIL & GAS DIVISION  
INSPECTOR'S WELL REPORT DEPT. OF MINES

Permit No. 035 1874

Oil or Gas Well \_\_\_\_\_  
(KIND)

Company <u>Kaiser Exploration</u>	CASING AND TUBING	USED IN DRILLING	LEFT IN WELL	PACKERS
Address _____	Size			
Farm <u>R. B. Cass To</u>	16			Kind of Packer _____
Well No. <u>435</u>	13			
District _____ County <u>Saxson</u>	10			Size of _____
Drilling commenced _____	8 1/4			
Drilling completed <u>10 11 83</u> Total depth <u>TD 4390</u>	6 5/8			Depth set _____
Date shot _____ Depth of shot _____	5 3/16			
Initial open flow _____ /10ths Water in _____ Inch	3			Perf. top _____
Open flow after tubing _____ /10ths Merc. in _____ Inch	2			Perf. bottom _____
Volume _____ Cu. Ft.	Liners Used			Perf. top _____
Rock pressure _____ lbs. _____ hrs.				Perf. bottom _____
Oil _____ bbls., 1st 24 hrs.	CASING CEMENTED _____ SIZE _____ No. FT. _____ Date _____			
Fresh water _____ feet _____ feet	NAME OF SERVICE COMPANY _____			
Salt water _____ feet _____ feet	COAL WAS ENCOUNTERED AT _____ FEET _____ INCHES			
	_____ FEET _____ INCHES _____ FEET _____ INCHES			
	_____ FEET _____ INCHES _____ FEET _____ INCHES			

Drillers' Names \_\_\_\_\_

Remarks: 10 11 83 TD 4390  
4347' 4 1/2" pipe cement 200 SKS 50/50 po2 10 3/4 S41T  
1/4 lb. flt seal 1 7/8 lb SAC Gibsonite plug down  
12:30 pm on 10 11 83

10 17 83  
DATE

Jerry Tullh  
OIL & GAS INSPECTOR

09/08/2023



Form 26  
2/16/82

STATE OF WEST VIRGINIA  
DEPARTMENT OF MINES  
OIL AND GAS WELLS DIVISION  
INSPECTOR'S PLUGGING REPORT

Permit No. \_\_\_\_\_

Well No. \_\_\_\_\_

COMPANY \_\_\_\_\_ ADDRESS \_\_\_\_\_

FARM \_\_\_\_\_ DISTRICT \_\_\_\_\_ COUNTY \_\_\_\_\_

Filling Material Used \_\_\_\_\_

Liner		Location		Amount	Packer	Location		
PLUGS USED AND DEPTH PLACED			BRIDGES			CASING AND TUBING		
CEMENT-THICKNESS	WOOD-SIZE	LEAD	CONSTRUCTION-LOCATION		RECOVERED	SIZE	LOST	

Drillers' Names \_\_\_\_\_

Remarks: \_\_\_\_\_

\_\_\_\_\_ I hereby certify I visited the above well on this date.

09/08/2023

DISTRICT WELL INSPECTOR



STATE OF WEST VIRGINIA  
DEPARTMENT OF MINES  
OIL AND GAS WELLS DIVISION

RECEIVED

NOV 3 - 1983

INSPECTOR'S WELL REPORT

OIL & GAS DIVISION  
DEPT. OF MINES  
Oil or Gas Well \_\_\_\_\_  
(KIND)

Permit No. 035 1874

Company <u>Kaiser Exploration</u> Address _____ Farm <u>R. R. Casto</u> Well No. <u>435</u> District _____ County <u>Jackson</u> Drilling commenced _____ Drilling completed _____ Total depth _____ Date shot _____ Depth of shot _____ Initial open flow _____ /10ths Water in _____ Inch Open flow after tubing _____ /10ths Merc. in _____ Inch Volume _____ Cu. Ft. Rock pressure _____ lbs. _____ hrs. Oil _____ bbls., 1st 24 hrs. Fresh water _____ feet _____ feet Salt water _____ feet _____ feet	CASING AND TUBING	USED IN DRILLING	LEFT IN WELL	PACKERS
	Size			Kind of Packer _____
	16			
	13			Size of _____
	10			
	8 1/4			Depth set _____
	6 1/2			
	5 3/16			Perf. top _____
	3			Perf. bottom _____
	2			Perf. top _____
Liners Used			Perf. bottom _____	

CASING CEMENTED \_\_\_\_\_ SIZE \_\_\_\_\_ No. FT. \_\_\_\_\_ Date \_\_\_\_\_

NAME OF SERVICE COMPANY \_\_\_\_\_

COAL WAS ENCOUNTERED AT \_\_\_\_\_ FEET \_\_\_\_\_ INCHES

\_\_\_\_\_ FEET \_\_\_\_\_ INCHES \_\_\_\_\_ FEET \_\_\_\_\_ INCHES

\_\_\_\_\_ FEET \_\_\_\_\_ INCHES \_\_\_\_\_ FEET \_\_\_\_\_ INCHES

Drillers' Names \_\_\_\_\_

Remarks: 10 21 83 call from adjoining landowner. I called Ken Gas + checked pit 5:00pm. Ken Gas + Landowner had built Dike around pit ok.  
10 22 83 pit holding.  
10 24 83 met with Landowners son inspected location, and  
10 24 83 Discussed problems with adjoining landowner,

DATE

Jerry R. [Signature]  
DISTRICT WELL INSPECTOR

09/08/2023



Form 26  
2/16/82

STATE OF WEST VIRGINIA  
DEPARTMENT OF MINES  
OIL AND GAS WELLS DIVISION  
**INSPECTOR'S PLUGGING REPORT**

Permit No. \_\_\_\_\_ Well No. \_\_\_\_\_

COMPANY \_\_\_\_\_ ADDRESS \_\_\_\_\_

FARM \_\_\_\_\_ DISTRICT \_\_\_\_\_ COUNTY \_\_\_\_\_

Filling Material Used \_\_\_\_\_

Liner		Location	Amount	Packer	Location		
PLUGS USED AND DEPTH PLACED			BRIDGES		CASING AND TUBING		
CEMENT-THICKNESS	WOOD-SIZE	LEAD	CONSTRUCTION-LOCATION	RECOVERED	SIZE	LOST	

Drillers' Names \_\_\_\_\_

Remarks: \_\_\_\_\_

DATE

I hereby certify I visited the above well on this date.

09/08/2023

DISTRICT WELL INSPECTOR



STATE OF WEST VIRGINIA  
DEPARTMENT OF MINES  
OIL AND GAS WELLS DIVISION

RECEIVED  
DEC 8 - 1983

OIL & GAS DIVISION

INSPECTOR'S WELL REPORT DEPT. OF MINES

Permit No. 035 1874

Oil or Gas Well \_\_\_\_\_  
(KIND)

Company <u>Kaiser Exploration</u>	CASING AND TUBING	USED IN DRILLING	LEFT IN WELL	PACKERS
Address _____	Size			Kind of Packer _____
Farm <u>CASTO</u>	16			
Well No. _____	13			Size of _____
District _____ County <u>JACKSON</u>	10			
Drilling commenced _____	8 1/4			Depth set _____
Drilling completed _____ Total depth _____	6 5/8			
Date shot _____ Depth of shot _____	5 3/16			Perf. top _____
Initial open flow _____ /10ths Water in _____ Inch	3			
Open flow after tubing _____ /10ths Merc. in _____ Inch	2			Perf. bottom _____
Volume _____ Cu. Ft.	Liners Used			
Rock pressure _____ lbs. _____ hrs.	CASING CEMENTED _____ SIZE _____ No. FT. _____ Date _____			NAME OF SERVICE COMPANY _____
Oil _____ bbls., 1st 24 hrs.	COAL WAS ENCOUNTERED AT _____ FEET _____ INCHES			
Fresh water _____ feet _____ feet	_____ FEET _____ INCHES _____ FEET _____ INCHES			_____ FEET _____ INCHES _____ FEET _____ INCHES
Salt water _____ feet _____ feet	_____ FEET _____ INCHES _____ FEET _____ INCHES			

Drillers' Names \_\_\_\_\_

Remarks: Checked site & Road no present activity

11 2883  
DATE

[Signature] 09/08/2023



Form 26  
2/16/82

STATE OF WEST VIRGINIA  
DEPARTMENT OF MINES  
OIL AND GAS WELLS DIVISION

INSPECTOR'S PLUGGING REPORT

Permit No. \_\_\_\_\_

Well No. \_\_\_\_\_

COMPANY \_\_\_\_\_ ADDRESS \_\_\_\_\_

FARM \_\_\_\_\_ DISTRICT \_\_\_\_\_ COUNTY \_\_\_\_\_

Filling Material Used \_\_\_\_\_

Liner	Location		Amount	Packer	Location		
CEMENT-THICKNESS	PLUGS USED AND DEPTH PLACED		LEAD	CONSTRUCTION-LOCATION	CASING AND TUBING		
	WOOD-SIZE				RECOVERED	SIZE	LOST

Drillers' Names \_\_\_\_\_

Remarks: \_\_\_\_\_

\_\_\_\_\_ DATE I hereby certify I visited the above well on this date.

09/08/2023





**State of West Virginia**  
**Department of Mines**  
**Oil and Gas Division**  
**Charleston 25305**

**FINAL INSPECTION REPORT**  
**INSPECTORS COMPLIANCE REPORT**

COMPANY Kaiser Exploration

PERMIT NO 035 1874

\_\_\_\_\_

FARM & WELL NO Kem 435

\_\_\_\_\_

DIST. & COUNTY Jackson

RULE	DESCRIPTION	IN COMPLIANCE	
		YES	NO
23.06	Notification Prior to Starting Work	X	_____
25.04	Prepared before Drilling to Prevent Waste	X	_____
25.03	High-Pressure Drilling	_____	_____
16.01	Required Permits at Wellsite	C	_____
15.03	Adequate Fresh Water Casing	C	_____
15.02	Adequate Coal Casing	_____	_____
15.01	Adequate Production Casing	X	_____
15.04	Adequate Cement Strenght	X	_____
15.05	Cement Type	X	_____
23.02	Maintained Access Roads	X	_____
25.01	Necessary Equipment to Prevent Waste	X	_____
23.04	Reclaimed Drilling Pits	C	_____
23.05	No Surface or Underground Pollution	X	_____
23.07	Requirements for Production & Gathering Pipelines	X	_____
16.01	Well Records on Site	_____	_____
16.02	Well Records Filed	_____	_____
7.05	Identification Markings	X	_____

I HAVE INSPECTED THE ABOVE CAPTIONED WELL AND RECOMMEND THAT IT BE RELEASED:

SIGNED *Joseph Tepheloh*  
 DATE 10 5 85

Your well record was received and reclamation requirements approved. In accordance with Chapter 22, Article 4, Section 2, the above well will remain under bond coverage for the life of the well.

*T. H. ...*  
 Administrator-Oil & Gas Division

December 28, 1984

DATE

09/08/2023



7-25-83

3,350'

LATITUDE 38-47-30

LONGITUDE 81-40-00

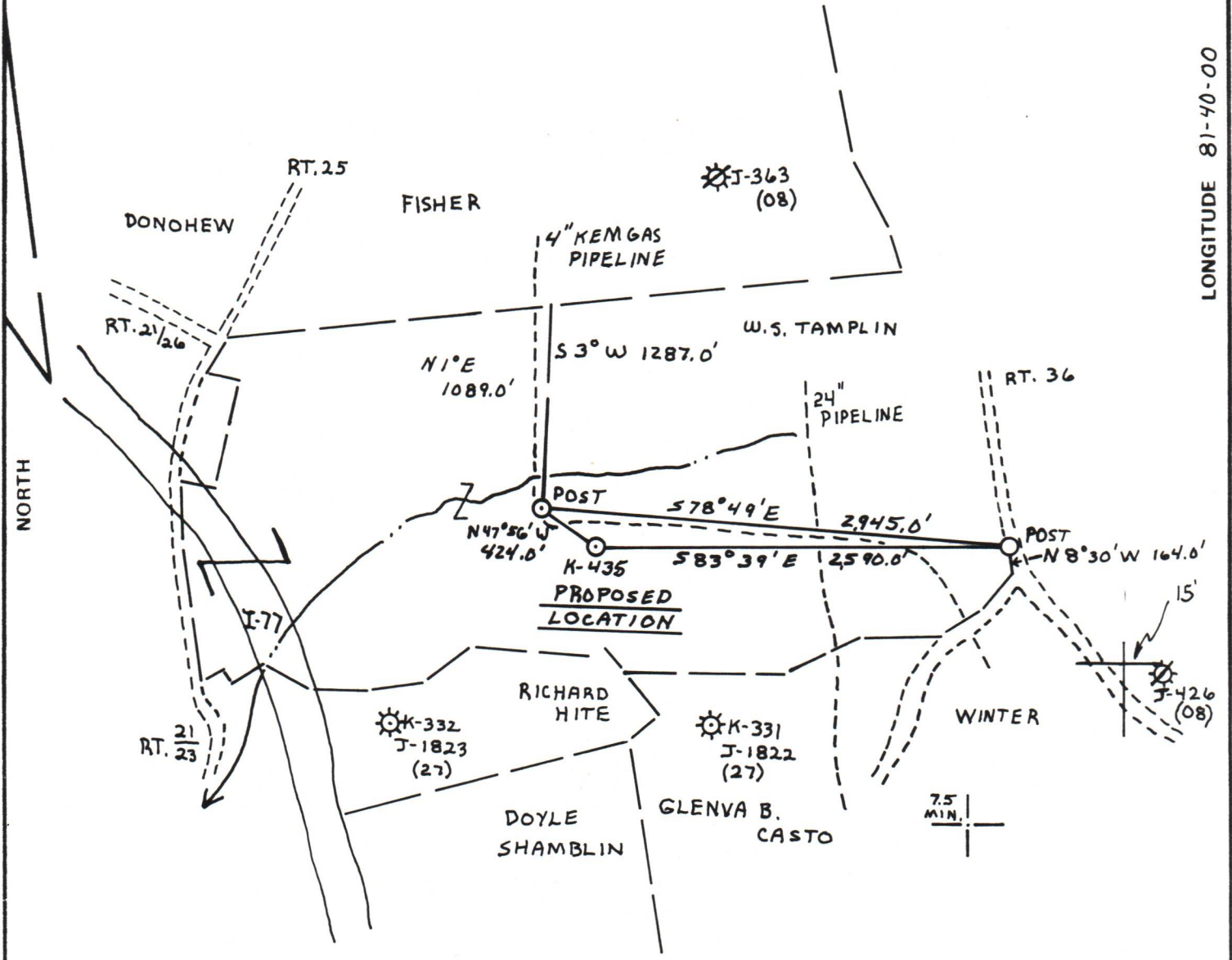

NOTE: K-331R IS 1558' FROM K-435

S 13 E 8

FILE NO. 6-26  
 DRAWING NO. \_\_\_\_\_  
 SCALE 1"=1000'  
 MINIMUM DEGREE OF ACCURACY 1:200  
 PROVEN SOURCE OF ELEVATION ROAD INTERSECTION  
ELEV.=889', 2700' N.E. OF LOCATION

I THE UNDERSIGNED, HEREBY CERTIFY THAT THIS PLAT IS CORRECT TO THE BEST OF MY KNOWLEDGE AND BELIEF AND SHOWS ALL THE INFORMATION REQUIRED BY LAW AND THE REGULATIONS ISSUED AND PRESCRIBED BY THE DEPARTMENT OF MINES.  
 (SIGNED) Vincent N. Wood  
 R.P.E. \_\_\_\_\_ L.L.S. 664

PLACE SEAL HERE

STATE OF WEST VIRGINIA  
 DEPARTMENT OF MINES  
 OIL AND GAS DIVISION



DATE JUNE 16, 19 83  
 OPERATOR'S WELL NO. KEM 435  
 API WELL NO. 47-035-1874  
 STATE COUNTY PERMIT

(+) DENOTES LOCATION OF WELL ON UNITED STATES TOPOGRAPHIC MAPS  
 WELL TYPE: OIL \_\_\_ GAS X LIQUID INJECTION \_\_\_ WASTE DISPOSAL \_\_\_  
 (IF "GAS,") PRODUCTION X STORAGE \_\_\_ DEEP \_\_\_ SHALLOW X  
 LOCATION: ELEVATION 861' WATER SHED GRASSLICK RUN  
 DISTRICT RIPLEY COUNTY JACKSON  
 QUADRANGLE RIPLEY  
 SURFACE OWNER RAYMOND B. CASTO, ET. AL. ACREAGE 152.71  
 OIL & GAS ROYALTY OWNER RAYMOND B. CASTO, ET. AL. LEASE ACREAGE 168.3  
 LEASE NO. 85-04-2932  
 PROPOSED WORK: DRILL X CONVERT \_\_\_ DRILL DEEPER \_\_\_ REDRILL \_\_\_ FRACTURE OR STIMULATE \_\_\_ PLUG OFF OLD FORMATION \_\_\_ PERFORATE NEW FORMATION \_\_\_ OTHER PHYSICAL CHANGE IN WELL (SPECIFY) \_\_\_\_\_  
 PLUG AND ABANDON \_\_\_ CLEAN OUT AND REPLUG \_\_\_  
 TARGET FORMATION DEVONIAN BROWN SHALE ESTIMATED DEPTH 5031'  
 WELL OPERATOR KAISER EXPLD. & MIN. CO. DESIGNATED AGENT KAISER EXPLORATION AND MINING CO.  
 ADDRESS P.O. BOX 8 ADDRESS P.O. BOX 8  
RAVENSWOOD, WV. 26164 RAVENSWOOD, WV. 26164

09/08/2023

H. T. HALL FORM IV-6 (8-78)

JACK: 1814