

RECEIVED
FORM IV-2(B) FILE COPY
APR 18 1984



1) Date: March 12, 19 84
2) Operator's Well No. KEM #547
3) API Well No. 47 - 035 - 1954
State County Permit

OIL & GAS DIVISION
DEPT. OF MINES

STATE OF WEST VIRGINIA
DEPARTMENT OF MINES, OIL AND GAS DIVISION
APPLICATION FOR A WELL WORK PERMIT

- 4) WELL TYPE: A Oil / Gas /
B (If "Gas", Production / Underground storage / Deep / Shallow /)
- 5) LOCATION: Elevation: 700 Watershed: Low Gap Run
District: Ravenswood County: Jackson Quadrangle: Liverpool
- 6) WELL OPERATOR Kaiser Exploration and Mining Co 7) DESIGNATED AGENT R. A. Pryce
Address P. O. Box 8 Address Same
Ravenswood, WV 26164
- 8) OIL & GAS INSPECTOR TO BE NOTIFIED 9) DRILLING CONTRACTOR:
Name Jerry Tephobock Name Clint Hurt
Address Rt. 1, Box 101A Address P. O. Box 388
Ripley, WV 25271 Elkview, WV
- 10) PROPOSED WELL WORK: Drill / Drill deeper / Redrill / Stimulate
Plug off old formation / Perforate new formation
Other physical change in well (specify) _____
- 11) GEOLOGICAL TARGET FORMATION, Devonian Brown Shale
- 12) Estimated depth of completed well, 4320 feet
- 13) Approximate strata depths: Fresh, _____ feet; salt, _____ feet.
- 14) Approximate coal seam depths: _____ Is coal being mined in the area? Yes / No

RECEIVED
MAR 23 1984
OIL & GAS DIVISION
DEPT. OF MINES

15) CASING AND TUBING PROGRAM

CASING OR TUBING TYPE	SPECIFICATIONS				FOOTAGE INTERVALS		CEMENT FILL-UP OR SACKS (Cubic feet)	PACKERS
	Size	Grade	Weight per ft.	New	Used	For drilling		
Conductor								Kinds
Fresh water	10 3/4"			X		250	250	150 sks class A to surface
Coal								Sizes
Intermediate	7"			X		2425	2425	65 sks 50/50 pozmix, 100 sks class
Production	4 1/2"			X		4320	4320	225 sks 50/50 Dep Pozmix
Tubing								
Liners								Perforations: Top Bottom

OFFICE USE ONLY
DRILLING PERMIT

Permit number 47-035-1954 Date May 2, 19 84

This permit covering the well operator and well location shown below is evidence of permission granted to drill in accordance with the pertinent legal requirements subject to the conditions contained herein and on the reverse hereof. **Notification must be given to the District Oil and Gas Inspector, (Refer to No. 8) Prior to the construction of roads, locations and pits for any permitted work.** In addition, the well operator or his contractor shall notify the proper district oil and gas inspector 24 hours before actual permitted work has commenced.)

The permitted work is as described in the Notice and Application, plat, and reclamation plan, subject to any modifications and conditions specified on the reverse hereof.

Permit expires May 2, 1986 unless well work is commenced prior to that date and prosecuted with due diligence.

Bond: BLANKET	Agent: <u>lo</u>	Plat: <u>T5</u>	Casing: <u>T5</u>	Fee: <u>966-498</u>
----------------------	------------------	-----------------	-------------------	---------------------

T. J. ...
Administrator, Office of Oil and Gas

NOTE: Keep one copy of this permit posted at the drilling location.

See the reverse side of the APPLICANT'S COPY for instructions to the well operator.

09/08/2023

File

5/4



OFFICE USE ONLY

PERMIT MODIFICATIONS AND CONDITIONS (IF ANY) TO THE PROPOSED WELL WORK

RECEIVED

DEPT. OF MINES OIL & GAS DIVISION

OFFICE USE ONLY

This part of Form IV-2(b) is to record the dates of certain occurrences and any follow-up inspections.

Date

Date(s)

Application received

Follow-up inspection(s)

Well work started

Completion of the drilling process

Well Record received

Reclamation completed

OTHER INSPECTIONS

Reason:

Reason:

Blacked	Acct:	Plan	Casing	Fee
---------	-------	------	--------	-----

09/08/2028



IV-9
(Rev 8-81)

DATE April 6, 1984

WELL NO. KEM #547 Revised

State of West Virginia

API NO. 47-035-1954

Department of Mines
Oil and Gas Division

CONSTRUCTION AND RECLAMATION PLAN

COMPANY NAME Kaiser Exploration and Mining Co DESIGNATED AGENT R. A. Pryce

Address P. O. Box 8, Ravenswood, WV

Address Same

Telephone 273-5371

Telephone _____

LANDOWNER Burke Parsons Bowlby

SOIL CONS. DISTRICT Western

Revegetation to be carried out by Kaiser Exploration and Mining Company (Agent)

This plan has been reviewed by [Signature] SCD. All corrections and additions become a part of this plan: Apr 6 1984 (Date)

[Signature]
(SCD Agent)

ACCESS ROAD

LOCATION

Structure Drainage Ditch (A)

Structure Top diversion ditch (1)

Spacing Earthen

Material Earthen

Page Ref. Manual 2:12

Page Ref. Manual 2:12

Structure Road Culverts (B)

Structure _____ (2)

Spacing 16" diameter

Material _____

Page Ref. Manual 2.7

Page Ref. Manual _____

Structure _____ (C)

Structure _____ (3)

Spacing _____

Material _____

Page Ref. Manual _____

Page Ref. Manual _____

All structures should be inspected regularly and repaired if necessary. All commercial timber is to be cut and stacked and all brush and small timber to be cut and removed from the site before dirt work begins.

RECEIVED
APR 18 1984
OIL & GAS DIVISION
DEPT. OF MINES

REVEGETATION

Treatment Area I

Treatment Area II

Line 4 Tons/acre
or correct to pH _____

Line Same as Area I Tons/acre
or correct to pH _____

Fertilizer 14-14-14 600 lbs/acre
(10-20-20 or equivalent)

Fertilizer _____ lbs/acre
(10-20-20 or equivalent)

Mulch Hay 2 Tons/acre

Mulch _____ Tons/acre

Seed* 81% Orchard Grass/15% Ry 16 lbs/acre

Seed* _____ lbs/acre

Kentucky 31 Fescue 16 lbs/acre

_____ lbs/acre

Red Clover 8 lbs/acre

_____ lbs/acre

*Inoculate all legumes such as vetch, trefoil and clovers with the proper bacterium. Inoculate with 3X recommended amount.

PLAN PREPARED BY Vincent Wood 09/08/2023

ADDRESS 116 Ppost Avenue

Ripley, WV 25271

PHONE NO. 372-2709

NOTES: Please request landowner's cooperation to protect new seedling for one growing season. Attach separate sheets as necessary for comments.

ATTACH OR PHOTOCOPY SECTION OF INVOLVED TOPOGRAPHIC MAP. QUADRANGLE LIVERPOOL

LEGEND













Well Site 

Access Road 



Sketch to include well location, existing access road, roads to be constructed, wellsite, drilling pits and necessary structures numbered or lettered to correspond with the first part of this plan. Include all natural drainage.

LEGEND

Property boundary 	Diversion 
Road 	Spring 
Existing fence 	Wet spot 
Planned fence 	Building 
Stream 	Drain pipe 
Open ditch 	Waterway 

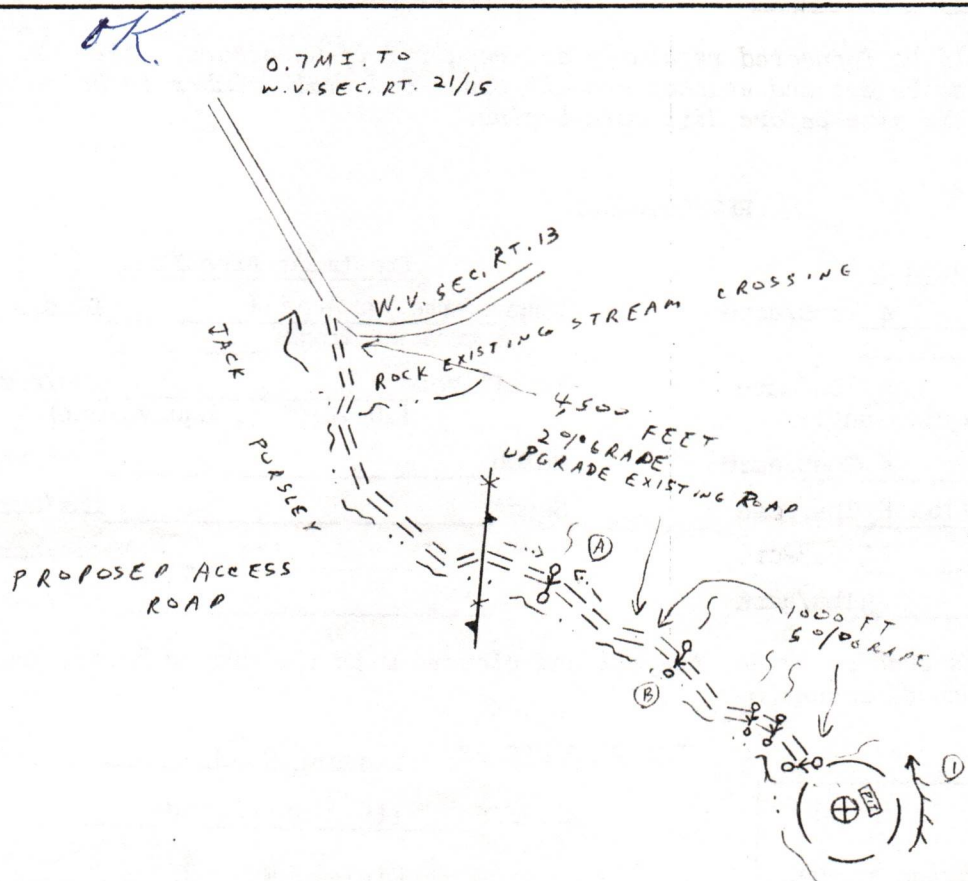

09/08/2023
PROPOSED LOCATION ON WOODED RIB

1) Date: March 12, 1984
2) Operator's Well No. KEM #547
3) API Well No. 47-035-1954
State County Permit

STATE OF WEST VIRGINIA
DEPARTMENT OF MINES, OFFICE OF OIL & GAS
NOTICE OF APPLICATION FOR A WELL WORK PERMIT

4) SURFACE OWNER(S) OF RECORD TO BE SERVED

5(i) COAL OPERATOR None
Address _____

(i) Name Burke, Parsons, and Bowlby
Address P. O. Box 231
Ripley, WV 25271

5(ii) COAL OWNER(S) WITH DECLARATION ON RECORD:
Name None
Address _____

(ii) Name _____
Address _____

Name _____
Address _____

(iii) Name _____
Address _____

5(iii) COAL LESSEE WITH DECLARATION ON RECORD:
Name None
Address _____

TO THE PERSON(S) NAMED ABOVE: You should have received this Form and the following documents:

- (1) The Application for a Well Work Permit on Form IV-2(B) (or Form IV-4 if the well is to be plugged, which sets out the parties involved in the drilling or other work, and describes the well and its location and, if applicable, the proposed casing and cementing program;
- (2) The plat (surveyor's map) showing the well location on Form IV-6; and
- (3) The Construction and Reclamation Plan on Form IV-9 (unless the well work is only to plug a well), which sets out the plan for erosion and sediment control and for reclamation for the site and access road.

THE REASON YOU RECEIVED THESE DOCUMENTS IS THAT YOU HAVE RIGHTS REGARDING THE APPLICATION WHICH ARE SUMMARIZED IN THE "INSTRUCTIONS" ON THE REVERSE SIDE OF THE COPY OF THE APPLICATION (FORM IV-2(B) OR FORM 4, DESIGNATED FOR YOU. HOWEVER, YOU ARE NOT REQUIRED TO TAKE ANY ACTION AT ALL.

RECEIVED
MAR 23 1984

Take notice that under Chapter 22 of the West Virginia Code, the undersigned well operator proposes to file or has filed this Notice and Application and accompanying documents for a Well Work Permit with the Administrator of the Office of Oil and Gas, West Virginia Department of Mines, with respect to a well at the location described on attached Application and depicted on attached Form IV-6. Copies of this Notice, the Application, the plat, and the Construction and Reclamation Plan have been mailed by registered or certified mail or delivered by hand to the person(s) named above (or by publication in certain circumstances) on or before the day of mailing or delivery to the Administrator.

OIL & GAS DIVISION
DEPT. OF MINES

6) EXTRACTION RIGHTS

Check and provide one of the following:

- Included is the lease or leases or other continuing contract or contracts by which I hold the right to extract oil or gas.
- The requirement of Code 22-4-1-(c) (1) through (4). (See reverse side for specifics.)

7) ROYALTY PROVISIONS

Is the right to extract, produce or market the oil or gas based upon a lease or leases or other contract or contracts providing for flat well royalty or any similar provision for compensation to the owner of the oil or gas in place which is not inherently related to the volume of oil or gas so extracted, produced or marketed? Yes (No)

If the answer above is No, nothing additional is needed. If the answer is Yes, you may use Affidavit Form IV-60.

DEPT. OF MINES
OIL & GAS DIVISION

RECEIVED
APR 18 1984

See the reverse side for line item instructions, and for instructions concerning the required copies of the Notice and Application, plat, and Construction and Reclamation Plan.

The truth of the information on the Notice and Application is verified and sworn to and the Notice is signed on behalf of the Well Operator in my County and State by

WELL OPERATOR Kaiser Exploration and Mining Company

R. A. Pryce
this 3 day of April, 1984.
My commission expires 8/30, 1993.

By [Signature]
Its General Manager
Address P. O. Box 8
Ravenswood, WV 26164
Telephone 304 273 5371

[Signature]
Notary Public, Jackson County,
State of West Virginia

09/08/2023

I N S T R U C T I O N S T O A P P L I C A N T

CONCERNING THE LINE ITEMS:

- 1) Date of Notice.
- 2) Your well name and number.
- 3) To be filled out by the Office of Oil & Gas.
- 4) & 5) Use separate sheet if necessary.
- 4) Surface owner(s) of record to be served with Notice and Application. However, see also Code § 22-4-1b(b) if "more than three tenants in common or other co-owners of interest described in subsection (a) of this section hold interests in such lands".
- 5(i) "Coal Operator" means any person, firm, partnership, partnership association or corporation that proposes to or does operate a coal mine.
- 5(ii, iii) See Code § 22-4-20.
- 6) See Code § 22-4-11(c). However, in lieu of filing the lease(s) or other continuing contract(s), the Applicant may fill out the information in the space provided below.
- 7) See Code § § 22-4-11(d, e).

CONCERNING THE REQUIRED COPIES FOR FILING AND SERVICE:

Filing. Code § 22-4-1k and Regulation 7.02 provide that the original and required copies of the Notice and Application must be filed with the Administrator, accompanied by (i) a plat in the form prescribed by Regulation 11, (ii) a bond in one of the forms prescribed by Regulation 12, or in lieu thereof the other security allowed by Code § 22-4-1k(d) and the reclamation required by Code § 22-4-12b and Regulation 23, (iv) unless previously paid on the same well, the fees required by Code § 22-4-1a(c) and 22-3-12a, and (v) if applicable, the consent required by Code § 22-4-8a from the owner of any water well on dwelling within 200 feet of the proposed well.

Service. In addition, service must be made on the surface owner(s) and the person(s) with an interest in the coal. See Code § § 22-4-1m, 22-4-2, 22-4-2a, and 22-4-2b.

INFORMATION SUPPLIED UNDER CODE § 22-4-11(d)

IN LIEU OF FILING LEASE(S) AND OTHER CONTINUING CONTRACT(S)

Under the oath required to make the verification on the obverse side of this Notice, I depose and say that I am the person who signed the Notice for the Applicant, and that--

- (1) the tract of land is the same tract described in the Application to which this Notice applies, partly or wholly depicted in the accompanying plat, and described in the Construction and Reclamation Plan;
- (2) the parties and recordation data (if recorded) for lease(s) or other continuing contract(s) by which the Applicant claims the right to extract, produce or market the oil or gas are as follows:

<u>Grantor, lessor, etc.</u>	<u>Grantee, lessee, etc.</u>	<u>Royalty</u>	<u>Book Page</u>
Delphia M. O'Dell et al	Kaiser Exploration and Mining Company	1/8 of prevailing field price	175/49
			175/725
			187/1
			186/28

AFFIDAVIT OF PERSONAL SERVICE ON SURFACE OWNER

STATE OF West Va,
COUNTY OF JACKSON:

The undersigned, being first duly sworn, says that the undersigned served a true and complete copy of all sides of--

- (1) Notice on Form IV-2(A) X / Form IV-3(A) / Form IV-4(A) /
- (2) Application on Form IV-2(B) X / Form IV-3(B) / Form IV-4(B) /
- (3) Plat showing the well location on Form IV-6. and
- (4) Construction and Reclamation Plan on Form IV-9 (unless the application is to plug a well)

--all with respect to operator's Well No. KEM 547 located in Ravenswood District, JACKSON County, West Virginia, upon the person or organization named--

BURKE, PARSONS, BOWLBY Corp

--by delivering the same in JACKSON County, State of West Va. on the 21 day of March, 1984 in the manner specified below.

[COMPLETE THE APPROPRIATE SECTION]

For an individual:

[] Handing it to him / her / or, because he / she / refused to take it when I offered it, by leaving it in his / her / presence.

[] Handing it to a member of his or her family above the age of 16 years named _____ who resides at the usual place of abode of the person to be served, and asking the family member to give it to the person to be served as soon as possible.

For a partnership:

[] Handing it to _____, a partner of the partnership or, because the partner refused to take it when I handed it over, by leaving it in the presence of the partner.

For a limited partnership:

[] Handing it to the general partner, named _____, or, because the general partner refused to take it when I tried to hand it over, by leaving it in the presence of the general partner.

For a corporation:

[X] Handing it to the corporation's employee X / officer / director / attorney in fact / named PAM DEEM.

RECEIVED
MAR 23 1984

[Signature]
(Signature of person executing service)

OIL & GAS DIVISION

Taken, subscribed and sworn before me this 22 day of March, 1984. My commission expires OCT 28, 1993.

[Signature]
Notary Public
Commissioner

(AFFIX SEAL IF NOTARIZED IF OUTSIDE THE STATE)

09/08/2023



RECEIVED
OIL & GAS DIVISION
DEPT. OF REVENUE

09/08/2023

STATE OF WEST VIRGINIA
INFORMATION MEMO

TO: WIMC DATE: 5-22
FROM: Mike Lewis TIME: _____
OF: _____ RECD. BY _____

TELEPHONE NUMBER EXT.

- PLEASE CALL
- WILL CALL AGAIN
- RETURNING YOUR CALL
- CALLED TO SEE YOU

THE ATTACHED PAPERS ARE REFERRED

PLEASE:

- SIGN
- COMMENT
- NOTE
- AS REQUESTED
- FOR YOUR INFORMATION
- APPROVE
- SEE ME
- PREPARE REPLY FOR MY SIGNATURE
- REPLY DIRECTLY WITH COPY TO ME
- TAKE APPROPRIATE ACTION
- RETURN
- ROUTE TO: _____
- FILE

REMARKS/MESSAGE: Gave Walter Morgan (KEM Gas) verbal approval to plug if necessary on 5-23 A.M.

<u>TD → Berea</u>	<u>100' plug</u>	<u>50'-Surface</u>
<u>salt sand</u>	<u>100' plug</u>	<u>Cement</u>
<u>225'-325'</u>	<u>100' plug</u>	

Klenese -
 Must have
 well record
 (IV-35)
 Margaret

28 4541922

POSTAGE AND FEE

INSURANCE COVERAGE PROVIDED—
NOT FOR INTERNATIONAL MAIL
 (See Reverse)

SENT TO		Burke Parsons Bowler	
STREET AND NO.		Rt. 21 South	
P.O., STATE AND ZIP CODE		Ripley, W.V. 25271	
POSTAGE		\$	
CONSULT POSTMASTER FOR FEES	CERTIFIED FEE	\$	
	SPECIAL DELIVERY	\$	
	RESTRICTED DELIVERY	\$	
	OPTIONAL SERVICES	\$	
	RETURN RECEIPT SERVICE	\$	
	SHOW TO WHOM AND DATE DELIVERED	\$	
SHOW TO WHOM, DATE, AND ADDRESS OF DELIVERY	\$		
SHOW TO WHOM AND DATE DELIVERED WITH RESTRICTED DELIVERY	\$		
SHOW TO WHOM, DATE AND ADDRESS OF DELIVERY WITH RESTRICTED DELIVERY	\$		
TOTAL POSTAGE AND FEES		\$	
POSTMARK OR DATE			

K-537 P4A

PS Form 3800, Apr. 1976

RECEIVED
JUN 13 1984

OIL & GAS DIVISION
 DEPT. OF MINES

RECEIVED
JUN 21 1984

OIL & GAS DIVISION
 DEPT. OF MINES

09/08/2023

09/08/2023



IV-35
(Rev 8-81)

State of West Virginia
Department of Mines
Oil and Gas Division

Date Sept. 17, 1984
Operator's Well No. KEM 547 O'Dell
Farm _____
API No. 47 -035 - 1954

WELL OPERATOR'S REPORT
OF
DRILLING, FRACTURING AND/OR STIMULATING, OR PHYSICAL CHANGE

WELL TYPE: Oil x / Gas x / Liquid Injection ___ / Waste Disposal ___ /
(If "Gas," Production x / Underground Storage ___ / Deep ___ / Shallow x /)

LOCATION: Elevation: 700 Watershed Low Gap Run
District: Ravensood County Jackson Quadrangle Liverpool

COMPANY Kaiser Exploration and Mining Company
ADDRESS P.O. Box 8, Ravenswood, WV 26164
DESIGNATED AGENT R. A. Pryce
ADDRESS P.O. Box 8, Ravenswood, WV 26164
SURFACE OWNER Burke, Parsons, and Bowlby, Corp.
ADDRESS _____
MINERAL RIGHTS OWNER Delphia M. O'Dell, et al
ADDRESS _____
OIL AND GAS INSPECTOR FOR THIS WORK Jerry
Tephabock ADDRESS Rt. 1 Box 101A, Ripley
PERMIT ISSUED _____
DRILLING COMMENCED 5-19-84
DRILLING COMPLETED 5-24-84
IF APPLICABLE: PLUGGING OF DRY HOLE ON
CONTINUOUS PROGRESSION FROM DRILLING OR
REWORKING. VERBAL PERMISSION OBTAINED
ON _____

Casing & Tubing	Used in Drilling	Left in Well	Cement fill up Cu. ft.
Size 20-16 Cond.			
^{10 3/4"} 13-10"	253.5'	253.5'	150 sx Class A
9 5/8			
8 5/8	No casing or cement		
7	Well was plugged on 5/24/84		
5 1/2	with verbal consent from state		
4 1/2			
3			
2			
Liners used			

GEOLOGICAL TARGET FORMATION Berea Sandstone Depth 2376 feet
Depth of completed well 2470' feet Rotary x / Cable Tools _____
Water strata depth: Fresh NA feet; Salt NA feet
Coal seam depths: NA Is coal being mined in the area? No
Drilled on fluid - not known

OPEN FLOW DATA

Producing formation _____ Pay zone depth _____ feet
Gas: Initial open flow 0 Mcf/d Oil: Initial open flow 0 Bbl/d
Final open flow _____ Mcf/d Final open flow _____ Bbl/d
Time of open flow between initial and final tests _____ hours
Static rock pressure _____ psig (surface measurement) after _____ hours shut in
(If applicable due to multiple completion--)
Second producing formation _____ Pay zone depth 09/08/2023 feet
Gas: Initial open flow _____ Mcf/d Oil: Initial open flow _____ Bbl/d
Final open flow _____ Mcf/d Oil: Final open flow _____ Bbl/d
Time of open flow between initial and final tests _____ hours
Static rock pressure _____ psig (surface measurement) after _____ hours shut in

(Continue on reverse side)

DETAILS OF PERFORATED INTERVALS, FRACTURING OR STIMULATING, PHYSICAL CHANGE, ETC.

- Plugged on 5/24/84 B. J. Hughes Cement
- 1) Run 12 BBl Class A, 2% CaCl₂ from 2436' KB- 2300'KB plug Berea
 - 2) Run 54.4 BBl of 6% GEL from 2300' KB-1678'KB
 - 3) Run 8.7 BBl Class A cement, 2% CaCl₂ from 1678'KB to plug salt sands
 - 4) Run 110.4 BBl of 6% Bel from 15.78' KB-342'KB
 - 5) Run 32 BBl Class A cement, 2% CaCl from 342' KB to surface
- Plugged at 1:45 AM

WELL LOG

FORMATION	COLOR	HARD OR SOFT	TOP FEET	BOTTOM FEET	REMARKS
					Including indication of all fresh and salt water, coal, oil and gas
Soil and Shale			0	82	
Shale and Siltstone			82	338	
Sand			338	348	
Shale			348	488	
Pittsburgh Sand			488	573	
Shale			573	622	
Sand			622	664	
Shale			664	1070	
Donkard Sands			1070	1386	
Shale and Siltstone			1386	1680	
Salt Sands			1680	1820	
Big Lime (Greenbrier)			1820	1918	
Shale			1918	1948	
Big Injun Sand			1948	2007	
Shale			2007	2360	
Coffe Shale (Sunbury)			2360	2376	
Berea Horizon			2376	---	NO SAND
Shale			2376	2436	
Total Depth			2436		

(Attach separate sheets as necessary)

R. W. Durr
Well Operator

By: KAISER EXPLORATION AND MINING CO. 09/08/2023

Date: November 12, 1984

Note: Regulation 2.02(i) provides as follows:
"The term 'log' or 'well log' shall mean a systematic detailed geological record of all formations, including ..., encountered in the drilling of a well."

STATE OF WEST VIRGINIA
DEPARTMENT OF MINES
OIL AND GAS WELLS DIVISION

RECEIVED
MAY 30 1984

INSPECTOR'S WELL REPORT

OIL & GAS DIVISION
DEPT. OF MINES

Permit No. 035 1954

Oil or Gas Well _____
(KIND)

Company <u>Kaiser Exploration</u>	CASING AND TUBING	USED IN DRILLING	LEFT IN WELL	PACKERS
Address _____	Size			
Farm <u>02111 Randolph</u>	16			Kind of Packer _____
Well No. <u>Kem #347</u>	13			
District _____ County <u>Jackson</u>	10			Size of _____
Drilling commenced _____	8 1/4			
Drilling completed _____ Total depth _____	6 5/8			Depth set _____
Date shot _____ Depth of shot _____	5 3/16			
Initial open flow _____ /10ths Water in _____ Inch	3			Perf. top _____
Open flow after tubing _____ /10ths Merc. in _____ Inch	2			Perf. bottom _____
Volume _____ Cu. Ft.	Liners Used			Perf. top _____
Rock pressure _____ lbs. _____ hrs.				Perf. bottom _____
Oil _____ bbls., 1st 24 hrs.	CASING CEMENTED _____ SIZE _____ No. FT. _____ Date _____			
Fresh water _____ feet _____ feet	NAME OF SERVICE COMPANY _____			
Salt water _____ feet _____ feet	COAL WAS ENCOUNTERED AT _____ FEET _____ INCHES			
	_____ FEET _____ INCHES _____ FEET _____ INCHES			
	_____ FEET _____ INCHES _____ FEET _____ INCHES			

Drillers' Names _____

Hurt Rig #4

Remarks: TD 13 1/4 hole 270' ran 6 jts 10 3/4 csg set 263.5 KB Cement Hughes 150 sacs class A neat 3% cacl 1/4 lb per sac off celeflake plug down 7 am .

5 21 84

DATE

Jing T. [Signature]
09/08/2023

Form 26
2/16/82

STATE OF WEST VIRGINIA
DEPARTMENT OF MINES
OIL AND GAS WELLS DIVISION

RECEIVED
MAY 30 1984

INSPECTOR'S PLUGGING REPORT

OIL & GAS DIVISION

DEPT. OF MINES

Permit No. 035.1954 P

COMPANY Kaiser Exploration ADDRESS _____

FARM Odell DISTRICT _____ COUNTY Jackson

Filling Material Used Gel and Class A neat

Liner			Location	Amount	Packer	Location		
PLUGS USED AND DEPTH PLACED			BRIDGES			CASING AND TUBING		
CEMENT-THICKNESS	WOOD-SIZE	LEAD	CONSTRUCTION-LOCATION			RECOVERED	SIZE	LOST
						None	103/4	263.5'

Drillers' Names _____

Hurt

Remarks:

5 23 84 TD 2436' Base off Breara 2376' Spotted plug 2436 to 2300 cement,
Gel 2300 to 1680 top off salt sand set cement plug 1580 1680
Gel to 328' cement to surface. will set monument when rig is off.
Cement by BJ Hughes finished 1;30 am 5 24 84

5 24 84 I hereby certify I visited the above well on this date.

DATE

Jeffrey T. Tophel
08/08/2023

STATE OF WEST VIRGINIA
DEPARTMENT OF MINES
OIL AND GAS WELLS DIVISION

INSPECTOR'S WELL REPORT

Permit No. _____

Oil or Gas Well _____
(KIND)

Company _____ Address _____ Farm _____ Well No. _____ District _____ County _____ Drilling commenced _____ Drilling completed _____ Total depth _____ Date shot _____ Depth of shot _____ Initial open flow _____ /10ths Water in _____ Inch Open flow after tubing _____ /10ths Merc. in _____ Inch Volume _____ Cu. Ft. Rock pressure _____ lbs. _____ hrs. Oil _____ bbls., 1st 24 hrs. Fresh water _____ feet _____ feet Salt water _____ feet _____ feet	CASING AND TUBING	USED IN DRILLING	LEFT IN WELL	PACKERS
	Size			Kind of Packer _____
	16			
	13			Size of _____
	10			
	8 1/4			Depth set _____
	6 5/8			
	5 3/16			Perf. top _____
	3			Perf. bottom _____
	2			Perf. top _____
	Liners Used			Perf. bottom _____

CASING CEMENTED _____ SIZE _____ No. FT. _____ Date _____

NAME OF SERVICE COMPANY _____

COAL WAS ENCOUNTERED AT _____ FEET _____ INCHES

_____ FEET _____ INCHES _____ FEET _____ INCHES

_____ FEET _____ INCHES _____ FEET _____ INCHES

Drillers' Names _____

Remarks: _____

09/08/2023



1) Date: May 29, 19 84
2) Operator's Well No. KEM - 547 O'Dell
3) API Well No. 47 - 035 - 1954-P
State County Permit

RECEIVED
NOV 13 1984

STATE OF WEST VIRGINIA
OFFICE OF OIL AND GAS, DEPARTMENT OF MINES

APPLICATION FOR A PERMIT TO PLUG AND ABANDON A WELL

OIL & GAS DIVISION
DEPT. OF MINES

- 4) WELL TYPE: A Oil / Gas _____ / Liquid injection _____ / Waste disposal _____
B (if "Gas" Production _____ / Underground storage) _____ / Deep _____ / Shallow /
- 5) LOCATION: Elevation: 720 Watershed: Low Gap Run
District: Ravenswood County: Jackson Quadrangle: Liverpool
- 6) WELL OPERATOR Kaiser Expl. and Mining Co. 7) DESIGNATED AGENT R. RYCE
Address P.O. Box 8 Address same address
Ravenswood, WV 26164
- 8) OIL & GAS INSPECTOR TO BE NOTIFIED 9) PLUGGING CONTRACTOR
Name Jerry Tephabock Name Clint Hurt
Address Rt. 1, Box 101-A Address P.O. Box 388
Ripley, WV 25271 Elkview, WV

10) WORK ORDER: The work order for the manner of plugging this well is as follows:
Received verbal approval to plug and abandon well from Department of Oil and Gas 5/23/84.
(Mike Liwis)

Top of Berea = 2376' KB
Top of Salt Sands = 1680' KB
10 3/4" casing set at 253' KB

- 1) Run 12 bbl Class A cement, 2% CaCl from 2436'KB to 2300'KB to plug Berea
- 2) Run 54.4 bbl of 6% Gel from 2300'KB to 1678'KB
- 3) Run 8.7 bbl Class A cement, 2% CaCl from 1678'KB to 1578'KB to plug Salt Sands.
- 4) Run 110.5 bbl of 6% Gel from 1578'KB to 342'KB.
- 5) Run 32 bbl Class A cement, 2% CaCl from 342'KB to surface.

RECEIVED
JUN 21 1984
OIL & GAS DIVISION
DEPT. OF MINES

OFFICE USE ONLY

PLUGGING PERMIT

Permit number 47-035-1954-P

May 23 19 84
Date

This permit covering the well operator and well location shown below is evidence of permission granted to plug in accordance with the pertinent legal requirements subject to the conditions contained herein and on the reverse hereof. **Notification must be given to the District Oil and Gas Inspector 24 hours before actual permitted work has commenced.**

The permitted work is as described in the Notice and Application, plat, subject to any modifications and conditions on the reverse hereof.

Permit expires May 23, 1986 unless plugging is commenced prior to that date and prosecuted with due diligence.

Bond:	Agent:	Plat:	Casing:	Fee:
<u>Blanket</u>	<u>MA</u>	<u>TS</u>	<u>TS</u>	<u>NF</u>

Margaret J. Kasse
Administrator, Office of Oil and Gas

NOTE: Keep one copy of this permit posted at the plugging location.

File

See the reverse side of the APPLICANT'S COPY for instructions to the well operator.

09/08/2023

OFFICE USE ONLY

PERMIT MODIFICATIONS AND CONDITIONS (IF ANY) TO THE PROPOSED PLUGGING

1) LOCATION: Blaine, District, KY 40315-000
 2) WELL OPERATOR: KATSONE EXP. DRILLING CO.
 3) PLUGGING CONTRACTOR: [Name]
 4) DESIGNATED AGENT: KATRICE [Name]

OFFICE USE ONLY

This part of Form IV-4(b) is to record the dates of certain occurrences and any follow-up inspections.

	Date	Follow-up inspection(s)	Date(s)
Application received			
Plugging started		" "	
Plugging completed		" "	
Well Record received		" "	

OTHER INSPECTIONS

Reason: _____

Reason: _____

Signature: [Handwritten Signature]
 Date: [Handwritten Date]



1) Date: May 20, 19 84
2) Operator's Well No. KEM - 547 O'Dell
3) API Well No. 47 - 035 - 125-P
State County Permit

STATE OF WEST VIRGINIA
OFFICE OF OIL AND GAS, DEPARTMENT OF MINES

APPLICATION FOR A PERMIT TO PLUG AND ABANDON A WELL

- 4) WELL TYPE: A Oil X / Gas _____ / Liquid injection _____ / Waste disposal _____
B (If "Gas", Production _____ / Underground storage) _____ / Deep _____ Shallow X /)
- 5) LOCATION: Elevation: 720 Watershed: Low Gap Run
District: Ravenswood County: Jackson Quadrangle: Liverpool
- 6) WELL OPERATOR Kaiser Expt. and Mining Co. 7) DESIGNATED AGENT _____
Address P.O. Box 8 Address _____
Ravenswood, WV 26164
- 8) OIL & GAS INSPECTOR TO BE NOTIFIED 9) PLUGGING CONTRACTOR
Name Jerry Tephabock Name Clint Hurt
Address Rt. 1, Box 101-A Address P.O. Box 388
Ripley, WV 25271 Elkview, WV

WORK ORDER: The work order for the manner of plugging this well is as follows:

Received verbal approval to plug and abandon well from Department of Oil and Gas 5/23/84.
(Mike Lewis)

Top of Berea = 2376' KB
Top of Salt Sands = 1680' KB
10 3/4" casing set at 253' KB

- 1) Run 12 bbl Class A cement, 2% CaCl from 2436'KB to 2300'KB to plug Berea.
- 2) Run 54.4 bbl of 6% Gel from 2300'KB to 1678'KB
- 3) Run 8.7 bbl Class A cement, 2% CaCl from 1678'KB to 1578'KB to plug Salt Sands.
- 4) Run 110.5 bbl of 6% Gel from 1578'KB to 342'KB.
- 5) Run 32 bbl Class A cement, 2% CaCl from 342'KB to surface.

47-035-1954-P

May 23

May 23, 1986

**INSTRUCTION TO COAL OPERATORS
OWNERS AND LESSEE**

The well operator named on the obverse side of IV-4(b) is about to abandon the well described in the enclosed materials and will commence the work of plugging and abandoning said well on the date the inspector is notified (which date shall not be less than five days after the day on which this notice and application so mailed is received, or in due course should be received by the Department of Mines, Office Oil & Gas).

This notice and application is given to you in order that your respective representatives may be present at the plugging and filling of said well. You are further notified that whether you are represented or not represented the operator will proceed to plug and fill said well in the manner required by Section 10, Article 4, Chapter 22 of the Code and given in detail on obverse side of this application.

NOTE: If you wish this well to be plugged according to 22-4-10(d) then as per Regulation 17:05 you must complete and return to this office on IV-16 "Request by Coal Operator, Owner, or lessee for plugging under Code 22-4-10(d)" prior to the issuance of this plugging permit.

Form 17-1 (Rev. 12/20/80/60) [8-83]



STATE OF WEST VIRGINIA
OFFICE OF OIL AND GAS, DEPARTMENT OF MINES
NOTICE OF APPLICATION TO PLUG AND ABANDON A WELL

1) Date: May 29 19 84
2) Operator's Well No. KEM-547 0'De11
3) API Well No. 47 - 035 - 1954
State County Permit

4) SURFACE OWNER(S) OF RECORD TO BE SERVED

(1) Name Burke, Parsons & Bowlby Corp.
Address Rt. 21 South
Ripley, WV 25271

(11) Name
Address

(111) Name
Address

5 (111) COAL LESSEE WITH DECLARATION ON RECORD:
Name
Address

5 (11) COAL OWNERS(S) WITH DECLARATION ON RECORD:
Name
Address

5 (1) COAL OPERATOR
Name
Address

TO THE PERSON(S) NAMED ABOVE: You should have received this form and the following documents:

- (1) The application to plug and abandon a well on Form IV-4(B), which sets out the parties involved in the work, and describes the well and its location and the plugging work order; and
- (2) The plat (surveyor's map) showing the well location on Form IV-6.

THE REASON YOU RECEIVED THESE DOCUMENTS IS THAT YOU HAVE RIGHTS REGARDING THE APPLICATION WHICH ARE SUMMARIZED IN THE "INSTRUCTIONS" ON THE REVERSE SIDE OF THE COPY OF THE APPLICATION (FORM IV-4(B)) DESIGNATED FOR YOU. HOWEVER, YOU ARE NOT REQUIRED TO TAKE ANY ACTION AT ALL.

Take notice that under Chapter 22 of the West Virginia Code, the undersigned well operator proposes to file or has filed this Notice and Application and accompanying documents for a permit to plug and abandon a well with the Administrator of the Office of Oil and Gas, West Virginia Department of Mines, with respect to the well at the location described on the attached Application and depicted on the attached Form IV-6. Copies of this Notice, the Application, and the plat have been mailed by registered or certified mail or delivered by hand to the person(s) named above (or by publication in certain circumstances) on or before the day of mailing or delivery to the Administrator.

The truth of the information on the Notice and Application is verified and sworn to and the Notice is signed on behalf of the well Operator in my County and State by

Operator's Name: R.A. RICE
this 15 day of June, 19 84
My commission expires 8/30, 19 93

Notary Public, Jackson County, State of West Virginia

Telephone 304-273-5371
Address P. O. Box 8 Ravenswood, WV 26164

By: R.A. RICE
Its General Manager
OPERATOR Kaiser Exploration and Mining Co.

RECEIVED JUN 21 1984

RECEIVED NOV 18 1984

OIL & GAS DIVISION DEPT. OF MINES

OIL & GAS DIVISION DEPT. OF MINES

See the reverse side for Line Item Instructions, and for other instructions concerning the required copies of the Notice and Application and the plat, etc.

I N S T R U C T I O N S T O A P P L I C A N T

CONCERNING THE LINE ITEMS:

- 1) Date of Notice.
- 2) Your well name and number.
- 3) To be filled out by the Office of Oil & Gas.
- 4) & 5) Use separate sheet if necessary.
- 4) Surface owner(s) of record to be served with Notice and Application. However, see also Code § 22-4-1m(b) if "more than three tenants in common or other co-owners of interest described in subsection (a) of this section hold interests in such lands".
- 5(i) "Coal Operator" means any person, firm, partnership, partnership association or corporation that proposes to or does operate a coal mine.
- 5(ii, iii) See Code § 22-4-20.

CONCERNING THE REQUIRED COPIES FOR FILING AND SERVICE:

Filing. Code § 22-4-1k and Regulation 7.02 provide that the original and two copies of the Application must be filed with the Administrator, accompanied by (i) an original and four copies of the Notice, (ii) an original and four copies of a plat in the form prescribed by Regulation 11, and (iii) a bond in one of the forms prescribed by Regulation 12, or in lieu thereof the other security allowed by Code § 22-4-9.

Service. In addition, service must be made on the surface owner(s) and the person(s) with an interest in the coal. See Code §§ 22-4-1m and 22-4-9.

Delphia M. O'Dell et al Kaiser Exploration and Mining Co. 1/8 of prevailing 175/49
field price 175/725
187/1
186/28

STATE OF WEST VIRGINIA
DEPARTMENT OF MINES
OIL AND GAS WELLS DIVISION

AFFIDAVIT OF PLUGGING AND FILLING WELL

AFFIDAVIT SHOULD BE MADE IN TRIPPLICATE. ONE COPY MAILED TO THE DEPARTMENT, ONE COPY TO BE RETAINED BY THE WELL OPERATOR AND THE THIRD COPY (AND EXTRA COPIES IF REQUIRED) SHOULD BE MAILED TO EACH COAL OPERATOR AT THEIR RESPECTIVE ADDRESSES.

RECEIVED
NOV 17 1984

None
COAL OPERATOR OR OWNER
Kaiser Exploration and Mining Company
NAME OF WELL OPERATOR
P. O. Box 8 Ravenswood, WV 26164
OIL & GAS DIVISION DEPT. OF MINES
COMPLETE ADDRESS
None
November 21 1984
COAL OPERATOR OR OWNER
WELL AND LOCATION
Ravenswood District
ADDRESS
Burke, Parsons & Bowlby
LEASE OR PROPERTY OWNER
Jackson County
Rt. 21 South, Ripley, WV 25271
Well No. KEM 547-Delphia O'Dell
47-035-1954
Delphia M. O'Dell, et al Farm

STATE INSPECTOR SUPERVISING PLUGGING..... Jerry Tephabock

AFFIDAVIT

STATE OF WEST VIRGINIA,

County of Jackson

SS:

Clint Hurt & Associates; Rig #2 crew
and Walter Morgan

Larry Moore being first duly sworn according to law depose and say that they are experienced in the work of plugging and filling oil and gas wells and were employed by Kaiser Exploration and Mining Co. well operator, and participated in the work of plugging and filling the above well, that said work was commenced on the 23 day of May, 1984, and that the well was plugged and filled in the following manner:

SAND OR ZONE RECORD	FILLING MATERIAL	PLUGS USED	CASING	
			CSG PULLED	CSG LEFT IN
FORMATION		SIZE & KIND		
	Cement Surface - 328'	10 3/4" csg.	-0-	253"
	Gel 328' - 1580'			
Salt sand top 1680'	Cement 1580' - 1680'			
	Gel 1680' - 2300'			
Berea top 2376'	Cement 2300' - 2436'			
	Total Depth 2436'			
	Erect monument as prescribed by law			
COAL SEAMS		DESCRIPTION OF MONUMENT		
(NAME)		7" casing 30" above surface with		
(NAME)		inscription: KEM 547 Plugged		
(NAME)		5-24-84 API 47-035-1954		
(NAME)		Kaiser Exploration and Mining Co.		

and that the work of plugging and filling said well was completed on the 24th day of May, 1984.

And further deponents saith not.

Larry Moore
Walter Morgan
09/08/2023

Sworn to and subscribed before me this 12 day of December, 1984.

Denese Carney
Notary Public.
Permit No. JAC-1954

My commission expires:
August 30, 1990

TRK-1954



State of West Virginia

Department of Mines

Oil and Gas Division

Charleston 25305

FINAL INSPECTION REPORT
INSPECTORS COMPLIANCE REPORT
January 25, 1984

RECEIVED

FEB 4 - 1985

OIL & GAS DIVISION
DEPT. OF MINES

COMPANY Kaiser Exp. & Mining Co.

PERMIT NO 035-1954-P

P. O. Box 8

FARM & WELL NO Burke-Parsons-Bowlby #KEM-547

Ravenswood, West Virginia 26164

DIST. & COUNTY Ravenswood/Jackson

RULE	DESCRIPTION	IN COMPLIANCE	
		Yes	No
23.06	Notification Prior to Starting Work	<input checked="" type="checkbox"/>	<input type="checkbox"/>
16.01	Required Permits at Wellsite	<input checked="" type="checkbox"/>	<input type="checkbox"/>
17.02	Method of Plugging	<input checked="" type="checkbox"/>	<input type="checkbox"/>
18.01	Materials used in Plugging	<input checked="" type="checkbox"/>	<input type="checkbox"/>
23.02	Maintained Access Roads	<input checked="" type="checkbox"/>	<input type="checkbox"/>
25.01	Necessary Equipment to Prevent Waste	<input checked="" type="checkbox"/>	<input type="checkbox"/>
23.04	Reclaimed Drilling Pits	<input checked="" type="checkbox"/>	<input type="checkbox"/>
23.05	No Surface or Underground Pollution	<input checked="" type="checkbox"/>	<input type="checkbox"/>
17.06	Statutory Affidavit	<input type="checkbox"/>	<input type="checkbox"/>
7.06	Parties Responsible	<input type="checkbox"/>	<input type="checkbox"/>
7.05	Identification Markings	<input checked="" type="checkbox"/>	<input type="checkbox"/>

I HAVE INSPECTED THE ABOVE CAPTIONED WELL AND RECOMMEND THAT IT BE RELEASED:

SIGNED *James M. Tepheloch*
DATE 1 28 85

Your Affidavit of Plugging was received and reclamation requirements approved.
The well designated by the above permit number has been released under your bond.

T. H. ...
Administrator-Oil & Gas Division

February 8, 1985

DATE

4,400'

LATITUDE 38° 55' 00"

REFERENCE POINTS:
S 69° 44' E 168' TO 22" B.OAK
N 27° 23' E 265' TO 14" W.OAK

LONGITUDE 81° 35' 00"

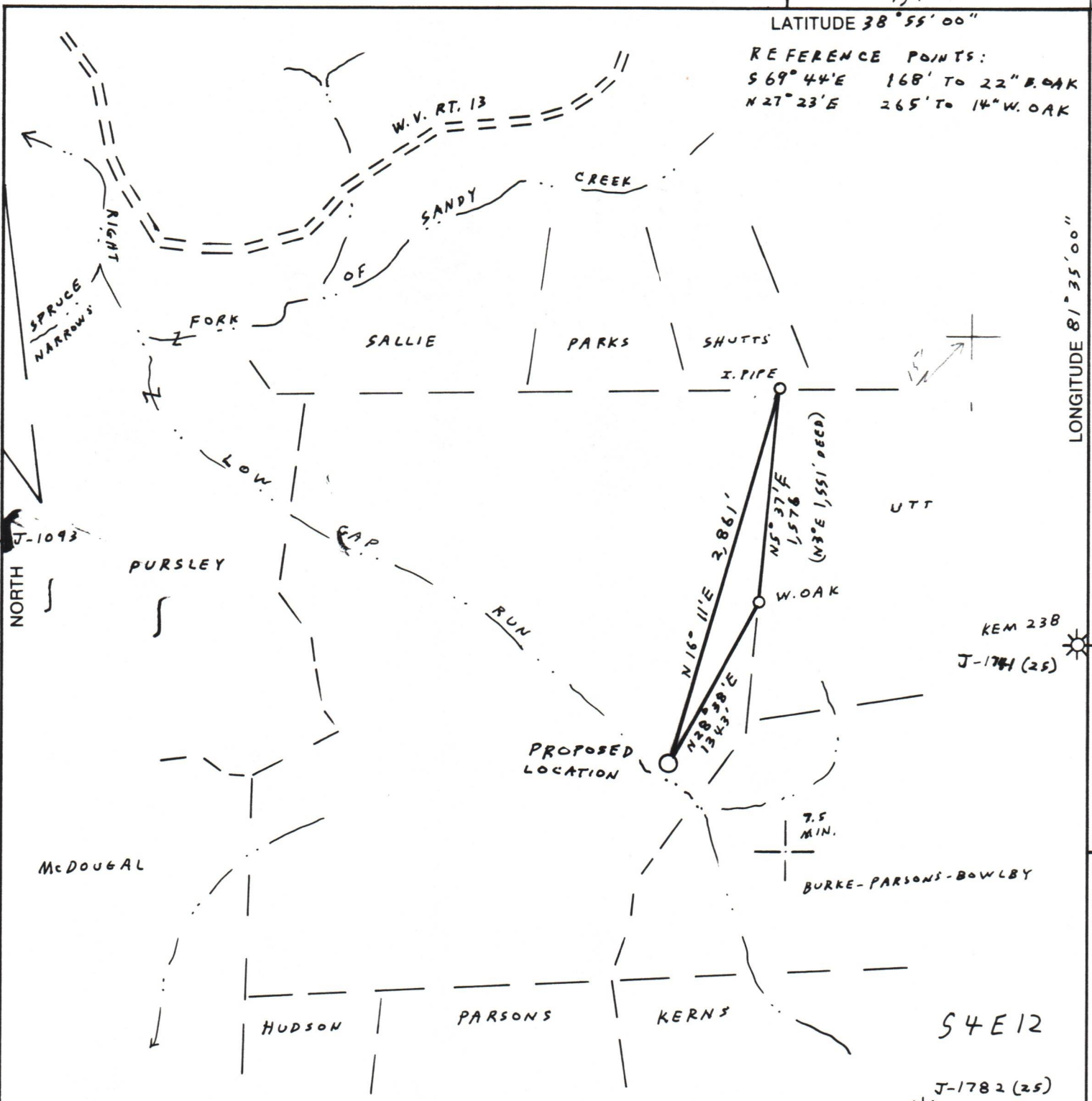

(+) DENOTES LOCATION OF WELL ON UNITED STATES TOPOGRAPHIC MAPS

FILE NO. 7-23
 DRAWING NO. REV. NO. 1
 SCALE 1" = 1,000'
 MINIMUM DEGREE OF ACCURACY 1:200
 PROVEN SOURCE OF ELEVATION HIGH POINT ELEV. 1081, 2,900' N.E. OF LOCATION

I THE UNDERSIGNED, HEREBY CERTIFY THAT THIS PLAT IS CORRECT TO THE BEST OF MY KNOWLEDGE AND BELIEF AND SHOWS ALL THE INFORMATION REQUIRED BY LAW AND THE REGULATIONS ISSUED AND PRESCRIBED BY THE DEPARTMENT OF MINES.
 (SIGNED) Vincent W. Wood
 R.P.E. _____ L.L.S. 664

PLACE SEAL HERE

STATE OF WEST VIRGINIA
 DEPARTMENT OF MINES
OIL AND GAS DIVISION



DATE APRIL 6, 1984
 OPERATOR'S WELL NO. KEM 547
 API WELL NO. _____

WELL TYPE: OIL ___ GAS X LIQUID INJECTION ___ WASTE DISPOSAL ___
 (IF "GAS,") PRODUCTION X STORAGE ___ DEEP ___ SHALLOW X
 LOCATION: ELEVATION 720 WATER SHED LOW GAP RUN
 DISTRICT RAVENSWOOD COUNTY JACKSON
 QUADRANGLE LIVER POOL
 SURFACE OWNER BURKE, PARSONS AND BOWLBY CORPORATION ACREAGE 3/0
 OIL & GAS ROYALTY OWNER DELPHIA M. O'DELL, ET AL. LEASE ACREAGE 3/0
 LEASE NO. 88-11-2649

PROPOSED WORK: DRILL X CONVERT ___ DRILL DEEPER ___ REDRILL ___ FRACTURE OR STIMULATE X PLUG OFF OLD FORMATION ___ PERFORATE NEW FORMATION ___ OTHER PHYSICAL CHANGE IN WELL (SPECIFY) _____

PLUG AND ABANDON ___ CLEAN OUT AND REPLUG ___
 TARGET FORMATION DEVONIAN BROWN SHALE ESTIMATED DEPTH 4320'
 WELL OPERATOR KAISER EXPLORATION & MINING CO. DESIGNATED AGENT KAISER EXPLORATION & MINING CO.
 ADDRESS P.O. BOX 8, RAVENSWOOD, W.V. 26164 ADDRESS P.O. BOX 8, RAVENSWOOD, W.V. 26164

COUNTY NAME JACKSON
 PERMIT 1954

FORM IV-6 (8-78)
 H.T. HALL

09/08/2023