

FILE COPY



1) Date: June 7, 19 84
 2) Operator's Well No. KEM 577
 3) API Well No. 47 - 035 - 1976
 State County Permit

STATE OF WEST VIRGINIA
 DEPARTMENT OF MINES, OIL AND GAS DIVISION
 DEPT. OF MINES
APPLICATION FOR A WELL WORK PERMIT

- 4) WELL TYPE: A Oil / Gas X /
 B (If "Gas", Production X / Underground storage / Deep / Shallow X)
- 5) LOCATION: Elevation: 804 Watershed: Buffalolick Run (03222)
 District: Ripley 3 County: Jackson Quadrangle: Ripley 577
- 6) WELL OPERATOR Kaiser Expl. & Mining Co. 255507 DESIGNATED AGENT Kaiser Expl. & Mining Co.
 Address P.O. Box 8 Address P.O. Box 8 R. A. Pryce
Ravenswood, WV 26164 Ravenswood, WV 26164
- 8) OIL & GAS INSPECTOR TO BE NOTIFIED Name Jerry Tephacock
 Address Rt. 1, Box 101A
Ripley, WV 25271
- 9) DRILLING CONTRACTOR: Name Clint Hurt
 Address P.O. Box 388
Elkview, WV 25071
- 10) PROPOSED WELL WORK: Drill X / Drill deeper / Redrill / Stimulate X /
 Plug off old formation / Perforate new formation /
 Other physical change in well (specify)
- 11) GEOLOGICAL TARGET FORMATION, Devonian Brown Shale
- 12) Estimated depth of completed well 4370' feet
- 13) Approximate strata depths: Fresh, N/A feet; salt, N/A feet.
- 14) Approximate coal seam depths: N/A Is coal being mined in the area? Yes / No X
- 15) CASING AND TUBING PROGRAM

CASING OR TUBING TYPE	SPECIFICATIONS					FOOTAGE INTERVALS		CEMENT FILL-UP OR SACKS (Cubic feet)	PACKERS
	Size	Grade	Weight per ft.	New	Used	For drilling	Left in well		
Conductor									Kinds
Fresh water	10 3/4"			X		335'250	335'250	150 sks	Class A (to surface)
Coal									Sizes
Intermediate	7"			X		2210'	2210'	65 sks 50/50	pozmix, 100 sks Clas
Production	4 1/2"			X		4370'	4370'	225 sks	Depths set 50/50 pozmix
Tubing									
Liners									Perforations:
									Top Bottom

OFFICE USE ONLY
 DRILLING PERMIT

Permit number 47-035-1976

July 9, 19 84
 Date

This permit covering the well operator and well location shown below is evidence of permission granted to drill in accordance with the pertinent legal requirements subject to the conditions contained herein and on the reverse hereof. **Notification must be given to the District Oil and Gas Inspector, (Refer to No. 8) Prior to the construction of roads, locations and pits for any permitted work.** In addition, the well operator or his contractor shall notify the proper district oil and gas inspector 24 hours before actual permitted work has commenced.)

The permitted work is as described in the Notice and Application, plat, and reclamation plan, subject to any modifications and conditions specified on the reverse hereof.

Permit expires July 9, 1986 unless well work is commenced prior to that date and prosecuted with due diligence.

Bond: <u>Blanket</u>	Agent: <u>LP</u>	Plat: <u>MH</u>	Casing: <u>MH</u>	Fee: <u>967 594</u>
----------------------	------------------	-----------------	-------------------	---------------------

T. R. ...
 Administrator, Office of Oil and Gas

NOTE: Keep one copy of this permit posted at the drilling location.

See the reverse side of the APPLICANT'S COPY for instructions to the well operator.

09/08/2023

File

OFFICE USE ONLY

PERMIT MODIFICATIONS AND CONDITIONS (IF ANY) TO THE PROPOSED WELL WORK

1) LOCATION: District: Madison County: Jackson Elevation: Washed Well: Shallow

2) WELL OPERATOR: Name: Jerry Tebbok Address: P.O. Box 8 Ravenswood, W.V. 26184

3) DRILLING CONTRACTOR: Name: Clint Hurt Address: P.O. Box 335 Elkview, W.V. 26037

4) PROPOSED WELL WORK: Drill depth: Drill Refrill Stimulate

5) GEOLOGICAL TARGET FORMATION: Devonian Brown Shale

6) APPROXIMATE COAL SEAM DEPTH: 10 feet

7) APPROXIMATE TRAP DEPTH: 10 feet

8) ESTIMATED DEPTH OF COMPLETED WELL: 10 feet

9) IS COAL BEING MINED IN THE AREA: Yes No

OFFICE USE ONLY

This part of Form IV-2(b) is to record the dates of certain occurrences and any follow-up inspections.

	Date	Date(s)
Application received		
Well work started		
Completion of the drilling process		
Well Record received		
Reclamation completed		

OTHER INSPECTIONS

Reason: _____
Reason: _____

Body	Agent	Part	Casing	Log

09/08/2023



1) Date: June 7, 19 84
 2) Operator's Well No. KEM 577
 3) API Well No. 47
 State _____ County _____ Permit _____

STATE OF WEST VIRGINIA
 DEPARTMENT OF MINES, OIL AND GAS DIVISION
APPLICATION FOR A WELL WORK PERMIT

- 4) WELL TYPE: A Oil _____ / Gas X /
 B (If "Gas", Production X / Underground storage _____ / Deep _____ / Shallow X /)
- 5) LOCATION: Elevation: 804 Watershed: Buffallick Run (03262)
 District: Ripley County: Jackson Quadrangle: Ripley
- 6) WELL OPERATOR Kaiser Expl. & Mining Co. 7) DESIGNATED AGENT Kaiser Expl. & Mining Co.
 Address P.O. Box 8 Ravenswood, WV 26164 Address P.O. Box 8 R. A. Pryce Ravenswood, WV 26164
- 8) OIL & GAS INSPECTOR TO BE NOTIFIED 9) DRILLING CONTRACTOR:
 Name Jerry Tephabeck Name Clint Hurt
 Address Rt. 1, Box 101A Ripley, WV 25271 Address P.O. Box 388 Elkview, WV 25071
- 10) PROPOSED WELL WORK: Drill X / Drill deeper _____ / Redrill _____ / Stimulate X /
 Plug off old formation _____ / Perforate new formation _____
 Other physical change in well (specify) _____
- 11) GEOLOGICAL TARGET FORMATION, Devonian Brown Shale
- 12) Estimated depth of completed well, 4370' feet
- 13) Approximate strata depths: Fresh, N/A feet; salt, N/A feet.
- 14) Approximate coal seam depths: N/A Is coal being mined in the area? Yes _____ / No X /

15) CASING AND TUBING PROGRAM

CASING OR TUBING TYPE	SPECIFICATIONS					FOOTAGE INTERVALS		CEMENT FILL-UP OR SACKS (Cubic feet)	PACKERS
	Size	Grade	Weight per ft.	New	Used	For drilling	Left in well		
Conductor									Kinds
Fresh water	<u>10 3/4"</u>			<u>X</u>		<u>335-250</u>	<u>335-250</u>	<u>180 sfs</u>	<u>Class A (to surface)</u>
Coal									Sizes
Intermediate	<u>7"</u>			<u>X</u>		<u>2210'</u>	<u>2210'</u>	<u>65 sfs 50/50 pozmix</u>	<u>100 sfs Class</u>
Production	<u>4 1/2"</u>			<u>X</u>		<u>4370'</u>	<u>4370'</u>	<u>225 sfs</u>	Depths set <u>50/50 pozmix</u>
Tubing									
Liners									Perforations: Top _____ Bottom _____

INSTRUCTIONS TO COAL OPERATOR, OWNER, OR LESSEE

The named coal operator, coal owner(s), and coal lessee are hereby notified that any objection they wish to make or are required to make by Code §22-4-3 must be filed with the Department of Mines within fifteen (15) days after the receipt of this Application by the Department.

The following waiver must be completed by the coal operator and by any coal owner or coal lessee who has recorded a declaration under Code §22-4-20, if the permit is to be issued within fifteen (15) days of the filing of the Application.

WAIVER

The undersigned coal operator _____ / owner _____ / lessee _____ / of the coal under this well location has examined this proposed well location. If a mine map exists which covers the area of the well location, the well location has been added to the mine map. The undersigned has no objection to the work proposed to be done at this location, provided, the well operator has complied with all applicable requirements of the West Virginia Code and the governing regulations.

Date: _____, 19 _____ By: _____
 Its: _____

09/08/2023
 Coal Owner

09/08/2023



IV-9
(Rev 8-81)

DATE May 7, 1984
WELL NO. KEM #577
API NO. 47-035-1976

State of West Virginia
Department of Mines
Oil and Gas Division

CONSTRUCTION AND RECLAMATION PLAN

COMPANY NAME Kaiser Exploration and Mining Co. DESIGNATED AGENT R. A. Pryce
Address P. O. Box 8, Ravenswood, WV 26164 Address Same
Telephone 273-5371 Telephone _____
LANDOWNER Glenn Thompson SOIL CONS. DISTRICT Western
Revegetation to be carried out by Kaiser Exploration and Mining Company (Agent)

This plan has been reviewed by Western SCD. All corrections and additions become a part of this plan: May 10 1984 (Date)
Walter E. Hughes (SCD Agent)

ACCESS ROAD

LOCATION

Structure Cross Drains (A)
Spacing 250'
Page Ref. Manual 2-4

Structure None Required (1)
Material _____
Page Ref. Manual _____

Structure _____ (B)
Spacing _____
Page Ref. Manual _____

Structure _____ (2)
Material _____
Page Ref. Manual _____

Structure _____
Spacing _____
Page Ref. Manual _____

Structure _____ (3)
Material _____
Page Ref. Manual _____

RECEIVED
JUN 27 1984
OIL & GAS DIVISION
DEPT. OF MINES

RECEIVED
JUN 21 1984
OIL & GAS DIVISION
DEPT. OF MINES

All structures should be inspected regularly and repaired if necessary. All commercial timber is to be cut and stacked and all brush and small timber to be cut and removed from the site before dirt work begins.

REVEGETATION

Treatment Area I

Treatment Area II

Lime 4 Tons/acre
or correct to pH _____
Fertilizer 14-14-14 600 lbs/acre
(10-20-20 or equivalent)
Mulch Hay 2 Tons/acre
Seed* 81% Orchard Grass/15% Ryegrass 16 lbs/acre
Kentucky 31 Fescue 16 lbs/acre
Red Clover 8 lbs/acre

Lime Same as area I Tons/acre
or correct to pH _____
Fertilizer _____ lbs/acre
(10-20-20 or equivalent)
Mulch _____ Tons/acre
Seed* _____ lbs/acre
_____ lbs/acre
_____ lbs/acre

*Inoculate all legumes such as vetch, trefoil and clovers with the proper bacterium. Inoculate with 3X recommended amount.

PLAN PREPARED BY Vincent Wood 09/08/2023

ADDRESS 116 Post Avenue
Ripley, WV 25271

PHONE NO. 372-2709

NOTES: Please request landowner's cooperation to protect new seedling for one growing season. Attach separate sheets as necessary for comments.

AFFIDAVIT OF PERSONAL SERVICE ON SURFACE OWNER

STATE OF West Virginia,
COUNTY OF JACKSON :

The undersigned, being first duly sworn, says that the undersigned served a true and complete copy of all sides of--

- (1) Notice on Form IV-2(A) / Form IV-3(A) / Form IV-4(A) /
- (2) Application on Form IV-2(B) / Form IV-3(B) / Form IV-4(B) /
- (3) Plat showing the well location on Form IV-6. and
- (4) Construction and Reclamation Plan on Form IV-9 (unless the application is to plug a well)

--all with respect to operator's Well No. K 577 located in Ripley District, JACKSON County, West Virginia, upon the person or organization named--

Glenn Thompson

--by delivering the same in JACKSON County, State of WV on the 17 day of JUNE, 1984 in the manner specified below.

[COMPLETE THE APPROPRIATE SECTION]

For an individual:

- [] Handing it to him / her / or, because he / she / refused to take it when I offered it, by leaving it in his her / presence.
- [] Handing it to a member of his or her family above the age of 16 years named _____ who resides at the usual place of abode of the person to be served, and asking the family member to give it to the person to be served as soon as possible.

For a partnership:

- [] Handing it to _____, a partner of the partnership or, because the partner refused to take it when I handed it over, by leaving it in the presence of the partner.

For a limited partnership:

- [] Handing it to the general partner, named _____, or, because the general partner refused to take it when I tried to hand it over, by leaving it in the presence of the general partner.

For a corporation:

- [] Handing it to the corporation's employee / officer / director / attorney in fact / named _____.

William K. Brown
(Signature of person executing service)

JUN 21 1984

OIL & GAS DIVISION
DEPT. OF MINES

Taken, subscribed and sworn before me this 15 day of June, 1984.
My commission expires OCT 28, 1993

Stephen W. Kelly
Notary Public

(AFFIX SEAL IF NOTARIZED IF OUTSIDE THE STATE)

COMMISSIONER FOR THE STATE OF WV

09/08/2023



RECEIVED
 JUL 23 1924
 OIL & GAS DIVISION
 DEPT. OF MINES





1) Date: June 7, 19 84
 2) Operator's Well No. KCM 577
 3) API Well No. 47 State County Permit

*House Pipeline Row
For Roadway
Thompson*

**STATE OF WEST VIRGINIA
DEPARTMENT OF MINES, OIL AND GAS DIVISION
APPLICATION FOR A WELL WORK PERMIT**

- 4) WELL TYPE: A Oil / Gas X /
 B (If "Gas", Production X / Underground storage / Deep / Shallow X /)
- 5) LOCATION: Elevation: 804 Watershed: Buffalolick Run
 District: Ripley County: Jackson Quadrangle: Ripley
- 6) WELL OPERATOR Kaiser Expl. & Mining Co. 7) DESIGNATED AGENT Kaiser Expl. & Mining Co.
 Address P.O. Box 2 Address P.O. Box 3 R.A. Payne
Ravenswood, WV 26164 Ravenswood, WV 26164
- 8) OIL & GAS INSPECTOR TO BE NOTIFIED 9) DRILLING CONTRACTOR:
 Name Larry Tophbeck Name Clint Hurt
 Address Rt. 1, Box 101A Address P.O. Box 283
Ripley, WV 25271 Elkview, WV 25071
- 10) PROPOSED WELL WORK: Drill X / Drill deeper / Redrill / Stimulate X /
 Plug off old formation / Perforate new formation
 Other physical change in well (specify)
- 11) GEOLOGICAL TARGET FORMATION, Devonian Brown Shale
- 12) Estimated depth of completed well, 4370' feet
 13) Approximate strata depths: Fresh, N/A feet; salt, N/A feet.
 14) Approximate coal seam depths: N/A Is coal being mined in the area? Yes / No X /

15) CASING AND TUBING PROGRAM

CASING OR TUBING TYPE	SPECIFICATIONS					FOOTAGE INTERVALS		CEMENT FILL-UP OR SACKS (Cubic feet)	PACKERS
	Size	Grade	Weight per ft.	New	Used	For drilling	Left in well		
Conductor									Kinds
Fresh water	<u>10 3/4"</u>			<u>X</u>		<u>250'</u>	<u>250'</u>	<u>150 sks</u>	<u>Class A (to surface)</u>
Coal									Sizes
Intermediate	<u>7"</u>			<u>X</u>		<u>2210'</u>	<u>2210'</u>	<u>65 sks 50/50</u>	<u>poznix, 100 sks Clas</u>
Production	<u>4 1/2"</u>			<u>X</u>		<u>4370'</u>	<u>4370'</u>	<u>225 sks</u>	Depths set <u>50/50 poznix</u>
Tubing									
Liners									Perforations:
									Top Bottom

The law requires a comment period for surface owners. However, the permit can be issued in less than 15 days from the filing of the Application if the surface owner(s) of record sign(s) the following "Voluntary Statement of No Objection" on a facsimile of this surface owner's copy of the Application.

VOLUNTARY STATEMENT OF NO OBJECTION

I hereby state that I have read the instructions to surface owners on the reverse side of this Application for a Well Work Permit, and that I have received copies of (1) a Notice of Application for a Well Work Permit on Form IV-2(A), (2) an Application for a Well Work Permit on Form IV-2(B), (3) a survey plat on Form IV-6, and (4) a Construction and Reclamation Plan on Form IV-9, all for proposed well work on my surface land as described therein.

I further state that I have no objection to the planned work described in these materials, and I have no objection to a permit being issued based on those materials.

(For execution by corporation, partnership, etc.)
 NAME: _____
 By _____
 Its _____ Date _____

(For execution by natural persons)
 _____ Date: _____
 (Signature)
 _____ Date: _____
 (Signature)

09/08/2023
Surface Owner

1) Date: June 7, 1984
2) Operator's Well No. KEM 577
3) API Well No. 47-035-1976
State County Permit

STATE OF WEST VIRGINIA
DEPARTMENT OF MINES, OFFICE OF OIL & GAS

NOTICE OF APPLICATION FOR A WELL WORK PERMIT

4) SURFACE OWNER(S) OF RECORD TO BE SERVED

(i) Name Glen Thompson
Address Tug Fork Road
Ripley, WV 25271
(ii) Name _____
Address _____
(iii) Name _____
Address _____

5(i) COAL OPERATOR _____
Address _____

5(ii) COAL OWNER(S) WITH DECLARATION ON RECORD:
Name _____
Address _____

Name _____
Address _____

5(iii) COAL LESSEE WITH DECLARATION ON RECORD:
Name _____
Address _____

TO THE PERSON(S) NAMED ABOVE: You should have received this Form and the following documents:

- (1) The Application for a Well Work Permit on Form IV-2(B) (or Form IV-4 if the well is to be plugged, which sets out the parties involved in the drilling or other work, and describes the well and its location and, if applicable, the proposed casing and cementing program;
- (2) The plat (surveyor's map) showing the well location on Form IV-6; and
- (3) The Construction and Reclamation Plan on Form IV-9 (unless the well work is only to plug a well), which sets out the plan for erosion and sediment control and for reclamation for the site and access road.

THE REASON YOU RECEIVED THESE DOCUMENTS IS THAT YOU HAVE RIGHTS REGARDING THE APPLICATION WHICH ARE SUMMARIZED IN THE "INSTRUCTIONS" ON THE REVERSE SIDE OF THE COPY OF THE APPLICATION (FORM IV-2(B) OR FORM 4, DESIGNATED FOR YOU. HOWEVER, YOU ARE NOT REQUIRED TO TAKE ANY ACTION AT ALL.

Take notice that under Chapter 22 of the West Virginia Code, the undersigned well operator proposes to file or has filed this Notice and Application and accompanying documents for a Well Work Permit with the Administrator of the Office of Oil and Gas, West Virginia Department of Mines, with respect to a well at the location described on attached Application and depicted on attached Form IV-6. Copies of this Notice, the Application, the plat, and the Construction and Reclamation Plan have been mailed by registered or certified mail or delivered by hand to the person(s) named above (or by publication in certain circumstances) on or before the day of mailing or delivery to the Administrator.

6) EXTRACTION RIGHTS

Check and provide one of the following:

- Included is the lease or leases or other continuing contract or contracts by which I hold the right to extract oil or gas.
- The requirement of Code 22-4-1-(c) (1) through (4). (See reverse side for specifics.)

7) ROYALTY PROVISIONS

Is the right to extract, produce or market the oil or gas based upon a lease or leases or other contract or contracts providing for flat well royalty or any similar provision for compensation to the owner of the oil or gas in place which is not inherently related to the volume of oil or gas so extracted, produced or marketed? Yes No

If the answer above is No, nothing additional is needed. If the answer is Yes, you may use Affidavit Form IV-60.

See the reverse side for line item instructions, and for instructions concerning the required copies of the Notice and Application, plat, and Construction and Reclamation Plan.

The truth of the information on the Notice and Application is verified and sworn to and the Notice is signed on behalf of the Well Operator in my County and State by

Robert A. Pryce
this 11 day of June, 1984.
My commission expires August 30 1993.

Dorene Carney
Notary Public, Jackson County,
State of West Virginia

WELL

OPERATOR Kaiser Exploration and Mining Co

By R A P
Its General Manager

Address P.O. Box 8

Ravenswood, WV 26164
Telephone (304) 273-5371

RECEIVED
JUN 27 1984

OIL & GAS DIVISION

DEPT. OF MINES

I N S T R U C T I O N S T O A P P L I C A N T

CONCERNING THE LINE ITEMS:

- 1) Date of Notice.
- 2) Your well name and number.
- 3) To be filled out by the Office of Oil & Gas.
- 4) & 5) Use separate sheet if necessary.
- 4) Surface owner(s) of record to be served with Notice and Application. However, see also Code § 22-4-1b(b) if "more than three tenants in common or other co-owners of interest described in subsection (a) of this section hold interests in such lands".
- 5(i) "Coal Operator" means any person, firm, partnership, partnership association or corporation that proposes to or does operate a coal mine.
- 5(ii, iii) See Code § 22-4-20.
- 6) See Code § 22-4-11(c). However, in lieu of filing the lease(s) or other continuing contract(s), the Applicant may fill out the information in the space provided below.
- 7) See Code § § 22-4-11(d, e).

CONCERNING THE REQUIRED COPIES FOR FILING AND SERVICE:

Filing. Code § 22-4-1k and Regulation 7.02 provide that the original and required copies of the Notice and Application must be filed with the Administrator, accompanied by (i) a plat in the form prescribed by Regulation 11, (ii) a bond in one of the forms prescribed by Regulation 12, or in lieu thereof the other security allowed by Code § 22-4-1k(d) and the reclamation required by Code § 22-4-12b and Regulation 23, (iv) unless previously paid on the same well, the fees required by Code § 22-4-1a(c) and 22-3-12a, and (v) if applicable, the consent required by Code § 22-4-8a from the owner of any water well on dwelling within 200 feet of the proposed well.

Service. In addition, service must be made on the surface owner(s) and the person(s) with an interest in the coal. See Code § § 22-4-1m, 22-4-2, 22-4-2a, and 22-4-2b.

INFORMATION SUPPLIED UNDER CODE § 22-4-11(d)

IN LIEU OF FILING LEASE(S) AND OTHER CONTINUING CONTRACT(S)

Under the oath required to make the verification on the obverse side of this Notice, I depose and say that I am the person who signed the Notice for the Applicant, and that--

- (1) the tract of land is the same tract described in the Application to which this Notice applies, partly or wholly depicted in the accompanying plat, and described in the Construction and Reclamation Plan;
- (2) the parties and recordation data (if recorded) for lease(s) or other continuing contract(s) by which the Applicant claims the right to extract, produce or market the oil or gas are as follows:

Grantor, lessor, etc.	Grantee, lessee, etc.	Royalty	Book Page
-----------------------	-----------------------	---------	-----------

Rolla Skidmore

Kaiser Expl. & Mining Co. 1/8 of 159/249

prevailing field price. 159/249

Rolla Skidmore

Kaiser Exp + Min Co

prevailing field price

DETAILS OF PERFORATED INTERVALS, FRACTURING OR STIMULATING, PHYSICAL CHANGE, ETC.

- 10/15/84 Youngs Perk Lower Brown Shale 20 holes (0.39" DIA) from 4064-4296
- 10/15/84 Youngs Perk Berea 20 holes (0.39" DIA) from 2456-2461
- 10/17/84 Halliburton (fluid) and Nowsco (N₂) Foam Proc. Lower Brown Shale :
Used: 60,000 Bs 20/40 sand; 66D mscie total N₂; and 200 BBl total fluid
- 10/17/84 Halliburton (fluid) and Nowsco (N₂) Foam Prac Berea used: 60,000 lbs
20/40 sand; 682 mscie total N₂ ; 289 BBl's total fluid; 500 gal. 15%
HCl.

WELL LOG

FORMATION	COLOR	HARD OR SOFT	TOP FEET	BOTTOM FEET	REMARKS Including indication of all fresh and salt water, coal, oil and gas
DRILLERS DEPTHS: (top hole not logget)					
Sand and Shale			0	1890	
Big Lime			1890	1956	
Big Injun			1956	2065	
Shale			2065	2200	
<u>LOGGERS DEPTH:</u>					
Shale			2200	2436	
Coffee Shale			2436	2459	
Berea Sandstone			2459	2465	5/G
Shale			2465	3710	
Brown Shale			3710	4300	
Shale			4300	4366	5/G @ 4300
Total Depth			4366		

(Attach separate sheets as necessary)

RA R
Well Operator

By: KAISER EXPLORATION AND MINING COMPANY

09/08/2023

Date: November 12, 1984

Note: Regulation 2.02(i) provides as follows:
"The term 'log' or 'well log' shall mean a systematic
detailed geological record of all formations, including
encountered in the drilling of a well."

STATE OF WEST VIRGINIA
DEPARTMENT OF MINES
OIL AND GAS WELLS DIVISION

RECEIVED
SEP 19 1984

OIL & GAS DIVISION

INSPECTOR'S WELL REPORT
DEPT. OF MINES

Permit No. 035 1976

Oil or Gas Well _____
(KIND)

Company <u>Kaiser Exploration</u>	CASING AND TUBING	USED IN DRILLING	LEFT IN WELL	PACKERS
Address _____	Size			Kind of Packer _____
Farm _____	16			
Well No. <u>Kem 577</u>	13			Size of _____
District _____ County <u>Jackson</u>	10			
Drilling commenced <u>9 13 84</u>	8 1/4			Depth set _____
Drilling completed _____ Total depth _____	6			
Date shot _____ Depth of shot _____	5 3/16			Perf. top _____
Initial open flow _____ /10ths Water in _____ Inch	3			
Open flow after tubing _____ /10ths Merc. in _____ Inch	2			Perf. bottom _____
Volume _____ Cu. Ft.	Liners Used			
Rock pressure _____ lbs. _____ hrs.				Perf. top _____
Oil _____ bbls., 1st 24 hrs.				
Fresh water _____ feet _____ feet				Perf. bottom _____
Salt water _____ feet _____ feet				

CASING CEMENTED _____ SIZE _____ No. FT. _____ Date _____

NAME OF SERVICE COMPANY _____

COAL WAS ENCOUNTERED AT _____ FEET _____ INCHES

_____ FEET _____ INCHES _____ FEET _____ INCHES

_____ FEET _____ INCHES _____ FEET _____ INCHES

Drillers' Names _____

Hurt Rig #4 Archer

Remarks: _____

Td 744' set 16 jts 103/4 csg 704' set 714' Kb cement Noscoe 3000 lbs neat 3%
cacl 1/4 lb per sk flocele plug down 12:30 pm 9 13 84,

9 13 84
DATE

[Signature] 09/08/2023

STATE OF WEST VIRGINIA
DEPARTMENT OF MINES
OIL AND GAS WELLS DIVISION

RECEIVED
SEP 25 1984

OIL & GAS DIVISION
DEPT. OF MINES

INSPECTOR'S WELL REPORT

Permit No. 035 1976

Oil or Gas Well _____
(KIND)

Company <u>Kaiser Exploration</u>	CASING AND TUBING	USED IN DRILLING	LEFT IN WELL	PACKERS
Address _____	Size			
Farm _____	16			Kind of Packer _____
Well No. <u>Kem 577</u>	13			Size of _____
District _____ County <u>Jackson</u>	10			Depth set _____
Drilling commenced _____	8 1/4			Perf. top _____
Drilling completed _____ Total depth _____	6 3/8			Perf. bottom _____
Date shot _____ Depth of shot _____	5 3/16			Perf. top _____
Initial open flow _____ /10ths Water in _____ Inch	3			Perf. bottom _____
Open flow after tubing _____ /10ths Merc. in _____ Inch	2			Perf. top _____
Volume _____ Cu. Ft.	Liners Used _____			Perf. bottom _____
Rock pressure _____ lbs _____ hrs.	CASING CEMENTED _____ SIZE _____ No. FT. _____ Date _____			
Oil _____ bbls., 1st 24 hrs.	NAME OF SERVICE COMPANY _____			
Fresh water _____ feet _____ feet	COAL WAS ENCOUNTERED AT _____ FEET _____ INCHES			
Salt water _____ feet _____ feet	_____ FEET _____ INCHES _____ FEET _____ INCHES			
	_____ FEET _____ INCHES _____ FEET _____ INCHES			

Drillers' Names HurtRig #4 Archer

Remarks:

rd 9 1/2 hole at 4:00am 9 16 84 2235 Ran 53 jts 7" csg set 2212 Noscoe cement 175 sks 50/50 poz 10 % salt 1/4 lb pe sk flocele and 100 sks neat 3% cacl 1/4 lb per flocele plug down 10:00 am 9 16 84.

9 17 84

DATE

Jerry Teplak
09/08/2023

STATE OF WEST VIRGINIA
DEPARTMENT OF MINES
OIL AND GAS WELLS DIVISION

RECEIVED
SEP 25 1984
OIL & GAS DIVISION
DEPT. OF MINES

INSPECTOR'S WELL REPORT

Permit No. 035 1976

Oil or Gas Well _____
(KIND)

Company <u>Kaiser Explorstion</u>	CASING AND TUBING	USED IN DRILLING	LEFT IN WELL	PACKERS
Address _____	Size			Kind of Packer _____
Farm <u>skidmore</u>	16			
Well No. <u>Kem 577</u>	13			Size of _____
District _____ County <u>Jackson</u>	10			
Drilling commenced _____	8 1/4			Depth set _____
Drilling completed <u>9 18 84</u> Total depth <u>4350</u>	6 5/8			
Date shot _____ Depth of shot _____	5 3/16			Perf. top _____
Initial open flow _____ /10ths Water in _____ Inch	3			Perf. bottom _____
Open flow after tubing _____ /10ths Merc. in _____ Inch	2			Perf. top _____
Volume _____ Cu. Ft.	Liners Used			Perf. bottom _____
Rock prescure _____ lbs. _____ hrs.	CASING CEMENTED _____ SIZE _____ No. FT. _____ Date _____			
Oil _____ bbls., 1st 24 hrs.	NAME OF SERVICE COMPANY _____			
Fresh water _____ feet _____ feet	COAL WAS ENCOUNTERED AT _____ FEET _____ INCHES			
Salt water _____ feet _____ feet	_____ FEET _____ INCHES _____ FEET _____ INCHES			
	_____ FEET _____ INCHES _____ FEET _____ INCHES			

Drillers' Names _____

Hurt Rig #4

Remarks: _____

Ran 108 Jts 4 1/2 csg set 4329 KB. Cement Noscoe 250 sks 50/50 poz
Plug K Down 9:30 pm 9 18 84

9 19 84 moved off to J Kem 309 1812.

9 19 84
DATE

Jerry M. Taylor
09/08/2023

STATE OF WEST VIRGINIA
DEPARTMENT OF MINES
OIL AND GAS WELLS DIVISION

RECEIVED
JAN 3 - 1985

OIL & GAS DIVISION
DEPT. OF MINES

INSPECTOR'S WELL REPORT

035 1976

Permit No. _____

Oil or Gas Well _____
(KIND)

Company	CASING AND TUBING	USED IN DRILLING	LEFT IN WELL	PACKERS
Kaiser Exploration	Size			
Address	16			Kind of Packer
Farm Thompson	13			
Well No. Kem 577	10			Size of
District _____ County Jackson	8 1/4			
Drilling commenced	6 5/8			Depth set
Drilling completed _____ Total depth _____	5 3/16			
Date shot _____ Depth of shot _____	3			Perf. top
Initial open flow _____ /10ths Water in _____ Inch	2			Perf. bottom
Open flow after tubing _____ /10ths Merc. in _____ Inch	Liners Used			Perf. top
Volume _____ Cu. Ft.				Perf. bottom
Rock pressure _____ lbs. _____ hrs.	CASING CEMENTED _____ SIZE _____ No. FT. _____ Date _____			
Oil _____ bbls., 1st 24 hrs.	NAME OF SERVICE COMPANY _____			
Fresh water _____ feet _____ feet	COAL WAS ENCOUNTERED AT _____ FEET _____ INCHES			
Salt water _____ feet _____ feet	_____ FEET _____ INCHES _____ FEET _____ INCHES			
	_____ FEET _____ INCHES _____ FEET _____ INCHES			

Drillers' Names _____

Remarks:

Needs reclaimed

12 26 84

DATE

Inspector Signature
09/08/2023
DISTRICT WELL INSPECTOR

RECEIVED

JUN 17 1985

OIL & GAS DIVISION
DEPT. OF MINES

STATE OF WEST VIRGINIA
DEPARTMENT OF MINES
OFFICE OF OIL AND GAS
CHARLESTON 25305
FINAL INSPECTION REPORT
INSPECTORS COMPLIANCE REPORT

Company: KAISER EXP & MIN. CO
Farm: THOMPSON, GLEN

Well: KEM 577

Permit No. 47- 35-1976
County: JACKSON

Rule	Description	In Compliance	
		Yes	No
23.06	Notification prior to starting work	X	
25.04	Prepared before drilling to prevent waste	X	
25.03	High pressure drilling		
16.01	Required permits at wellsite	X	
15.03	Adequate Fresh Water Casings	X	
15.02	Adequate Coal Casings		
15.01	Adequate Production Casings	X	
15.04	Adequate Cement Strength	X	
15.05	Cement Type	X	
23.02	Maintained Access Roads	X	
25.01	Necessary Equipment to Prevent Waste	X	
23.04	Reclaimed Drilling Pits	X	
23.05	No Surface or Underground Pollution	X	
23.07	Requirements for Production & Gathering Pipelines	X	
16.01	Well Records on Site		
16.02	Well Records Filed		
7.05	Identification Markings	X	

I HAVE INSPECTED THE ABOVE CAPTIONED WELL AND RECOMMEND THAT IT BE RELEASED:

SIGNED *James R. Tephelord*
DATE 6-12-85

Your well record was received and reclamation requirements approved. In accordance with Chapter 22, Article 4, Section 2, the above well will remain under bond coverage for the life of the well.

T. H. ...
Administrator
June 19, 1985
Date

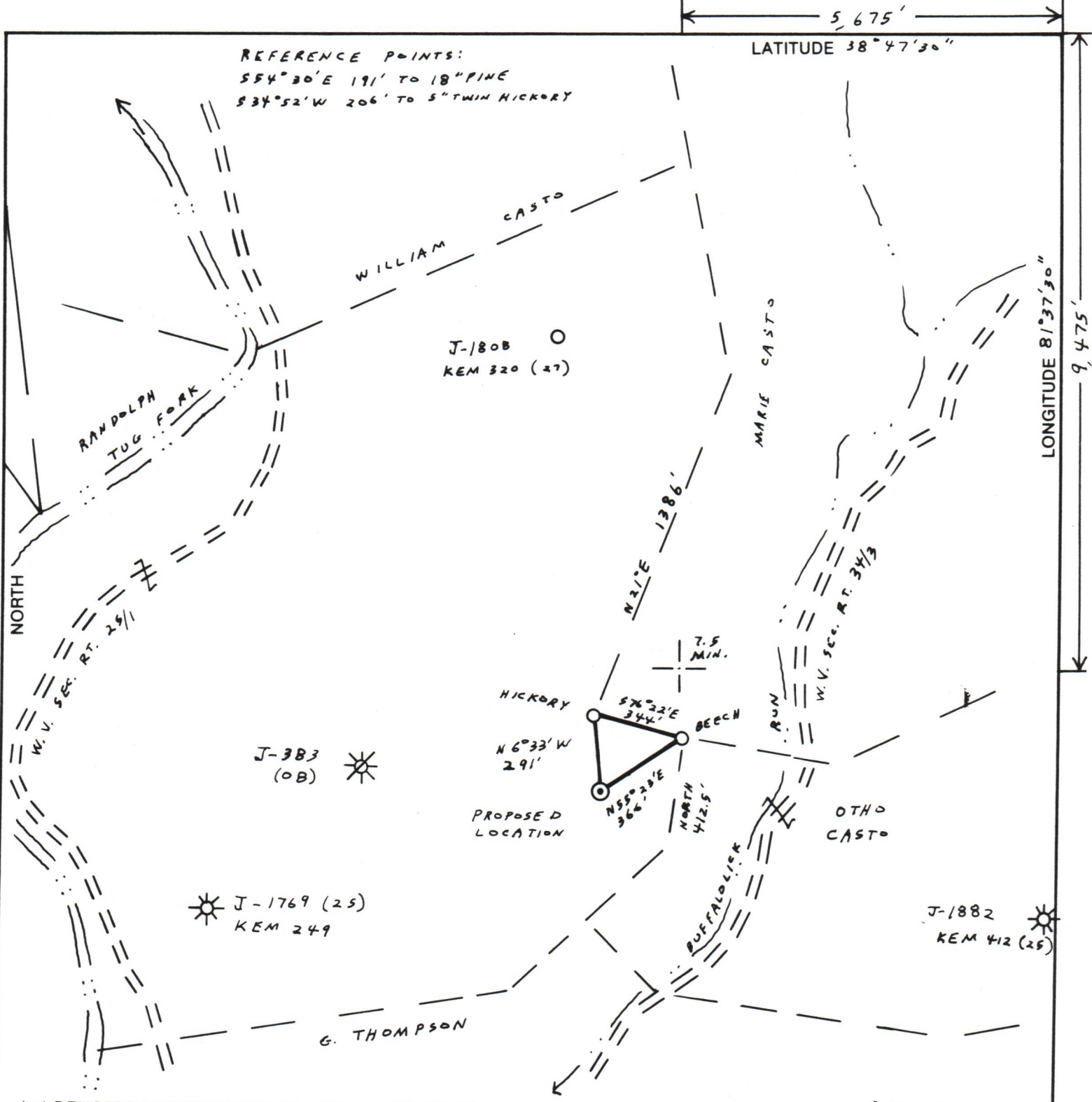

(+) DENOTES LOCATION OF WELL ON UNITED STATES TOPOGRAPHIC MAPS

S 12 E 10

FILE NO. 7-38
 DRAWING NO. _____
 SCALE 1" = 500
 MINIMUM DEGREE OF ACCURACY 1:200
 PROVEN SOURCE OF ELEVATION HIGH POINT ELEV. 825, 1250' N.W. OF LOCATION

I THE UNDERSIGNED, HEREBY CERTIFY THAT THIS PLAT IS CORRECT TO THE BEST OF MY KNOWLEDGE AND BELIEF AND SHOWS ALL THE INFORMATION REQUIRED BY LAW AND THE REGULATIONS ISSUED AND PRESCRIBED BY THE DEPARTMENT OF MINES.
 (SIGNED) Vincent W. Wood
 R.P.E. _____ L.L.S. 664

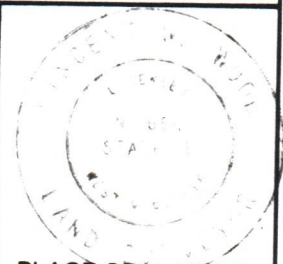

STATE OF WEST VIRGINIA
DEPARTMENT OF MINES
OIL AND GAS DIVISION



DATE MAY 7, 19 84
 OPERATOR'S WELL NO. KEM 577
 API WELL NO. _____

WELL TYPE: OIL ___ GAS X LIQUID INJECTION ___ WASTE DISPOSAL ___
 (IF "GAS,") PRODUCTION X STORAGE ___ DEEP ___ SHALLOW X
 LOCATION: ELEVATION 804 WATER SHED BUFFALO LICK RUN
 DISTRICT RIPLEY COUNTY JACKSON
 QUADRANGLE RIPLEY

SURFACE OWNER GLENN F. THOMPSON ACREAGE 153.75
 OIL & GAS ROYALTY OWNER ROLLA SKIDMORE ET AL. LEASE ACREAGE 152.75
 LEASE NO. 91-01-1049

PROPOSED WORK: DRILL X CONVERT ___ DRILL DEEPER ___ REDRILL ___ FRACTURE OR STIMULATE X PLUG OFF OLD FORMATION ___ PERFORATE NEW FORMATION ___ OTHER PHYSICAL CHANGE IN WELL (SPECIFY) _____

PLUG AND ABANDON ___ CLEAN OUT AND REPLUG ___
 TARGET FORMATION DEVONIAN BROWN SHALE ESTIMATED DEPTH 4370' R. A. PRYCE
 WELL OPERATOR KAISER EXPLOR. AND MINING CO. DESIGNATED AGENT KAISER EXPLORATION & MINING CO.
 ADDRESS P.O. BOX B, RAVENSWOOD, W.V. 26164 ADDRESS P.O. BOX B, RAVENSWOOD, W.V. 26164

COUNTY NAME
 PERMIT

09/08/2023