

LATITUDE 38°50'

81°30'

LONGITUDE

+ 7 1/2' LOC.

2.755
1.64W

*LOCATED FROM OLD FARM-LINE MAPS, CONFIRMED BY

Company Jeff Miller

PLAT 121-A (ATTACHED)

Farm A.V. PARSONS #1

APPROXIMATELY 910' TOPO. ELEV.

WELL LOCATION MAP

File No. JAC-20-A

Quad GAY 7 1/2; Ripley 15' SE

ABANDONED WELL FILE -
PRE-PERMIT

County JACKSON

District WASH.

Latitude 38° 50

Longitude 81° 30

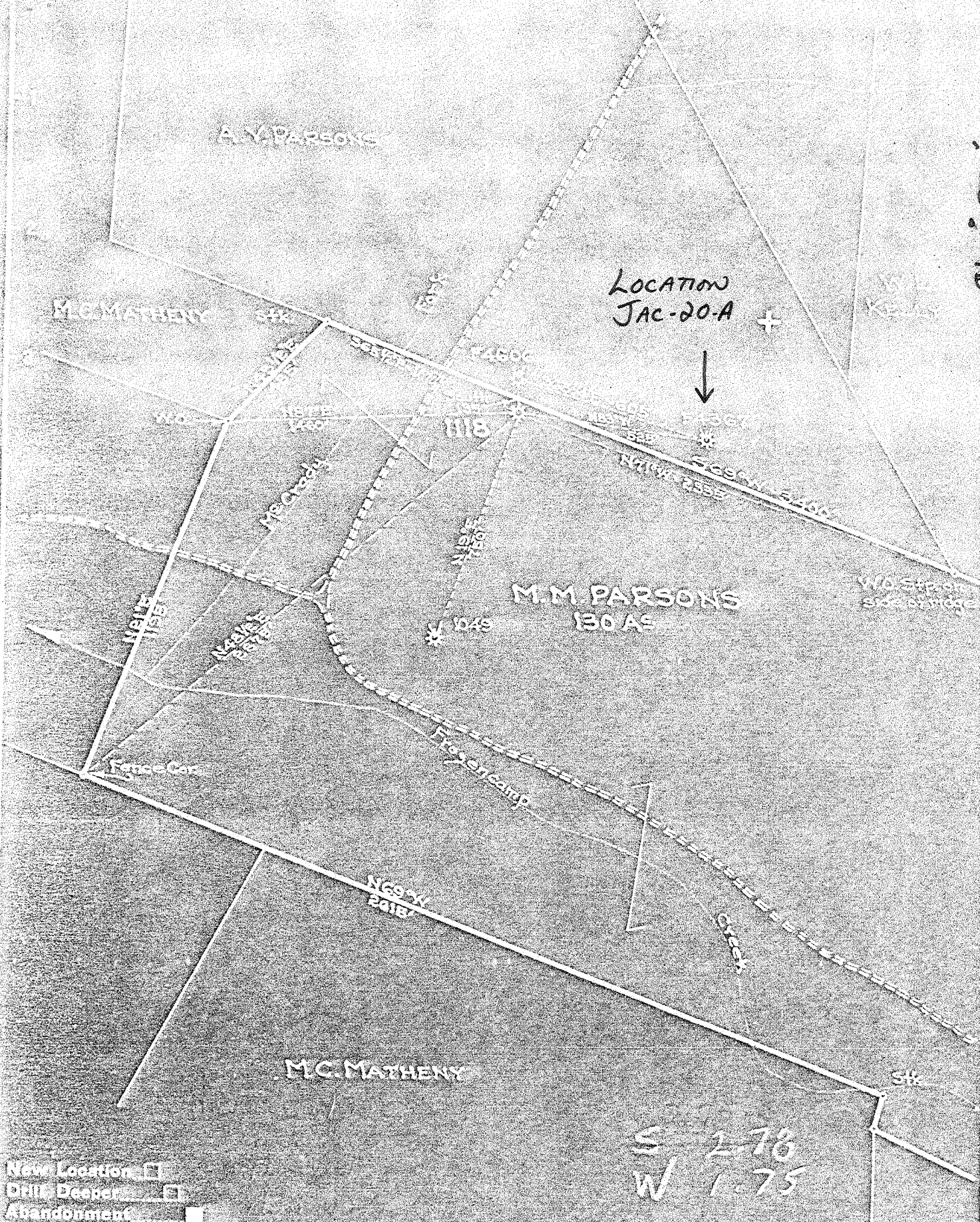

New Location
 DHM Deeper
 Abandonment

S 2.78
 W 1.75

JEFF MILLOR

Company UNITED FUEL GAS CO.
 Address CHARLESTON, W. VA.
 Farm A.V. PARSONS
 Tract Acres 6.5 Lease No. 51330
 Well (Farm) No. # 1 Serial No. 1110
 Elevation (Surface) 910 TOPO.
 Operator BIRLEY
 Owner JACKSON District WASHINGTON
 Engineer JEFF MILLOR
 Engineer's Registration No. 662 SE
 File No. 66-89 Drawing No. _____
 Date JULY 21 1950 Scale 1" = 400'

STATE OF WEST VIRGINIA
 DEPARTMENT OF MINES
 OIL AND GAS DIVISION
 CHARLESTON

WELL LOCATION MAP

FILE NO. 66-89-2

JAC-20-A

+ Denotes location of well on United States Topographic Maps, scale 1" to 62,500' (latitude and longitude lines being represented by border lines as shown)

- Denotes one inch spaces on border lines of original tracing.

Washington District, Jackson County, W. Va.

Jeff Miller et al., Spencer, W. Va.

On 25 acres, on McGrady's Fork; surface and mineral rights owned by
A. V. Parsons, Parkersburg, W. Va.

Well completed, August, 1919.

No elevation given.

1 3/4" conductor, 16'; 10" casing, 732'; 8 1/4", 1113'; 6-5/8", 2108'.

No coal encountered.

Abandonment reported to Dept. of Mines March 16, 1932.

Well was shot at 2480 to 2500'.

Salt water at 1685'.

	Top.	Bottom.
✓ Pittsburgh Sand	509	- 610
✓ Little Dunkard Sand	1000	- 1025
✓ Big Dunkard Sand	1060	- 1155
✓ Salt Sand (water)	1635	- 1950
✓ Big Lime	1955	- 2050
✓ Big Injun Sand (water)	2050	- 2095
✓ Berea Sand (gas)	2475	- 2495
Total depth		2512

410