

Latitude 38° + 45'

Longitude 81° 35'

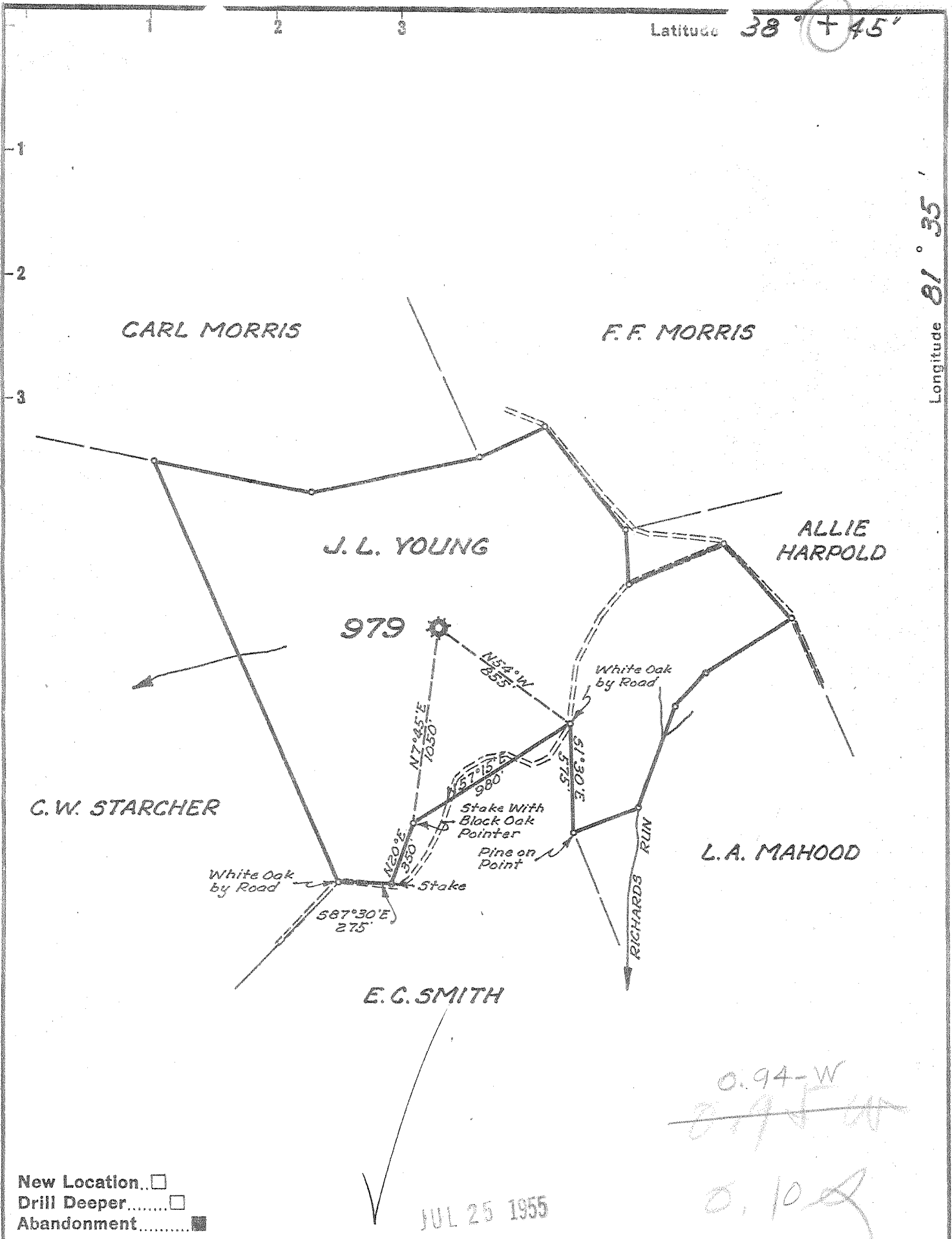

- New Location...
- Drill Deeper.....
- Abandonment.....

JUL 25 1955

0.94-W
~~0.775 W~~
 0.10

Company UNITED FUEL GAS CO.
 Address CHARLESTON, W. VA.
 Farm J. L. YOUNG
 Tract _____ Acres 97 Lease No. 7466
 Well (Farm) No. _____ Serial No. 979
 Elevation (Spirit Level) 843.5'
 Quadrangle KENNA
 County JACKSON District WASHINGTON
 Engineer Seibert R. Howell
 Engineer's Registration No. 2529
 File No. 62-85-87 Drawing No. _____
 Date 6-23-55 Scale 1" = 660'

STATE OF WEST VIRGINIA
 DEPARTMENT OF MINES
 OIL AND GAS DIVISION
 CHARLESTON

WELL LOCATION MAP
 FILE NO. JAC-141-A

+ Denotes location of well on United States Topographic Maps, scale 1 to 62,500, latitude and longitude lines being represented by border lines as shown.
 - Denotes one inch spaces on border line of original tracing.

6-6-(163)Gay

J.L. YOUNG No. 979 -

U. F. G. Co. -

JAC-141-A

J. L. YOUNG NO. 1 (979) WELL.

Washington District, Jackson County, W. Va.

By United Fuel Gas Co.

On 97 acres.

Keller Map G-24.

Elevation.....

Completed Oct. 11, 1917.

Gas well. 12/10 W. in 6 $\frac{5}{8}$ ".

S. P. - S-47 - W-55; on Tug Fork of Mill Creek.

From Heck's notes.

	Top.	Bottom.
Big Lime	1851 -
Berea Sand (gas, 2469-2473')	2467 -	2473
Total depth		2473



STATE OF WEST VIRGINIA
DEPARTMENT OF MINES
OIL AND GAS DIVISION

309

Quadrangle Kenna

WELL RECORD

Permit No. 111-A

Oil or Gas Well Gas
(KIND)

Company UNITED FUEL GAS COMPANY
Address P.O. Box 1273, Charleston 25, W. Va.
Farm J. L. Young Acres 97
Location (waters) Richards Run
Well No. 979 Elev. 843.5'
District Washington County Jackson
The surface of tract is owned in fee by _____
Address _____
Mineral rights are owned by Susan Payne
Address Gay, W. Va.
Drilling commenced 8-10-17
Drilling completed 10-15-17 *RECORDED 7/22/55*
Date Shot 10-14-17 From _____ To _____
With 30 cts.
Open Flow 64 /10ths Water in 6-5/8 Inch
_____ /10ths Merc. in _____ Inch
Volume 4,000,000 Cu. Ft.
Rock Pressure 720 lbs. 60 min. hrs.
Oil _____ bbls., 1st 24 hrs.
Fresh water _____ feet _____ feet
Salt water _____ feet _____ feet

Casing and Tubing	Used in Drilling	Left in Well	Packers
Size		16	
16			Kind of Packer <u>Callanan</u>
13			
10	790		Size of <u>5-3/16x3</u>
8 1/4	1080		
6 5/8		2070	Depth set <u>2137</u>
5 3/16		2116	
3		2543	Perf. top
2			Perf. bottom
Liners Used			Perf. top
			Perf. bottom

CASING CEMENTED _____ SIZE _____ No. Ft. _____ Date _____

COAL WAS ENCOUNTERED AT _____ FEET _____ INCHES
_____ FEET _____ INCHES _____ FEET _____ INCHES
_____ FEET _____ INCHES _____ FEET _____ INCHES

Formation	Color	Hard or Soft	Top	Bottom	Oil, Gas or Water	Depth Found	Remarks
✓Pittsburg Sand	-18		493	548	(Circled checkmark)		
✓2nd Pittsburg Sand			625	670			
✓Dunkard Sand	-18		1075	1135			
✓Salt Sand			1700	1851			
✓Big Lime			1851	1996			
✓Big Injun			1996	2076			
Berea			2467	2478			
Gas			2471	2478			
Total depth			2527'				
			(Circled 410)				

RECEIVED
 WEST VIRGINIA
 DEPT. OF MINES
 JUL 1955

JAN. 23 1956

