



1) Date: November 8, 19 84
 2) Operator's Well No. A. Huntington #43
 3) API Well No. 47 - 089 039 - 0132-DD
 State County Permit

RECEIVED
 NOV 13 1984

STATE OF WEST VIRGINIA
 DEPARTMENT OF MINES, OIL AND GAS DIVISION
 APPLICATION FOR A WELL WORK PERMIT

- 4) WELL TYPE: A Oil / B Gas X / C Production / D Underground storage / E Deep / F Shallow X / G Other
- 5) LOCATION: Elevation: 1018' / Watershed: Hughes Creek / District: Cabin Creek / County: Kanawha / Quadrangle: Montgomery
- 6) WELL OPERATOR Cabot Oil & Gas Corp. of WV / 7) DESIGNATED AGENT Robert E. Horrell
 Address P.O. Box 628 / Address P.O. Box 628
Charleston, West Virginia 25322 / Charleston, West Virginia 25322
- 8) OIL & GAS INSPECTOR TO BE NOTIFIED 8150 / 9) DRILLING CONTRACTOR:
 Name Russell Boall / Name UNKNOWN
 Address P.O. Box 160 / Address _____
Phillippi, West Virginia 26416 / 866-4608 / 469-2015
- 10) PROPOSED WELL WORK: Drill _____ / Drill deeper X / Redrill _____ / Stimulate X / Plug off old formation _____ / Perforate new formation X / Other physical change in well (specify) Drill deeper from Big Lime to Weir
- 11) GEOLOGICAL TARGET FORMATION, Weir & Big Lime
- 12) Estimated depth of completed well, 2400 feet
- 13) Approximate trata depths: Fresh, 40 feet; salt, 1185 feet.
- 14) Approximate coal seam depths: 167, 508 Is coal being mined in the area? Yes _____ / No _____
- 15) CASING AND TUBING PROGRAM WORKOVER

CASING OR TUBING TYPE	SPECIFICATIONS				FOOTAGE INTERVALS		CEMENT FILL-UP OR SACKS (Cubic feet)	PACKERS
	Size	Grade	Weight per ft.	New	Used	For drilling		
Conductor	13					EXISTING	33	ON SHOE Kinds Spang Anchor
Fresh water								
Coal	10					EXISTING	512	ON SHOE Sizes 2" x 6-5/8"
Intermediate	8					EXISTING	1391	ON SHOE
Production	6					EXISTING	1922	ON SHOE Depths set 1961
Tubing	2				TO BE PULLED	EXISTING	2094	ON PACKER
Liners								Perforations: Top Bottom
	4-1/2		10.5	X		PROPOSED	2400	100 sks.
	1-1/2		2.75	X		PROPOSED	2350	

OFFICE USE ONLY
 DRILLING PERMIT

Permit number 47-039-0132-DD Date November 29, 19 84

This permit covering the well operator and well location shown below is evidence of permission granted to drill in accordance with the pertinent legal requirements subject to the conditions contained herein and on the reverse hereof. **Notification must be given to the District Oil and Gas Inspector, (Refer to No. 8) Prior to the construction of roads, locations and pits for any permitted work.** In addition, the well operator or his contractor shall notify the proper district oil and gas inspector 24 hours before actual permitted work has commenced.)

The permitted work is as described in the Notice and Application, plat, and reclamation plan, subject to any modifications and conditions specified on the reverse hereof.

Permit expires November 29, 1986 unless well work is commenced prior to that date and prosecuted with due diligence.

Bond:	Agent:	Plat:	Casing	Fee
<u>30</u>	<u>MH</u>	<u>MH</u>	<u>MH</u>	<u>14071</u>

Margaret J. Nass
 Administrator, Office of Oil and Gas

NOTE: Keep one copy of this permit posted at the drilling location.



RECEIVED
1984

DEPARTMENT OF MINES, OIL AND GAS DIVISION
STATE OF WEST VIRGINIA

OFFICE USE ONLY

PERMIT MODIFICATIONS AND CONDITIONS (IF ANY) TO THE PROPOSED WELL WORK

1) LOCATION: Cabin Creek, Kanawha County, West Virginia, Hughes Creek
 2) WELL OPERATOR: Cabot Oil & Gas Corp. of WV, P.O. Box 628, Charleston, West Virginia 25322
 3) DESIGNATED AGENT: Robert E. Horrel, P.O. Box 628, Charleston, West Virginia 25322
 4) DRILLING CONTRACTOR: UNKNOWN
 5) ON A GAS INSPECTION TO BE NOTIFIED: YES
 6) PROPOSED WELL WORK: Drilling new formation, Drift deeper from Big Lime to Weir & Big Lime
 7) APPROXIMATE COST: \$185,000
 8) APPROXIMATE COST PER FOOT: \$40
 9) COAL BEING MINED IN THE AREA: YES

~~449-2012~~
~~RODNEY DILON~~

DEPTH (FEET)	FORMATION	INTERVALS	TESTS	REMARKS
0-33	ON SHOE	EXISTING	33	To be pulled to be pulled Sparg Anchor
33-51.5	ON SHOE	EXISTING	51.5	2" x 6-5/8"
51.5-139.1	ON SHOE	EXISTING	139.1	
139.1-192.2	ON SHOE	EXISTING	192.2	1991
192.2-203.4	ON RACKER		203.4	

OFFICE USE ONLY

This part of Form IV-2(b) is to record the dates of certain occurrences and any follow-up inspections.

Date	Date(s)
Application received	Follow-up inspection(s)
Well work started	"
Completion of the drilling process	"
Well Record received	"
Reclamation completed	"

OTHER INSPECTIONS

Reason: _____
 Reason: _____

Board	30
Pin	4/11/84
Casing	4/11/84
Pin	4/11/84
Board	4/11/84

09/08/2023



1) Date: November 8, 19 84
 2) Operator's Well No. A. Huntington #43
 3) API Well No. 47 089 0132
 State County Permit

STATE OF WEST VIRGINIA
 DEPARTMENT OF MINES, OIL AND GAS DIVISION
 APPLICATION FOR A WELL WORK PERMIT

- 4) WELL TYPE: A Oil _____ / Gas X /
 B (If "Gas", Production _____ / Underground storage _____ / Deep _____ / Shallow X /)
- 5) LOCATION: Elevation: 1018' Watershed: Hughes Creek
 District: Cabin Creek County: Kanawha Quadrangle: Montgomery
- 6) WELL OPERATOR Cabot Oil & Gas Corp. of WV 7) DESIGNATED AGENT Robert E. Horrell
 Address P.O. Box 628 Address P.O. Box 628
Charleston, West Virginia 25322 Charleston, West Virginia 25322
- 8) OIL & GAS INSPECTOR TO BE NOTIFIED 8150 9) DRILLING CONTRACTOR:
 Name Russell Beall Name UNKNOWN
 Address P.O. Box 160 Address _____
Philippi, West Virginia 26416 866-4608 404-2015
- 10) PROPOSED WELL WORK: Drill _____ / Drill deeper X / Redrill _____ / Stimulate X /
 Plug off old formation _____ / Perforate new formation X /
 Other physical change in well (specify) Drill deeper from Big Lime to Weir
- 11) GEOLOGICAL TARGET FORMATION, Weir & Big Lime
- 12) Estimated depth of completed well, 2400 feet
 13) Approximate trata depths: Fresh, 40 feet; salt, 1185 feet.
 14) Approximate coal seam depths: 167, 508 Is coal being mined in the area? Yes _____ / No _____
- 15) CASING AND TUBING PROGRAM WORKOVER

CASING OR TUBING TYPE	SPECIFICATIONS					FOOTAGE INTERVALS		CEMENT FILL-UP OR SACKS (Cubic feet)	PACKERS To be pulled
	Size	Grade	Weight per ft.	New	Used	For drilling	Left in well		
Conductor	<u>13</u>					EXISTING	<u>33</u>	ON SHOE	Kinds <u>Spang Anchor</u>
Fresh water									
Coal	<u>10</u>					EXISTING	<u>512</u>	ON SHOE	Sizes <u>2" x 6-5/8"</u>
Intermediate	<u>8</u>					EXISTING	<u>1391</u>	ON SHOE	
Production	<u>6</u>					EXISTING	<u>1922</u>	ON SHOE	Depths set <u>1961</u>
Tubing	<u>2</u>					EXISTING	<u>2094</u>	ON PACKER	
Liners									Perforations:
	<u>4-1/2</u>		<u>10.5</u>	<u>X</u>		PROPOSED	<u>2400</u>	<u>100 sks.</u>	Top Bottom
	<u>1-1/2</u>		<u>2.75</u>	<u>X</u>		PROPOSED	<u>2350</u>		

INSTRUCTIONS TO COAL OPERATOR, OWNER, OR LESSEE

The named coal operator, coal owner(s), and coal lessee are hereby notified that any objection they wish to make or are required to make by Code §22-4-3 must be filed with the Department of Mines within fifteen (15) days after the receipt of this Application by the Department.

The following waiver must be completed by the coal operator and by any coal owner or coal lessee who has recorded a declaration under Code §22-4-20, if the permit is to be issued within fifteen (15) days of the filing of the Application.

WAIVER

The undersigned coal operator _____ / owner _____ / lessee _____ / of the coal under this well location has examined this proposed well location. If a mine map exists which covers the area of the well location, the well location has been added to the mine map. The undersigned has no objection to the work proposed to be done at this location, provided, the well operator has complied with all applicable requirements of the West Virginia Code and the governing regulations.

Date: 30 Nov 84, 19 84 By Margaret J. Hesse

09/08/2023
Coal Owner



1) Date: November 8, 19 84
 2) Operator's Well No. A. Huntington #43
 3) API Well No. 47 State 089 County 0132 Permit

**STATE OF WEST VIRGINIA
 DEPARTMENT OF MINES, OIL AND GAS DIVISION
 APPLICATION FOR A WELL WORK PERMIT**

- 4) WELL TYPE: A Oil _____ / Gas X /
 B (If "Gas", Production _____ / Underground storage _____ / Deep _____ / Shallow X /)
- 5) LOCATION: Elevation: 1018' Watershed: Hughes Creek
 District: Cabin Creek County: Kanawha Quadrangle: Montgomery
- 6) WELL OPERATOR Cabot Oil & Gas Corp. of WV 7) DESIGNATED AGENT Robert E. Horrell
 Address P.O. Box 628 Address P.O. Box 628
Charleston, West Virginia 25322 Charleston, West Virginia 25322
- 8) OIL & GAS INSPECTOR TO BE NOTIFIED 8150 9) DRILLING CONTRACTOR:
 Name Russell Beall Name UNKNOWN
 Address P.O. Box 160 Address _____
Philippi, West Virginia 26416 866-4608
- 10) PROPOSED WELL WORK: Drill _____ / Drill deeper X / Redrill _____ / Stimulate X /
 Plug off old formation _____ / Perforate new formation X /
 Other physical change in well (specify) Drill deeper from Big Lime to Weir
- 11) GEOLOGICAL TARGET FORMATION, Weir & Big Lime
- 12) Estimated depth of completed well, 2400 feet
- 13) Approximate strata depths: Fresh, 40 feet; salt, 1185 feet.
- 14) Approximate coal seam depths: 167, 508 Is coal being mined in the area? Yes _____ / No _____
- 15) CASING AND TUBING PROGRAM WORKOVER

CASING OR TUBING TYPE	SPECIFICATIONS				FOOTAGE INTERVALS		CEMENT FILL-UP OR SACKS (Cubic feet)	PACKERS		
	Size	Grade	Weight per ft.	New	Used	For drilling		Left in well	To be pulled	
Conductor	<u>13</u>					<u>EXISTING</u>	<u>33</u>	<u>ON SHOE</u>	Kinds	<u>Spang Anchor</u>
Fresh water										
Coal	<u>10</u>					<u>EXISTING</u>	<u>512</u>	<u>ON SHOE</u>	Sizes	<u>2" x 6-5/8"</u>
Intermediate	<u>8</u>					<u>EXISTING</u>	<u>1391</u>	<u>ON SHOE</u>		
Production	<u>6</u>					<u>EXISTING</u>	<u>1922</u>	<u>ON SHOE</u>	Depths set	<u>1961</u>
Tubing	<u>2</u>					<u>EXISTING</u>	<u>2094</u>	<u>ON PACKER</u>		
Liners									Perforations:	
	<u>4-1/2</u>		<u>10.5</u>	<u>X</u>		<u>PROPOSED</u>	<u>2400</u>	<u>100 sks.</u>	Top	<u>Bottom</u>
	<u>1-1/2</u>		<u>2.75</u>	<u>X</u>		<u>PROPOSED</u>	<u>2350</u>			

The law requires a comment period for surface owners. However, the permit can be issued in less than 15 days from the filing of the Application if the surface owner(s) of record sign(s) the following "Voluntary Statement of No Objection" on a facsimile of this surface owner's copy of the Application.

VOLUNTARY STATEMENT OF NO OBJECTION

I hereby state that I have read the instructions to surface owners on the reverse side of this Application for a Well Work Permit, and that I have received copies of (1) a Notice of Application for a Well Work Permit on Form IV-2(A), (2) an Application for a Well Work Permit on Form IV-2(B), (3) a survey plat on Form IV-6, and (4) a Construction and Reclamation Plan on Form IV-9, all for proposed well work on my surface land as described therein.

I further state that I have no objection to the planned work described in these materials, and I have no objection to a permit being issued based on those materials.

(For execution by corporation, partnership, etc.)

(For execution by natural persons)

NAME: _____
 By [Signature] _____
 Its _____ Date _____

 (Signature)

 (Signature)

09/08/2023
 Surface Owner

**INSTRUCTIONS TO SURFACE OWNERS
AND
EXPLANATION OF METHODS AND TIME LIMITS TO COMMENT
ON OIL AND GAS WELL WORK PERMIT**

The well operator named in the Notice and this Application and the attached materials is applying for a permit from the State to do oil or gas well drilling or other well work. You are being served with these materials because surface owners have the right to file comments before the permit is issued. (NOTE: If the surface tract is owned by more than three persons, in multiple heirship for example, then these materials were served on you because your name appeared on the Sheriff's tax ticket on the land or because you actually occupy the surface tract. In either case, you may be the only owner who will actually receive these materials.) See Chapter 22, Article 4 of the W. Va. Code. Permits are valid for 24 months.

If you do not own any interest in the surface tract, please forward these materials to the true owner immediately if you know who it is. Also, please notify the well operator named in the materials and the Administrator of the Office of Oil and Gas in the West Virginia Department of Mines immediately.

NOTE: You are not required to file any comment at all.

Where to file comments and obtain additional information:

Administrator of the Office of Oil and Gas
West Virginia Department of Mines
1615 Washington Street East
Charleston, West Virginia 25311
(304) 348-2057

Who may file comments? If you wish to file comments, you must be an owner of record of (1) an interest in the surface tract on which the well already is or is about to be located, or (2) an interest in any other surface tract under the same oil or gas lease which will be utilized for roads or other land disturbances.

Time limits for comments. The law requires these materials to be delivered on or before the date the operator files his Application. You have **FIFTEEN (15) DAYS** after the filing date to file your comments as provided in **Methods for Filing Comments** below. You may call the Administrator's office at the above telephone number to be sure of the date. However, if you have been contacted by the well operator, and if you have signed a "voluntary statement of no objection" to any of the planned work described in these materials, then the permit may be issued at any time.

Comments must be in writing. Your comments must include your name, address and telephone number, the well operator's name and well number, and the approximate location of the proposed well site including district and county from the application. You may add other documents, such as sketches, maps or photographs to support your comments.

Methods for filing comments. Comments must be filed in person or received in the mail at the Administrator's office by the time stated above. Check with your postmaster to ensure adequate delivery time or to arrange special expedited handling.

The Administrator for Oil and Gas has the power to deny or condition a well work permit based on your comments on the following grounds:

- “(1) The proposed well work will constitute a hazard to the safety of persons; or
- “(2) The plan for soil erosion and sediment control is not adequate or effective; or
- “(3) Damage would occur to publicly owned lands or resources; or
- “(4) The proposed well work fails to protect fresh water sources or supplies.”

If you want a copy of the permit as it is finally issued, or a copy of the order denying the permit, you should request a copy from the Administrator.

List of Water Testing Laboratories. The Administrator maintains a list of water testing laboratories which you can hire to test your water to establish water quality prior to and after drilling. Contact the Administrator's office or an Oil and Gas Inspector to obtain a copy of the list.

1) Date: November 8, 1984
2) Operator's Well No. A. Huntington #43
3) API Well No. 47 - 089 - 0132 - 02
State County Permit

STATE OF WEST VIRGINIA
DEPARTMENT OF MINES, OFFICE OF OIL & GAS

NOTICE OF APPLICATION FOR A WELL WORK PERMIT

Cannelton Industries, Inc.

- 4) SURFACE OWNER(S) OF RECORD TO BE SERVED
- (i) Name First & Merchants National Bank Trust Account of Mariners Museum
Address 2600 Washington Avenue Newport News, Virginia 23607
- (ii) Name _____
Address _____
- (iii) Name _____
Address _____

- 5(i) COAL OPERATOR Attn: Mr. Jim Staub
Address 1205 One Kanawha Valley Square Charleston, West Virginia 25301
- 5(ii) COAL OWNER(S) WITH DECLARATION ON RECORD:
Name First & Merchants National Bank Trust Account of Mariners Museum
Address 2600 Washington Avenue Newport News, Virginia 23607
Name _____
Address _____
- 5(iii) COAL LESSEE WITH DECLARATION ON RECORD:
Name _____
Address _____

TO THE PERSON(S) NAMED ABOVE: You should have received this Form and the following documents:

- (1) The Application for a Well Work Permit on Form IV-2(B) (or Form IV-4 if the well is to be plugged, which sets out the parties involved in the drilling or other work, and describes the well and its location and, if applicable, the proposed casing and cementing program;
- (2) The plat (surveyor's map) showing the well location on Form IV-6; and
- (3) The Construction and Reclamation Plan on Form IV-9 (unless the well work is only to plug a well), which sets out the plan for erosion and sediment control and for reclamation for the site and access road.

THE REASON YOU RECEIVED THESE DOCUMENTS IS THAT YOU HAVE RIGHTS REGARDING THE APPLICATION WHICH ARE SUMMARIZED IN THE "INSTRUCTIONS" ON THE REVERSE SIDE OF THE COPY OF THE APPLICATION (FORM IV-2(B) OR FORM 4, DESIGNATED FOR YOU. HOWEVER, YOU ARE NOT REQUIRED TO TAKE ANY ACTION AT ALL.

Take notice that under Chapter 22 of the West Virginia Code, the undersigned well operator proposes to file or has filed this Notice and Application and accompanying documents for a Well Work Permit with the Administrator of the Office of Oil and Gas, West Virginia Department of Mines, with respect to a well at the location described on attached Application and depicted on attached Form IV-6. Copies of this Notice, the Application, the plat, and the Construction and Reclamation Plan have been mailed by registered or certified mail or delivered by hand to the person(s) named above (or by publication in certain circumstances) on or before the day of mailing or delivery to the Administrator.

6) EXTRACTION RIGHTS

Check and provide one of the following:

- Included is the lease or leases or other continuing contract or contracts by which I hold the right to extract oil or gas.
- The requirement of Code 22-4-1-(c) (1) through (4). (See reverse side for specifics.

ROYALTY PROVISIONS

Is the right to extract, produce or market the oil or gas based upon a lease or leases or other contract or contracts providing for flat well royalty or any similar provision for compensation to the owner of the oil or gas in place which is not inherently related to the volume of oil or gas so extracted, produced or marketed? Yes No X

If the answer above is No, nothing additional is needed. If the answer is Yes, you may use Affidavit Form IV-60.

See the reverse side for line item instructions, and for instructions concerning the required copies of the Notice and Application, plat, and Construction and Reclamation Plan.

The truth of the information on the Notice and Application is verified and sworn to and the Notice is signed on behalf of the Well Operator in my County and State by

Robert F. Horrell
this 8 day of November, 1984.
My commission expires March 5, 1989.

WELL OPERATOR CABOT OIL & GAS CORPORATION OF WV

By Robert E. Hanell
Its District Production Superintendent
Address P.O. Box 628 Charleston, WV 25322
Telephone (304) 347-1600

Jorene Miller
Notary Public, Kanawha County,
State of West Virginia

RECEIVED
NOV 13 1984
OIL & GAS DIVISION
DEPT. OF MINES

09/08/2023

P 753 224 461

RECEIPT FOR CERTIFIED MAIL

NO INSURANCE COVERAGE PROVIDED
NOT FOR INTERNATIONAL MAIL

(See Reverse)

Bank

Sent to First & Merchants Nat'l Trust Account of Mariners Mus.	
Street and No. 2600 Washington Avenue	
P.O., State and ZIP Code Newport News, VA. 23607	
Postage	\$
Certified Fee	75
Special Delivery Fee	
Restricted Delivery Fee	
Return Receipt Showing to whom and Date Delivered	60
Return receipt showing to whom, Date, and Address of Delivery	
TOTAL Postage and Fees	\$
Postmark or Date	CHARLESTON, WV NOV 8 1984 25301

43 & 45
 Huntingtown
 PS Form 3800, Feb. 1982
 * U.S.G.P.O. 1983-403-517

P 753 224 464

RECEIPT FOR CERTIFIED MAIL

NO INSURANCE COVERAGE PROVIDED
NOT FOR INTERNATIONAL MAIL

(See Reverse)

Sent to Canneton Industries, Inc. Attn: Mr. Jim Staub	
Street and No. 1205 Kanawha Valley Square	
P.O., State and ZIP Code Charleston, WV 25301	
Postage	\$
Certified Fee	75
Special Delivery Fee	
Restricted Delivery Fee	
Return Receipt Showing to whom and Date Delivered	60
Return receipt showing to whom, Date, and Address of Delivery	
TOTAL Postage and Fees	\$
Postmark or Date	CHARLESTON, WV NOV 8 1984 25301

43 & 45
 Huntingtown
 PS Form 3800, Feb. 1982
 * U.S.G.P.O. 1983-403-517

owner of any water well on dwelling within 200 feet of the proposed well.

Service. In addition, service must be made on the surface owner(s) and the person(s) with an interest in the coal. See Code § § 22-4-lm, 22-4-2, 22-4-2a, and 22-4-2b.

INFORMATION SUPPLIED UNDER CODE § 22-4-11(d)

IN LIEU OF FILING LEASE(S) AND OTHER CONTINUING CONTRACT(S)

Under the oath required to make the verification on the obverse side of this Notice, I depose and say that I am the person who signed the Notice for the Applicant, and that--

- (1) the tract of land is the same tract described in the Application to which this Notice applies, partly or wholly depicted in the accompanying plat, and described in the Construction and Reclamation Plan;
- (2) the parties and recordation data (if recorded) for lease(s) or other continuing contract(s) by which the Applicant claims the right to extract, produce or market the oil or gas are as follows:

Grantor, lessor, etc.	Grantee, lessee, etc.	Royalty	Book	Page
First National Bank of Newport News	Godfrey L. Cabot, Inc. (COGC of WV)	12.5%	60	450



OCT. 29 1984

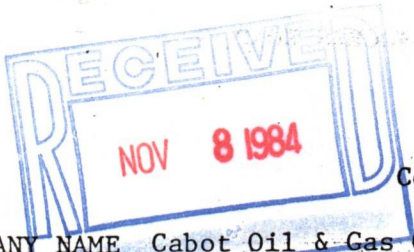

State of West Virginia
Department of Mines
Oil and Gas Division

Construction and Reclamation Plan

COMPANY NAME Cabot Oil & Gas Corporation of WV DESIGNATED AGENT Robert Horrell
ADDRESS P.O. Box 628, Chas. WV 25322 ADDRESS P.O. Box 628 Chas. WV 25322
TELEPHONE 304-347-1600 TELEPHONE 304-347-1600
LANDOWNER First & Merchants National Bank SOIL CONS. DISTRICT Capitol
Trust Account of Mariners Museum
Revegetation to be carried out by _____ Company Contractor _____ (Agent)

This plan has been reviewed by Capitol SCD. All corrections and additions have become a part of this plan.

NOV. 06 1984
(Date)

R. C. [Signature]
(SCD Agent)

"SEE ATTACHED COMMENTS"

ACCESS ROAD	LOCATION
STRUCTURE <u>Ditch Relief Cross Drain</u> (A)	STRUCTURE <u>Drainage Ditch</u> (1)
SPACING <u>Per Plan</u>	MATERIAL <u>Soil</u>
PAGE REF. MANUAL <u>2-1, 2-2, 2-3, 2-4</u>	PAGE REF. MANUAL <u>2:12, 2:15</u>
STRUCTURE _____ (B)	STRUCTURE <u>Diversion</u> (2)
SPACING _____	MATERIAL <u>Soil</u>
PAGE REF. MANUAL _____	PAGE REF. MANUAL <u>2:12, 2:13</u>
STRUCTURE _____ (C)	STRUCTURE <u>Sediment Barrier</u> (3)
SPACING _____	MATERIAL <u>Straw Bales or Filter Fence</u>
PAGE REF. MANUAL _____	PAGE REF. MANUAL <u>2:16, 2:18, 2:19</u>

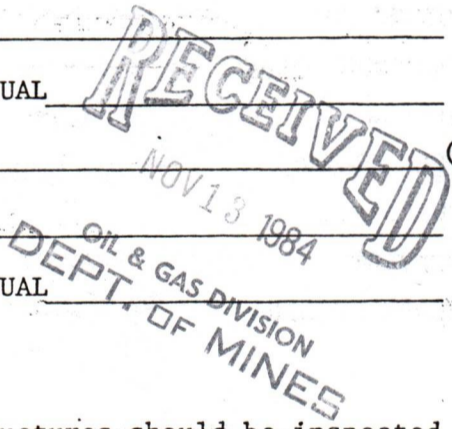

All structures should be inspected regularly and repaired if necessary. All commercial timber is to be cut and stacked and all brush and small timber to be cut and removed from the site before earth work begins.

TREATMENT AREA I		Revegetation	TREATMENT AREA II	
Lime _____	Tons/acre	Lime _____	Tons/acre	
or correct to pH <u>6.5</u>		or correct to pH <u>6.5</u>		
Fertilizer <u>500</u>	lbs/acre	Fertilizer <u>500</u>	lbs/acre	
(10-20-20 or equivalent)		(10-20-20 or equivalent)		
Mulch <u>Hay or Straw @ 1 1/2</u>	Tons/acre	Mulch <u>Hay or Straw @ 1 1/2</u>	Tons/acre	
Seed* <u>N/A County Route 85/3</u>	lbs/acre	Seed* <u>Ky 31 Tall Fescue</u>	40 lbs/acre	
	lbs/acre	<u>Redtop</u>	5 lbs/acre	
	lbs/acre		lbs/acre	

*Inoculate all legumes such as vetch, trefoil and clovers with the proper bacterium. Inoculate with 3X the recommended amount.

PLAN PREPARED BY Robert E 09/08/2023

Note: Please request landowner cooperation to protect new seedlings for one growing season. Attach separate sheets as necessary for comments.

Cabot Oil and Gas Corporation of WV
ADDRESS P.O. Box 628
Charleston, WV 25322
PHONE NO. (304) 347-1600

ATTACH OR PHOTOCOPY SECTION OF INVOLVED TOPOGRAPHIC MAP. QUADRANGLE Montgomery

LEGEND

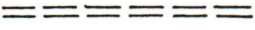













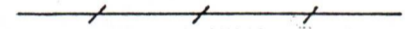

WELL SITE 
ACCESS ROAD 

PHOTOCOPY ATTACHED

WELL SITE PLAN

SKETCH TO INCLUDE WELL LOCATION, EXISTING ACCESS ROAD, ROADS TO BE CONSTRUCTED, WELLSITE, DRILLING PITS AND NECESSARY STRUCTURES NUMBERED OR LETTERED TO CORRESPOND WITH THE FIRST PART OF THIS PLAN. INCLUDE ALL NATURAL DRAINAGE.

LEGEND

WELL LOCATION		DRILLING PIT	
PROPOSED ROAD		EXISTING ROAD	
PROPERTY BOUNDARY		DIVERSION	
EXISTING FENCE		PROPOSED FENCE	
STREAM		SPRING	
WET SPOT		OPEN DITCH	
DRAIN PIPE		BUILDING	
WATERWAY		CULVERT	
RIP RAP		SLOPE OF LAND	

SKETCH ATTACHED

COMMENTS: This is an existing well to have additional work performed.

Existing location to be graded and leveled as required.

Topsoil will be utilized to construct diversion terraces.

All available topsoil shall be scalped from the work area, stockpiled and

utilized for topdressing after the site is regraded.

09/08/2023

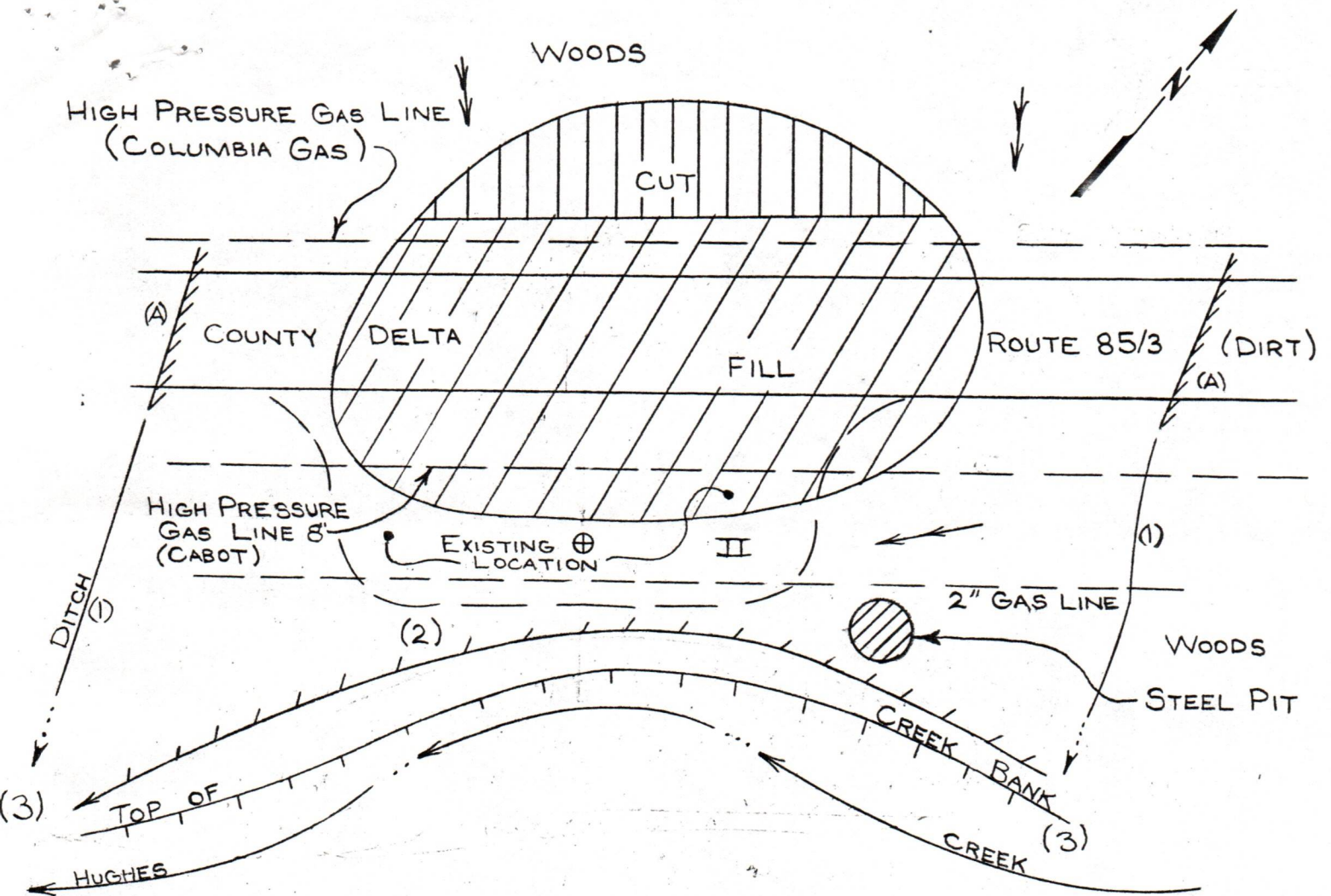

NOTE: EXISTING LOCATION TO BE GRADED AND LEVELED AS REQUIRED.

PLAN VIEW
SCALE: 1" = 20'

AREA II = 1 ACRE

CABOT OIL & GAS CORPORATION
OF WEST VIRGINIA

ARABELLA HUNTINGTON ESTATE #43

KOLB ENTERPRISES Ltd.
CHARLESTON, W. VA.

RECEIVED
NOV 18 1984

OIL & GAS DIVISION
DEPT. OF MINES

09/08/2023

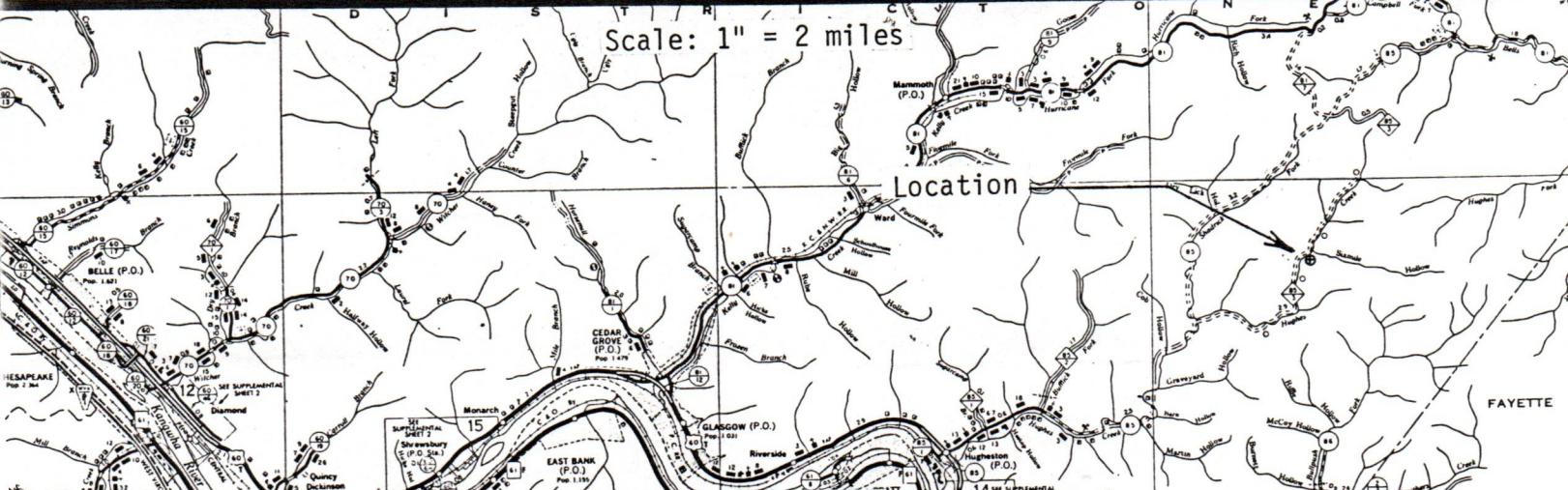
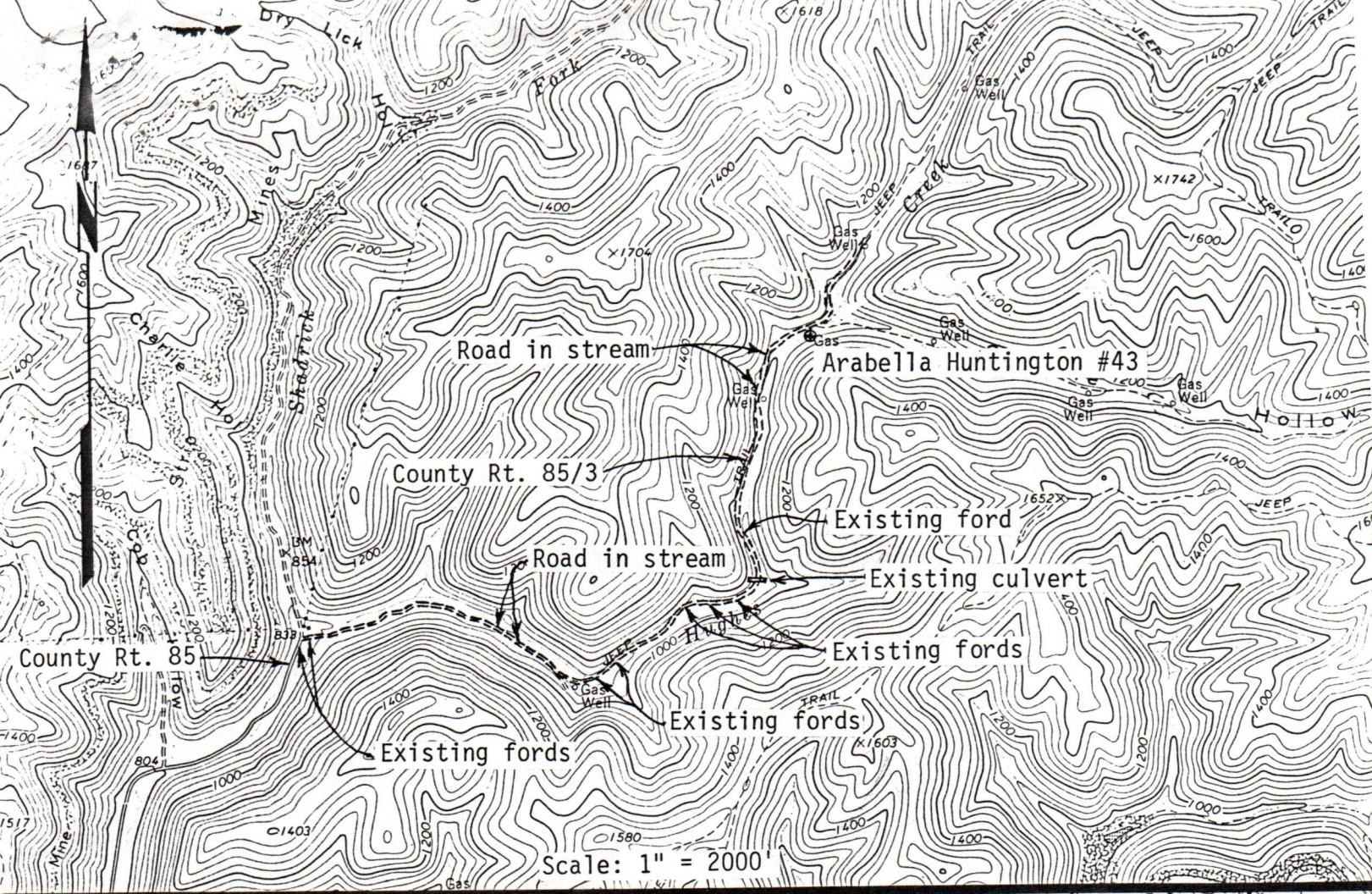

**CABOT OIL & GAS CORPORATION
OF WEST VIRGINIA**

ARABELLA HUNTINGTON ESTATE #43

QUADRANGLE: Montgomery

COUNTY: Kanawha
scale: 1" = 2000'

DISTRICT: Cabin Creek
contour interval: 40'

KOLB ENTERPRISES Ltd.
CHARLESTON, W. VA.

09/08/2023



WELL RECORD

SERIAL NO. 796 OPERATING DISTRICT AUK Map Square Lot No. Warrant No. 30-48
 FARM Huntington No. 43 LEASE NO.
 COUNTY Kanawha TAX DISTRICT Cabin Creek STATE W. Va.
 DRILLING COMMENCED April 16, 1934 DRILLING COMPLETED June 7, 1934
 CONTRACTOR Everett Ferrell ADDRESS Sodb, W. Va.

ROCK PRESSURE RECORD				PRODUCING SAND RECORD			
Big Line	Sand	510 lbs. in	24 hrs.	Sand, from	to	Init. Prod.	M. C. F. Gas
	Sand	lbs. in	hrs.	Sand, from	to	Init. Prod.	M. C. F. Gas
	Sand	lbs. in	hrs.	Sand, from	to	Init. Prod.	M. C. F. Gas

OPEN FLOW				CASING RECORD				
Time, Condition: 50 Water 10ths Mercury in 2" inch opening				SIZE	WEIGHT	USED IN DRILLING	LEFT IN WELL	HOW CASING SET
Volume 1,253,200 M. C. F.				13"		33	33	
24 HOUR PRODUCTION TEST AFTER TUBING				10"		512	512	
18/10 Merc. in 500 inch 744,480				8 1/4"		1391	1391	
Rock Press. 510# after 24 hrs in 24 Hours				6-5/8"		1922	1922	
TUBED AND SHUT IN Date 6-7-34				2"		2107	2107	
Packer, Size 2" x 6-5/8" KBK Ang Anchor								
Set, Depth 1961 Size Anchor 2" x 128'								
Perf. Top 2072 Bottom 2094								
Perf. Top Tubing casing at 2056'								

ELEVATION: 975.6
 Acid Shot with from to Date
 Gauge Before { Acid Shot } Gauge Min. Hrs. After { Acid Shot }

FORMATION	COLOR	TOP	BOTTOM	STEEL LINE MEASUREMENTS	HARD OR SOFT	OIL, GAS OR WATER	DEPTH FOUND	REMARKS
Gravel		0	33					
Sand		33	37			Water	40	Hole full.
Slate		37	42					
Sand		42	60					
Slate & Shells		60	167					
Coal		167	170					
Slate		170	250					
Sand		250	307					
Slate		307	444					
Lime		444	478					
Slate		478	505					
Coal		505	508					
Lime		508	532					
Slate		532	760					
Sandy Lime		760	850					
Crampus Sand		850	1000					
Slate		1000	1002					
First Salt Sand		1002	1170					
Slate		1170	1172			S.W.	1165	Hole full
Second Salt Sand		1172	1260					
Slate		1260	1270					
Sand		1270	1320					
Slate		1320	1322					
Lime		1322	1340					
Slate		1340	1372					
Lime		1372	1523					
Redrock		1523	1553					
Lime		1553	1575					
Slate		1575	1585					
Redrock		1585	1700					
Slate		1700	1733					
Redrock		1733	1743					
Slate & Shells		1743	1758					
Marston Sand		1758	1823					
Little Lime		1823	1857					
Slate		1857	1864					
						Salt Water	1790	3 baile rs per hour.

RECEIVED
 NOV 1 1934
 OIL & GAS DIVISION
 DEPT. OF MINES

09/08/2023

SERIAL NO. 796 FARM Huntington NO. 43 OPERATING DIST. Auk TOWNSHIP Auk MAP SQUARE LOT NO. 30-40 WARRANT NO. 40

FORMATION	COLOR	TOP	BOTTOM	STEEL LINE MEASUREMENTS	HARD OR SOFT	OIL, GAS OR WATER	DEPTH FOUND	REMARKS
White Lime		1864	1880					
Pencil Cave		1880	1985					
Big Lime		1895	2094	1972		Gas	2031	6/10 in 1" water.
				2094		Gas	2048	50/10 " 2" Merc.
						Gas	2052	30/10 in 2" "
TOTAL DEPTH								

09/08/2023

DATE _____

APPROVED _____ FOREMAN

IV-35
(Rev 8-81)



RECEIVED
FEB 12 1985

OIL & GAS DIVISION
DEPT. OF MINES

State of West Virginia
Department of Mines
Oil and Gas Division

Date February 7, 1985
Operator's
Well No. #43
Farm Arabella Huntington
API No. 47 - 039 - 0132

WELL OPERATOR'S REPORT
OF
DRILLING, FRACTURING AND/OR STIMULATING, OR PHYSICAL CHANGE

WELL TYPE: Oil ___ / Gas XX / Liquid Injection ___ / Waste Disposal ___ /
(If "Gas," Production XX / Underground Storage ___ / Deep ___ / Shallow XX /)

LOCATION: Elevation: 1018 Watershed Hughes Creek
District: Cabin Creek County Kanawha Quadrangle Montgomery

COMPANY Cabot Oil & Gas Corporation of WV
ADDRESS Box 628, Charleston, WV 25322
DESIGNATED AGENT Robert E. Horrell
ADDRESS Box 628, Charleston, WV 25322
SURFACE OWNER First & Merchants National Bank Trust Account of Mariners Museum
ADDRESS 2600 Washington Avenue Newport News, VA 23607
MINERAL RIGHTS OWNER First & Merchants Natl Bank Trust Acct of Mariners Museum
ADDRESS 2600 Washington Avenue Newport News, VA 23607
OIL AND GAS INSPECTOR FOR THIS WORK Russell Beall
ADDRESS Box 160, Philippi, WV 26416

PERMIT ISSUED 11/29/84
~~DRILLING~~ WORKOVER COMMENCED 12/5/84
~~DRILLING~~ WORKOVER COMPLETED 12/20/84

IF APPLICABLE: PLUGGING OF DRY HOLE ON CONTINUOUS PROGRESSION FROM DRILLING OR REWORKING. VERBAL PERMISSION OBTAINED ON _____

Casing & Tubing	Used in Drilling	Left in Well	Cement fill up Cu. ft.
Size 20-16 Cord.			
13-10"			
9 5/8			
8 5/8			
7			
5 1/2			
4 1/2		2398.01	120 sks TOC 900'
3			
2	Pulled	2112'	
1-1/2		2239.21	Seating Nipple @ 2205.29'

GEOLOGICAL TARGET FORMATION Weir, Injun, Big Lime Depth _____ feet

Depth of completed well 2414 feet Rotary ___ / Cable Tools _____

Water strata depth: Fresh _____ feet; Salt _____ feet

Coal seam depths: _____ Is coal being mined in the area? _____

OPEN FLOW DATA
Weir 2180-2200, 2252-2263
Injun 2110-2120
Producing formation Big Lime 1974-78, 2013-15, 2028, 2040, 2056-58, 2068
Pay zone depth _____ feet

Gas: Initial open flow - - Mcf/d Oil: Initial open flow - - Bbl/d

4 hr. Final open flow 304 Mcf/d Final open flow - - Bbl/d

Time of open flow between initial and final tests _____ hours

Static rock pressure 177 psig (surface measurement) after _____ hours shut in

(If applicable due to multiple completion--)

09/08/2023

Second producing formation _____ Pay zone depth _____ feet

Gas: Initial open flow _____ Mcf/d Oil: Initial open flow _____ Bbl/d

Final open flow _____ Mcf/d Oil: Final open flow _____ Bbl/d

Time of open flow between initial and final tests _____ hours

Static rock pressure _____ psig (surface measurement) after _____ hours shut in

(Continue on reverse side)

KAN

0132

DETAILS OF PERFORATED INTERVALS, FRACTURING OR STIMULATING, PHYSICAL CHANGE, ETC.
 MIRU Tri-State Well Service. Pulled 2112' of 2-3/8" tubing. RIH w/6-1/4" bit, 20 4-3/4" drill collars & 2-7/8" AOH drill pipe to 2099'. R/U Foamair, circ hole. Drilled deeper to 2404'. R/U Young Wireline Service, ran GR, Density, Ind, Temp & Sonic logs. LTD 2414'. R/U Howco, cmted w/120 sks 50/50 poz, 10% salt, 10#/sk Gilsonite. R/U McCullough, ran GR, Correlation, & CBL. LTD 2359'. TOC 900'. Perf Weir from 2180-2263' (15 holes). R/U Howco, dumped 250 gals 15% HCL. BD Weir @ 1940 psi. Treated w/450 sks 20/40 sand, max 2#/gal, 150 sks 10/20 max 2#/gal. AIR 6.5 BPM, 8000 SCF/min N₂ for 75 Q foam. ATP 1940 psi. TF 355 bbls. S/L 289 bbls, 483,000 SCF N₂. ISIP 1940 psi, 15 min 1770 psi. R/U McCullough, w/lubricator, perf Injun 2110-2120' (11 holes). R/U Howco, pumped 2 bbls 15% HCL, dropped frac ball, pumped 10 bbls 15% HCL & displaced ball to baffle. BD Injun @ 2900 psi, treated w/300 sks 20/40 sand, max 2#/gal. AIR 6.6 BPM, 9000 SCF/min N₂ for 75 Q foam. ATP 2400 psi, TF 198 bbls, S/L 99 bbls, 267,000 SCF N₂. ISIP 1750 psi, 15 min 1470 psi. Released thru 1/4" choke. Perf Big Lime 1976-2071' (11 holes). R/U Howco, pumped 2 bbls 15% HCL. Dropped frac ball & displaced to baffle w/15% HCL. BD @ 2800 psi & treated w/8000 gals 15% gelled HCL. AIR 9 BPM w/6,000 SCF/min N₂, ATP 2660 psi. Dropped 5 perf balls halfway thru treatment. TF 223 bbls

FORMATION	COLOR	HARD OR SOFT	TOP FEET	BOTTOM FEET	REMARKS Including indication of all fresh and salt water, coal, oil and gas
(192 bbls 15% gelled HCL, 12 bbls 15% reg HCL)			138,000	SCF N ₂	ISIP 1900 psi, 15 min 1500 psi. Seating nipple @ 2205.29'.
Drilled deeper					
Original TD				2099'	
Big Lime			2099'	2108'	
Injun			2108'	2130'	
Shale			2130'	2176'	
Weir			2176'	2268'	
Shale			2268'	2414'	LTD 2414'
SEE ATTACHED ORIGINAL WELL RECORD					

(Attach separate sheets as necessary)

CABOT OIL & GAS CORPORATION OF WEST VIRGINIA

Well Operator

By: Robert E. Howell 09/08/2023

Date: February 7, 1985

Note: Regulation 2.02(i) provides as follows:
 "The term 'log' or 'well log' shall mean a systematic detailed geological record of all formations, including coal, encountered in the drilling of a well."

STATE OF WEST VIRGINIA
DEPARTMENT OF MINES
OIL AND GAS WELLS DIVISION

RECEIVED

DEC 10 1984

OIL & GAS DIVISION

DEPT. OF MINES

INSPECTOR'S WELL REPORT

Permit No. 039-0132 DD

Oil or Gas Well GAS
(KIND)

Company <u>CABOT</u>	CASING AND TUBING	USED IN DRILLING	LEFT IN WELL	PACKERS
	Address <u>Charleston</u>	Size		
Farm <u>Mariners Museum</u>	16			Size of
Well No. <u>#43 A. Huntington</u>	13			Depth set
District <u>CABINCK.</u> County <u>KAN.</u>	10			Perf. top
Drilling commenced <u>12-5-84</u>	8 1/4			Perf. bottom
Drilling completed _____ Total depth _____	6 5/8			Perf. top
Date shot _____ Depth of shot _____	5 3/16			Perf. bottom
Initial open flow _____ /10ths Water in _____ Inch	3			Liners Used
Open flow after tubing _____ /10ths Merc. in _____ Inch	2			
Volume _____ Cu. Ft.	CASING CEMENTED _____ SIZE _____ No. FT. _____ Date _____			
Rock pressure _____ lbs. _____ hrs.	NAME OF SERVICE COMPANY _____			
Oil _____ bbls., 1st 24 hrs.	COAL WAS ENCOUNTERED AT _____ FEET _____ INCHES			
Fresh water _____ feet _____ feet	_____ FEET _____ INCHES	_____ FEET _____ INCHES	_____ FEET _____ INCHES	
Salt water _____ feet _____ feet	_____ FEET _____ INCHES	_____ FEET _____ INCHES	_____ FEET _____ INCHES	

Drillers' Names Tri-State Well Service Rig #8

Remarks: Move Rig on location
Start To Pull 238

12-5-84
DATE

Rod Dutton
09/08/2023
DISTRICT WELL INSPECTOR

STATE OF WEST VIRGINIA
DEPARTMENT OF MINES
OIL AND GAS WELLS DIVISION

RECEIVED
DEC 18 1984

INSPECTOR'S WELL REPORT OIL & GAS DIVISION
DEPT. OF MINES

Permit No. 039-0132-DD

Oil or Gas Well _____
(KIND)

Company <u>Cabot Gas Co.</u>	CASING AND TUBING	USED IN DRILLING	LEFT IN WELL	PACKERS
Address _____	Size			
Farm <u>Mariners Museum</u>	16			Kind of Packer _____
Well No. <u>A. Huntington #43</u>	13			
District <u>Cabin Creek County Kanawha</u>	10			Size of _____
Drilling commenced _____	8 1/4			
Drilling completed _____ Total depth _____	6 5/8			Depth set _____
Date shot _____ Depth of shot _____	5 3/16			
Initial open flow _____ /10ths Water in _____ Inch	3			Perf. top _____
Open flow after tubing _____ /10ths Merc. in _____ Inch	2			Perf. bottom _____
Volume _____ Cu. Ft.	Liners Used			Perf. top _____
Rock pressure _____ lbs. _____ hrs.				Perf. bottom _____
Oil _____ bbls., 1st 24 hrs.	CASING CEMENTED _____ SIZE _____ No. FT. _____ Date _____			
Fresh water _____ feet _____ feet	NAME OF SERVICE COMPANY _____			
Salt water _____ feet _____ feet	COAL WAS ENCOUNTERED AT _____ FEET _____ INCHES			
	_____ FEET _____ INCHES _____ FEET _____ INCHES			
	_____ FEET _____ INCHES _____ FEET _____ INCHES			

Drillers' Names Tri-State Well Service

Remarks:

Coming out of hole, Laying down Drill pipe.
Tri-State well Service doing work

19-10-84

DATE

Carlos W. Hinchey
09/08/2023

DISTRICT WELL INSPECTOR

Form 26
2/16/82

**STATE OF WEST VIRGINIA
DEPARTMENT OF MINES
OIL AND GAS WELLS DIVISION
INSPECTOR'S PLUGGING REPORT**

Permit No. _____

Well No. _____

COMPANY _____ ADDRESS _____

FARM _____ DISTRICT _____ COUNTY _____

Filling Material Used _____

Liner			Location		Amount	Packer	Location		
PLUGS USED AND DEPTH PLACED			BRIDGES			CASING AND TUBING			
CEMENT-THICKNESS	WOOD-SIZE	LEAD	CONSTRUCTION-LOCATION			RECOVERED	SIZE	LOST	

Drillers' Names _____

Remarks:

_____ I hereby certify I visited the above well on this date.
DATE

_____ 09/08/2023
DISTRICT WELL INSPECTOR

STATE OF WEST VIRGINIA
DEPARTMENT OF MINES
OIL AND GAS WELLS DIVISION

RECEIVED

JAN 4 - 1985

OIL & GAS DIVISION
DEPT. OF MINES

INSPECTOR'S WELL REPORT

Permit No. 039-0135-DD

Oil or Gas Well _____
(KIND)

Company <u>Cabot Gas Co.</u>	CASING AND TUBING	USED IN DRILLING	LEFT IN WELL	PACKERS
Address _____	Size			
Farm <u>Mariners Museum</u>	16			Kind of Packer _____
Well No. <u>A. Huntington # 43</u>	13			
District <u>Cabin Creek County Kanawha</u>	10			Size of _____
Drilling commenced _____	8 1/4			
Drilling completed _____ Total depth _____	6 5/8			Depth set _____
Date shot _____ Depth of shot _____	5 3/16			
Initial open flow _____ /10ths Water in _____ Inch	3			Perf. top _____
Open flow after tubing _____ /10ths Merc. in _____ Inch	2			Perf. bottom _____
Volume _____ Cu. Ft.	Liners Used			Perf. top _____
Rock pressure _____ lbs. _____ hrs.				Perf. bottom _____
Oil _____ bbls., 1st 24 hrs.	CASING CEMENTED _____ SIZE _____ No. FT. _____ Date _____			
Fresh water _____ feet _____ feet	NAME OF SERVICE COMPANY _____			
Salt water _____ feet _____ feet	COAL WAS ENCOUNTERED AT _____ FEET _____ INCHES			
	_____ FEET _____ INCHES _____ FEET _____ INCHES			
	_____ FEET _____ INCHES _____ FEET _____ INCHES			

Drillers' Names Tri-State Well Service

Remarks:

Pulling Tubing to do Gas Flow Test.

12-26-84
DATE

Carlos W. Hines
DISTRICT WELL INSPECTOR

09/08/2023

2/16/82

**STATE OF WEST VIRGINIA
DEPARTMENT OF MINES
OIL AND GAS WELLS DIVISION
INSPECTOR'S PLUGGING REPORT**

Permit No. _____

Well No. _____

COMPANY _____ ADDRESS _____

FARM _____ DISTRICT _____ COUNTY _____

Filling Material Used _____

Liner			Location	Amount	Packer	Location		
PLUGS USED AND DEPTH PLACED			BRIDGES			CASING AND TUBING		
CEMENT-THICKNESS	WOOD-SIZE	LEAD	CONSTRUCTION-LOCATION			RECOVERED	SIZE	LOST

Drillers' Names _____

Remarks:

I hereby certify I visited the above well on this date.

DATE

DISTRICT WELL INSPECTOR

09/08/2023

STATE OF WEST VIRGINIA
DEPARTMENT OF MINES
OIL AND GAS WELLS DIVISION

RECEIVED
JAN 29 1985

OIL & GAS DIVISION
DEPT. OF MINES

INSPECTOR'S WELL REPORT

Permit No. 039-0132-DD

Oil or Gas Well _____
(KIND)

Company Cabot Gas Co.

Address _____

Farm Mariners Museum

Well No. A. Huntington # 43

District Cabin Creek County Kanawha

Drilling commenced _____

Drilling completed _____ Total depth _____

Date shot _____ Depth of shot _____

Initial open flow _____ /10ths Water in _____ Inch

Open flow after tubing _____ /10ths Merc. in _____ Inch

Volume _____ Cu. Ft.

Rock pressure _____ lbs. _____ hrs.

Oil _____ bbls., 1st 24 hrs.

Fresh water _____ feet _____ feet

Salt water _____ feet _____ feet

CASING AND TUBING	USED IN DRILLING	LEFT IN WELL	PACKERS
Size			
16			Kind of Packer _____
13			
10			Size of _____
8 1/4			
6 3/8			Depth set _____
5 3/16			
3			Perf. top _____
2			Perf. bottom _____
Liners Used			Perf. top _____
			Perf. bottom _____

CASING CEMENTED _____ SIZE _____ No. FT. _____ Date _____

NAME OF SERVICE COMPANY _____

COAL WAS ENCOUNTERED AT _____ FEET _____ INCHES

_____ FEET _____ INCHES _____ FEET _____ INCHES

_____ FEET _____ INCHES _____ FEET _____ INCHES

Drillers' Names _____

Remarks:
Well is hooked into production & No Reclamation being done.

1-25-85
DATE

Charles W. Hinchey
DISTRICT WELL INSPECTOR

09/08/2023

Form 26
2/16/82

RECEIVED
JAN 29 1982
OIL & GAS DIVISION
DEPT. OF MINES

**STATE OF WEST VIRGINIA
DEPARTMENT OF MINES
OIL AND GAS WELLS DIVISION
INSPECTOR'S PLUGGING REPORT**

Permit No. _____

Well No. _____

COMPANY _____ ADDRESS _____

FARM _____ DISTRICT _____ COUNTY _____

Filling Material Used _____

Liner			Location		Amount	Packer	Location		
PLUGS USED AND DEPTH PLACED						BRIDGES	CASING AND TUBING		
CEMENT-THICKNESS	WOOD-SIZE	LEAD				CONSTRUCTION-LOCATION	RECOVERED	SIZE	LOST

Drillers' Names _____

Remarks:

_____ I hereby certify I visited the above well on this date.

DATE

DISTRICT WELL INSPECTOR

09/08/2023

STATE OF WEST VIRGINIA
DEPARTMENT OF MINES
OIL AND GAS WELLS DIVISION

RECEIVED
MAY 28 1985

INSPECTOR'S WELL REPORT

OIL & GAS DIVISION
DEPT. OF MINES
Oil or Gas Well _____
(KIND)

Permit No. 039-0133-DD

Company <u>Cabat Oil + Gas</u>	CASING AND TUBING	USED IN DRILLING	LEFT IN WELL	PACKERS
	Address _____	Size		
Farm <u>Mariners Museum</u>	16			Kind of Packer _____
Well No. <u>A. Huntington #43</u>	13			
District <u>Cabin Creek County Kanawha</u>	10			Size of _____
Drilling commenced _____	8 1/4			
Drilling completed _____ Total depth _____	6 5/8			Depth set _____
Date shot _____ Depth of shot _____	5 3/16			
Initial open flow _____ /10ths Water in _____ Inch	3			Perf. top _____
Open flow after tubing _____ /10ths Merc. in _____ Inch	2			Perf. bottom _____
Volume _____ Cu. Ft.	Liners Used			Perf. top _____
Rock pressure _____ lbs. _____ hrs.				Perf. bottom _____
Oil _____ bbls., 1st 24 hrs.	CASING CEMENTED _____ SIZE _____ No. FT. _____ Date _____			
Fresh water _____ feet _____ feet	NAME OF SERVICE COMPANY _____			
Salt water _____ feet _____ feet	COAL WAS ENCOUNTERED AT _____ FEET _____ INCHES			
	_____ FEET _____ INCHES _____ FEET _____ INCHES			
	_____ FEET _____ INCHES _____ FEET _____ INCHES			

Drillers' Names _____

Remarks: NO API number on well

5-21-85
DATE

Carlos W. Hines
DISTRICT INSPECTOR

09/08/2023

Form 26
2/16/82

STATE OF WEST VIRGINIA
DEPARTMENT OF MINES
OIL AND GAS WELLS DIVISION
INSPECTOR'S PLUGGING REPORT

RECEIVED
MAY 8 8 58 AM
OIL & GAS DIVISION

Permit No. _____ Well No. _____

COMPANY _____ ADDRESS _____

FARM _____ DISTRICT _____ COUNTY _____

Filling Material Used _____

Liner		Location		Amount	Packer	Location	
PLUGS USED AND DEPTH PLACED			BRIDGES		CASING AND TUBING		
CEMENT-THICKNESS	WOOD-SIZE	LEAD	CONSTRUCTION-LOCATION		RECOVERED	SIZE	LOST

Drillers' Names _____

Remarks:

_____ I hereby certify I visited the above well on this date.
DATE

DISTRICT WELL INSPECTOR 09/08/2023

STATE OF WEST VIRGINIA
DEPARTMENT OF MINES
OFFICE OF OIL AND GAS
CHARLESTON 25305
FINAL INSPECTION REPORT
INSPECTORS COMPLIANCE REPORT

RECEIVED
JUN 26 1985

OIL & GAS DIVISION
DEPT. OF MINES

Company: CABOT O & G CORP
Farm: MARINERS MUSEUM

Well: HUNTINGTON 43

Permit No. 47-
County: KANAWHA

(11-29-84)
47-039-132-0

Rule	Description	In Compliance	
		Yes	No
23.06	Notification prior to starting work	-----	-----
25.04	Prepared before drilling to prevent waste	-----	-----
25.03	High pressure drilling	-----	-----
16.01	Required permits at wellsite	-----	-----
15.03	Adequate Fresh Water Casings	-----	-----
15.02	Adequate Coal Casings	-----	-----
15.01	Adequate Production Casings	-----	-----
15.04	Adequate Cement Strength	-----	-----
15.05	Cement Type	-----	-----
23.02	Maintained Access Roads	-----	-----
25.01	Necessary Equipment to Prevent Waste	-----	-----
23.04	Reclaimed Drillings Pits	-----	-----
23.05	No Surface or Underground Pollution	-----	-----
23.07	Requirements for Production & Gathering Pipelines	-----	-----
14.01	Well Records on Site	-----	-----
14.02	Well Records Filed	-----	-----
7.05	Identification Markings	-----	-----

I HAVE INSPECTED THE ABOVE CAPTIONED WELL AND RECOMMEND THAT IT BE RELEASED:

SIGNED *Carlos W. Finley*
DATE 6-18-85

Your well record was received and reclamation requirements approved. In accordance with Chapter 22, Article 4, Section 2, the above well will remain under bond coverage for the life of the well.

T. H. ...

Administrator

July 3, 1985

Date

FIRST NATIONAL BANK OF NEWPORT NEWS

DEED BOOK 60 PAGE 450

3758.8 ACRES

LONGITUDE 81-17.30

NORTH

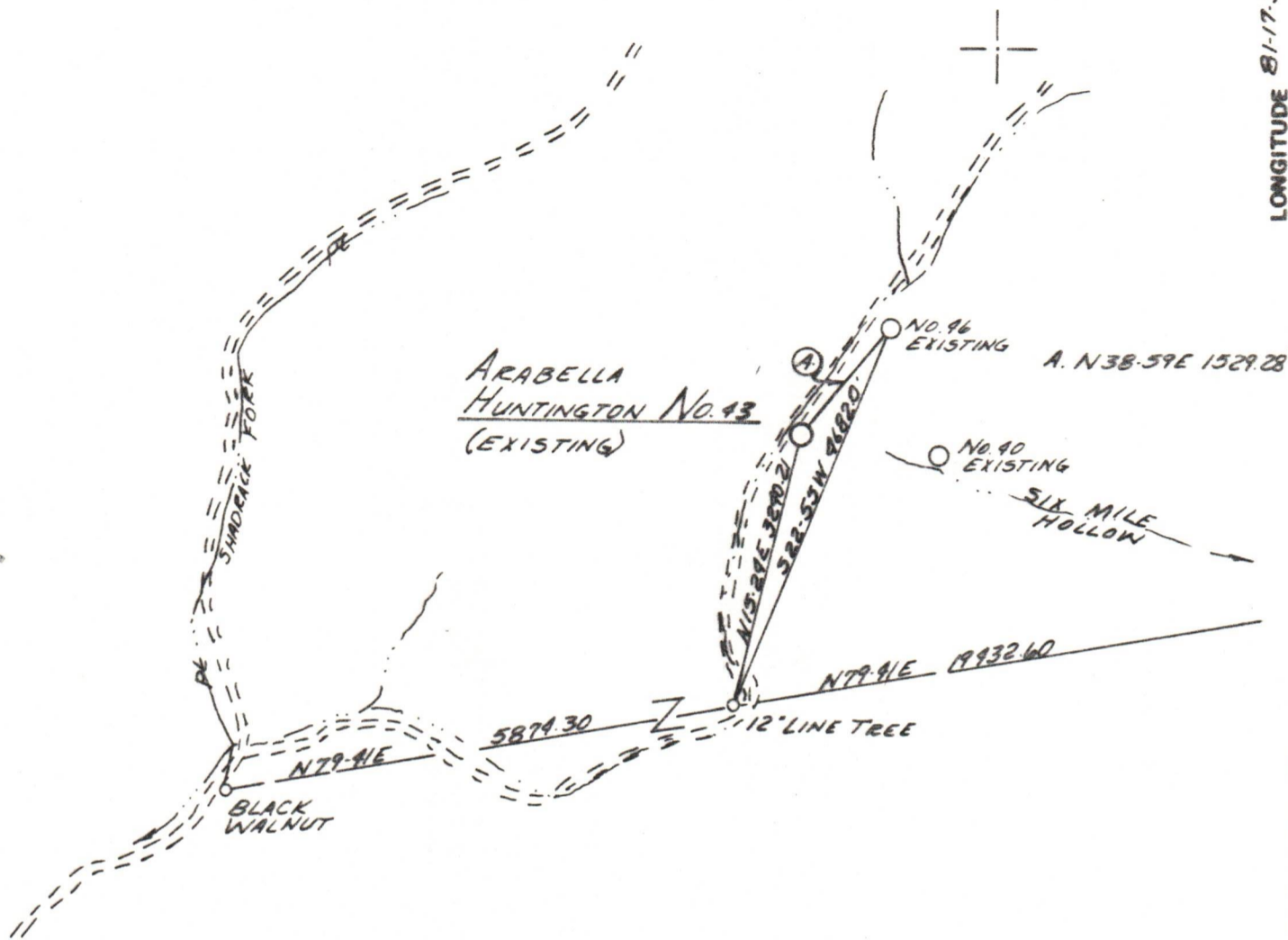

FILE NO. _____
 DRAWING NO. _____
 SCALE 1" = 2000'
 MINIMUM DEGREE OF ACCURACY 1:500
 PROVEN SOURCE OF ELEVATION ARABELLA HUNTINGTON No. 46 (EXISTING WELL)
 ELEVATION 1092'

I THE UNDERSIGNED, HEREBY CERTIFY THAT THIS PLAT IS CORRECT TO THE BEST OF MY KNOWLEDGE AND BELIEF AND SHOWS ALL THE INFORMATION REQUIRED BY LAW AND THE REGULATIONS ISSUED AND PRESCRIBED BY THE DEPARTMENT OF MINES.
 (SIGNED) Bryant W. Bowman
 R.P.E. _____ L.L.S. 736

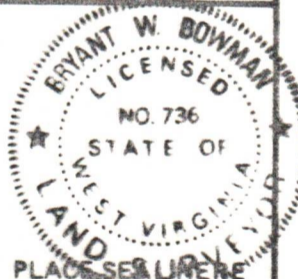

(+) DENOTES LOCATION OF WELL ON UNITED STATES TOPOGRAPHIC MAPS

FORM IV-6 (8-78)



DATE 11-1, 1989
 OPERATOR'S WELL NO. ARABELLA
 API WELL NO. HUNTINGTON No. 43
47 039 - 0132-03
 STATE COUNTY PERMIT

STATE OF WEST VIRGINIA
 DEPARTMENT OF MINES
 OIL AND GAS DIVISION

WELL TYPE: OIL ___ GAS ___ LIQUID INJECTION ___ WASTE DISPOSAL ___
 (IF "GAS,") PRODUCTION ___ STORAGE ___ DEEP ___ SHALLOW ___
 LOCATION: ELEVATION 1018' WATER SHED HUGHES CREEK
 DISTRICT CABIN CREEK COUNTY KANAWHA
 QUADRANGLE MONTGOMERY

SURFACE OWNER FIRST NATIONAL BANK NEWPORT NEWS ACREAGE 3758.8
 OIL & GAS ROYALTY OWNER FIRST NATIONAL BANK NEWPORT NEWS LEASE ACREAGE 3758.8
 LEASE NO. 47-0699

09/08/2023

PROPOSED WORK: DRILL ___ CONVERT ___ DRILL DEEPER ___ REDRILL ___ FRACTURE OR STIMULATE ___ PLUG OFF OLD FORMATION ___ PERFORATE NEW FORMATION ___ OTHER PHYSICAL CHANGE IN WELL (SPECIFY) _____

PLUG AND ABANDON ___ CLEAN OUT AND REPLUG ___
 TARGET FORMATION Weir ESTIMATED DEPTH 2400'
 WELL OPERATOR CABOT OIL & GAS CORP. W.VA. DESIGNATED AGENT BOB MORRELL
 ADDRESS PO BOX 628 ADDRESS P.O. BOX 628
CHARLESTON, W.VA. CHARLESTON, W.VA.