

LATITUDE (15') 39° 30'  
(7.5) 39° 27' 30"

(15') 81° 30'  
(7.5) 81° 32' 30"

LONGITUDE

7.5'

7.5 OGIS topo location

7.5' loc	<u>2.84E</u>	15' loc	<u>5.72</u>
	<u>.04W</u>	(calc.)	<u>2.30W</u>

Company S B Avis, Trustee

Farm W T Copen /

Quad Big Chimney 7.5' / Charleston 15' (NE)

County Kanawha

District ELK

WELL LOCATION MAP

File No. 039-147  
Kanawha

DEEP WELL 6.6 Elk-Poca (Sissonville) (192)

Well # 1-5-B Area  
Elk Dist Kansas

Kan 147

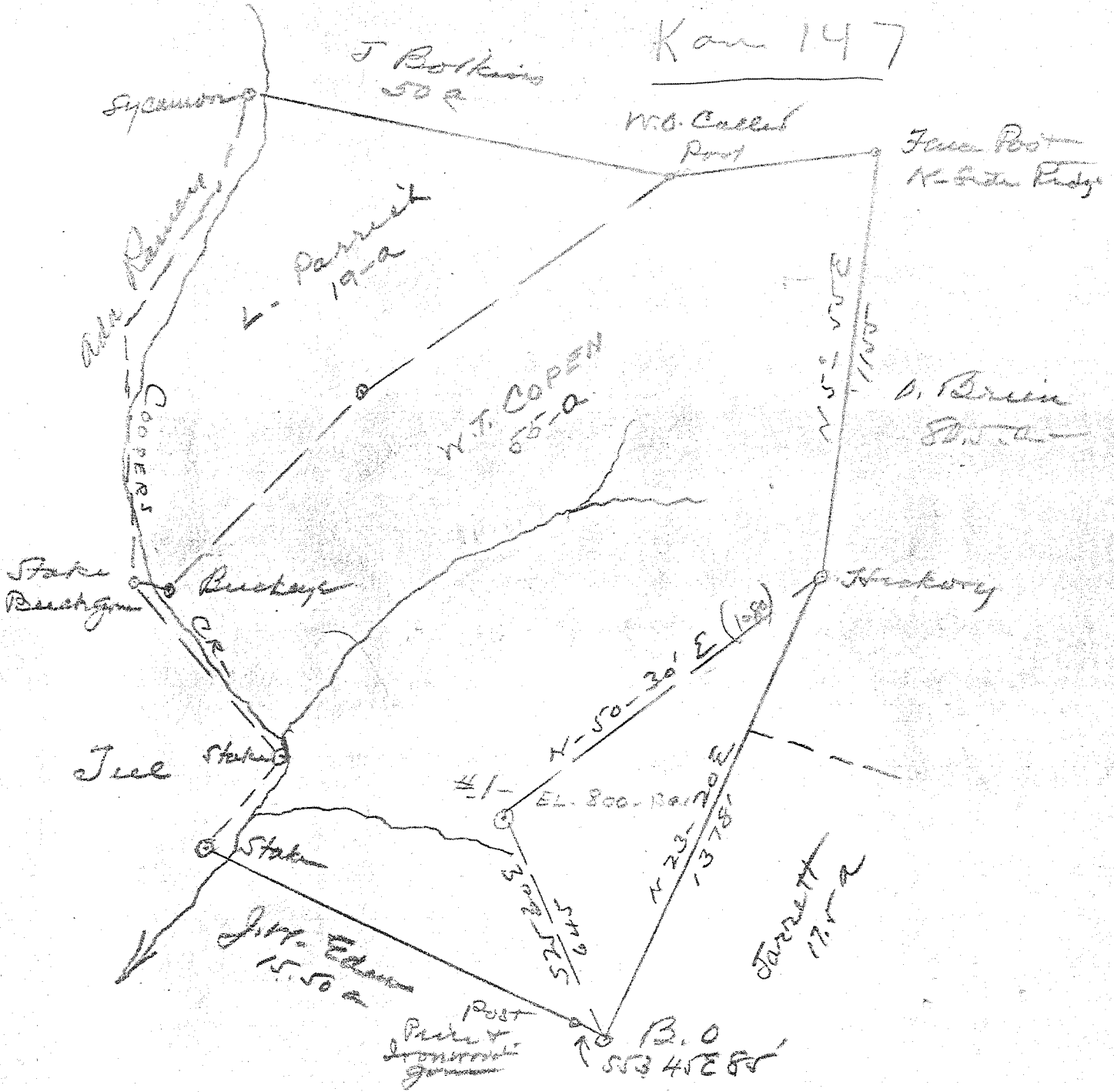

(Scale 1" = 400'  
Res)

# WEST VIRGINIA DEPARTMENT OF MINES

## OIL AND GAS DIVISION

### PRELIMINARY DATA SHEET NO. 1

File No. KAN-147

Well No. 1

S. B. Avis, Trustee Company of Charleston, W. Va.  
on the J. T. Jopen Farm  
containing \_\_\_\_\_ acres. Location \_\_\_\_\_

Elk District, in Kanawha County, West Virginia

The surface of the above tract is owned in fee by \_\_\_\_\_  
of \_\_\_\_\_ address, and the mineral rights are owned by  
\_\_\_\_\_ of \_\_\_\_\_

The oil and gas privileges are held under lease by the above named company, and this well is drilled under permit  
No. Kan-147 issued by the West Virginia Department of Mines, Oil and Gas Division  
\_\_\_\_\_ 193\_\_\_\_\_.

Elevation of surface at top of well, 800' Spirit /  
Barometric.

The number of feet of the different sized casings used in the well.

_____	feet	_____	size.	Wood conductor.
<u>21'3"</u>	feet	<u>13"</u>	size, csg.	<u>301'</u>
_____	feet	_____	size, csg.	<u>10"</u>
<u>672'</u>	feet	<u>8 1/2"</u>	size, csg.	<u>1753'</u>
_____	feet	_____	size, csg.	<u>6 5/8"</u>
<u>4493'6"</u>	feet	<u>5 3/6"</u>	size, csg.	_____
_____	feet	_____	size, csg.	_____

\_\_\_\_\_ packer of \_\_\_\_\_ size, set at \_\_\_\_\_

\_\_\_\_\_ packer of \_\_\_\_\_ size, set at \_\_\_\_\_

\_\_\_\_\_, in casing perforated at \_\_\_\_\_ feet to \_\_\_\_\_ feet.

\_\_\_\_\_, in casing perforated at \_\_\_\_\_ feet to \_\_\_\_\_ feet.

Coal was encountered at 260-264 feet, thick ness 48" inches, and at 271-276  
feet; thickness 60" inches; and at \_\_\_\_\_ feet; thickness \_\_\_\_\_ inches.

Liners were used as follows: (Give details) \_\_\_\_\_

Feb. 12, 1935 completed Date.

Approved S. B. Avis, Trustee, Owner.

By \_\_\_\_\_ (TITLE)

KAN-147

S. B. Avis, Trustee Company  
 Charleston, W. Va. Address  
 WELL No. 1 FARM W. T. Copen

COMPLETION DATA SHEET  
 No. 2  
 FORMATION RECORD

Name	Color	Character	Oil, Gas or Water	Top	Bottom	Thickness	Total Depth	Remarks
Soil				0	14			
White slate			Water 110'	14	210			only about 1/3 enough to drill with
White Sand				210	260			
Coal				260	264			
Slate				264	271			
Coal				271	276			
Slate				276	325			
Lime				325	335			
Slate				335	340			
Sand				340	382			
Slate and shells				382	487			
Slate				487	540			
Sand				540	641			
Slate				641	702			
Sand				702	780			
Slate				780	795			
Sand				795	820			
Slate				820	825			
Sand				825	900			
Slate				900	910			
Sand			Gas 960'	910	970			Insufficient to test
Slate				970	975			
Salt Sand			Hole full	975	1380			
Black Slate			water 990'	1380	1425			
Maxton Sand			and 1020'	1425	1509			
Little Lime				1509	1535			
Pencil Cave				1535	1538			
Big Lime				1538	1692			
Big Injun Sand			Show of gas	1692	1742			
Black Lime			1704'	1742	1765			
Slate and shells			Show of	1765	2100			
Berea Sand shells			gas 1840'	2100	2109			
Slate and shells				2109	2400			
Hard shells				2400	2465			
Slate and shells				2465	2650			
White slate				2650	3270			
Black slate and shells				3270	3343			
Black shale				3343	3415			
White slate and shells				3415	3650			
Brown shale				3650	3675			
Slate and lime				3675	3829			
Brown shale				3829	3992			
Lime shells and slate				3992	4500			
Brown shale				4500	4550			
White slate				4550	4575			
Brown shale				4575	4610			

shot  
 Well was not shot at.....feet; well was shot at.....feet.

Salt  
 Fresh water at.....feet; fresh water at.....feet.

producing  
 Well was hole.  
 dry

Date..... Approved..... Owner.....

NOTE: All bottom formations must be noted as indicated above and all key-rocks and oil and gas sands must be recorded under their proper geological names in the district as well as any local names commonly used in the district for such strata.

KAN-147

OIL OR GAS WELL

.....Company

COMPLETION DATA SHEET

.....Address

No. 2

WELL No. ....

FARM .....

FORMATION RECORD

Name	Color	Character	Oil, Gas or Water	Top	Bottom	Thickness	Total Depth	Remarks
White slate				4610	4625			
Brown shale				4625	4818			
White slate				4818	4842			
Brown shale				4842	4879			
Lime shells				4879	4884			
Brown shale				4884	4916			
Corniferous Lime				4916	5019			
Oriskany Sand			Gas at 5021'	5019	5029			Volume 17,136 cu. ft. initial
Total depth, in Oriskany Sand							5043	
				4916	5019	5029		

Well was ~~not~~ shot at Oriskany Sand shot with 90 feet; well was shot at ..... feet.  
 pounds, 5019-32'. Ten minutes after shot, the test showed a volume of 35M cu. ft.  
 Salt five minutes later this reduced ~~to~~ 26,500 cu. ft. and half hour after shot the  
 Fresh water at ..... gas volume was still decreasing; fresh water at ..... feet.

Well was producing hole.  
dry

Completed Feb. 12, 1935  
 Date

Approved .....

S. V. Avis, Trustee  
 Owner

NOTE: All bottom formations must be noted as indicated above and all key-rocks and oil and gas sands must be recorded under their proper geological names in the district as well as any local names commonly used in the district for such strata.