

LATITUDE 38° 30'

LONGITUDE 81° 30'

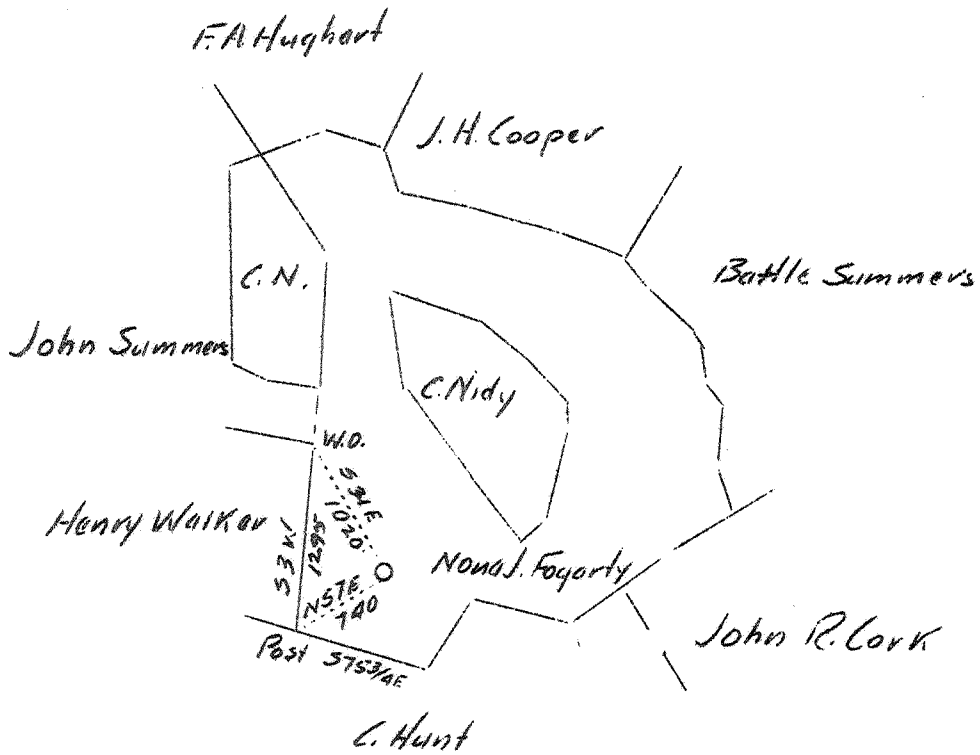

7.5' 0615 loc 15'
 38° 30' .435 .435
 81° 30' .81w .81w

0.93 W
 0.468

Company	Columbian Carbon Co.
Address	Box 1240, Charleston, W. Va.
Farm	Nona J. Fogarty
Tract	Acres 154 Lease No. C-529
Well (Farm) No.	1 Serial No.
Elevation	1020 (Bar)
Quadrangle	Charleston (NE)
County	Kanawha District Elk
Engineer	C.A. Branham
Engineer's Registration No.	683
File No.	Drawing No.
Date	6/21/37 Scale 1"-1320'

STATE OF WEST VIRGINIA
 Department of Mines
 OIL AND GAS DIVISION
 CHARLESTON

WELL LOCATION MAP
 File No. KAN-406

+ Denotes location of well on United States Topographic Maps, scale 1 to 62,500, latitude and longitude lines being represented by border lines as shown.

— Denotes one inch spaces on border line of original tracing.

6-9 192

WEST VIRGINIA DEPARTMENT OF MINES

OIL AND GAS DIVISION

WELL RECORD

Permit No. Kan-406

Gas Well

Charleston Quad. *N.E.*

CASING & TUBING

Company	Columbian Carbon Co.	14	35'8"	35'8"
Address	Box 1240, Charleston, W.Va.	10 $\frac{3}{4}$	449'10"	Pulled
Farm	Nona J. Fogarty Acres 154	8 5/8	1693'3"	1693'3"
Location	Wolfpen Br. Little Sandy	3 5/8	5085'	5085'
Well No.	1 (G.W.-394) Elev. 949.7	2	Shut in on casing.	
District	Elk County Kanawha			
Surface	Mark C. Moles, Elkview, W.Va.			
Mineral (Oil & Gas & portion of coal.)	Nona J. Fogarty, et al Frame, W.Va.	Casing Cemented: See reverse side.		
Balance Coal-	Alex. M. Bruen Hrs., New York City			
Drilling	7-24-37 Commenced			
	10-26-37 Completed			
Date Shot	10-27-37 Depth 5165-5234			
Volume	8,150,000 Cu. Ft.			
Rock Press.	1210# 1 hr.			
Oil	Show			

Formation	Color	Hgr	Top	Base	Result	Formation	Color	Hgr	Top	Base	Result
Clay	Yellow		0	15		Slate & Shells			3395	3695	
Sand			15	35		Slate Shells & Shale			3695	3800	
Slate			35	60		Slate			3800	3950	
Red Rock			60	130	Water	Shale			3950	4080	
Slate			130	140	125	Slate			4080	4660	
Red Rock			140	158	1-10"	Shale			4660	4940	
Slate	White		158	165	Blr. in	Slate	White		4940	4990	
Sand			165	181	3 hrs.	Shale	Black		4990	5040	
Slate	White		181	239		Comiferous			5040	5158	
Red Rock			239	259		Oriskany			5158	5233	
Slate			259	275		Lime <i>held</i>	Black		5233	5242	
Red Rock			275	325		TOTAL DEPTH				5242	
Slate	White		325	452							
Sand			452	481							
Slate			481	500					1st pay	5167-	5167 $\frac{1}{2}$
Sand			500	572					2nd pay	5171-	5187
Slate			572	625					3rd pay	5226-	5226 $\frac{1}{2}$
Sand			625	638	Water				4th pay	5232-	5233
Slate & Shells			638	717	630				Oil Show		5213'
Sand			717	780	1/3-						
Slate			780	880	10" Blr.						
Sand			880	928	pr. hr.						
Slate			928	1005							
Sand			1005	1015							
Slate			1015	1051							
Sand			1051	1081							
Slate			1081	1106							
Sand			1106	1112							
Slate			1112	1118							
1st Salt Sand			1118	1188							
Slate			1188	1208							
2nd Salt Sand			1208	1234	Show						
Slate			1234	1240	Gas						
3rd Salt Sand			1240	1427	1220						
Slate			1427	1438	Water						
Maxon			1438	1619	1280						
Little Lime			1619	1638	500' in						
Pencil Cave			1638	1644	12 hr.						
Lime	Black		1644	1655	Water						
Pencil Cave			1655	1669	1300						
Big Lime			1669	1830	HFV						
Injun Sand			1830	1840	Gas Sh.						
Slate			1840	1855	1810-						
Slate & Shells			1855	1956	1815						
Slate			1956	2090							
Slate & Shells			2090	2800	Sh. Gas						
Slate			2800	3395	1823-27						

Cement record: 8/22/37 Ran cement in 8 5/8". Used 6 sacks Aquagel and 82 sacks Incor cement. Aquagel ahead of cement. One plug after Aquagel. 10' spacer after cement. One plug of cement. Casing went back within 1" of bottom. 20' of cement left in 8 5/8".

10/7/37- Ran cement in 6 5/8" Used 25 sack Alpha Cement. 5054' cement. Left 20' cement in pipe.