

38° 32' 30"

LATITUDE 38° 35'

LONGITUDE 81° 35'
81° 37' 30"

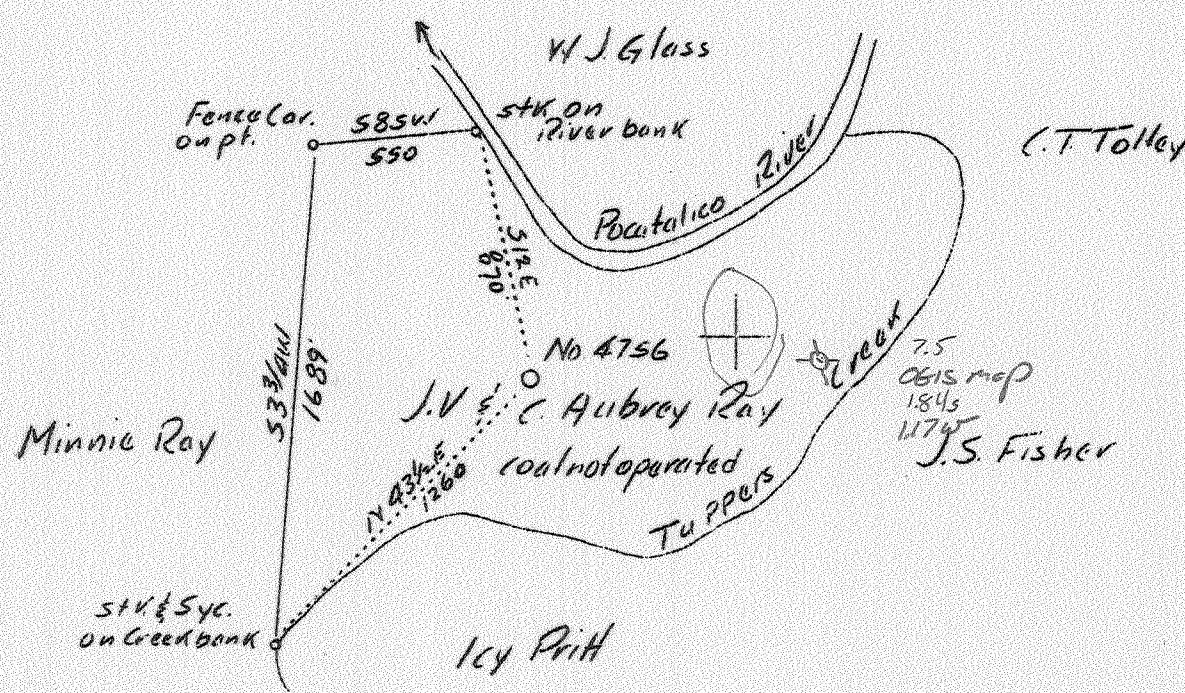

3.53 W
4.73 8

Company	United Fuel Gas Co.
Address	Charleston, W.Va.
Farm	J.V. & C. Aubrey Ray
Tract	Acres 66 Lease No. 41935
Well (Farm) No.	1 Serial No. 4756
Elevation (Spirit Level)	
Quadrangle	Kenna Sissonville (A.B.)
County	Kanawha District Poca
Engineer	G.A. Cunningham
Engineer's Registration No.	659
File No.	60-69 Drawing No.
Date	June 25, 1937 Scale 1"=660'

STATE OF WEST VIRGINIA
 Department of Mines
 OIL AND GAS DIVISION
 CHARLESTON

WELL LOCATION MAP
 File No. KAN-407

+ Denotes location of well on United States Topographic Maps, scale 1 to 62,500, latitude and longitude lines being represented by border lines as shown.

- Denotes one inch spaces on border line of original tracing.

WEST VIRGINIA DEPARTMENT OF MINES

OIL AND GAS DIVISION

WELL RECORD

Permit Kan-407

Gas Well

Kenna

CASING & TUBING

Company	United Fuel Gas Co.	10	1197	1197
Address	Charleston, W.Va.	8 5/8	1812	1812
Farm	J.V. & C. Aubrey Ray	7	4807	4807
Location	Tuppers Creek			
Well No.	4756			
District	Poca			
Surface	Jno. V. Ray, Agt., Charleston, W.Va.			
Mincral	Same			
Drilling	Commeneed July 26, 1937			
	Completed Nov. 9, 1937			
Volume	12,475,000 Cu.Ft.			
Rock Press.	Not given			

CASING CEMENTED: 7",
4762.

Formation	Color	Hor	Top	Base	Result	Formation	Color	Hor	Top	Base	Result
Surface			0	14							
Bastard Sand			14	30							
Shale			30	70							
Lime			70	100							
Sand			100	132							
Shale			132	150							
Slate & Shell			150	230							
Sand			230	265							
Slate			265	275							
Lime Shells			275	280							
Slate			280	335							
Red Rock			335	345							
Slate & Shell			345	460							
Sand			460	500							
Slate & Shell			500	635							
Coal			635	638							
Lime			638	675							
Sand			675	710							
Slate & Shell			710	1077							
Salt Sand			1077	1495	Water						
Maxon Sand			1495	1527	1200						
Little Lime			1527	1547	Gas						
Pencil Cave			1547	1553	Maxon						
Big Lime			1553	1704	Gas						
Big Injun			1704	1768							
Big Injun				1782							
Lime Shell			1782	1797							
Slate & Shell			1797	3385							
Brown Shale			3385	3410							
Slate & Shells			3410	3560							
Slate White			3560	3630							
Slate & Shells			3630	3815							
Brown Shale			3815	3955							
Slate White			3955	4400							
Shale Brown			4400	4475							
Slate & Shells			4475	4640							
Shale Black			4640	4748							
Corniferous Lime			4748	4853							
Oriskany Sand			4853								
TOTAL DEPTH				4866	Gas						
					4856						
					Gas						
					4859						

No 5 Black? - No