

38° 32' 30"

LATITUDE 38° 35'

LONGITUDE 81° 35'
81° 37' 30"

7.5
0615 map
.165
1.54 w

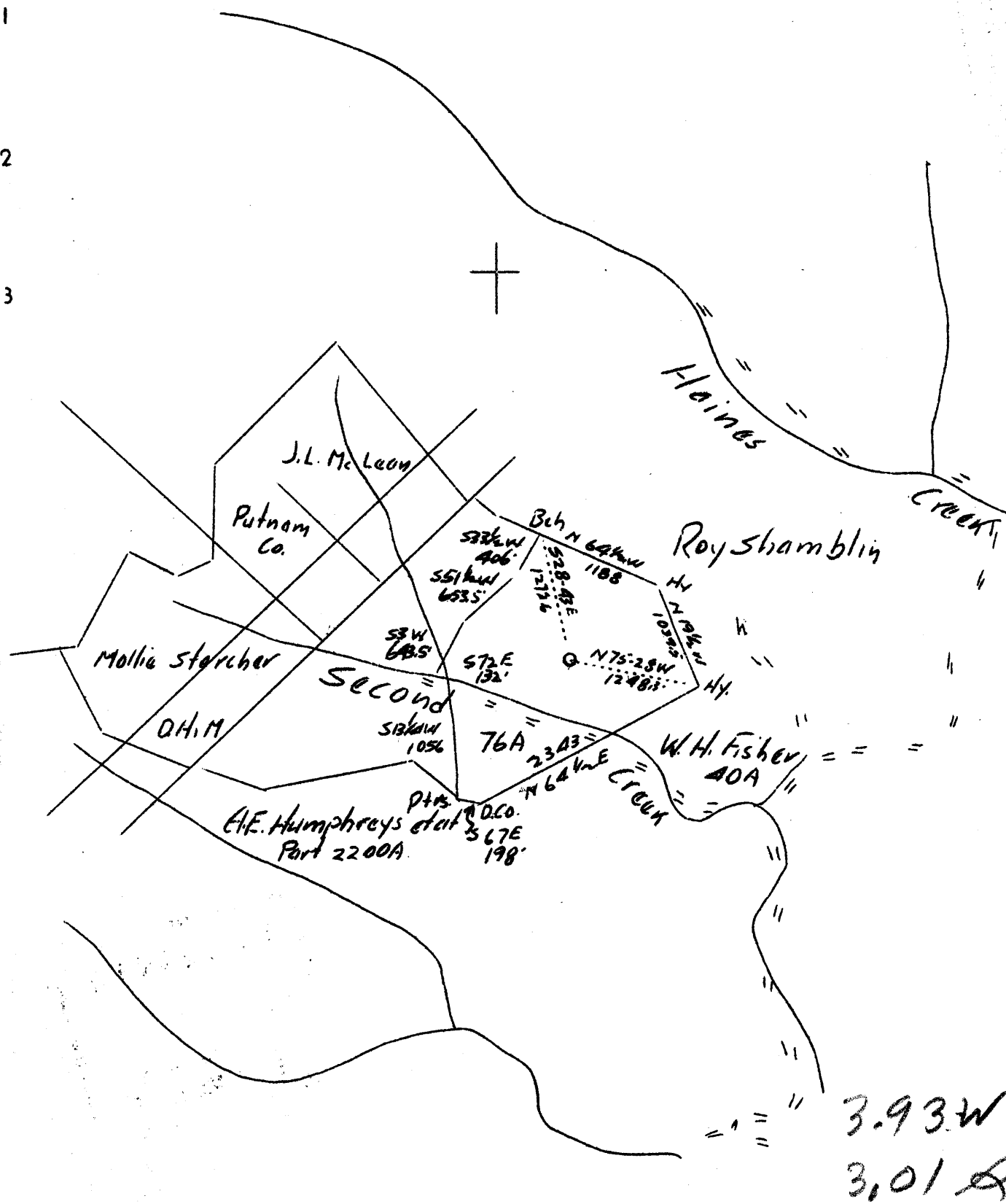

3.93 W
3.01 A

Ground Elev 821.52 (spirit)

Company	Godfrey L. Cabot, Inc.
Address	600 Union Bldg., Charleston, W. Va.
Farm	B.M. Delaney
Tract	Acres 78.75 Lease No. 4-612
Well (Farm) No.	1 Serial No. 913
Quadrangle	Kenna 50
County	Kanawha
District	Poca
Engineer	O.L. Fitz Randolph
Engineer's Registration No.	806
File No.	Drawing No.
Date	July 3, 1937 Scale 1"-1320'

STATE OF WEST VIRGINIA
Department of Mines
OIL AND GAS DIVISION
CHARLESTON

WELL LOCATION MAP

File No. KAN-419

+ Denotes location of well on United States Topographic Maps, scale 1 to 62,500, latitude and longitude lines being represented by border lines as shown.

- Denotes one inch spaces on border line of original tracing.

WEST VIRGINIA DEPARTMENT OF MINES

OIL AND GAS DIVISION

WELL RECORD

Permit No. Kan-419

Gas Well

Kenna Quad.

CASING & TUBING

Company	Godfrey L. Cabot, Inc.	Wood Cond.	14	14
Address		13 3/8	578	578
Farm	B.M. Delaney Acres	10 3/4	1755	1755
Location		8 5/8	2030	2030
Well No.	1 Elev. 821.52	7" O.D.	4949	4949
District	Boca County Kanawha			
Surface		Shut in		
Mineral		11/22/37		
Drilling	Commenced Aug. 24, 1937			
	Completed Nov. 22, 1937			
Date Shot	Not shot	7" O.D. casing cemented		
Volume	7,800,000 Cu. Ft.	in by Halliburton Oil		
Rock Press.	1915# 24 hrs.	Well Cementing Co.		

Formation Color ^{Hor} TOP Base Result					Formation Color ^{Hor} TOP Base Result					
Surface			0	14	Lime	Gray		3692	3717	
Sand	Yellow		14	42	Slate	Blue		3717	4000	
Mud	Blue		42	98	Shale	Brown		4000	4100	
Sand			98	133	Slate	Blue		4100	4600	Water
Slate			133	228	Shale	Brown		4600	4860	1935
Red Rock			228	250	Shale	Black		4860	4917	1945
Slate			250	280	Corniferous Lime			4917	5021	Fill
Red Rock			280	350	Oriskany Sand			5021	5037	hole
Sand			350	370						300'
Red Rock			370	425						
Slate	Blue		425	455						S.L.
Red Rock			455	465						4949
Slate	Blue		465	543						& 5021
Sand			543	564						
Slate			564	577						
Sand			577	630						
Slate			630	645	Show of Gas	4850				Not enough to gauge.
Sand			645	670	Gas	5022	8/10 W. in 2"			
Slate			670	680		5024	12/10 M. in 7" o.D.			
Sand			680	723		5028	15/10 M. " "			
Slate			723	737		5032	18/10 M. " "			
Sand			737	777		5032	15/10 M. in " "			
Slate			777	786		5033	9/10 M. in " "			
Sand			786	791		5037	6/10 M. in " "			
Slate			791	870		5037	5/10 M. in " "			
Sand			870	889						
Slate			889	900						
Sand			900	954						
Slate			954	979						
Slate			979	1020						
Sandy Lime			1020	1040						
Slate & Lime Shells			1040	1303						
Salt Sand			1303	1665						
Slate			1665	1668						
Maxon Sand			1668	1716						
Slate			1716	1718	Water					
Little Lime			1718	1738	1350'					1 bailer pr. hr.
Pencil Cave			1738	1741						
Big Lime			1741	1906	Water					
Injun Sand			1906	1958	1375'					Hole Full
Slate & Shells			1958	2022						
Lime Shell			2022	2060	Water					
Slate & Shell	Blue		2060	2426	1915-					3/4 bailer pr. hr.
Slate & Berca	Shell		2426	2850						
Slate	Blue		2850	3568						
Shale	Brown		3568	3620	Water					
Slate	Blue		3620	3692	1925-					4 bailers pr. hr.

WELL RECORD

CASING & TUBING

INITIAL OPEN FLOW

B. M. Delaney #1, Serial #913
 Pocca District, Kanawha County, W. Va.

Size	Used in	
	Drilling	Well
Wood		
Con.	14'	14'
13-3/8"	578'	578'
10-3/4"	1755'	1755'
8-5/8"	2030'	2030'
7" O.D.	4949'	4949'

18/10ths Hg. in 7" O.D. 26#,
 7,800 M.C.F.
 Not shot

Drilling commenced Aug. 24, 1937
 Drilling completed Nov. 22, 1937

Rock Pressure - 1915# 24 hrs.

Elevation - 821.52

Shut in 11/22/37

Surface	0	14
Yellow Sand	14	42
Blue Mud	42	98
Sand	98	133
Slate	133	228
Red Rock	228	250
Slate	250	280
Red Rock	280	350
Sand	350	370
Red Rock	370	425
Blue Slate	425	455
Red Rock	455	465
Blue Slate	465	543
Sand	543	564
Slate	564	577
Sand	577	630
Slate	630	645
Sand	645	670
Slate	670	680
Sand	680	723
Slate	723	737
Sand	737	777
Slate	777	786
Sand	786	791
Slate	791	870
Sand	870	889
Slate	889	900
Sand	900	954
Slate	954	979
Slate	979	1020
Sandy Lime	1020	1040
Slate & Lime Shells	1040	1303
Salt Sand	1303	1665
Slate	1665	1668
Maxton Sand	1668	1716
Slate	1716	1718
Little Lime	1718	1738
Pencil Cave	1738	1741
Big Lime	1741	1906
Injun Sand	1906	1958
Slate & Shells	1958	2022
Lime Shell	2022	2060
Blue Slate & Shell	2060	2426
Slate & Berea Shell	2426	2850
Blue Slate	2850	3568
Brown Shale	3568	3620
Blue Slate	3620	3692
Gray Lime	3692	3717
Blue Slate	3717	4000
Brown Shale	4000	4100
Blue Slate	4100	4600
Brown Shale	4600	4860
Black Shale	4860	4917
Corniferous Lime	4917	5021
Oriskany Sand	5021	5037

7" O.D. casing cemented in
 by Halliburton Oil Well
 Cementing Co.

4917 5021
 822 822
 4095 4199

Salt Water	1350'
" "	1375'
Salt Water	1915'
" "	1925'
" "	1935-45'

1 bailer per hr.
 Hole full

3/4 bailer per hr.
 4 bailers per hr.
 Filled hole 300 feet

5021 4949 SLM	
" Show of gas	4850'
Gas	5022'
"	5024'
"	5028'
"	5032'
"	5032'
"	5033'
"	5037'
"	5037'

Not enough to gauge
 8/10 water in 2"
 12/10 Hg. in 7" O.D.
 15/10 " "
 18/10 " "
 16/10 " "
 9/10 " "
 6/10 " "
 5/10 " "