

LATITUDE 38° 35'

LONGITUDE 81° 35'

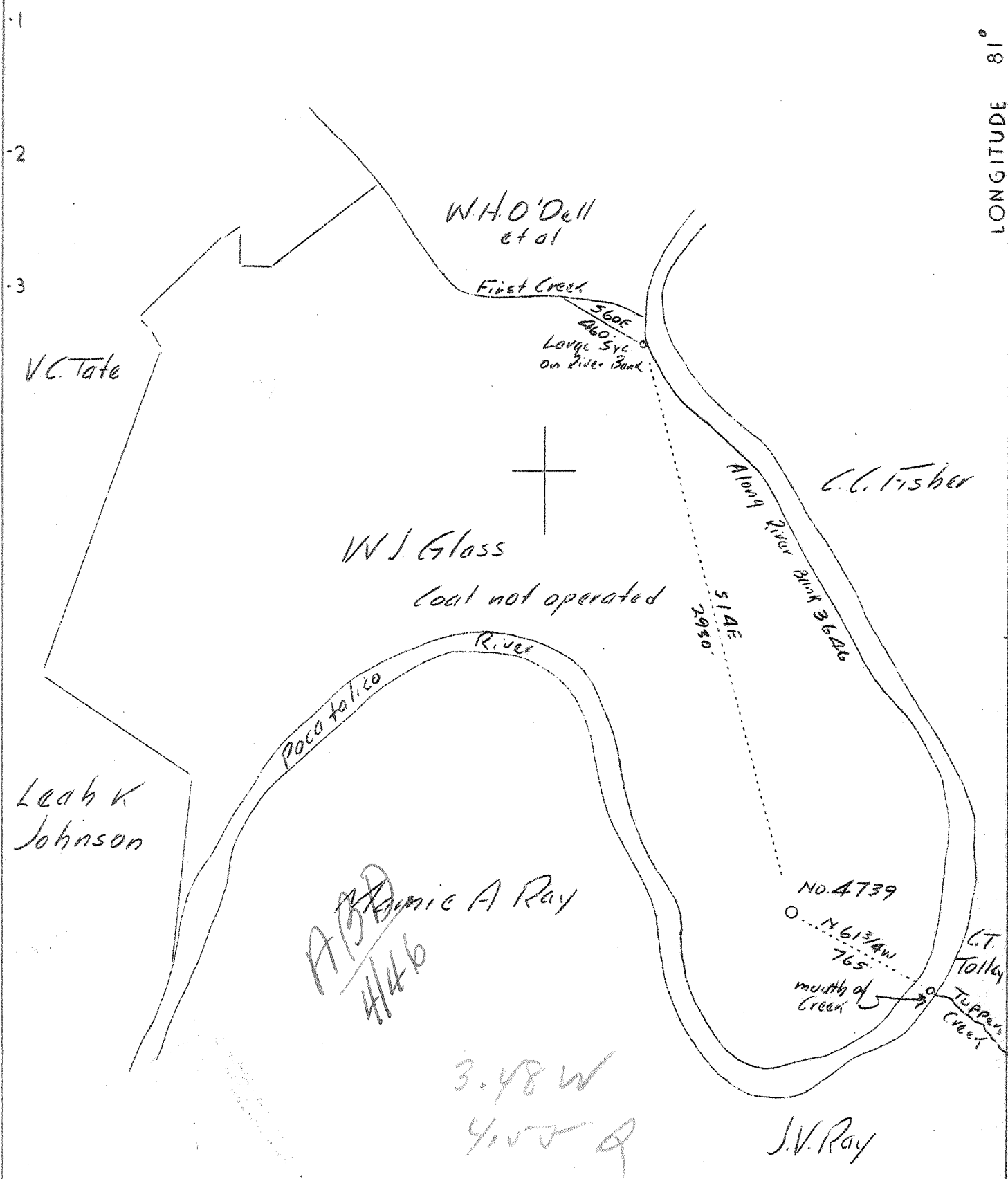

Company	United Fuel Gas Co.
Address	Charleston, W. Va.
Farm	W. J. Glass
Tract	Acres 216 Lease No. 40270
Well (Farm) No.	1 Serial No. 4739
Elevation (Spirit Level)	
Quadrangle	Kenna <span style="border: 1px solid black; border-radius: 50%; padding: 2px;">52</span>
County	Kanawha District Poca
Engineer	G. A. Cunningham
Engineer's Registration No.	659
File No.	60-69-71 Drawing No.
Date	Aug. 13, 1937 Scale 1"=660'

STATE OF WEST VIRGINIA  
Department of Mines  
OIL AND GAS DIVISION  
CHARLESTON

WELL LOCATION MAP  
File No. KAN-446

+ Denotes location of well on United States Topographic Maps, scale 1 to 62,500, latitude and longitude lines being represented by border lines as shown.

— Denotes one inch spaces on border line of original tracing.

Deer

WEST VIRGINIA DEPARTMENT OF MINES

OIL & GAS DIVISION

WELL RECORD

Permit No. Kan-446

Gas Well

Kenna Quad.

CASING & TUBING

Company	United Fuel Gas Co.	18	47	47
Address	Charleston, W. Va.	14	353	353
Farm	W. J. Glass - Acres 216	10	1077	1077
Location	Poca River	8-1/4	1702	1702
Well No.	4739 - Elev. 626.43	7	4651	4651
District	Poca - County Kanawha	2		4756
Surface & Mineral Address	W. J. Glass, Sissonville, W. Va.			
Drilling Commenced	Sept. 8, 1937			
Drilling Completed	Jan. 3, 1938			COAL AT; 297' - 36 inches.
Date Shot	Not shot			
Open Flow	24/10ths Merc. in 7"			
Volume	8,622,000 c.f.			
Rock Pressure	1525 lbs. 48 hrs.			
Fresh Water	100 to 353 feet			
Salt Water	1028			

Formation Color <sup>Har</sup> 5 Top Base Result Formation Color <sup>Har</sup> 5 Top Base Result

Formation	Color	Har	5	Top	Base	Result	Formation	Color	Har	5	Top	Base	Result
Surface				0	30								
Sand Cave				30	40								
Slate				40	47								
Red Rock				47	110								
Slate				110	200		Hole full of water from 100' to 353'						
Red Rock				200	250								
Slate				250	260								
Sand				260	297								
Coal (Blossom)				297	300								
Slate				300	345								
Sand				345	350								
Slate & Shells				350	490								
Slate				490	525								
Lime (Hard)				525	540								
Sand				540	602								
Slate & Shells				602	885								
Lime (Hard)				885	970								
Salt Sand				970	1420		Hole full of water at 1028'						
Lime Shells				1420	1432								
Little Lime				1432	1457								
Pencil Cave				1457	1460								
Big Lime				1460	1640								
Injun Sand				1640	1680		8 5/8" casing at 1702'						
Slate				1680	1696								
Lime Shell				1696	1710								
Wear Shells				1710	1920								
Slate & Shells				1920	2072								
Brown Shale				2072	2080								
Ferea Shell				2080	2093								
Slate & Shells				2093	2195								
Lime				2195	2220		Hard						
Slate & Shells				2220	2470								
Sand				2470	2482		Hard						
Slate & Shells				2482	3271								
Brown Shale				3271	3349								
Slate & Shells				3349	3700		Hard						
Brown Shale				3700	3795								
White Slate				3795	4305								
Brown Shale				4305	4580								
Black Slate				4580	4637								
Corniferous Lime				4637	4739		7" O.D. Casing at 4651'						
Oriskany Sand				4739									
Total Depth				4748			Gas at 4742' to 4747'						