

LATITUDE 38° 35'

LONGITUDE 81° 35'

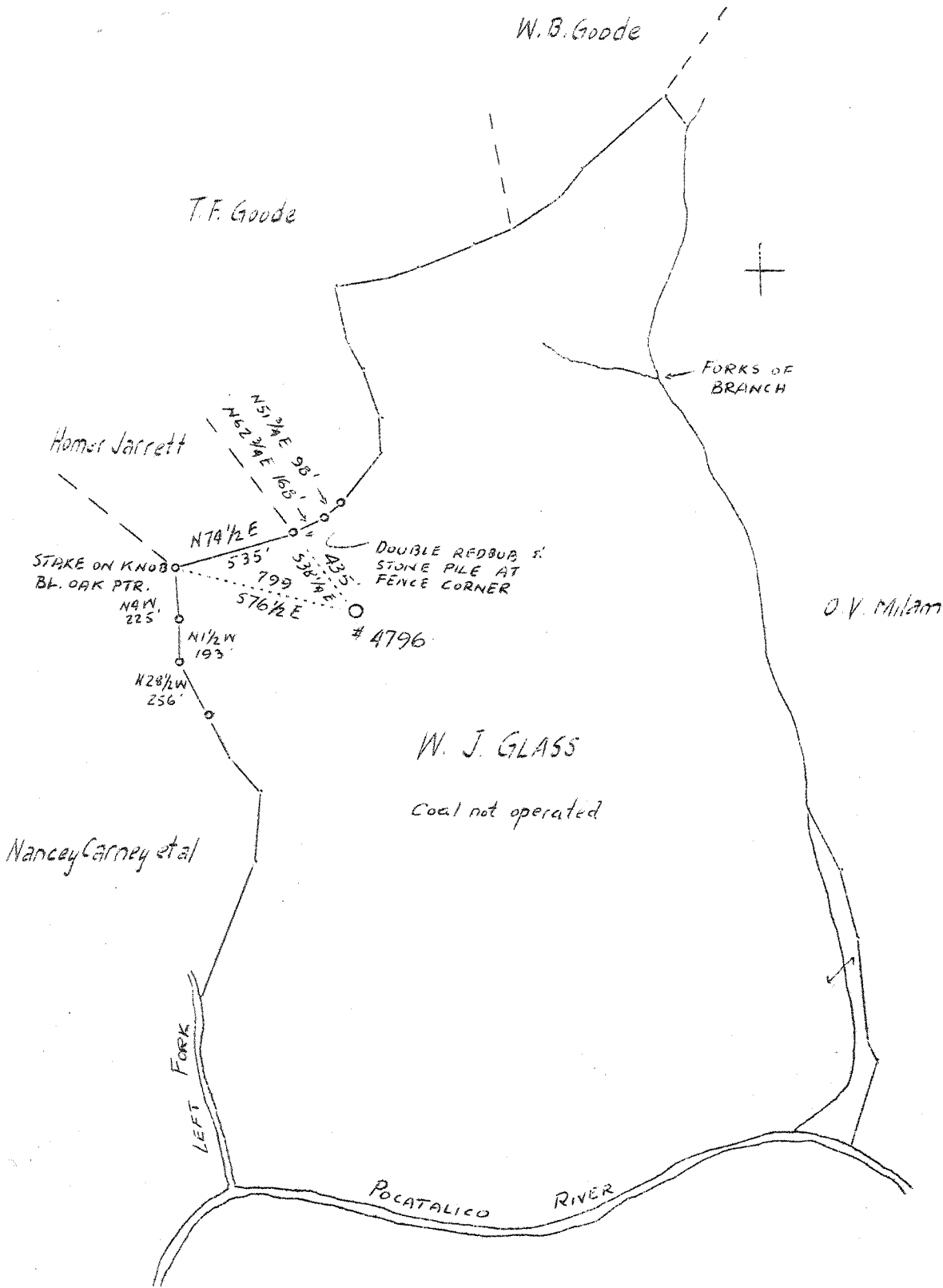

NEW LOCATION - REVISED

Company	United Fuel Gas Co.
Address	Charleston, W. Va.
Farm	W. J. Glass
Acres	205
Lease No.	40266
Well (Farm) No.	One
Serial No.	4796
Elevation (SP)	945.0 Ground
Quadrangle	Kenna 98
County	Kanawha
District	Poca
Engineer	G. A. Cunningham
Eng. Reg. No.	659
File No.	62 - 73
Date	August 24, 1938
Scale	1" = 660'

STATE OF WEST VIRGINIA
 Department of Mines
 OIL & GAS DIVISION
 Charleston

WELL LOCATION MAP

File No. KAN-527

x Denotes location of well on U. S. Topographic Maps, scale 1 to 62,500, latitude and longitude lines being represented by border lines as shown.

- Denotes one inch spaces on border line of original tracing.

2,46 W
 2,44 S

WEST VIRGINIA DEPARTMENT OF MINES

OIL & GAS DIVISION

WELL RECORD

Permit No. Kan-527

Gas Well

Kenna Road,

CASING & TUBING

Company	United Fuel Gas Co.	13	16	16
Address	Charleston, W. Va.	10	836	836
Farm	W. J. Glass ACRES 205	8-5/8	2069	2069
Location	Left Fork of Poca River	7	5076	5076
Well No.	4796 ELEV. 950.13			
District	Poca - Kanawha County			
Surface & Mineral	W. J. Glass, Sissonville, W.Va.			
Drilling commenced	Sept. 24, 1938			
Drilling completed	Dec. 22, 1938			
Shot	Not shot			
Open Flow	82/10ths Merc. in 7 inch			
Volume	14,140,000 c.f.			
Rock pressure	1410 lbs. 48 hrs.			
Salt Water	1475			

Formation Color ^{ft} TOP Base Result Formation Color ^{ft} TOP Base Result

Red Rock		225	225						
Slate&Shells		225	425						
Sand		425	456						
Red Rock		456	465						
White Slate		465	490						
Red Rock		490	550						
Slate&Shells		550	650						
Red Rock		650	770						
Slate		770	785						
Sand		785	850						
Slate		850	856						
Sand		856	925						
Slate		925	935						
Sand		935	965						
Slate		965	992						
Black slate		992	1002						
Sand		1002	1073						
Slate		1073	1144						
Sand		1144	1194						
Slate		1194	1240						
Sand		1240	1260						
Slate		1260	1354						
Salt sand		1354	1810						
Slate		1810	1815						
Little Lime		1815	1840						
Slate		1840	1845						
Big Lime		1845	1995						
Injun		1995	2055						
Slate&Shells		2055	2520						
Berea		2520	2530						
Slat&shells		2530	3680						
Brown shale		3680	3740						
Slat&shells		3740	3930						
Brown shale		3930	4032						
White slate		4032	4050						
Brown shale		4050	4271						
White slate		4271	4707						
Brown shale		4707	5055						
Corniferous Lime		5055	5171						
Oriskany sand		5171	5192						
TOTAL DEPTH			5192						