

LATITUDE 38° 35'

LONGITUDE 81° 30'

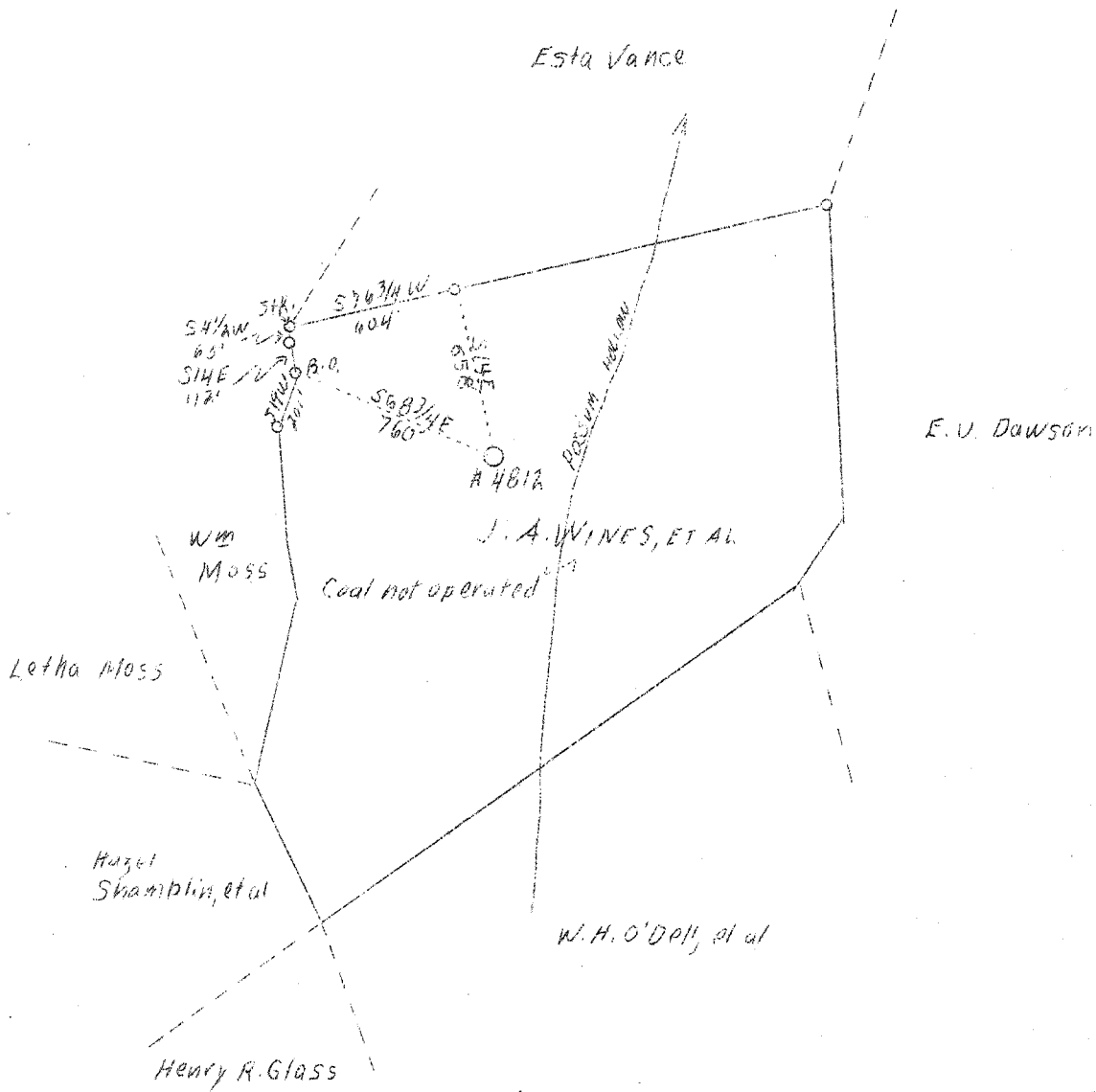

REVISED LOCATION

~~32 W~~
~~283 S~~

ABD
6/50

Company	United Fuel Gas Co.
Address	Charleston, W. Va.
Farm	J. A. Wines, et al
Acres	3/4 78
Lease No.	40298
Well (Farm) No.	One
Serial No.	4812
Elevation (SP)	-
Quadrangle	Kenna <i>S.C.</i>
County	Kanawha
District	Poca
Engineer	G. A. Cunningham
Eng. Reg. No.	659
File No.	64 - 71
Date	Oct. 25, 1938
Scale	1" - 660'

STATE OF WEST VIRGINIA
 Department of Mines
 OIL & GAS DIVISION
 Charleston

WELL LOCATION MAP

File No. Kan-574-D

x Denotes location of well on U. S. Topographic Maps, scale 1 to 62,500, latitude and longitude lines being represented by border lines as shown.

- Denotes one inch spaces on border line of original tracing.

Deep

✓

WEST VIRGINIA DEPARTMENT OF MINES

OIL & GAS DIVISION

WELL RECORD

Permit No. Kan-574-R

Gas Well

Kenna Quad.

CASING & TUBING

Company	United Fuel Gas Co.	13	15	15
Address	Box 1256, Charleston, W. Va.	10	429	429
Farm	J. A. Wines, et al ACRES 78.1	8-5/8	1777	1777
Location	Possum Hollow - Peca River	7	4853	4853
Well No.	4812 ALEV. 797.7			
District	Poca - Kanawha County			
Surface & Mineral	J. A. Wines, et al			
Address	406 Reynolds, St., Charleston, W.Va.			
Drilling commenced	Nov. 25, 1938			
Drilling completed	Feb. 27, 1939			
Open Flow	56/10ths Merc. in 7 inch			
Volume	11,681,000 c.f.			
Rock pressure	1210 lbs. 48 hrs.			
Salt Water	1186 and 1293			

Formation	Color	Hor	Top	Base	Result	Formation	Color	Hor	Top	Base	Result
Soil			0	15		Brown Shale	-441		3400	3444	
Sand			15	19		Slate&Shells			3444	3847	
Blue Mud			19	39		Brown Shale			3847	3988	
Sand			39	90		White Slate			3988	4505	
Blue Mud			90	105		Brown Shale			4505	4740	
Red Rock			105	118		White Slate			4740	4767	
Blue Mud			118	137		Brown Shale			4767	4802	
Red Rock			137	233		Black Shale	-Macedonia		4802	4838	
Black Slate			233	245		Coniferous			4838	4952	
Red Rock			245	265		Criskany			4952	4975	G 4958-
Sand			265	290							4975
Blue Mud			290	310		Total Depth					4975
Red Rock			310	325							
Brown Sand			325	340							
Red Rock			340	355							
Blue Mud			355	385							
Red Rock			385	402							
Blue Mud			402	428							
Slate&Shells			428	436							
Red Rock			436	440							
Slate&Shells			440	480							
White Sand			480	538							
Slate			538	544							
Sand			544	652							
Slate			652	666							
Sand			666	675							
Slate			675	699							
White Sand			699	760							
Slate&Shells			760	810							
Sand			810	895							
Slate			895	908							
Lime			908	941							
Slate&Shells			941	1020							
Broken Sand			1020	1060							
Sand			1060	1095							
Broken Lime			1095	1144							
Salt Sand			1144	1486	Water 1186-1203 Hole full						
Slate			1486	1488							
Sand			1488	1644							
Big Lime			1644	1721							
Injun Sand			1721	1765							
Slate			1765	1775							
Lime			1775	1780							
Slate & Shells			1780	2164							
Brown Shale	-Coffee Sh.		2164	2170							
Berea Sand			2170	2177							
Slate&Lime Shells			2177	3400							

WEST VIRGINIA DEPARTMENT OF MINES
OIL & GAS DIVISION
W E L L R E C O R D

Permit No. Kan-574-D
Kenna Quad.

Gas Well

Company United Fuel Gas Company
Address Box 1256, Charleston, W. Va.
Farm J. A. Wines, et al ACRES 3/4 of 78
Location Possum Hollow of Poca River
Well No. 4812 ELEV. 797.7
District Poca - Kanawha County
Surface & Mineral J. A. Wines, et al
Address -
Commenced Oct. 6, 1940
Completed Oct. 21, 1940
Shot Not shot
Open Flow -
Volume Gas Well
Rock Pressure -
Water -

CASING & TUBING
No change in casing

DEEPENING RECORD

Original Depth 4975
✓Oriskany Sand 4952 4993
New Total Depth 4993 Gas 4981-4987

475