

38° 32' 30"

LATITUDE 38° 35'

LONGITUDE 81° 35'

81° 37' 30"

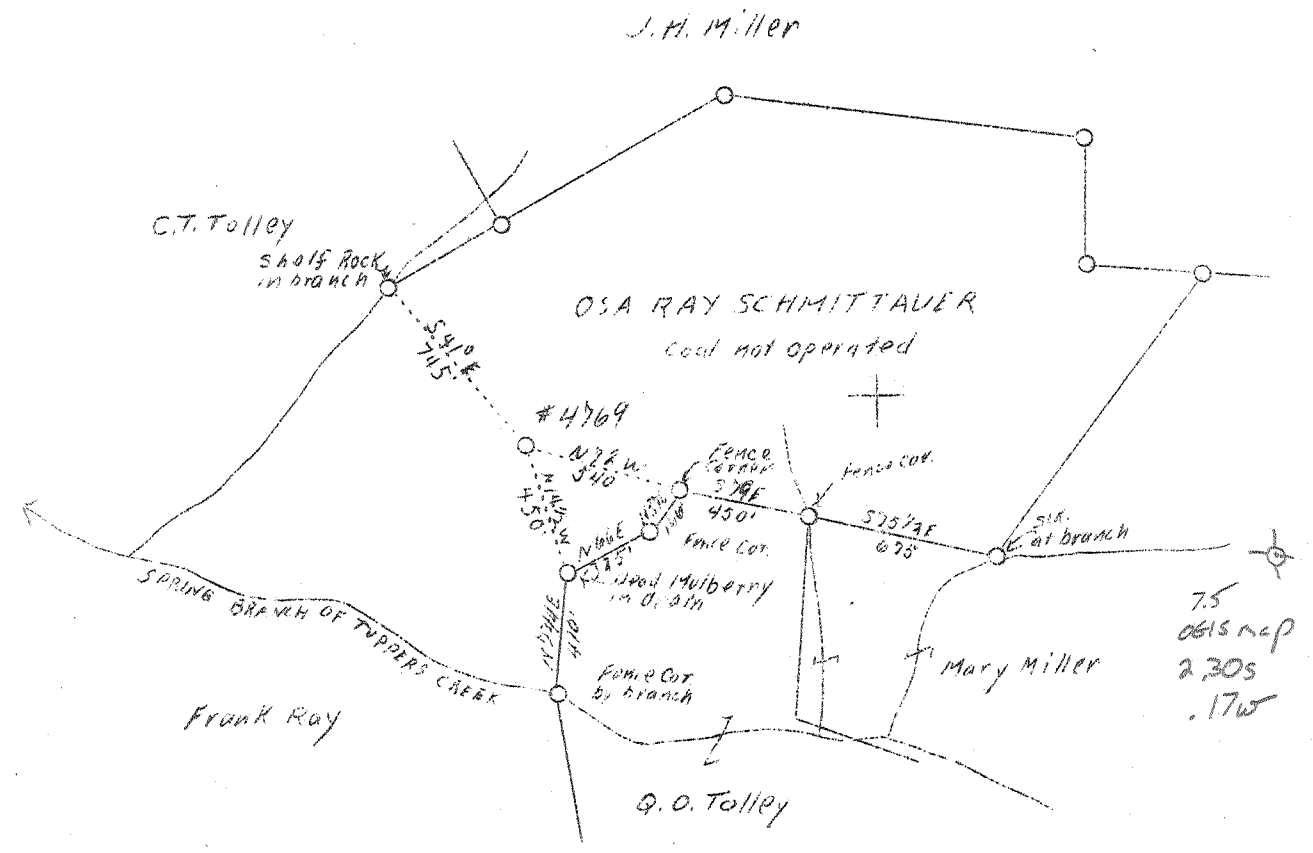

ABD
7/46

2.5 W
5.245

New Location

Company	United Fuel Gas Co.	STATE OF WEST VIRGINIA
Address	Charleston, W. Va.	Department of Mines
Farm	Osa Ray Schmittauer	OIL & GAS DIVISION
Acres	One	Charleston
Lease No.	42407	WELL LOCATION MAP
Well (Farm) No.	One	File No. <u>Kan. 595</u>
Serial No.	4769	
Elevation (SP)	-	
Quadrangle	Kenna SC	
County	Kanawha	
District	Poca	
Engineer	G. A. Cunningham	
Eng. Reg. No.	659	
File No.	60-62-69	
Date	Nov. 9, 1938	
Scale	1" = 660'	

x Denotes location of well on U. S. Topographic Maps, scale 1 to 62,500, latitude and longitude lines being represented by border lines as shown.

- Denotes one inch spaces on border line of original tracing.

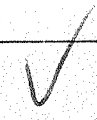

WEST VIRGINIA DEPARTMENT OF MINES

OIL & GAS DIVISION

WELL RECORD

Permit No. Kan-595

Gas Well

Kenna Quad.

CASING & TUBING

Company	United Fuel Gas Co.	13	14	14
Address	Charleston, W. Va.	10-5/8	674	674
Farm	Osa Ray Schmittauer ACRES 92	8-5/8	3003	3003
Location	Spring Branch of Tappers Ck.	7	5012	5012
Well No.	4769 ELEV. 1617.4			
District	Poca - Kanawha County	Coal Encountered:		
Surface & Mineral Address	O. R. Schmittauer, et al Charleston, W. Va.	835'	24"	
Drilling commenced	Feb. 2, 1939			
Drilling completed	May 13, 1939			
Open Flow	- 6048 Mcf - vol XVI			
Volume	-			
Rock Pressure	-			
Oil	-			
Fresh Water	-			
Salt Water	1380			

Formation Color ^{Har} TOP Base Result					Formation Color ^{Har} TOP Base Result				
Sand		0	20		Coffee Shale		2375	2385	
Red Rock		20	30		Berea Shells		2385	2393	
Sand		30	75		Slate & Shells		2393	2550	
Slate		75	150		White Slate		2550	3100	
Sand		150	205		Slate & Shells		3100	3615	
Slate		205	220		Brown Shale		3615	3643	
Sand		220	235		Slate & Shells		3643	3900	
Red Rock		235	310		Brown Shale		3900	4030	
Slate		310	350		White Slate		4030	4040	
Red Rock		350	440		Brown Shale		4040	4215	
Slate & Shells		440	510		White Slate		4215	4665	
Red Rock		510	545		Brown Shale		4665	4830	
Sand		545	639		White Slate		4830	4915	
Slate		639	650		Brown Shale		4915	4938	
Sand		650	687		Black Shale		4938	4997	
Slate & Shells		687	740		Corniferous Lime		4997	5105	Sh Gas
Sand		740	754						5108
White Slate		754	800		Oriskany Sand		5105	5145	Gas 5108-
Dark Lime		800	835						5118
Coal		835	837		Total Depth		5145		Gas 5123-
Slate		837	840						5128
Sand		840	890						
Slate		890	905						
Sand		905	940						
Slate & Shells		940	995						
Sand		995	1040						
Slate		1040	1244						
Sand		1244	1283						
Slate		1283	1310	HFW 1380					
Salt Sand		1310	1655	Sh. gas 1345, 2390					
Slate		1655	1660						
Maxon Sand		1660	1737						
Slate		1737	1740						
Little Lime		1740	1758						
Slate		1758	1760						
Lime Shells		1760	1763						
Pencil Cave		1763	1766						
Lime		1766	1773						
Slate		1773	1778						
Big Lime		1778	1925						
Keener Sand		1925	1931						
Injun Sand		1931	1958						
Slate		1958	1961						
Sand		1961	1991						
Slate		1991	2002						
Lime		2002	2010						
Slate & Shells		2010	2375						