

LATITUDE 38° 20'

LONGITUDE 81° 35'

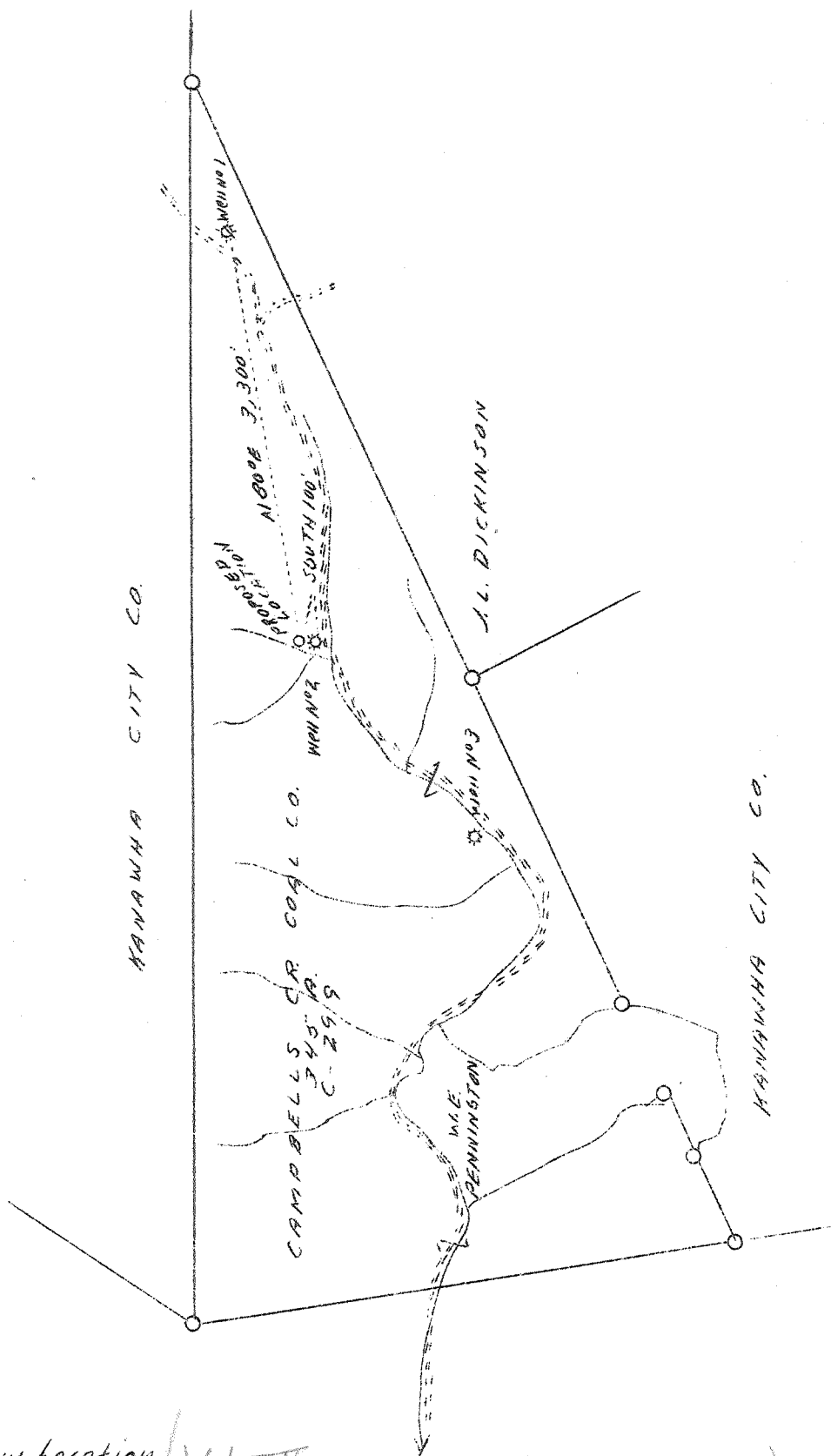

ABD
7/51

2.63 S.
0.99 W.

EC (J-5)

New location Vol. XVI, p. 348, and Vol. XII, p. 339

Company	Columbian Carbon Co.
Address	Box 1240, Charleston, W. Va.
Farm	Campbells Cr. Coal Co.
Acres	345
Lease No.	C-299
Well (Farm) No.	4
Elevation (SL)	984.0
Quadrangle	SC Charleston - S. E.
County	Kanawha
District	Loudon
Engineer	James N. Sell
Eng. Reg. No.	772
Date	Sept. 1, 1939
Scale	1" = 1320'

STATE OF WEST VIRGINIA
 Department of Mines
 OIL & GAS DIVISION
 Charleston

WELL LOCATION MAP

File No. KON-662

Plugged 07/18/1951

x Denotes location of well on U. S. Topographic Maps, scale 1 to 62,500, latitude and longitude lines being represented by border lines as shown.

INDIAN CREEK (358)

- Denotes one inch spaces on border line of original tracing.

3-3 deepening

Samples 27-K

(1415-6339)

6-6 238 - Deep Well

WEST VIRGINIA DEPARTMENT OF MINES
OIL & GAS DIVISION
W E L L R E C O R D

Permit No. Kan-662
Charleston Quad.

Gas Well

		CASING & TUBING	
Company	Columbian Carbon Co.	14	29
Address	Box 1240, Charleston, W. Va.	10-3/4	353-6
Farm	Cambolls Ck. Coal Co. ACRES 345	8-5/8	1470-6
Location	Cane Fork of Davis Creek	7	4768-6
Well No.	4 (GW-436) ELEV. 983.9 DF	2-3/8	4882-11
District	Loudon - Kanawha County	5	68-10
Surface & Mineral	Cambell Ck. Coal Co., Road, W. Va.		68-10
Commenced	Sept. 24, 1939	No Packer	
Completed	Dec. 30, 1939		
Shot	12/31/39 - Depth 4820-4833	COAL AT:	
Volume	73,000 c.f.	65'	36"
Rock Pressure	350 lbs. 8 hrs.	605	60
Oil	005' Show	963	60
Fresh Water	50-55 HF: 100, 1-13" blr. hr.		
Salt Water	Hole Full 700'		

Formation	TOP	Base		Formation	TOP	Base	
Clay	0	5		Black Lime	1380	1400	
Sand	5	20		Pencil Slate	1400	1422	
Gravel	20	25		Black Lime	1422	1439	SLM
Sand	25	66	HFV 55	Big Lime	1439	1610	Gas sh.
Coal	66	69		Injun Sand	1610	1643	1475
Slate	69	75		Slate	1643	1665	
Sand	75	95		White Lime	1665	1725	
Slate	95	210	W 100	Slate&Shells	1725	2040	
Sand	210	240	1-13	Brown Shale	2040	2050	
Slate	240	290	blr.	Berea Sand	2050	2060	
Sand	290	300	pr. hr.	Slate&Shells	2060	2560	
Black Slate	300	350		Gritty Lime	2560	2590	
Black Lime	350	370		Dark Lime	2590	2630	
Slate	370	380		Gritty Lime	2630	2720	
Lime	380	388		Slate&Shells	2720	2820	
Slate	388	406		Shale	2820	2880	
Sand	406	455		Slate&Shells	2880	3290	
Slate	455	470		Shale	3290	3450	
Sand	470	530		Black Lime	3450	3460	
Black Slate	530	550		White Lime	3460	3560	
Lime	550	552		Brown Shale	3560	3590	
Sand	552	605		White Shale	3590	3620	
Coal	605	610		Gray Lime	3620	3630	
Slate	610	625		Brown Shale	3630	3840	
Sand - Salt Sand	625	963	HFV 700	White Shale	3840	4350	
Coal	963	968	Oil SH.	Dark Slate	4350	4620	
Lime	968	975	805	White Slate	4620	4650	
Sand	975	990	Gas SH.	White Shale	4650	4670	
Slate	990	993	805	Black Shale - 455	4670	4723	SLM
Sand	993	998		Corniferous Lime	4723	4820	SLM
Slate	998	1009		Criskany Sand	4820	4848	
Lime	1009	1077		Lime - held	4848	4872	SLM
Sand	1077	1102		Total Depth		4872	SLM
Red Rock	1102	1108		*For Sample examination			
Slate	1108	1132		Pay: 4820 1/2 - 21; 4827 - 29			
Sand	1132	1233					
Slate	1233	1241		CEMENT RECORD: Cemented 8-5/8 Casing. Ran			
Lime	1241	1245		113 sacks Alpha Cement mixed with 2"			
White Slate	1245	1270		Aquadel. Ran 2 sacks Aquadel ahead of			
Lime	1270	1280		cement. 1 Sack mixed with cement. 23'			
Slate	1280	1285		solid cement in hole. Dick Allen,			
Red Rock	1285	1295		Cementer - Halliburton Oil Well Cement-			
Lime	1295	1305		ing Company (10/23/39.			
Slate	1305	1310		12/11/39 - Cemented 7" Casing. Ran 25			
Lime	1310	1330		sacks Alpha Cement. Ran 7 bbl. water on			
Maxton Sand	1330	1380		top of Cement in hole after starting up.			
				last 12' hard. Jack Hughes, Cementor.			

Top.	Bottom.	Thickness.	
1808	1812	4	No sample
1812	1816	4	Sandstone, white, fine
1816	1834	18	Sandstone, nearly white, very fine, 80%; gray shale, 20%
1834	1838	4	Sandstone, white, fine
	1951		Total depth

Campbell Creek Coal Company No. 4 (GW-436) Well.

Loudon District, Kanawha County, W. Va.

By Columbian Carbon Company, Box 1240, Charleston, W. Va.

Located 0.98 mi. W. of 81° 35' and 2.64 mi. S. of 38° 20'—SC—Charleston Quadrangle; on N. side of Cane Fork of Davis Creek, at mouth of northern branch, just north of well No. 1.

Elevation, 983.9' L. (derrick floor).

Permit Kan-662.

Drilling commenced Sept. 24, 1939; completed (to 4872') Dec. 30, 1939; completed deepening August 5, 1940.

14" casing, 29' (19' 2" left in); 10¾", 353' 6" (109' 8" left in); 8¾", 1470' 6" (1461' 2" left in); 7", 4768' 6"; 5½", 5620'; 2¾" tubing, 6379'; 3", 558' 11" (casing point, 6347').

Gas shows: pocket of "sweet" gas at 5273', 5/10 W. 2"; gas at 5391' SLM, 18/10 W. 2" with 381 grains of H₂S per 100 cu. ft.; "sweet" gas at 5739' SLM, 6/10 W. in 2"; 1st pay in "Clinton Sand", 6256-6260½'; 2nd pay, 6318-6320'; highest gauge before shot, 327,000 cu. ft.; gauge immediately before shot, 169,000 cu. ft.

Shot August 9, 1940, from 6256 to 6331' with 98 quarts nitroglycerine; open flow, 733,000 cu. ft. after blowing open 18 days; initial rock pressure, 1800 lbs.

Samples from 1415 to 6339', examined by J. H. C. Martens.

Pottsville and Mauch Chunk Formations, 1422 feet

Top.	Bottom.	Thickness.	
0	5	5	Clay
5	20	15	Sand
20	25	5	Gravel
25	66	41	Sand (hole full water, 55')
66	69	3	Coal
69	75	6	Slate
75	95	20	Sand
95	210	115	Slate (water, 100', 1 13" bailer per hour)
210	240	30	Sand
240	290	50	Slate
290	300	10	Sand
300	350	50	Black slate
350	370	20	Black lime
370	380	10	Slate
380	388	8	Lime
388	406	18	Slate
406	455	49	Sand
455	470	15	Slate
470	530	60	Sand
530	550	20	Black slate

STATE OF WEST VIRGINIA
DEPARTMENT OF MINES
OIL AND GAS DIVISION

860

WELL RECORD

Permit No. Kan-662-D

Oil or Gas Well GAS
(Kind)

Company COLUMBIAN CARBON CO.
Address Box 1240, Charleston, W. Va.
Farm Campbells Creek Coal Co. Acres 345
Location (waters) Cane Fork of Davis Creek
Well No. 4 (GW-436) Elev. 983.90F
District Loudon County Kanawha

The surface of tract is owned in fee by Campbell Creek Coal Co. Address Reed, W. Va.

Mineral rights are owned by "SAME" Address

Drilling commenced 3/23/40
Drilling completed 8/5/40

Date shot 8/9/40 Depth of shot 6256-6331 SLM

Open Flow /10ths Water in Inch
/10ths Merc. in Inch

Volume 733M Cu. Ft.

Rock Pressure 1800 lbs. 11 Days

Oil bbls., 1st 24 hrs.

Fresh water feet

Salt water 5391' Hole feet

Casing and Tubing	Used in Drilling	Left in Well	Packers
Size			
16.			Kind of Packer
13.			No Packer
10.			Size of
8 1/2			Depth set
6 1/2			
5 1/2	5620'9"	5620'9"	
3.			Perf. top
2 - 3/8"	6379'	6379'	Perf. bottom
			Perf. top
3" 8.77	558'11"	558'11"	Perf. bottom

CASING CEMENTED. SIZE No. Ft. Date
See Reverse Side
COAL WAS ENCOUNTERED AT FEET INCHES
FEET INCHES FEET INCHES
FEET INCHES FEET INCHES

Formation	Color	Hard or Soft	Top	Bottom	Oil, Gas or Water	Depth Found	Remarks
Oriskany Sand			4820 1/2	4848			
Lime			4848	4872 SLM			
OLD TOTAL DEPTH				4872 SLM			
<u>DEEPENING RECORD</u>							
Dark Lime			4872 SLM	4915			
Light Lime			4915	4950			
Dark Lime			4950	5035			
Gray Lime			5035	5051			
Dark Lime			5051	5253			
Gray Lime			5253	5273	Gas	5273	Pocket (sweet)
Dark Lime			5273	5290			
Gray Lime			5290	5312			
Dark Lime			5312	5372	Gas & Water	5386 DLM =	H2S Gas, Water
Brown Lime			5372	5444		5391 SLM	filled 4000'
Gray Lime			5444	5535			
Newburg Sand			5535	5559			
Dark Gray Sand			5559	5561			
Newburg Sand - White			5561	5566		5535	5535
Dark Gray Lime			5566	5572		984	4821
White Sand			5572	5576		4551	714
Dark Gray Lime			5576	5591			
Sandy Lime - Broken			5591	5598			
Brown & Dark Gray Lime			5598	5601			
Dark Gray Lime			5601	5623			
Dark Lime			5623	5634			
Gray Lime			5634	5687			
Gritty Lime			5687	5761	Gas	5739 SLM	Show (Sweet)
Dark Gray Sand			5761	5778			
White Sand			5778	5786			
Dark Gray Sand			5786	5800			
Light Shale			5800	5812			
Pink Shale			5812	5863			
Red Slate			5863	5916			
Blue Shale			5916	6023			
Pink Sand			6023	6029			
Red Sand			6029	6041			
Red Slate			6041	6100			
Gritty Gray Shale			6100	6145			
Red Shale			6145	6148			

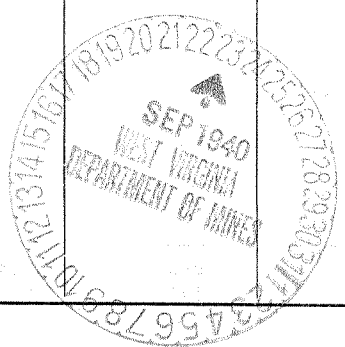

(Over)

NOV 19 1940

Formation	Color	Hard or Soft	Top	Bottom	Oil, Gas or Water	Depth Found	Remarks
Gray Shells			6148	6204			
Clinton Sand			6204	6245			
Slate Break	Tuscarora		6245	6255 SLM			
Clinton Sand			6255 SLM	6272			
Slate			6272	6318			
Sand			6318	6325			
Red Medina	JUNT		6325	6347 SLM	PAY:	6256SLM-6260 $\frac{1}{2}$ 6318-6320	
TOTAL DEPTH				6347 SLM			

6325
984
5341

CEMENT RECORD: 5/22/40 Cemented 5-1/2" Casing.
Ran 7 sacks Alpha Cement with
dump bailer. 40' Solid Cement.
Pipe cemented 27" off bottom or
off casing point.
R. B. Anderson, Cementer -
Columbian Carbon Company.

Vol XVI p. 348
Tested 733 MCFGPD from Tuscarora.

6256
764
5292

6318
984
5334

Date..... September 19, 1940

APPROVED..... COLUMBIAN CARBON COMPANY, Owner

By *O. W. Van Petten* (Title) Supt.