

38° 32' 30"

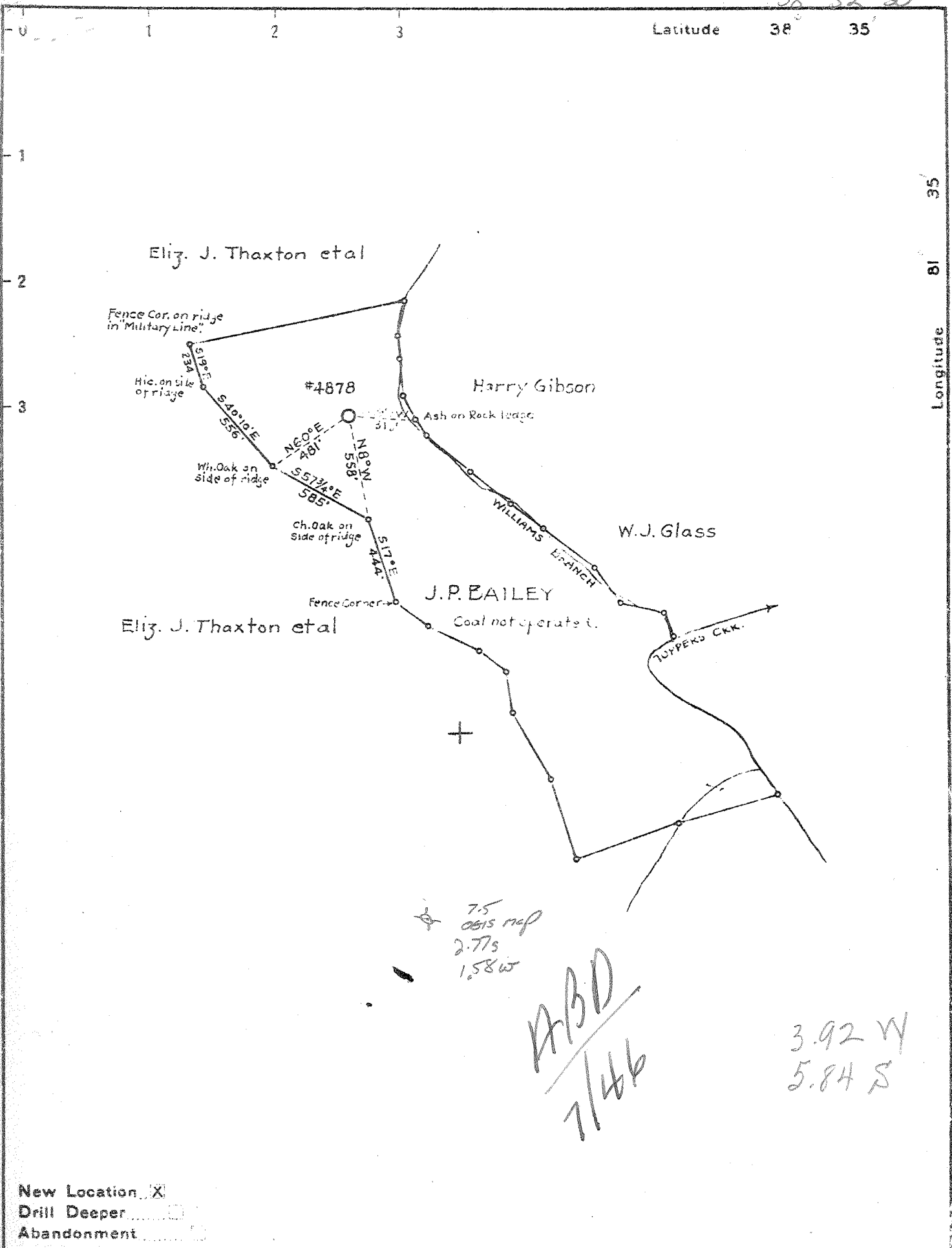

New Location    
 Drill Deeper    
 Abandonment

Company UNITED FUEL GAS CO.   
 Address CHARLESTON, W.VA.   
 Farm J. P. BAILEY   
 Tract          Acres 63 Lease No. 42671   
 Well (Farm) No. 1 Serial No. 4878   
 Elevation (Spirit Level)            
 Quadrangle KENNA *S. Sissonville*   
 County KANAWHA District POCA   
 Engineer            
 Engineer's Registration No. 659   
 File No. 60-69 Drawing No.            
 Date FEB 23, 1946 Scale " = 660'

STATE OF WEST VIRGINIA   
 DEPARTMENT OF MINES   
 OIL AND GAS DIVISION   
 CHARLESTON

**WELL LOCATION MAP**   
 FILE NO. KAN-687

+ Denotes location of well on United States Topographic Maps, scale 1 to 62,500, latitude and longitude lines being represented by border lines as shown.   
 - Denotes one inch spaces on border line of original tracing.

6-6-1946

WEST VIRGINIA DEPARTMENT OF MINES  
OIL & GAS DIVISION  
W E L L R E C O R D

Permit No. Kan-687  
Kenna Quad.

Gas Well

Company United Fuel Gas Co.  
Address Box 1256, Charleston, W. Va.  
Farm J. P. Bailey ACRES 6.3  
Location Williams Branch of Tumpers Creek  
Well No. 4878 ELEV. 757.01  
District Poca - Kanawha County  
Surface & Mineral J. P. Bailey, Sissonville, W. Va.  
Commenced April 1, 1940  
Completed June 24, 1940  
Shot 7/1/40 - Depth 4832  
Open Flow -  
Volume Gas Well 1220mcg - Vol XVI  
Rock Pressure -  
Salt Water 1130-1453

CASING & TUBING

16 Cond.	16	16
13	190	190
10	452	452
8-5/8	1765	1765
7	4748	4748

Surface	0	20	Berea	2186	2202
Red Rock	20	45	Slate & Shells	2202	3410
Blue Slate	45	96	Brown Shale	3410	3460
Slate	96	110	Slate & Shells	3460	3716
Sand	110	130	Brown Shale	3716	3750
Red Rock	130	135	Slate	3750	3775
White Slate	135	155	Brown Shale	3775	4014
Sand	155	165	White Slate	4014	4428
White Slate	165	170	Brown Shale	4428	4709
Red Rock	170	195	Black Shale	4709	4733
Slate	195	313	Corniferous	4733	4833
Sand	313	376	Oriskany	4833	4898 Gas 4835-
Slate	376	412			4845
Sand, dunkard	412	468	Total Depth		4898
Slate	468	530	Filled back with rock to		4855
Shells	530	540			
Slate	540	565			
Red Rock	565	567			
Slate	567	632			
Sand	632	662			
Slate	662	668			
Sand	668	690			
Slate & Shells	690	957			
Sand	957	967			
Slate	967	995			
Sand	995	1014			
Slate	1014	1016			
Salt Sand	1016	1035			
Slate	1035	1045			
Salt Sand	1045	1453	W 1130-1453 HF		
Slate	1453	1455			
Maxon	1455	1517			
Little Lime	1517	1533			
Slate	1533	1535			
Lime	1535	1541			
Pencil Cove	1541	1546			
Big Lime	1546	1712			
Injun	1712	1761			
Slate	1761	1765			
Lime Shells	1765	1770			
Slate&Shells	1770	2120			
Shells	2120	2124	Gas 2123 - show		
Slate & Shells	2124	2180			
Brown Shale	2180	2186			