

W. 2.46'

S. 1.89'

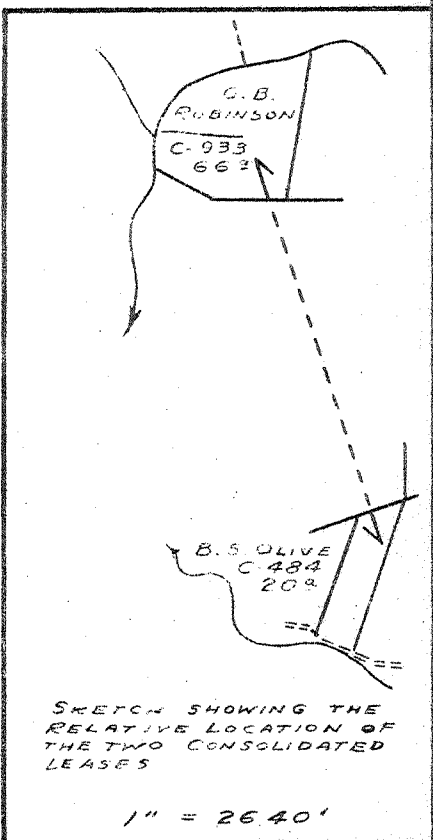

New Location X
 Drill Deeper
 Abandonment

NOTE - LOC. IS 2.5 M. N.W. BLUNDON

Company COLUMBIAN CARBON CO.

Address BOX 1240-CHARLESTON-W. VA.

Farm G. B. ROBINSON ET AL

Tract _____ Acres 86 Lease No. C-484 C-933

Well (Farm) No. ONE Serial No. _____

Elevation (Spirit Level) 741.4

Quadrangle KENNA S.E. (7)

County KANAWHA District POCA

Engineer J. McCall

Engineer's Registration No. 772

File No. _____ Drawing No. _____

Date NOV. 6, 1940 Scale 1" = 660'

STATE OF WEST VIRGINIA
 DEPARTMENT OF MINES
 OIL AND GAS DIVISION
 CHARLESTON

WELL LOCATION MAP
 FILE NO. KAN-773

+ Denotes location of well on United States Topographic Maps, scale 1 to 62,500, latitude and longitude lines being represented by border lines as shown.

- Denotes one inch spaces on border line of original tracing.

WEST VIRGINIA DEPARTMENT OF MINES
OIL & GAS DIVISION
W E L L R E C O R D

Permit No. Kan-773
Kenna S. E. Quad.

Gas Well

Company Columbian Carbon Co.
Address Box 1240, Charleston, W. Va.
Farm G. B. Robinson, et al ACRES 86
Location Pocatalico River
Well No. 1 (GW-470) ELEV. 746.0 DF
District Poca - Kanawha County
Surface Myrtle C. Simpson, et al
 307 Elm St., Charleston, W. Va.
Mineral Contact Columbian Carbon Co.
Commenced 1/1/41
Completed 4/18/41
Shot 4/18/41 - depth 5060-5000 SLM
Volume 5,868,000 c.f.
Rock Pressure 1570 lbs. 6-3/4 hrs.
Salt Water 1224 - 600

CASING & TUBING
16 23-10 23-10
10-3/4 514-3 pulled
8-5/8 1788-4 1788-4
7 4911-2 4911-2
2-3/8 5042-2 5042-2

No packer

Clay	0	15
Sand	15	27
Slate	27	35
Sand	35	50
Slate	50	95
Sand	95	110
Red Rock	110	135
Sand	135	145
Red Rock	145	160
Slate	160	185
Red Rock	185	240
Slate	240	280
Red Rock	280	290
Sand	290	305
Red Rock	305	340
Slate	340	350
Red Rock	350	485
Sand	485	530
Slate	530	550
Sand	550	705
Slate	705	725
Sand	725	795
Slate	795	825
Sand	825	865
Slate	865	900
Sand	900	970
Slate	970	1080
Sand	1080	1125
Slate	1125	1160
Black Lime	1160	1205
Salt Sand	1205	1512 SW 1224 600'
Slate	1512	1517
Little Lime	1517	1545
Slate	1545	1547
Shell	1547	1553
Slate	1553	1558
Big Lime	1558	1721
Big Injun Sand	1721	1762
Slate	1762	1769
Black Lime	1769	1785
Slate	1785	1810
Lime Shell	1810	1835
Slate & Shells	1835	3355
Brown Slate	3355	3405
White Slate	3405	3840
Brown Shale	3840	3890

White Slate	3890	4600
Brown Slate	4600	4785
White Slate	4785	4825
Brown Slate	4825	4874
Corniferous Lime	4874	4997
Oriskany Sand SLM	4997	5045
Black Lime Break	5045	5053
Oriskany Sand	5053	5069
Lime	5069	5085 SLM
Total Depth		5085 SLM

PAY: 5017-5018

CEMENT RECORD:

1/10/41 - Aquagelled 10-3/4 casing.
Ran 10 sacks Aquagel. Ran plug on
top Aquagel.
Dallas Holley, Cementer, Halliburton
Oil Well Cementing Co.

2/10/41 - Cemented 8-5/8 casing. Ran
95 sacks Alpha cement mixed with 2
sacks Aquagel. Ran 10 sacks Aquagel
ahead cement - mixed 6% solution. Ran
plug on top Aquagel and plug on top
cement. 19' of cement in hole.
Dallas Holley, Cementer - Halliburton
Oil Well Cementing Co.

4/3/41 - Cemented 7" casing. Ran 10
sacks Alpha cement dumped on
bottom with dump bailer. Casing
pulled up 30 feet and set back
on bottom. 40' of cement in pipe.
Cemented by Columbian Carbon Co.

Gas 4422 794M - Gas exhausted