

Latitude 38 35
Longitude 81 30

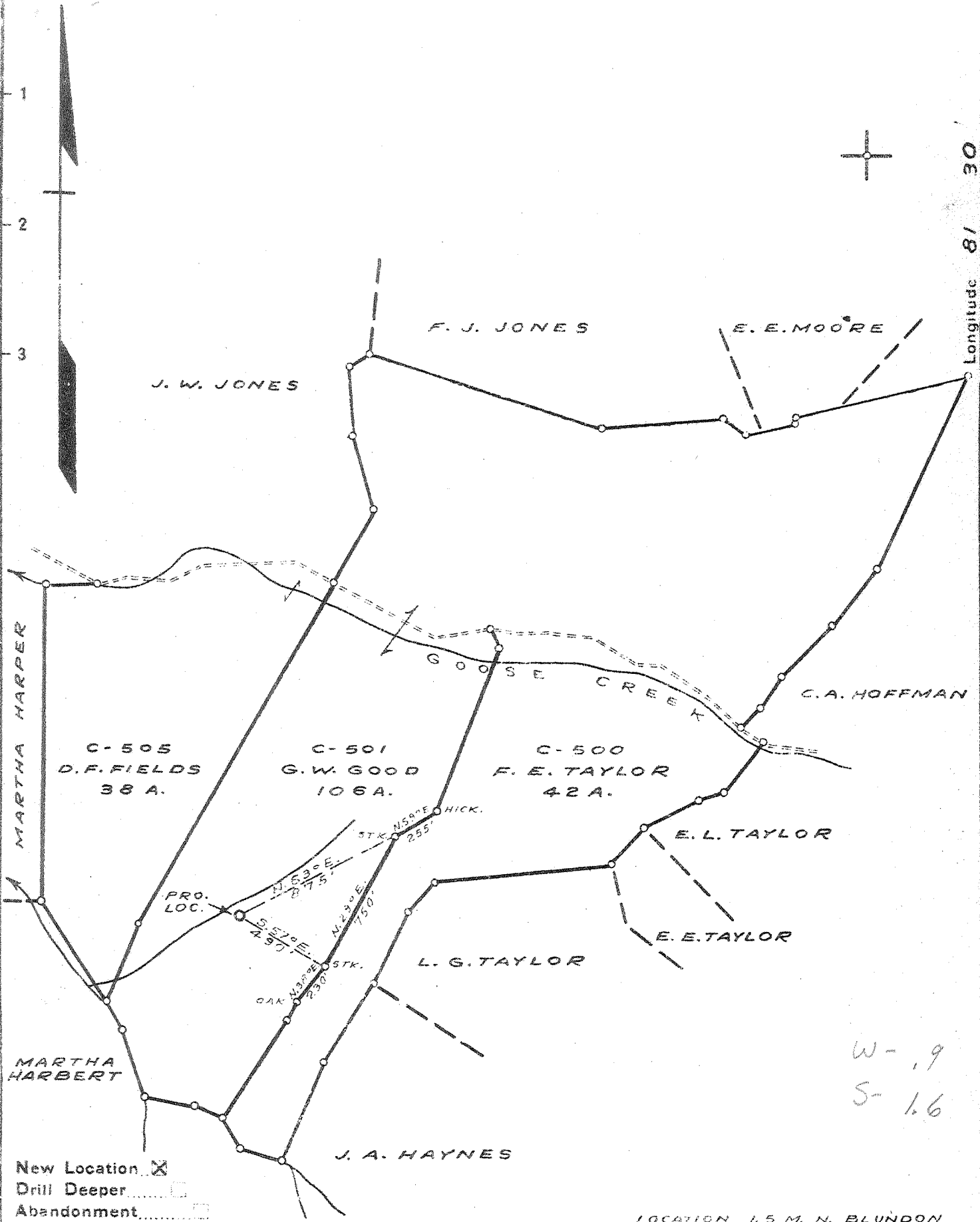

W-19
S-16

New Location
 Drill Deeper
 Abandonment

LOCATION 1.5 M. N. BLUNDON

Company COLUMBIAN CARBON CO.
 Address BOX 1240 - CHARLESTON - W.VA.
 Farm G. W. GOOD ET AL
 Tract C-500-501 Acres 186 Lease No. & 505
 Well (Farm) No. ONE Serial No. _____
 Elevation (Spirit Level) 891.7
 Quadrangle KENNA S.E. (7)
 County KANAWHA District POCA
 Engineer J. McCall
 Engineer's Registration No. 772
 File No. _____ Drawing No. _____
 Date DEC. 13, 1940 Scale 1" = 660'

STATE OF WEST VIRGINIA
 DEPARTMENT OF MINES
 OIL AND GAS DIVISION
 CHARLESTON

WELL LOCATION MAP
 FILE NO. KAN-780

+ Denotes location of well on United States Topographic Maps, scale 1 to 62,500, latitude and longitude lines being represented by border lines as shown.
 - Denotes one inch spaces on border line of original tracing.

WEST VIRGINIA DEPARTMENT OF MINES
OIL & GAS DIVISION
W E L L R E C O R D

Permit No. Kan-780
Kenna S. E. Quad.

Gas Well

Company Columbian Carbon Co.
Address Box 1240, Charleston, W. Va.
Farm G. W. Good ACRES 186
Location Goose Creek of Poca River
Well No. 1 (GW-469) ELEV. 896.6 DF
District Poca - Kanawha County
Surface & Mineral G. W. Good, et al, % Howard Lowe
 R-5, Charleston, W. Va.
Commenced Jan. 15, 1941
Completed April 26, 1941
Shot 4/26/41 - depth 5228-5168 SLM
Volume 1,443,000 c.f.
Rock Pressure 1350 lbs. 68-3/4 hrs.
Oil 1295 show
Salt Water 1305 - 5 blrs. per hr.
 1355 - hole full

CASING & TUBING

14	24-6	24-6
10-3/4	559-0	pulled
8-5/8	1888-7	1888-7
7	5077-4	5077-4
2-3/8	5251-1	5251-1
3	92-7	92-7

No packer

Clay	0	10
Sand	10	30
Red Rock	30	60
Sand	60	70
Slate	70	125
Sand	125	145
Red Rock	145	300
Slate	300	320
Red Rock	320	345
Slate	345	360
Red Rock	360	375
Sand	375	395
Red Rock	395	450
Slate	450	480
Red Rock	480	550
Sand	550	700
Slate	700	704
Sand	704	763
Slate	763	820
Sand	820	1013
Slate	1013	1125
Lime Shells&Slate	1125	1145
Lime Sand	1145	1200
Slate	1200	1205
Sand	1205	1245
Slate	1245	1251 Gas 1280 - show
Salt	1251	1570 Oil 1295 - show
Slate	1570	1573 SW 1304 5 blrs. hr.
Maxton Sand	1573	1628 SW 1355 - hole full
Little Lime	1628	1657
Pencil Cave	1657	1660
Big Lime	1660	1800
Big Injun Sand	1800	1845
Slate & Shells	1845	2100
Black Slate	2100	2135
Lime Shells	2135	2150
Slate & Shell	2150	2315
Lime Shell	2315	2325
Slate & Shells	2325	3485
Lime Shells & Slate	3485	3680
White Slate	3680	3980
Brown Shale	3980	4035
Slate & Shells	4035	4130
Brown Shale	4130	4150
Slate & Shells	4150	4615
Brown Shale	4615	4880
White Slate	4880	4925
Brown Shale	4925	5034

-Corniferous Lime	5034	5158 SLM
Oriskany Sand SLM	5158	5210
Lime -	5210	5219
Oriskany Sand -	5219	5236
-Black Lime -	5236	5240 SLM
Total Depth		5240 SLM

CEMENT RECORD:

1/23/41 Aquagelled 10" csg.
Ran 12 sacks Aquagel mixed
6% solution. Forced plug
within 15' of bottom.
Dallas Holley, Cementeer,
Halliburton Oil Well Cem. Co.

2/19/41 Cemented 8-5/8 csg.
Ran 95 sacks Alpha cement
mixed with 2 sacks Aquagel.
Ran 8 sacks Aquagel ahead
cement - mixed 4%. Ran Plug
on top Aquagel and ran plug
on top cement. Pulled pipe
up 30' while cement was going
around pipe; pipe went back
to bottom. 12' solid cement
left in pipe. Dallas Holley,
Cementeer - Halliburton Oil
Well Cementing Co.

4/9/41 Cemented 7" casing.
Dumped 10 sacks cement with
pipe off bottom. Pulled pipe
up 30' and set back. 38'
solid cement in hole.
Cemented by Columbian Carbon
Company