

Drill Deeper
 Abandonment

Issued 7-11-69

Company (CABOT CORPORATION)
~~GEORGEY L. CABOT, INC.~~
 Address 600 Union Bldg. Charleston, W. Va.
 Farm The Putnam Co.
 Part of 22000 AC
 Tract _____ Acres _____ Lease No. 3-464
 Well (Farm) No. 18 Serial No. 981
 Elevation (Spirit Level) _____
 Quadrangle KENNA S.W. WC
 County KANAWHA District Regs
 Engineer Charles N. Sturme
 Engineer's Registration No. 975
 File No. _____ Drawing No. _____
 Date Apr 14 1941 Scale 1" = 1320'

STATE OF WEST VIRGINIA
 DEPARTMENT OF MINES
 OIL AND GAS DIVISION
 CHARLESTON

WELL LOCATION MAP
 FILE NO. KAN-810-P

+ Denotes location of well on United States Topographic Maps, scale 1 to 62,500, latitude and longitude lines being represented by border lines as shown.

- Denotes one inch spaces on border line of original tracing.

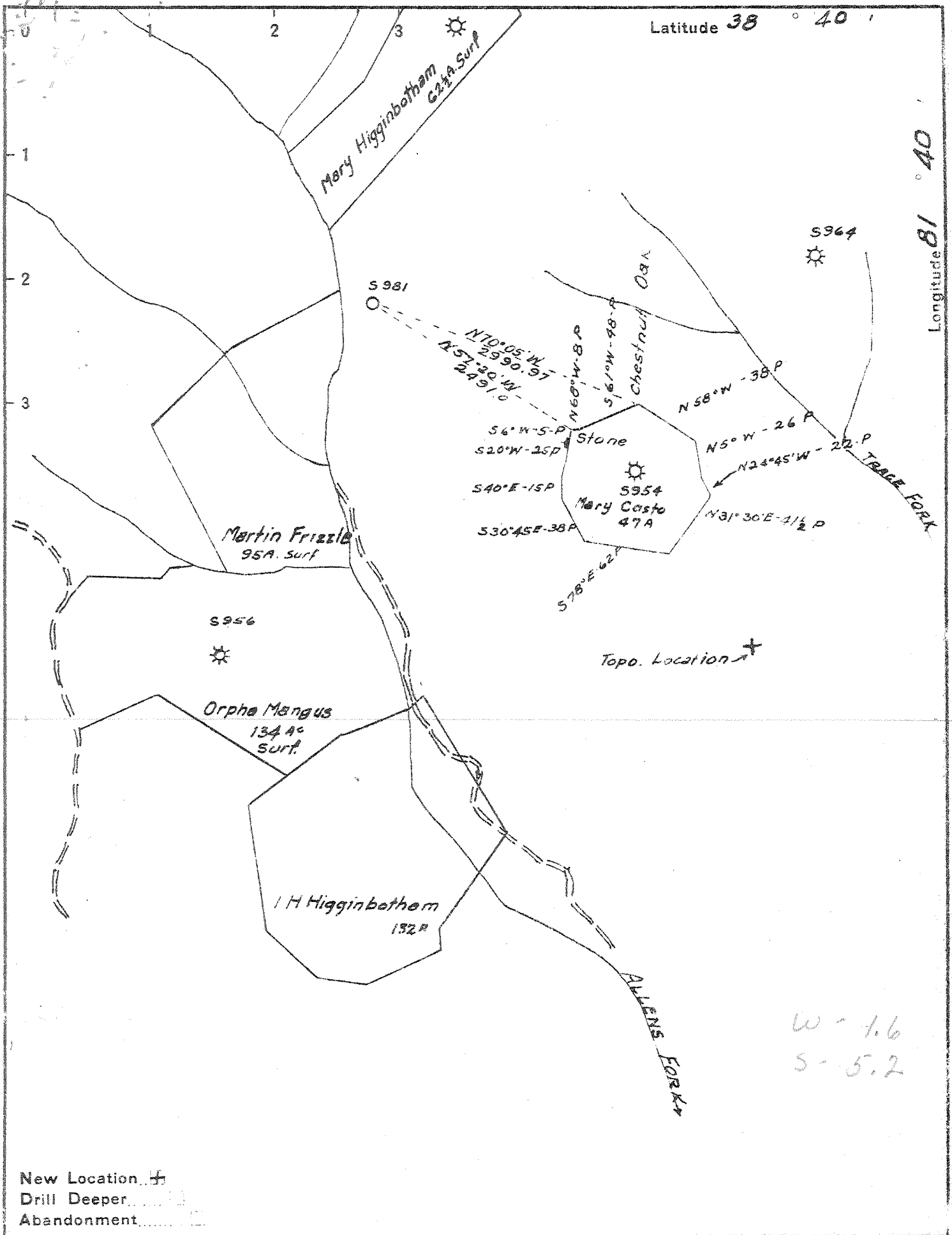

New Location
 Drill Deeper
 Abandonment

Company GODFREY L. CABOT INC
 Address 600 UNION BLDG. CHARLESTON, W.VA.
 Farm The Putnam Co
 Part of 22000 AC
 Tract _____ Acres _____ Lease No. 3-464
 Well (Farm) No. 18 Serial No. 981
 Elevation (Spirit Level) _____
 Quadrangle KENNA S.W.
 County KANAWHA District ROGA
 Engineer Charles N. Sturm
 Engineer's Registration No. 975
 File No. _____ Drawing No. _____
 Date Apr. 14 1941 Scale 1" = 1320'

STATE OF WEST VIRGINIA
 DEPARTMENT OF MINES
 OIL AND GAS DIVISION
 CHARLESTON

WELL LOCATION MAP
 FILE NO. KAN-810

+ Denotes location of well on United States Topographic Maps, scale 1 to 62,500, latitude and longitude lines being represented by border lines as shown.

- Denotes one inch spaces on border line of original tracing.

Deep Well

WEST VIRGINIA DEPARTMENT OF MINES
OIL & GAS DIVISION
W E L L R E C O R D

Permit No. Kan-810

Gas Well

Konna S W Quad.

Company Godfrey L. Cabot, Inc.
Address Charleston, W.Va.
Farm The Putnam Company
Well No. 18 Serial No. 981 Elev. 880.20
District Pocahontas Kanawha County
Commenced May 22, 1941
Completed August 24, 1941
Shot August 25, 1941 Depth 5078
Flow 40 mins. after shot
Volume 2,282 M.C.F.

Casing & Tubing
10 1/2 795 795
8-5/8 2133 --
7 4972 4972
2-3/8 5151 5113
Tubed & Shut in 9-4-41
Perf. top 5075
Perf. bot. 5083
Perf. top 5109
Perf. bot. 5115

Top Soil	0	14	Black Shale	4895	4952
Sand	14	20	Corniferous Lime	4952	5046SL
Red Rock	20	50	Oriskany	5046	5089
Red Lime	50	85	Lime, Oriskany	5089	5104
Slate	85	100	Sand	5104	5118
Red Rock	100	115	Lime, Helderberg	5118	5122SL
Sand	115	135	Total Depth		5122SL
Red Rock	135	175	Gauges in Oriskany Before Shot		
Sand	175	210	8-16 5047-50	273M	
Red Rock	210	250	8-17 5052	442M	
Slate	250	280	5054	520M	
Red Rock	280	320	5056	520M	
Slate & Shells	320	385	5056	447M	
Red Rock	385	400	5060	465M	
Slate & Shells	400	595	5062	710M	
Red Rock	595	625	5066	848M	
Slate & Shells	625	670	5067	600M	
Sand	670	695	5070	600M	
Slate & Shells	695	715	5073	600M	
Red Rock	715	725	5074	643M	
Slate & Shells	725	753	5076	684M	
Red Rock	753	767	5078	684M	
Sand	767	816	5079	600M	
Slate & Shells	816	830	5083	629M	
Red Rock	830	835	5091	629M	
Slate	835	840	5100	520M	
Sand	840	860	5108	502M	
Red Rock	860	863	5105	484M	
Slate	863	880	5109	502M	
Sand	880	925	5110	520M	
Slate	925	950	5111	520M	
Sand	950	995	5115	520M	
Slate	995	1040	5116	502M	
Sand	1040	1070	Gauges in Oriskany Sand After Shot		
Slate	1070	1105	8-25-41 Before Shot	465M	
Sand	1105	1200	5 Mins after shot	2,677M	
Slate	1200	1225	10 Mins. " "	2,559M	
Sand	1225	1250	15 Mins. " "	2,489M	
Slate & Shells	1250	1455	20 Mins. " "	2,314M	
Salt Sand	1455	1828	40 Mins. " "	2,282M	
Slate	1828	1833			
Maxton	1833	1939			
Big Lime	1939	1989			
Slate	1989	1992			
Lime	1992	2001			
Sand	2001	2040			
Sand, Slate & Shells	2040	2060			
Black Lime	2060	2228			
Slate & Shells	2228	2455			
Berea Sand	2455	2475			
Slate & Shells	2475	3720			
Brown Shale	3720	3740			
Slate & Shells	3740	3960			
Brown Shale	3960	4000			
Slate & Shells	4000	4100			
Brown Shale	4100	4240			
White Slate	4240	4695			
Brown Shale	4695	4895			

4952 5046 5118
 880 880 880

 4072 4166 4238