

Drill Deeper.....
Abandonment.....

Issue 7-11-69

Company CABOT CORPORATION

Address 900 UNION BLDG. CHARLESTON, W.VA.

Farm L. E. PAULEY

Tract _____ Acres 25 Lease No. _____

Well (Farm) No. 1 Serial No. 100.5

Elevation (Spirit Level) 908.41

Quadrangle KENNA EC

County KANAWHA District POCA

Engineer Roy Boston

Engineer's Registration No. _____

File No. _____ Drawing No. _____

Date 9-9-41 Scale 1"=1320'

STATE OF WEST VIRGINIA
DEPARTMENT OF MINES
OIL AND GAS DIVISION
CHARLESTON

WELL LOCATION MAP
FILE NO. KAN-863-P

+ Denotes location of well on United States Topographic Maps, scale 1 to 62,500, latitude and longitude lines being represented by border lines as shown.

- Denotes one inch spaces on border line of original tracing.

M

Latitude 38° 40'

Longitude 81° 30'

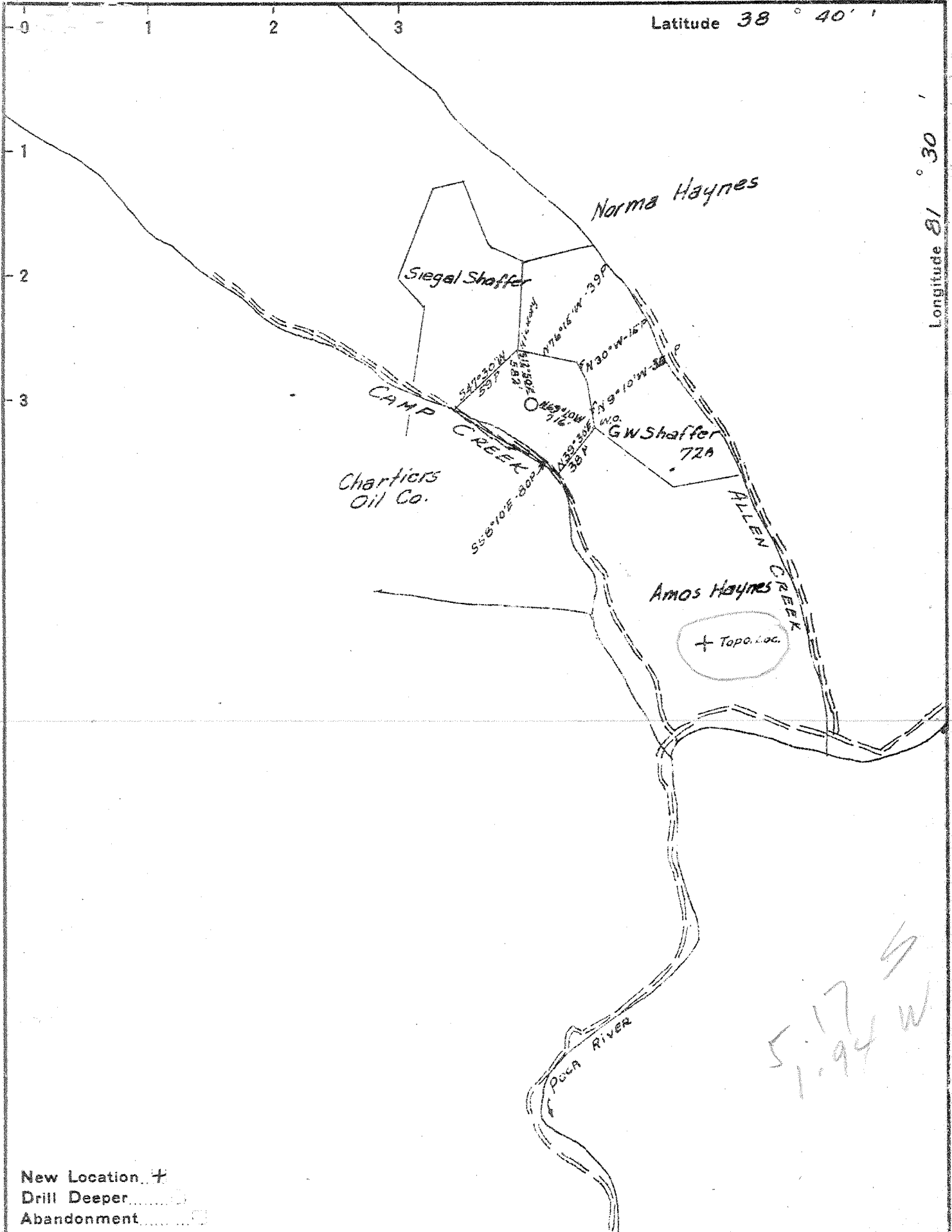

5:17
1:94 W

New Location +
 Drill Deeper
 Abandonment

Company GODFREY L. CABOT, INC.
 Address 300 UNION BLDG. CHARLESTON, W.VA.
 Farm L. E. PAULEY
 Tract _____ Acres 25 Lease No. _____
 Well (Farm) No. 1 Serial No. 1005
 Elevation (Spirit Level) 908.41
 Quadrangle KENNA
 County KANAWHA District POCA
 Engineer Roy Boston
 Engineer's Registration No. _____
 File No. _____ Drawing No. _____
 Date 9-9-41 Scale 1" = 1320'

STATE OF WEST VIRGINIA
 DEPARTMENT OF MINES
 OIL AND GAS DIVISION
 CHARLESTON

WELL LOCATION MAP
 FILE NO. KAN-863

+ Denotes location of well on United States Topographic Maps, scale 1 to 62,500, latitude and longitude lines being represented by border lines as shown.

- Denotes one inch spaces on border line of original tracing.

Deep Well

WEST VIRGINIA DEPARTMENT OF MINES
OIL & GAS DIVISION
W E L L R E C O R D

Permit No. Kan-863

Company Godfrey L. Cabot Inc.
Address Charleston, W.Va.
Farm L.M. Pauley Acres---
Location Poca
Well No 1 Serial# 1005 Elev. 908.41
District Poca Kanawha County
Surface
Mineral
Commenced Sept. 1, 1941
Completed Dec. 18, 1941
Rock Pressure 1700# 30 hrs-- Oriskany
Volume 9,902 MCF
Water 1425 Hole Full at 1475

Gas Well
Casing & Tubing
10 $\frac{1}{2}$ 719 719 C.S.
8 5/8 1946 1946
7 5130 5130
2 3/8 5238 5238
(Bull plugged)

B.H. Packer (28 bags Aquagel)
8 $\frac{1}{2}$ x 10x16
7" O.D. Sp. Orisk. B.H.
Packer and 40 bags
aquagel and 4 bags
fibertex.

Surface	0	14	Brown Shale	4720	5010
Sand	14	25	White Slate	5010	5030
Red Rock	25	45	Brown Shale	5030	5065 Sh.
Sand	45	210	Black Shale	5065	5110 Gas
Slate	210	225	Corniferous Lime	5110	5254 5050 <i>5234</i>
Lime	225	240	Oriskany	5234	5264
Slate	240	290			Gas
Sand	290	310			5254--
Slate	310	345			64
Red Rock	345	360			
Slate	360	385	TOTAL DEPTH		5264
Sand	385	397			
Red Rock	397	410			
Slate	410	430	GAUGES IN ORISKANY		
Red Rock	430	495	12-18-41	5255	8,507 M
Lime	495	570	"	5257	9,501 M
Sand & Red Rock	570	600	"	5262	9,902 M
Sand	600	620	"	5264	9,362 M
Slate	620	625	NOTE: Well not shot		
Red Rock	625	650	Pay: Oriskany	5254-5262-Init. Prod.	9,902 MCF
White Slate	650	695			
Sand	695	703			
Slate	703	715	Due to large open flow of gas no steel		
Lime	715	735	line was run on Oriskany sand.		
Sand	735	930			
Slate	930	1020			
Sand	1020	1080			
Slate	1080	1095			
Lime	1095	1130			
Sand	1130	1212			
Slate	1212	1306			
Sand	1306	1332			
Slate	1332	1369			
Sand	1369	1725			
Lime	1725	1729			
Maxon	1729	1748			
Little Lime	1748	1771			
Slate	1769	1771			
Lime Shell	1771	1773			
Pencil Cave	1773	1776			
Big Lime	1776	1902			
Injun Sand	1902	1951			
Slate	1951	1958			
Lime Shells	1958	1963			
Black Slate	1963	1980			
Slate & Shells	1980	3562 <i>3562</i>			
Brown Shale	3562	3640			
Wh. Slate & Shells	3640	3880			
Brown Shale	3880	3935			
Wh. Slate & Shells	3935	4000			
Brown Shale	4000	4180			
Slate & Shells	4180	4230			
Brown Shale	4230	4280			
White Slate	4280	4720			