

Near Location ☒  
 Drill Deeper ☐  
 Abandonment ☒ 5/23/73

**CABOT CORP.**  
 Company ~~Guthrie & Fitch Inc.~~  
 1400 Charleston W. F. 1928  
 Address ~~300 Union Bldg~~ Charleston W. Va.  
 Farm D. Holmes Morton  
 Tract \_\_\_\_\_ Acres 162 Lease No. 3-467  
 Well (Farm) No. 10 Serial No. 1048  
 Elevation (Spirit Level) 895.84  
 Quadrangle Kenna SW  
 County Kanawha District Poca  
 Engineer Roy Boster  
 Engineer's Registration No. \_\_\_\_\_  
 File No. \_\_\_\_\_ Drawing No. \_\_\_\_\_  
 Date 5-14-42 Scale 1" = 1320'

STATE OF WEST VIRGINIA  
 DEPARTMENT OF MINES  
 OIL AND GAS DIVISION  
 CHARLESTON

# WELL LOCATION MAP

FILE NO. KAN-918-P

+ Denotes location of well on United States Topographic Maps, scale 1 to 62,500, latitude and longitude lines being represented by border lines as shown.

- Denotes one inch spaces on border line of original tracing.

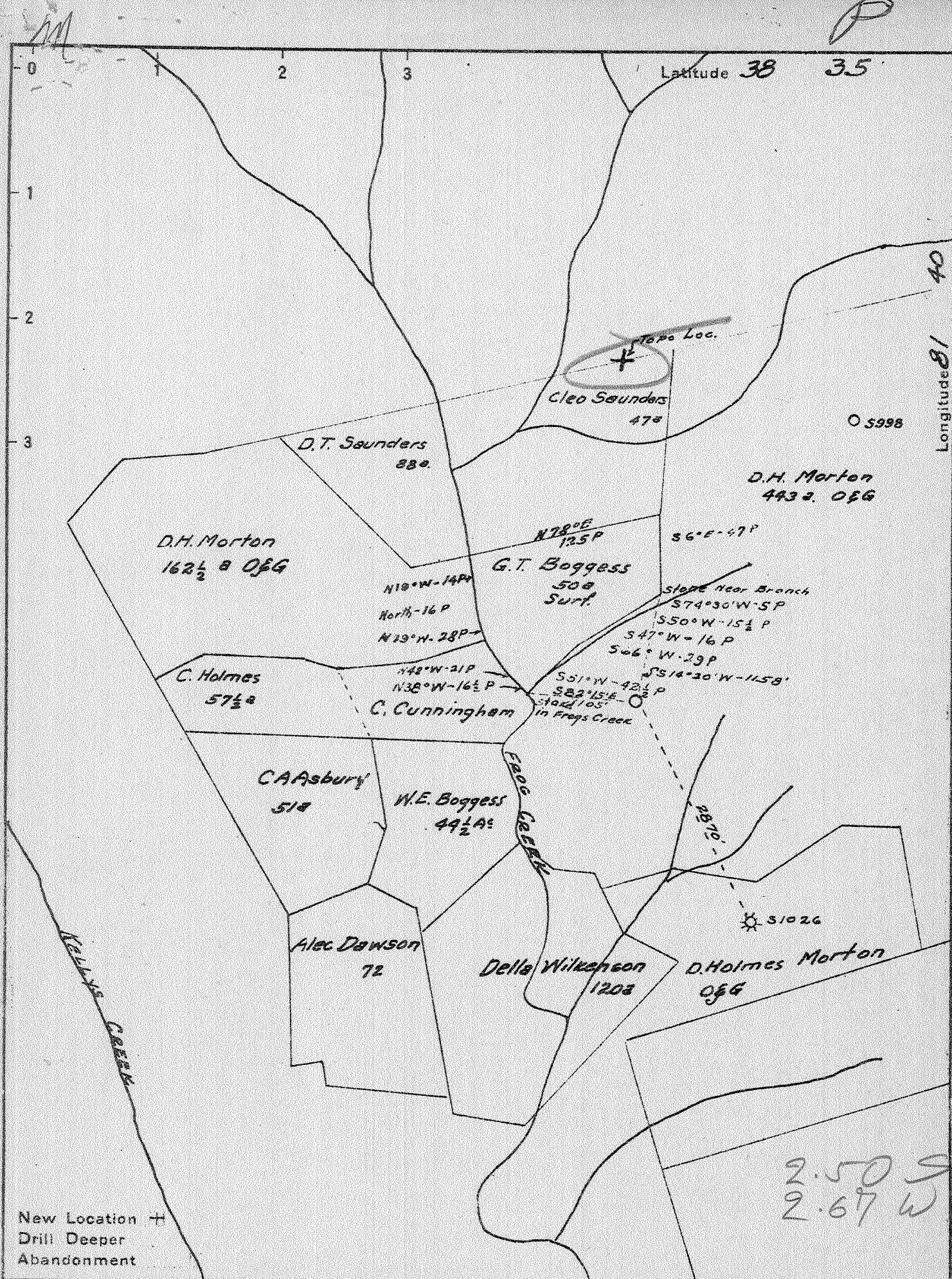

Company Godfrey L Cabot Inc

Address 900 Union Bldg Charleston Wva

Farm D. Holmes Morton

Tract \_\_\_\_\_ Acres 160 Lease No. 3-467

Well (Farm) No. 10 Serial No. 1048

Elevation (Spirit Level) 895.84

Quadrangle Kenna

County Kanawha District Poca

Engineer Roy Boston

Engineer's Registration No. \_\_\_\_\_

File No. \_\_\_\_\_ Drawing No. \_\_\_\_\_

Date 5-14-42 Scale 1" = 1320'

STATE OF WEST VIRGINIA  
DEPARTMENT OF MINES  
OIL AND GAS DIVISION  
CHARLESTON

# WELL LOCATION MAP

FILE NO. KAN-918

+ Denotes location of well on United States Topographic Maps, scale 1 to 62,500, latitude and longitude lines being represented by border lines as shown.

- Denotes one inch spaces on border line of original tracing.

Deep Well



WEST VIRGINIA DEPARTMENT OF MINES  
OIL & GAS DIVISION  
W E L L R E C O R D

Permit No. Kan 918				Gas Well
Kenna Quad				CASING & TUBING
Company	Godfrey L. Cabot, Inc.	10 $\frac{1}{2}$ 800	800	Casing shoe
Address	Charleston, W.Va.	85/8	2090 2090	28 sacks AQg.
Farm	D.Holmes Morton	Acres -- 7	4999 4999	40 " aquagel
Location	--			4 " Fibretex
Well No	10	Ser. 1048	Elev. 896 1 $\frac{1}{2}$	5127 5127 -screw cap
District	Poca	Kanawha County		on bottom joint
Surface	--			
Mineral	--			8 5/8 D.H. Packer
Commenced	June 15, 1942			7" Spec. Oriskany B.H.
Completed	Sept. 9, 1942			Packer
Shot	9-11-42	5074 to 5088 $\frac{1}{2}$		30 qts.
Flow	B.S. 8/10 W 1 $\frac{1}{2}$ "	50 Mins. A.S.		Perf. top 5083 5089
	.7 W-3"			Perf. top 5130 $\frac{1}{2}$ 5131
Volume	169 MCF (After cleaning out)			Tubed & Shut in 9-17-42
	A.S. 251 MCF			
Rock Pressure	--			
S. Water	1075 -3 blrs. pr. hr.			1485' H.F.

Red Rock	S	0	75	Lime	4200	4210
Blue Shale		75	125	Shale	4210	4700
Red Rock		125	200	Brown shale	4700	4950
Lime	Wh	200	225	Corniferous	4974	5068
Red Rock		225	300	Oriskany	5068	5083 SLM
Blue Shale		300	350	Sand	5083	5085
Red Rock		350	400	Oriskany	5085	5090
Blue Shale		400	450	Lime	5090	5092
Red Rock		450	510	Sand	5092	5103
Sand	Wh	510	530	Lime	5103	5125
Shale		530	580	Sand	5125	5133
Lime	Wh	580	595	TOTAL DEPTH		5133 SLM
Red Rock		595	650			
Shale Shells		650	670	Did not encounter any water in 12 $\frac{1}{2}$ "		
Lime	Bk	670	715	Hole.		
Shale Shells		715	755	GAUGES IN ORISKANY SAND		
Dunkard Sand		755	785	9-3-	5075-80	103M
Shale Shells		785	935		5083	84M
Sand		935	965	Shut in test casing		
Shale Shells		965	1055		5083	94M
Sand		1055	1120		5090	84M
Shale Shell		1120	1180		5103	60M
Sand		1180	1240		5118	60M
Shale	Bk	1240	1260		5125	60M
Lime		1260	1270		5130	60M
Shale Shell		1270	1420		5133	60M
Salt Sand		1420	1852	GAUGES IN ORISKANY SAND *A.S.		
Slate		1852	1855	Gauge B.S.	66M	
Big Lime		1855	2035	5Min A.S.	474M	
Injun Sand		2035	2082	10 " "	355M	
Lime		2082	2110	15 " "	300 M	
Shale Shells		2110	2175	20 " "	285 M	
Lime		2175	2225	50 " "	251 M	
Shale		2225	2495	After cleaning out	169 M	
Berea Grit		2495	2545			
Shale		2545	2725	Gas 2520 Too small to gauge		
Lime		2725	2760	Gas 5075-80		
Shale		2760	2800			
Lime		2800	2825	SLM 5083		
Shale		2825	2875	SLM 5133		
Lime		2875	2900			
Shale		2900	3700			
Brown Shale		3700	3790			
Lime		3790	3810			
Shale shells		3810	3860			
Lime		3860	3890			
Shale		3890	4025			
Brown shale		4025	4200			