

Latitude 38 30  
 + Topo. Location

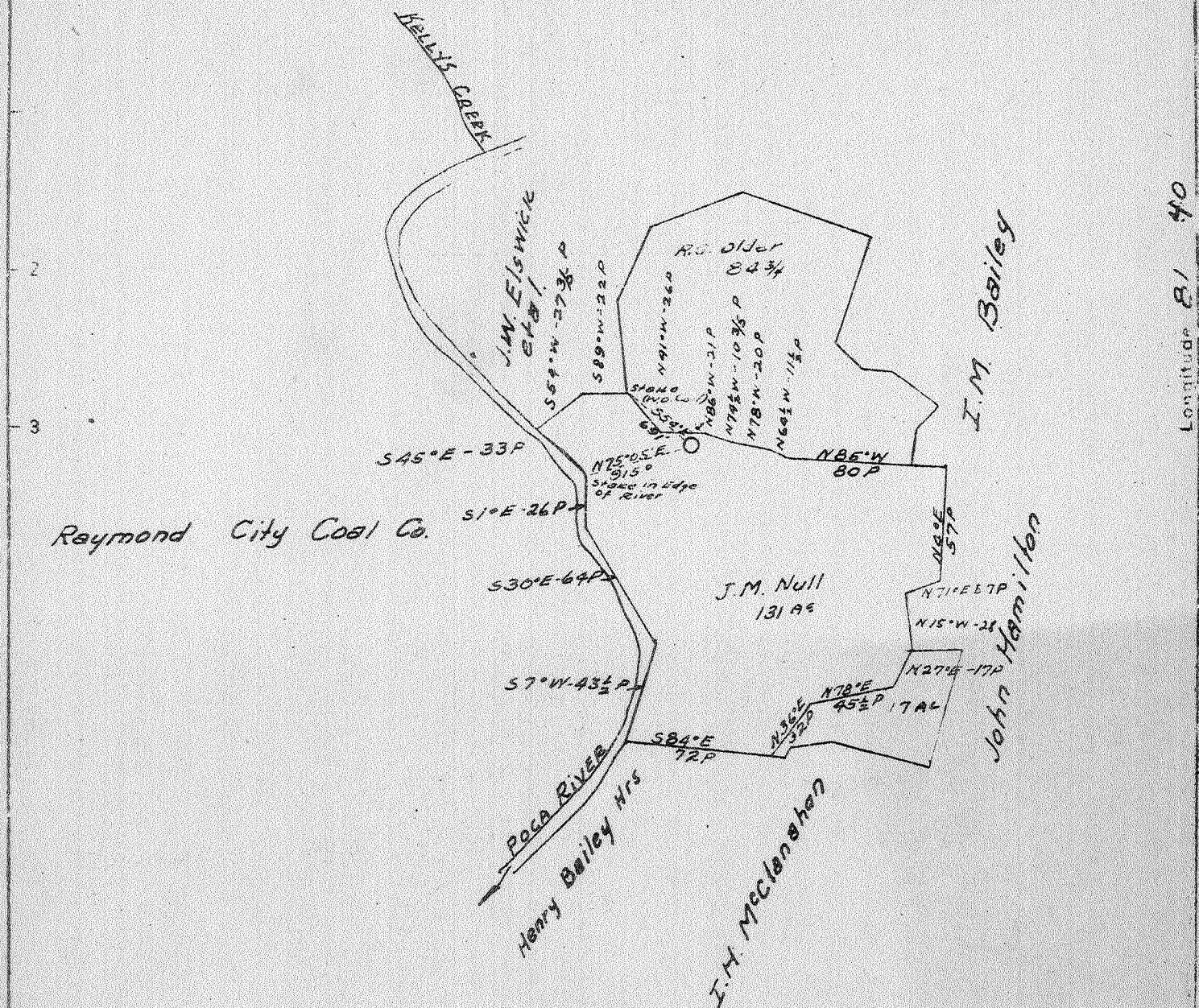

Longitude 81 40

0.26 S  
 2.3 W

New Location +  
 Drill Deeper  
 Abandonment

Company *Godfrey L Cabot Inc.*  
 Address *900 Union Bldg Charleston W Va*  
 Farm *J.M. Null et al*  
 Tract Acres *191* Lease No *Unit Agree*  
 Well (Farm) No *1* Serial No *1022*  
 Elevation (Spirit Level) *697.11 - 0L - 7.5' quad - KA 12587*  
 Quadrangle *Charleston NC*  
 County *Kanawha* Dist *UNION*  
 Engineer *Roy Booton*  
 Engineer's Registration No \_\_\_\_\_  
 Plot No \_\_\_\_\_ Drawing No \_\_\_\_\_  
 Date *2-16-42* Scale *1" = 1320'*

STATE OF WEST VIRGINIA  
 DEPARTMENT OF MINES  
 OIL AND GAS DIVISION  
 CHARLESTON

WELL LOCATION MAP  
 FILE NO *KAN-921*

+ Denotes location of well on United States Topographic Maps, scale 1 to 62,500. Latitude and longitude lines being represented by border lines as shown.

- Denotes one inch spaces on border line of original tract.

*66192* Deep well

WEST VIRGINIA DEPARTMENT OF MINES  
OIL & GAS DIVISION  
W E L L R E C O R D

Permit No. Kan 921		Gas Well
Charleston Quad		CASING & TUBING
Company	Godfrey L. Cabot, Inc.	601 Bevelled Coup-
Address	Charleston, W.Va.	-- ling shoe
Farm	J.M. Null et al Acres -- 7	4657
Location	--	2 3/8 4789
Well No	1 Ser1022 Elev. 849	4789-bottom joint
District	Union Kanawha County	welded. Line pipe
Surface	--	used as tubing
Mineral	--	8 5/8 Spang B.H. Packer; 28
Commenced	April 22, 1942	bags aquagel.
Completed	July 28, 1942	7" Spec. Orisk. B.H.Packer;
Shot	7-29-42	Depth 4740 to 4763, 45 qts. 40 bags aquagel;
Volume	B.S. 381 MCF; A.S. (20 Mins)	4,927 MCF 4 bags fibertex
Rock Pressure	1850 lbs. 25 hrs.	
Fresh water	80° 1/2 blr.;	Tubed and shut in 8-3-42
Salt Water	1065-70 H.F. Water level 300'	Perf. top 4749 4785 Perf. bot 4755 4787

Surface	0	20	Brown Shale	3796	3852
White Slate	20	60	Slate & Shells	3852	3862
Sand	60	85	Brown Shale	3862	3976
Red Rock	85	100	White Slate	3976	4375
White Slate	100	120	Brown Shale	4375	4636
Red Rock	120	140	Corniferous	4636	4740
White Slate	140	160	Oriskany	4736	4772
Red Rock	160	177	Lime	4772	4784
Gritty Lime	177	183	Sand	4784	4786
White Slate	183	215	Lime	4796	4800 HSL
Sand	215	228	TOTAL DEPTH		4800
Slate	228	240			
Red Rock	240	264	SLM 4657 and 4742		
White Slate	264	312			
Sand	312	420	GAUGES IN ORISKANY SAND B.S.		
White Slate	420	488	7-21 4741-42 246 M		
Sand	488	500	Shut down testing casing.		
Slate	500	540	7-23 4743 1,021 M		
Sand	540	573	4746 771 M		
Black Slate	573	592	7-24 4746 668 M		
Lime	592	601	4758 545 M		
Sand	601	725	4759 713 M		
Black Slate	725	752	4760 778 M		
Sand	752	770	4763 778 M		
Slate & Shells	770	875	4768 698 M		
Sand	875	985	4772 678 M		
Slate	985	1009	4783 603 M		
Sand	1009	1026	4781 492 M		
Black Slate	1026	1056	4800 381 M		
Salt Sand	1056	1557	GAUGES IN ORISKANY A.S.		
Big Lime	1557	1694	Gauge B.S. 351 M		
Big Injun	1694	1735	10 Mins A.S. 5130 M		
Blue Slate	1735	1750	15 " " 4927 M		
Gritty Lime	1750	1780	20 " " 4927 M		
Slate & Shells	1780	2150			
Br. Shale	2150	2167	B.S. Net gauges		
Berea Sand	2167	2185	Oriskany 4741 to 4743 init. 1021 MCF		
Slate & Shells	2185	2875	4759 4763 63		
Gray Shale	2875	3010	Total 1086 MCF		
White Slate	3010	3094			
Slate & Shells	3094	3385			
Brown Shale	3385	3445			
Slate & Shells	3445	3610			
White Shale	3610	3852			
Slate & Shells	3852	3796			