

New Location
 Drill Deeper
 Abandonment 2/14/94

Company Cabot Oil & Gas Corporation
 Address Gateway Center, Suite 200, Pittsburgh, PA
 Firm Poca Coal Co.
 Tract Acres 160 Lease No. 3-466
 Well (Farm) No. 103 Serial No. 1032
 Elevation (Spirit Level) 852.43
 Quadrangle Sissonville 7.5'
 County Kanawha District Union
 Engineer Ray Boston
 Engineer's Registration No. _____
 File No. _____ Drawing No. _____

STATE OF WEST VIRGINIA
 Division of Environmental Protection
 Office of Oil & Gas
 Nitro, WV.

WELL LOCATION MAP
 Oil Well No. 47-039-0931-P

+ Denotes location of well on United States Topographic Maps, scale 1 to 62,500, latitude and longitude lines being represented by border lines as shown.

- Denotes one inch spaces on border line of original tracing.

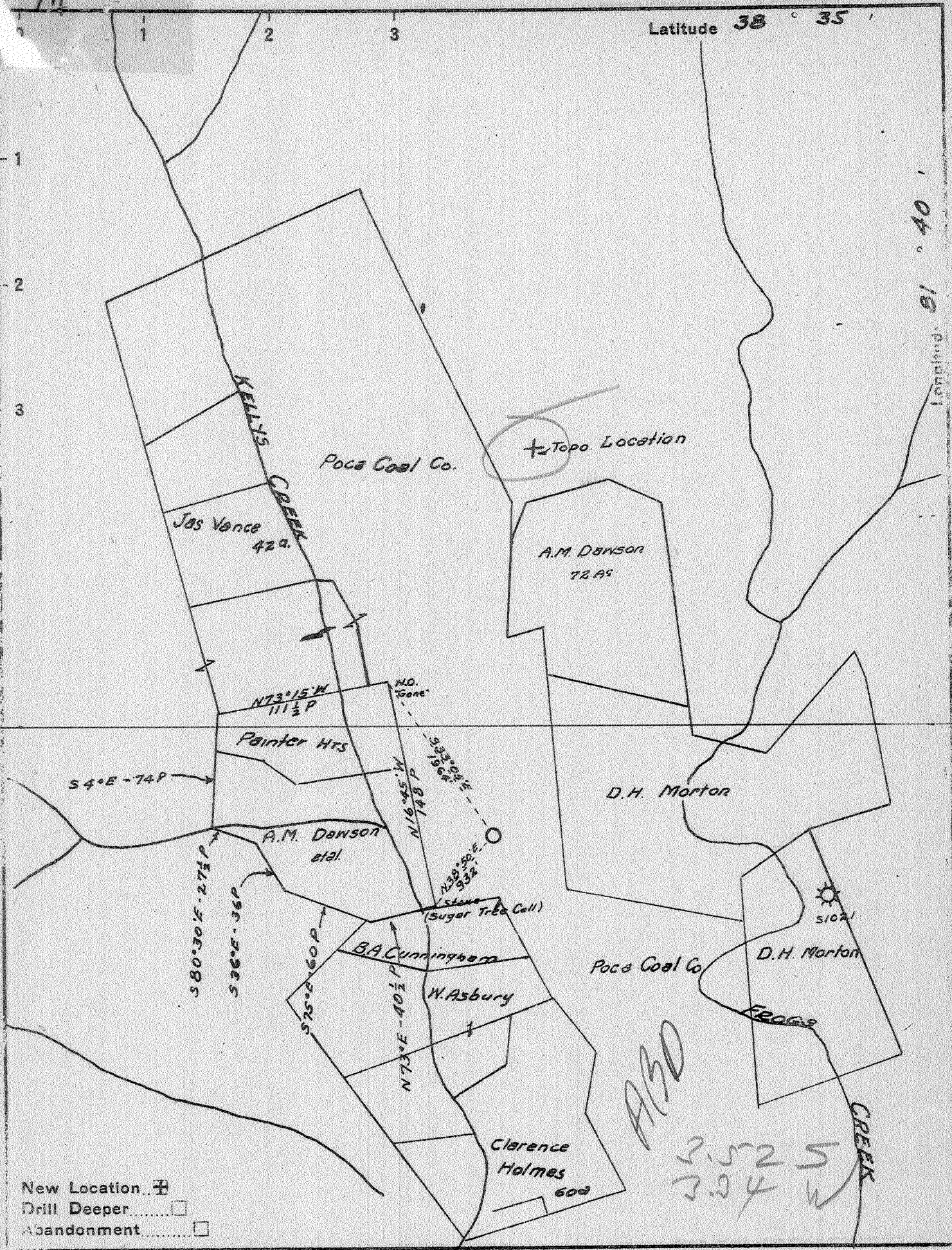

Company Godfrey L. Cabot Inc.
 Address 900 Union Bldg Charleston W Va
 Farm Poca Coal Co.
 Tract _____ Acres 160 Lease No. 3-466
 Well (Farm) No. 8 Serial No. 1032
 Elevation (Spirit Level) 352.43
 Quadrangle Kenna
 County Kanawha District Union
 Engineer Roy Boston
 Engineer's Registration No. _____
 File No. _____ Drawing No. _____
 Date 4-6-42 Scale 1" = 1320'

STATE OF WEST VIRGINIA
 DEPARTMENT OF MINES
 OIL AND GAS DIVISION
 CHARLESTON

WELL LOCATION MAP
 FILE NO. KAN-931

+ Denotes location of well on United States Topographic Maps, scale 1 to 62,500, latitude and longitude lines being represented by border lines as shown.
 - Denotes one inch spaces on border line of original tracing.

2.55 S. 38° 55'
3.33 W. 81° 40'

P

WEST VIRGINIA DEPARTMENT OF MINES
OIL & GAS DIVISION
WELL RECORD

Permit No. Kan 931
S.W. Kenna Quad.

Gas Well
CASING & TUBING

Company	Godfrey L. Cabot Inc.			
Address	Charleston, W.Va.	10 $\frac{1}{2}$	650	650
Farm	Poca Coal Land Co.	85/8	2037	2037
Location	--	7	4890	4890
Well No.	8 Mer. 1032	Elev. 852	2 3/8	5027 5027
District	Poca	Kanawha County	Bottom joint welded.	
Surface			E.W. Line pipe as tubing.	
Mineral				
Commenced	May 26, 1942			
Completed	Sept. 30, 1942		8 5/8" Spang Gas Anchor	
Date shot	9-30-42	Depth 4959 to 4979	40 qts. Packer; 28 bags	
Flow	B.S. 77 M; 45 Min. A.S. 783 M		aquagel.	
Rock Pressure	1450 lbs. 20 hrs. Oriskany		7" Spec. Oriskany B.H.	
Water	1460 H.F.; 965-67 l blr. pr. hr.		Packer; 28 bags aquagel.	

(Open)

Tubed and shut in 12-23-42
Perf. top Bot
4971 4979
5019 5027

Red Rock	0	25	Sand	1105	1165
Slate	25	40	Slate	1165	1335
Red Rock	40	55	Sand	1335	1785
Slate	55	65	Slate	1785	1786
Red Rock	65	75	Big Lime	1786	1970
Slate	75	140	Big Injun	1970	1995
Lime	140	150	Slate & Shells	1995	2434
Slate	150	180	Berea	2434	2450
Sandy	180	258	Slate & Shells	2450	3652
Coal	258	260	Brown Shale	3652	3690
Slate	260	265	Slate	3690	3920
Lime	265	275	Brown Shale	3920	3940
Red Rock	275	310	Slate & Shells	3940	4050
Slate	310	335	Brown Shale	4050	4195
Red Rock	335	395	Big White	4195	4610
Slate	395	455	Brown Shale	4610	4669
Red Rock	455	465	Corniferous	4669	4956
Slate	465	475	Oriskany	4956	4958
Red Rock	475	495	Lime	4958	SLM 4990
Sand	495	540	Sand	4990	4996
Slate	540	555	Lime	4996	5015
Sand	555	575	TOTAL DEPTH	5015	5029
Slate	575	580			5029
Pink Rock	580	595	Gas 2440 Little		
Slate	595	600	Gas 3161 Pocket		
Lime	600	610	Gas 3973 Pocket		
Slate	610	640	Gas 4960 Not enough to gauge.		
Big Dunk. Sand	640	672			
Slate	672	682	GAUGES IN ORISKANY B.S.		
Lime	682	699	1960-62 267 M	4996	119 M
Slate	699	702	4963 146 M	4997	112 M
Lime Shells	702	712	4967 133 M	5007	77 M
Sand	712	775	4971 163 M	5014-5029	64 M
Slate	775	780	4972 146 M		
Sand	780	800	4975 158 M		
Slate & Shells	800	815	4977 179 M		
Sand	815	869	4978 174 M		
Slate	869	914	4982 169 M		
Sand	914	960			
Coal	960	962	GAUGES IN ORISKANY A.S.		
Slate	962	967	Gauge B.S. 77 M		
Sand	967	982	5 Mins A.S. 1050 M		
Slate	982	987	10 Mins. A.S. 926 M		
Sand	987	1083	15 Mins. " 858 M		
Coal	1083	1088	20 Mins. A.S. 858 M		
Slate	1088	1105	45 Mins. A.S. 783 M		

Deep Well

STATE OF WEST VIRGINIA
DIVISION OF ENVIRONMENTAL PROTECTION
SECTION OF OIL AND GAS

AFFIDAVIT OF PLUGGING AND FILLING WELL

AFFIDAVIT SHOULD BE IN TRIPLICATE, one copy mailed to the Division, one copy to be retained by the Well Operator and the third copy (and extra copies if required) should be mailed to each coal operator at their respective addresses.

Farm name: JONES, JIMMY E. ETALS. Operator Well No.: POCA COAL #8

LOCATION: Elevation: 852.43 Quadrangle: SISSONVILLE
District: UNION County: KANAWHA
Latitude: 3650 Feet South of 38 Deg. 32 Min. 30 Sec.
Longitude 5450 Feet West of 81 Deg. 42 Min. 30 Sec.

Well Type: OIL _____ GAS X

Company: Cabot Oil & Gas Corp.
400 Fairway Drive, Suite 400
Coraopolis, PA 15108

Coal Operator Ardith Dandy Agent et al
or Owner 4009 Kanawha S.E.
Charleston, WV 25304

Agent: Dave McCluskey

Coal Operator _____
or Owner _____

Permit Issued: 02/14/94

AFFIDAVIT

STATE OF WEST VIRGINIA,
County of Kanawha ss:

Bill Shreve and Kevin Shreve being first duly sworn according to law depose and say that they are experience in the work of plugging and filling oil and gas wells and were employed by the above named well operator, and participated in the work of plugging and filling the above well, and Carlos Hively Oil and Gas Inspector representing the Director, say that said work was commenced on the 7th day of October, 1994, and that the well was plugged and filled in the following manner:

TYPE	FROM	TO	PIPE REMOVED	LEFT
Cement	2224'	1980'	8-5/8" 1300'	737'
Gel	1980'	1350'		
Cement	1350'	1250'		
Gel	1250'	1130'		
Cement	1130'	930'		
Gel	930'	700'		
Cement	700'	600'		
Gel	600'	300'		
Cement	*300'	Surface		

*Perf'd 10 holes in 10-3/4" casing 255'-265'
Description of monument: 6" installed in wellbore with plaque
and that the work of plugging and filling said well was completed on the 9th day of October, 1994.

And further deponents saith not.

Bill Shreve

Sworn and subscribe before me this 9th day of OCTOBER, 1994
My commission expires: June 17, 1994

Notarial Seal
Cynthia M. Bowles, Notary Public
Charters Twp., Washington County
My Commission Expires June 17, 1996

Kevin Shreve
Cynthia M. Bowles
Notary Public