

38° 32' 30"

Latitude 38° 35'

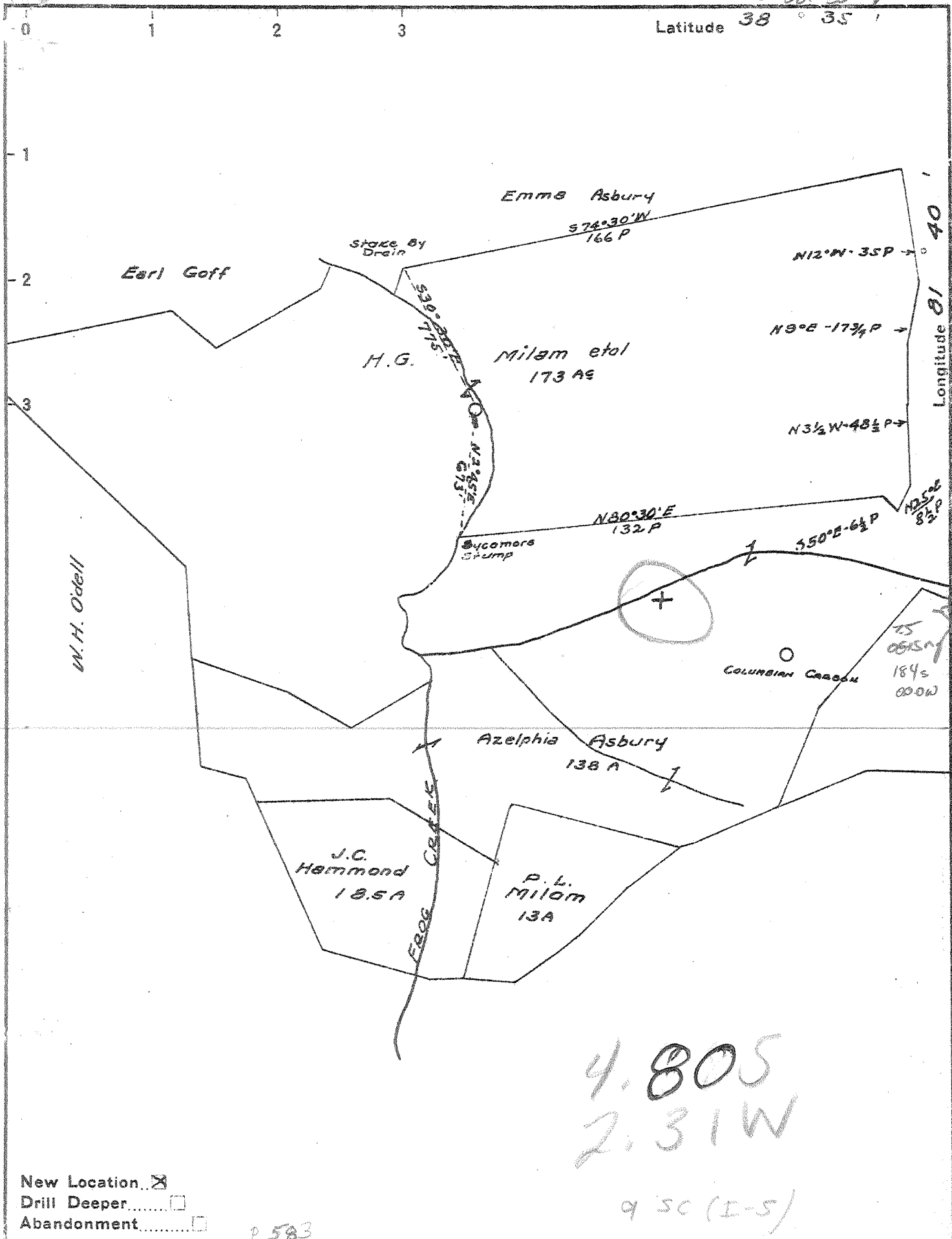

New Location
 Drill Deeper
 Abandonment

p 583

Company Godfrey L Cabot Inc
 Address 900 Union Bldg Charleston W.Va
 Farm H.G. Milam et al
 Tract _____ Acres 173 Lease No. 3-852
 Well (Farm) No. 1 Serial No. 1100
 Elevation (Spirit Level) 615.13
 Quadrangle Kenna - SW Sissonville
 County Kanawha District Union
 Engineer Roy Boston
 Engineer's Registration No. _____
 File No. _____ Drawing No. _____
 Date 4-9-43 Scale 1" = 660

STATE OF WEST VIRGINIA
 DEPARTMENT OF MINES
 OIL AND GAS DIVISION
 CHARLESTON

WELL LOCATION MAP
 FILE NO. KAN-1017

+ Denotes location of well on United States Topographic Maps, scale 1 to 62,500, latitude and longitude lines being represented by border lines as shown.

- Denotes one inch spaces on border line of original tracing.

"IMPERIAL" TRACING CLOTH
 K & E CO., N. Y.

6-6-192 Deepwell

WEST VIRGINIA DEPARTMENT OF MINES
OIL & GAS DIVISION
W E L L R E C O R D

Permit No. Kan 1017

Gas Well
CASING & TUBING

Kenna Quad.

Company

Godfrey L. Cabot, Inc.

Address

Charleston, W.Va.

Farm

H.G. Milam et al Acres

Location

Well No

District

Surface

Mineral

Commenced

Completed

Date shot

Volume

Rock Pressure

Salt Water

13 3/8 48# 125 Same

10 3/8 35.75# 420 "

8 5/8 25.55# 1703 "

One ser. 1100 Elev. 615.13 7 24# 4597 4593

Union Kanawha County 2 3/8 3.75# 4731 Same

13 3/8 1/2 Coupling shoe

June 1, 1943 10 3/8 " " 2

Sept. 23, 1943 #20715 * 1-85/8 x 10 3/8" 24# B.H.P.

9-24-43 Depth 4669 to 4689 with

40 qts. #20754 * 1 " " " "

822 MCF A.S.- 60 Mins.; B.S. 193M

1300 lbs. 40 hrs. Oriskany 1-7 x 85/8" 24# Lead

1160' H.F.; 1645' 2 1/2 blrs. pr. hr. B.H. Packer

#20962 and 40 sacks aquagel

2 3/8 RCW Line Pipe. Bottom

joint welded.

Best Gauge Oriskany 4670-4676 561 MCF

Perf. top bot

4687 4695

4729 4731

Red Rock

0 25

Gas 1570 Show of gas

Shale

25 75

Gas 1645 increase of Gas

Lime Sand

75 100

Shale

100 125

* 8" casing run at 1537' original

Sand

125 220

casing point casing pulled. Rerun

Red Rock

220 230

at 1703'

Shale

230 250

casing line cut, pulled and rerun

Oil Shale

250 260

at 1703'

White Shale

260 350

Sand

350 415

GAUGES IN ORISKANY

Shale

415 500

Lime

500 525

4670

133M

Shale

525 535

4672

158M

Sand

535 575

4673

169M

Black Slate

575 590

4676

561M

Sand

590 670

4679

227 M

White Slate

670 690

4720

212M

Black Slate

690 700

4723

190M

Shale

700 770

4733

193M

Sand

770 800

Shale

800 940

GAUGES IN ORISKANY SAND AFTER SHOT

(gauge before shot 193 M)

Salt Sand

940 1516

Big Lime

1516 1627

Injun Sand

1627 1682

5 Min. A.S.

949 M

Slate & Shells

1682 2069

10 Min. A.S.

919 M

Shale

2069 2079

15 " "

919 M

Zerea Grit

2079 2089

20 " "

855 M

Slate & Shells

2089 3350

60 " "

822 M

Brown Shale

3350 3385

Slate & Shells

3385 3550

Brown Shale

3550 3910

Big White Slate

3910 4300

Slate & Shells

4300 4490

White Slate

4490 4520

Brown Shale

4520 4576

Corniferous Lime

4576 4665 SLM

Oriskany Sand

4665 4728 SLM

Black Lime

4728

TOTAL DEPTH

4733

Search Page

Disclaimer:

Per §22-6-6. Permit required for all well work; permit fee; application; soil erosion control plan.

(a) It is unlawful for any person to commence any well work, including site preparation work, which involves any disturbance of land, without first securing a well work permit from the director of the WVDEP Office of Oil and Gas.

The appearance of an API number on the web page does not signify that a permit has been issued. The API number is used as a tracking mechanism until the permit has been issued. Under no circumstances should well work be commenced without a signed permit.

API	Last Permit Issue Date	Farm Name	Well Number	Operator	Status
039-01017	10/18/1943	MILAM, H. G., ETAL	1	CABOT OIL & GAS CORPORATION	Active Well

The operator listed above is the **CURRENT** operator of the well.

This operator may or may not have recorded production for this well for the years listed below.

The production listed below spans this well's entire lifetime, regardless of the operator who originally recorded a particular year's production numbers.

Well Lifetime Gas Production

Year	Jan	Feb	Mar	Apr	May	Jun	Jul	Aug	Sep	Oct	Nov	Dec	Total	Reporting Operator
2003	166	138	179	199	208	207	214	208	194	198	184	172	2,267	CABOT OIL & GAS CORPORATION
2002	196	158	157	166	203	186	194	184	189	196	182	178	2,189	CABOT OIL & GAS CORPORATION
2001	169	156	168	173	209	191	211	233	195	187	196	204	2,292	CABOT OIL & GAS CORPORATION
2000	185	206	222	205	229	213	224	221	198	213	171	126	2,413	CABOT OIL & GAS CORPORATION
1999	257	207	227	242	246	236	254	249	243	237	226	216	2,840	CABOT OIL & GAS CORPORATION
1998	231	212	224	213	214	223	219	247	238	242	250	0	2,513	CABOT OIL & GAS CORPORATION
1997	252	244	237	213	224	217	241	248	242	237	230	0	2,585	CABOT OIL & GAS CORPORATION
1996	245	252	253	257	264	264	282	289	271	281	255	261	3,174	CABOT OIL & GAS CORPORATION
1995	247	192	248	235	243	237	240	253	247	260	242	250	2,894	CABOT OIL & GAS CORPORATION
1994	195	227	257	254	268	277	274	281	265	267	254	249	3,068	CABOT OIL & GAS CORPORATION
1993	245	211	255	263	267	245	248	263	275	276	252	250	3,050	CABOT OIL & GAS CORPORATION
1992	264	213	222	304	271	320	287	273	245	246	250	247	3,142	CABOT OIL & GAS CORPORATION
1991	314	261	277	342	300	223	336	326	273	319	242	280	3,493	CABOT OIL & GAS CORPORATION
1990	298	159	273	266	304	249	256	320	281	316	281	258	3,261	CABOT OIL & GAS CORPORATION
1989	246	249	307	315	277	315	291	330	289	266	322	273	3,480	CABOT OIL & GAS CORPORATION
1988	284	274	334	314	287	352	317	330	287	275	314	270	3,638	CABOT OIL & GAS CORPORATION
1986	296	275	265	356	304	289	361	331	350	306	271	334	3,738	CABOT OIL & GAS CORPORATION

All amounts expressed in mcfg (thousand cubic feet)

No Oil Production Reported