

(+) DENOTES LOCATION OF WELL ON UNITED STATES TOPOGRAPHIC MAPS

FILE No 96X208
 DRAWING No. W-7077
 SCALE 1" = 1000'
 MINIMUM DEGREE OF ACCURACY 1 : 200
 PROVEN SOURCE OF ELEVATION EXISTING WELL

I, THE UNDERSIGNED, HEREBY CERTIFY THAT THIS PLAT IS CORRECT TO THE BEST OF MY KNOWLEDGE AND BELIEF AND SHOWS ALL THE INFORMATION REQUIRED BY LAW AND THE REGULATIONS ISSUED AND PRESCRIBED BY THE DEPARTMENT OF MINES

(SIGNED) Mark C. Shamblin

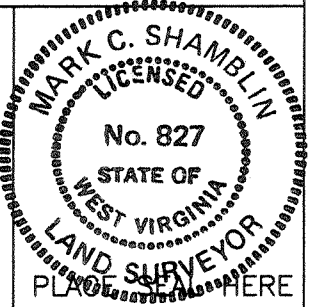

P.E. _____ R.P.S. 827

DEPARTMENT OF ENVIRONMENTAL PROTECTION
 OFFICE OF OIL & GAS
 #10 McJUNKIN ROAD
 NITRO, WEST VIRGINIA 25143-2506



DATE DECEMBER 3, 19 96
 OPERATOR'S WELL No. W-7077
 API WELL No.

WELL TYPE: OIL GAS LIQUID INJECTION WASTE DISPOSAL STATE 47 COUNTY 039 PERMIT 01236

LOCATION: ELEVATION 779.0 WATER SHED BLUE CREEK
 DISTRICT ELK COUNTY KANAWHA
 QUADRANGLE BLUE CREEK, 7.5' COORDINATES Lat: 38°-23'-32" Long: 81°-24'-53"

SURFACE OWNER BEULAH FARR, ETAL ACREAGE 372 AC
 OIL & GAS ROYALTY OWNER ALFRED PHILLIPS LEASE ACREAGE 14.335AC
 LEASE No. 14335

PROPOSED WORK: DRILL CONVERT DRILL DEEPER REDRILL FRACTURE OR STIMULATE PLUG OFF OLD FORMATION PERFORATE NEW FORMATION OTHER PHYSICAL CHANGE IN WELL (SPECIFY) Drill existing storage well deeper - 160' STORAGE RECONDITION

PLUG AND ABANDON CLEAN OUT AND REPLUG
 TARGET FORMATION Crinoid ESTIMATED DEPTH 5150' Drilled in 1946.
 WELL OPERATOR COLUMBIA GAS TRANSMISSION CORP. DESIGNATED AGENT RICHARD L. COTY
 ADDRESS P.O. 1273 CHARLESTON, WV 25325 ADDRESS P.O. BOX 1723 CHARLESTON, WV 25325

DEEP WELL

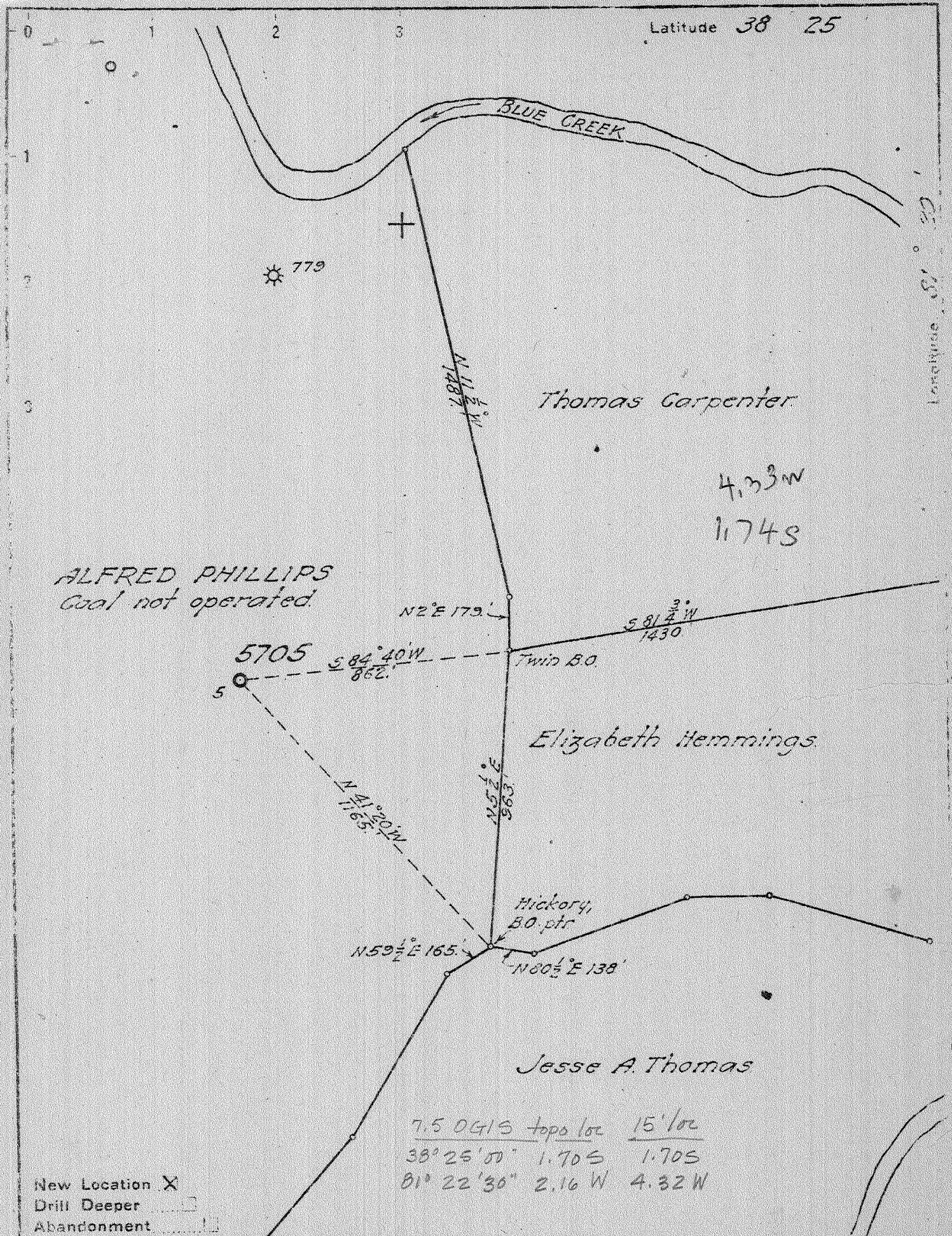

Company UNITED FUEL GAS CO.
 Address CHARLESTON W.VA.
 Farm ALFRED PHILLIPS
 Tract _____ Acres 446 1/4 Lease No. 14335
 Well (Farm) No. 5 Serial No. 5705
 Elevation (Spirit Level) 779.0 ft.
 Quadrangle CLENDENIN
 County KANAWHA District ELK
 Engineer G.A. Cunningham
 Engineer's Registration No. 659
 File No. 72-61 Drawing No. _____
 Date July 5, 1945 Scale 1" = 400'

STATE OF WEST VIRGINIA
 DEPARTMENT OF MINES
 OIL AND GAS DIVISION
 CHARLESTON

WELL LOCATION MAP
 FILE NO. KAN-1236

+ Denotes location of well on United States Topographic Maps, scale 1 to 62,500, latitude and longitude lines being represented by border lines as shown.

- Denotes one inch spaces on border line of original tracing.

(risk)

Deep Well



STATE OF WEST VIRGINIA
DEPARTMENT OF MINES
OIL AND GAS DIVISION

WELL RECORD

Permit No. KAN-1236

Oil or Gas Well Gas
(KIND)

Company United Fuel Gas Company
Address P.O.Box 1273, Charleston 25, W. Va.
Farm Alfred Phillins Acres 446-1/4
Location (waters) Blue Creek
Well No. 6543 (Now X-52A-7077) Elev. 779 L
District Elk County Kanawha
The surface of tract is owned in fee by _____
Address _____
Mineral rights are owned by _____
Address _____
Drilling commenced Not Given
Drilling completed 12-13-46
Date Shot Not shot From _____ To _____
With _____
Open Flow 120/10ths Water in 7 Inch
_____ /10ths Merc. in _____ Inch
Volume 4,635 M - (Oriskany) Cu. Ft.
Rock Pressure 980 lbs. 52 hrs.
Oil _____ bbls., 1st 24 hrs.
Fresh water 420 feet _____ feet
Salt water 718, 753, 1400 feet _____ feet

Casing and Tubing	Used in Drilling	Left in Well	Packers
Size			Kind of Packer
16			
18			
10	1142	1142	Size of
2 1/4 7"	4938	4938	Depth set
6 1/2			
5 3/16			
3			Perf. top
2			Perf. bottom
Liners Used			Perf. top
			Perf. bottom

CASING CEMENTED _____ SIZE _____ No. Ft. _____ Date _____
COAL WAS ENCOUNTERED AT _____ FEET _____ INCHES
_____ FEET _____ INCHES FEET _____ INCHES
_____ FEET _____ INCHES FEET _____ INCHES

Formation	Color	Hard or Soft	Top	Bottom	Oil, Gas or Water	Depth Found	Remarks
Surface			0	5			
Gravel			5	22			
Sand			22	24			
Slate			24	75			
Sand			75	144			
Slate			144	166			
Sandy Lime			166	185			
Slate			185	188			
Sand			188	290			
Slate & Shells			290	343			
Sandy Lime			343	370			
Slate			370	462	Water	420'	
Sand			462	475			
Slate			475	480			
Sandy Lime			480	495			
Slate & Shells			495	520			
Sand			520	540			
Lime			540	607			
Slate			607	613			
Slate			613	643			
Lime Shells			643	655			
Slate			655	665			
Salt Sand			665	678			
Slate & Cave			678	994	Water	718'	
					Water	753'	
Sand			994	1000			
Red Rock			1000	1084			
Slate & shells			1084	1140			
Red Rock			1140	1151			
Slate & Shells			1151	1167			
Red Rock			1167	1177			
Slate & Shells			1177	1183			
Lime			1183	1203			
Slate			1203	1226			
Mazon			1226	1231			
Slate			1231	1251			
Little Lime			1251	1264			
Slate			1264	1300			
Lime Shells			1300	1302			

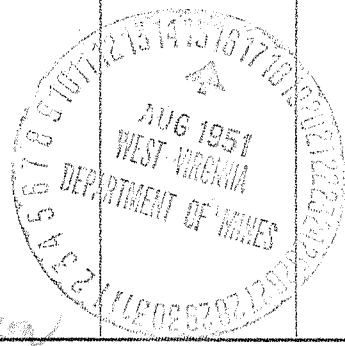

Formation	Color	Hard or Soft	Top	Bottom	Oil, Gas or Water	Depth Found	Remarks
Slate			1302	1308			
Lime			1308	1310			
Pencil Cave			1310	1317	Water	1400'	
Big Lime			1317	1470	Gas	1475'	
Injun			1470	1532			
Slate & Shells			1532	1712			
Brown Shale			1712	3810			
Wht. Slate			3810	3900			
Br. Shale			3900	4916			
Corniferous Sand (Oriskany)			4916	5021			
			5021	5044	Gas	5037-5044'	120/10 W 7" 24# 4,635 M
Total depth			5044'				
					Not Shot		
					Open Flow: 4,635 M		
					52 Hr. Rock Pressure	980#	

Date August 15, 19 51

APPROVED UNITED FUEL GAS COMPANY, Owner

By [Signature] (Title)

SURFACE AND COAL OWNERS

039-1236

Beulah Marie Farr
2102 Beverly St.
Parkersburg, WV 26103

Linda Lou Lenkey
1020 Glen Road
Charleston, WV 25314

Nora Louise Creasey
1020 Glen Road
Charleston, WV 25314

Dudley Yewell Johnson
1020 Glen Road
Charleston, WV 25314

RECEIVED
WV Division of
Environmental Protection
JAN 21 1997

Permitting
Office of Oil & Gas

State of West Virginia
Division of Environmental Protection
Section of Oil and Gas

Well Operator's Report of Well Work

Farm name: FARR, BEULAH ETAL.

Operator Well No.: 7077

LOCATION: Elevation: 779.00

Quadrangle: BLUE CREEK

District: ELK

County: KANAWHA

Latitude: 8900 Feet South of 38 Deg. 25Min. 0 Sec.

Longitude 11450 Feet West of 81 Deg. 22 Min. 30 Sec.

Company: COLUMBIA GAS TRANSMISSION
P. O. BOX 1273
CHARLESTON, WV 25325-1273

Agent: RICHARD L. COTY

Inspector: CARLOS HIVELY
Permit Issued: 01/13/97
Well work Commenced: 08-11-97
Well work Completed: 12-22-97
Verbal Plugging
Permission granted on: _____
Rotary X Cable _____ Rig
Total Depth (feet) 5105'
Fresh water depths (ft) _____
Not reported
Salt water depths (ft) _____
420', 718', 753', 1400'
Is coal being mined in area (Y/N)? No
Coal Depths (ft): Not reported

Casing & Tubing Size	Used in Drilling	Left in Well	Cement Fill Up Cu. Ft.
10 3/4"		1149'	
7"		4938'	
5 1/2"		4958'	100 SX
2 3/8"		4995'	

OPEN FLOW DATA

Producing formation ORISKANY STORAGE Pay zone depth (ft) 5021' = 5044
 Gas: Initial open flow _____ MCF/d Oil: Initial open flow _____ Bbl/d
 Final open flow _____ MCF/d Final open flow _____ Bbl/d
 Time of open flow between initial and final tests _____ Hours
 Static rock Pressure _____ psig (surface pressure) after _____ Hours

Second producing formation _____ Pay zone depth (ft) _____
 Gas: Initial open flow _____ MCF/d Oil: Initial open flow _____ Bbl/d
 Final open flow _____ MCF/d Final open flow _____ Bbl/d
 Time of open flow between initial and final tests _____ Hours
 Static rock Pressure _____ psig (surface pressure) after _____ Hours

NOTE: ON BACK OF THIS FORM PUT THE FOLLOWING: 1). DETAILS OF PERFORATED INTERVALS, FRACTURING OR STIMULATING, PHYSICAL CHANGE, ETC. 2). THE WELL LOG WHICH IS A SYSTEMATIC DETAILED GEOLOGICAL RECORD OF ALL FORMATIONS, INCLUDING COAL ENCOUNTERED BY THE WELLBORE.

For: COLUMBIA GAS TRANSMISSION CORP.

By: *[Signature]*
Date: 1-15-98

JAN 23 1998

Pulled 4994' of 2 3/8" tubing. Replaced top 1704' of 5 1/2" casing, installed new 7" x 5 1/2" API 3000 wellhead, drilled new 6 1/8" hole 5044' - 5105', stimulated ORISKANY with N2 - assist Deltafrac using 489 bbls water, 133 MSCF N2, and 27,800 lbs 20/40 sand, and ran 4995' of 2 3/8" tubing.

Table with multiple rows and columns, containing faint data entries.

Table with multiple rows and columns, containing faint data entries.

Additional text and faint data entries at the bottom of the page.

Handwritten signature or initials at the bottom center of the page.

STATE OF WEST VIRGINIA
DIVISION OF ENVIRONMENTAL PROTECTION, OFFICE OF OIL AND GAS
WELL WORK PERMIT APPLICATION

- 1) Well Operator: Columbia Gas¹⁷⁵ Transmission Corp. 10450 258
- 2) Operator's Well Number: 7077 3) Elevation: 779
- 4) Well type: (a) Oil ___ / or Gas X / *Issued 01/13/97*
Expires 01/13/99
 (b) If Gas: Production ___ / Underground Storage X /
 Deep X / Shallow ___ /
- Proposed Target Formation(s): Oriskany⁴⁷⁵ Sandstone
- Proposed Total Depth: 5150 feet
- Approximate fresh water strata depths: 420'
- 8) Approximate salt water depths: 718', 753', 1400'
- 9) Approximate coal seam depths: N/A
- 10) Does land contain coal seams tributary to active mine? Yes ___ / No X /
- 11) Proposed Well Work: Install API 3000 wellhead. Drill well
100' deeper. Log. Stimulate Oriskany. Install tubing if needed.
- 12)

CASING AND TUBING PROGRAM

TYPE	SPECIFICATIONS		FOOTAGE INTERVALS		CEMENT	
	Size	Grade	Weight per ft.	For drilling		Left in well
Conductor						
Fresh Water	10 3/4"		32.75	1149'	1149'	<i>Ejecture</i>
Coal						
Intermediate	7"		22	4938'	4938'	
Production	5 1/2"		17	4958'	4958'	100 sks
Tubing	2 3/8"		4.6	5044'	5044'	
Liners		C.H. 10-22-96				

PACKERS : Kind _____
 Sizes _____
 Depths set _____

For Office of Oil and Gas Use Only

Fee(s) paid: Well Work Permit Reclamation Fund WPCP
 Plat WW-9 WW-2B Bond Blanket Agent
 (Type)

RECEIVED
 Division of Environmental Protection
 DEC 27 1996
 Permitting Office of Oil & Gas

23041

00171760
42

RECEIVED
WV Division of
Environmental Protection
DEC 27 1996

Permitting
Office of Oil & Gas

- 1) Date: 10/29/96
- 2) Operator's well number
COCO- WELL # 7077
- 3) API Well No: 47 - 039 - 01236 - D D
State - County - Permit

STATE OF WEST VIRGINIA - BUREAU OF ENVIRONMENT
DIVISION OF ENVIRONMENTAL PROTECTION
OFFICE OF OIL AND GAS

NOTICE AND APPLICATION FOR A WELL WORK PERMIT

- 4) Surface Owner(s) to be served:
 - a) Name (see attached sheet)
Address _____
 - b) Name _____
Address _____
 - c) Name _____
Address _____
- 6) Inspector Carlos W. Hiviely
Address 223 Pinch Ridge Road
Elkview, WV 25071
Telephone (304) - 965-6069

- 5) (a) Coal Operator:
Name _____
Address _____
- (b) Coal Owner (s) with Declaration
Name (see attached sheet)
Address _____
- Name _____
Address _____
- (c) Coal Lessee with Declaration
Name _____
Address _____

TO THE PERSON(S) NAMED ABOVE TAKE NOTICE THAT:

_____ Included is the lease or leases or other continuing contract or contracts by which I hold the right to extract oil and gas OR
 X Included is the information required by Chapter 22, Article 6, Section 8(d) of the Code of West Virginia (see page 2)

I certify that as required under Chapter 22 of the West Virginia Code I have served copies of this notice and application, a location plat, and accompanying documents pages 1 through _____ on the above named parties, by:

- _____ Personal Service (Affidavit attached)
- X Certified Mail (Postmarked postal receipt attached)
- _____ Publication (Notice of Publication attached)

I have read and understand Chapter 22-6 and 38 CSR 11-18, and I agree to the terms and conditions of any permit issued under this application.

I certify under penalty of law that I have personally examined and am familiar with the information submitted on this application form and all attachments, and that based on my inquiry of those individuals immediately responsible for obtaining the information, I believe that the information is true, accurate, and complete.

I am aware that there are significant penalties for submitting false information, including the possibility of fine and imprisonment.

Well Operator COLUMBIA GAS TRANSMISSION CORP.
By: [Signature]
Its: Storage Engineer / Well Services
Address P. O. Box 1808
St. Albans, WV 25177-1808
Telephone (304) 722-8612

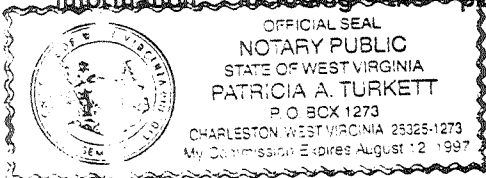

Subscribed and sworn before me this 4th day of November, 19 96

Patricia A. Turkett Notary Public
My commission expires August 12, 1997

*Copy of Lease
in Room City
Office*