

(+) DENOTES LOCATION OF WELL ON UNITED STATES TOPOGRAPHIC MAPS

FILE No 1601-2345-002
 DRAWING No. 1601-2345-002
 SCALE 1"=400'
 MINIMUM DEGREE OF ACCURACY 1:200
 PROVEN SOURCE OF ELEVATION TRIMBLE R8-3
GPS UNIT

I THE UNDERSIGNED, HEREBY CERTIFY THAT THIS PLAT IS CORRECT TO THE BEST OF MY KNOWLEDGE AND BELIEF AND SHOWS ALL THE INFORMATION REQUIRED BY LAW AND THE REGULATIONS ISSUED AND PRESCRIBED BY THE DIVISION OF ENVIRONMENTAL PROTECTION.

(SIGNED) R. F. Thaw
 ROBERT F. THAW PS #965

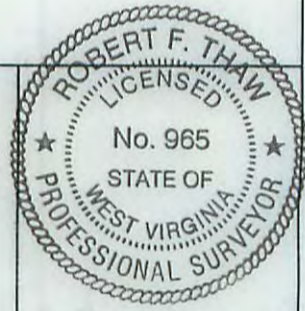

PLACE SEAL HERE

STATE OF WEST VIRGINIA
 DIVISION OF ENVIRONMENTAL PROTECTION
 OFFICE OF OIL AND GAS
 NITRO, WV



DATE FEBRUARY 10 20 16
 OPERATOR'S WELL No. 7043
 API WELL No.

WELL TYPE: OIL GAS X LIQUID INJECTION WASTE DISPOSAL STATE 47 COUNTY 039 PERMIT 01264W
 (IF "GAS") PRODUCTION STORAGE X DEEP X SHALLOW
 LOCATION: ELEVATION 896.2' WATER SHED PINCH CREEK
 DISTRICT ELK COUNTY KANAWHA
 QUADRANGLE BLUE CREEK, WV

SURFACE OWNER EUGENE & JOSEPHINE SPANGLER ACREAGE 16.37
 OIL & GAS ROYALTY OWNER L. H. GILLISPIE, ET AL LEASE ACREAGE 109
 LEASE No. 1000924-000

PROPOSED WORK: DRILL CONVERT DRILL DEEPER REDRILL FRACTURE OR STIMULATE X PLUG OFF OLD FORMATION PERFORATE NEW FORMATION OTHER PHYSICAL CHANGE IN WELL (SPECIFY) **03/18/2016**

PLUG AND ABANDON CLEAN OUT AND REPLUG
 TARGET FORMATION ORISKANY ESTIMATED DEPTH 5320
 WELL OPERATOR COLUMBIA GAS TRANSMISSION, LLC DESIGNATED AGENT PAUL AMICK
 ADDRESS PO BOX 1273, CHARLESTON, WV 25325-1273 ADDRESS P.O. BOX 1273, CHARLESTON W.V. 25325-1273

FORM IV-6 (8-78)

Coco B well 7043

WV DEP Reclamation Plan 1 or 2 - Access Road Detail

- BMPs to be utilized per WV DEP guidelines
- Existing drainage, culverts, and road ditches to be maintained
- Minor grading and road surfacing material to be applied as needed

