

8350'

LATITUDE 38°32'30"

TM-5 PAR 17

TM-5 PAR 18

TM-5 PAR 16.1

NOTES:

This Map Is For Well Location Only & Does Not Represent A Complete Property Survey. Location Determined By Differential GPS.

3/4" Iron Rod Found In Low Gap At Call Of Set Stone

GAS WELL #7280 (47-039-01618)

GAS WELL #7157 (47-039-01466)

WALTER & NAOMI ROBERTSON DB 1532 PG 245 TM-9 PAR 54

DONALD R. & BONNIE L. GODBEY DB 2392 PG 783 TM-9 PAR 54.1

GAS WELL #7152 (47-039-01383)

HAROLD PAXTON DB 1274 PG 71 TM-9 PAR 58

JEFFREY W. & SARAH H. JARRETT DB 2234 PG 633 TM-9 PAR 22.1

JOHN & REVA EDENS DB 980 PG 335 TM-9 PAR 22

JAMES F. JORDON DB 2402 PG 694 TM-9 PAR 38

JERRY L. & TERRESA E. HASH DB 1573 PG 495 TM-9 PAR 55

(+) DENOTES LOCATION OF WELL ON UNITED STATES TOPOGRAPHIC MAPS (7 1/2)

FILE NO. _____ DRAWING NO. 7152 SCALE 1" = 400 MINIMUM DEGREE OF ACCURACY 1/200' PROVEN SOURCE OF ELEVATION Standard Disc. Marked R-95, On SW Headwall Of Concrete Culvert

I THE UNDERSIGNED, HEREBY CERTIFY THAT THIS PLAT IS CORRECT TO THE BEST OF MY KNOWLEDGE AND BELIEF AND SHOWS ALL THE INFORMATION REQUIRED BY LAW AND THE REGULATIONS ISSUED AND PRESCRIBED BY THE DEPARTMENT OF ENERGY (SIGNED) [Signature]

R.P.E. _____ L.L.S. 798

PLACE SEAL HERE

STATE OF WEST VIRGINIA DIVISION OF ENVIRONMENTAL PROTECTION SECTION OF OIL & GAS



DATE April 16, 2001 OPERATOR'S WELL NO. 7152 API WELL NO. _____

WELL TYPE: OIL ___ GAS X LIQUID INJECTION ___ WASTE DISPOSAL ___ STATE 47 COUNTY 039 PERMIT 01383 F (IF "GAS,") PRODUCTION ___ STORAGE X DEEP ___ SHALLOW ___

LOCATION: ELEVATION 789.00' WATER SHED Patterson Fork Of Little Sandy Creek DISTRICT Elk COUNTY Kanawha QUADRANGLE Kettle, WV COORDINATES LAT: 38°31'03" LONG: 81°29'16"

SURFACE OWNER Walter & Naomi Robertson ACREAGE 83.5 ORIGINAL OIL & GAS ROYALTY OWNER D. M. Canterbury Et Al. LEASE ACREAGE 347 COAL OWNER Dorothy F. Edens, Et Al. LEASE NO. 1013790

PROPOSED WORK: DRILL ___ CONVERT ___ DRILL DEEPER ___ REDRILL ___ FRACTURE OR STIMULATE ___ PLUG OFF OLD FORMATION ___ PERFORATE NEW FORMATION ___ OTHER PHYSICAL CHANGE IN WELL (SPECIFY) Storage Recondition

PLUG AND ABANDON ___ CLEAN OUT AND REPLUG ___

TARGET FORMATION _____ ESTIMATED DEPTH _____ WELL OPERATOR COLUMBIA GAS TRANSMISSION CORP DESIGNATED AGENT PAUL AMICK ADDRESS PO Box 1273, Charleston, WV 25325-4273 ADDRESS PO Box 1273, Charleston, WV 25325-1273

KANAWHA COUNTY NAME PERMIT 1383

JUN -1 2001

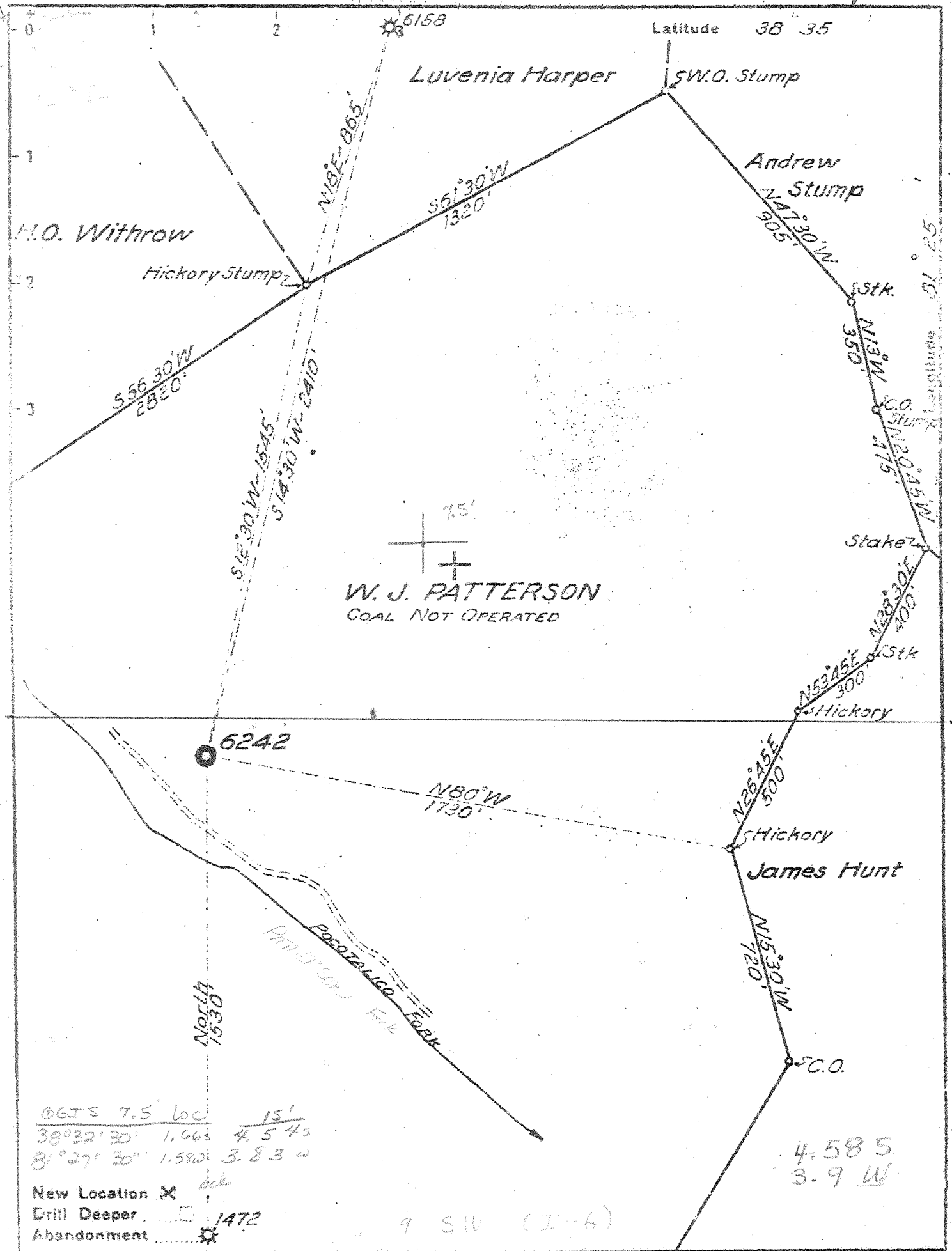

OGIS 7.5' loc 15'
 38°32'30" 1.663 4.545
 81°27'30" 1.592 3.830
 New Location
 Drill Deeper 1472
 Abandonment

9 SW (I-6)

4.585
 3.9 W

Company UNITED FUEL GAS CO.
 Address CHARLESTON, W. VA.
 Farm W. J. PATTERSON
 Tract _____ Acres 347 Lease No. 13790
 Well (Farm) No. 3 Serial No. 6242
 Elevation (Spirit Level) 789.7'
 Quadrangle WALTON - SW
 County KANAWHA District FLK
 Engineer [Signature]
 Engineer's Registration No. 662
 File No. 68-69 Drawing No. _____
 Date SEPT. 5, 1947 Scale 1"=400'

STATE OF WEST VIRGINIA
 DEPARTMENT OF MINES
 OIL AND GAS DIVISION
 CHARLESTON

WELL LOCATION MAP
 FILE NO. KAN-1383-#6242

+ Denotes location of well on United States Topographic Maps, scale 1 to 62,500, latitude and longitude lines being represented by border lines as shown.

- Denotes one inch spaces on border line of original tracing.

609 1942
 Deep Well

WEST VIRGINIA DEPARTMENT OF MINES
OIL & GAS DIVISION
W E L L R E C O R D

Gas Well
CASING & TUBING

Permit No. Kan 1383				
Walton Quad.				
Company	United Fuel Gas Co.			
Address	P.O. Box 1273, Charleston 25, W.Va.	14	35	35
Farm	W.J. Patterson Acres 347	10 $\frac{3}{4}$	339	339
Location	Pocatalico Fk. of Little Sandy	8 5/8	1367	1567
Well No.	6242 Elev. 789.6 Gr.	7	4989	4989
District	Elk Kanawha County			
Surface				
Mineral	N.J. Fogarty et al, Kan. Valley Bank Chas., W.Va.		Coal at 472'	96"
Commenced	9-22-47			
Completed	12-24-47			
Not shot				
Rock Pressure	1300 lbs. 16 hrs.			
Fresh Water	467' 1 BFH; 1120' H.F.			

Surface	0	10	
Red Rock	10	70	
Slate	70	112	
Lime	112	140	
Red Rock	140	180	
Lime	180	232	
Slate	232	256	
Sand	256	265	
Slate	265	338	
Lime	338	370	
Slate & Shells	370	392	
Sand	392	430	
Slate	430	443	
Sand	443	472	
Coal	472	480	<i>No. 10 Black</i>
Lime	480	490	
Slate	490	562	
Sand	562	600	
Slate	600	710	
Sand	710	812	
Slate	812	900	
Sand	900	925	
Slate & Shells	925	992	
Sand	992	1036	
Slate	1036	1056	
Sand	1056	1503	
Slate	1503	1505	
Little Lime	1505	1548	
Pencil Cave	1548	1551	
Big Lime	1551	1688	
Injun Sand	1688	1728	
Slate & Shells	1728	2146	Gas 1690-1696 Injun show
Berea Sand	2146	2158	
Slate & Shells	2158	3312	
Brown Shale	3312	3415	
Slate & Shells	3415	3732	
Brown Shale	3732	4030	
Slate, White	4030	4552	
Brown Shale	4552	4972	
Corniferous Lime	4972	5098	
Oriskany Sand	5098	5115	Gas 5106-5115 Oriskany
Total Depth		5115	