



West Virginia Department of Environmental Protection
Office of Oil and Gas
WELL LOCATION FORM: GPS

API: 47-039-1452 ^P WELL NO.: 323
FARM NAME: Williams Coal
RESPONSIBLE PARTY NAME: Gary E. Acord
COUNTY: Kanawha DISTRICT: Cabin Creek
QUADRANGLE: Esk-dale
SURFACE OWNER: Shonk Land Company
ROYALTY OWNER: Shonk Land Company
UTM GPS NORTHING: 4217971.976
UTM GPS EASTING: 456341.618 GPS ELEVATION: 1370.58 feet

The Responsible Party named above has chosen to submit GPS coordinates in lieu of preparing a new well location plat for a plugging permit or assigned API number on the above well. The Office of Oil and Gas will not accept GPS coordinates that do not meet the following requirements:

1. Datum: NAD 1983, Zone: 17 North, Coordinate Units: meters, Altitude: height above mean sea level (MSL) – meters.
2. Accuracy to Datum – 3.05 meters
3. Data Collection Method:
Survey grade GPS X : Post Processed Differential _____
Real-Time Differential _____
Mapping Grade GPS _____: Post Processed Differential _____
Real-Time Differential _____

4. Letter size copy of the topography map showing the well location.

I the undersigned, hereby certify this data is correct to the best of my knowledge and belief and shows all the information required by law and the regulations issued and prescribed by the Office of Oil and Gas.

Gary E. Acord
Signature

ENGINEER
Title

4/13/12
Date

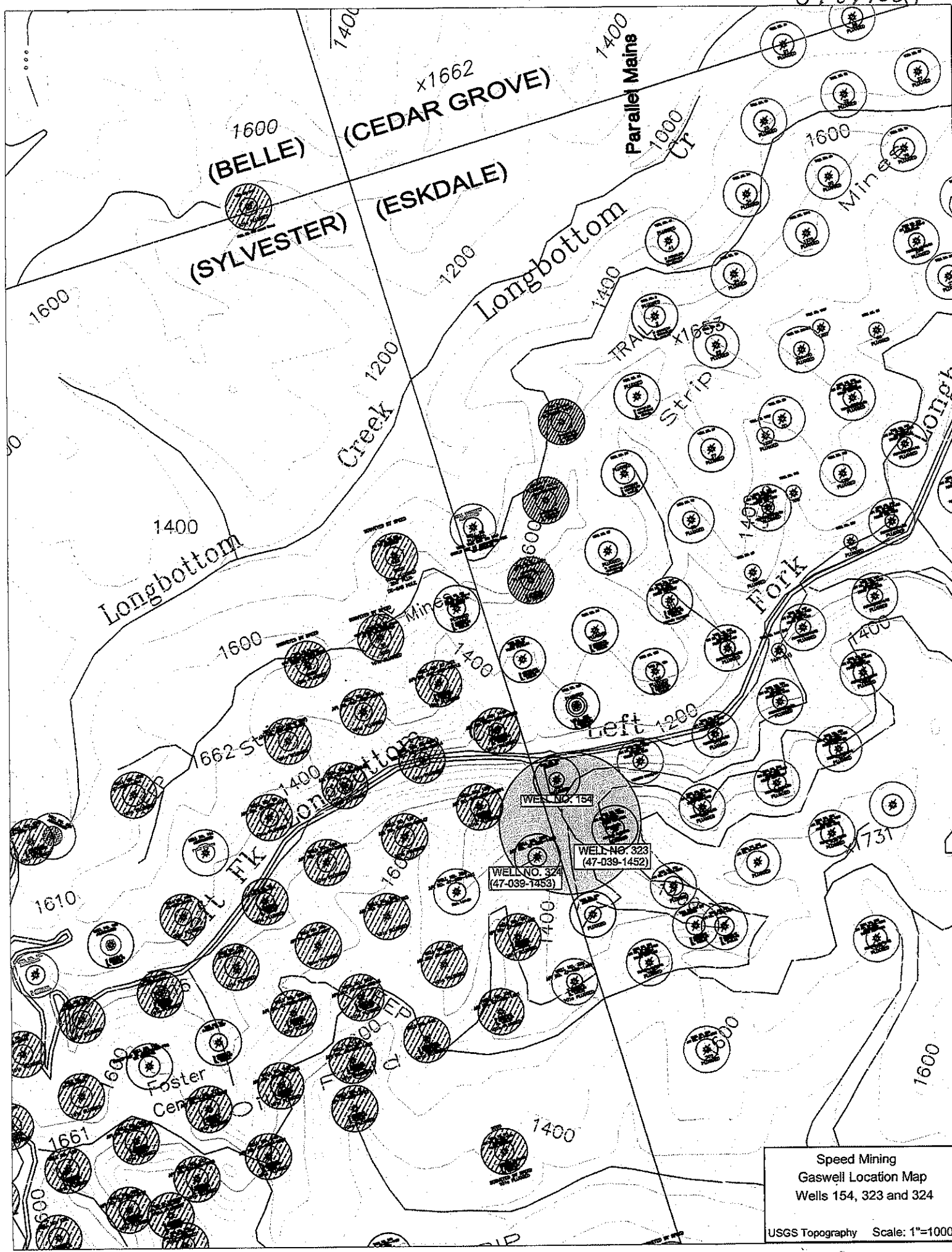

Speed Mining
 Gaswell Location Map
 Wells 154, 323 and 324
 USGS Topography Scale: 1"=1000'