

FRAC 9/10/75
 New Location
 Drill Deeper
 Abandonment

Company Columbia Gas Trans. Corp.
 Address CHARLESTON, W. VA.
 Farm C.J. HUNT
 Tract _____ Acres 946 Lease No. 27480
 Well (Farm) No. 52 Serial No. 6480
 Elevation (Spirit Level) 1099.9
 Quadrangle CLENDENIN WC Blue Creek
 County KANAWHA District ELK
 Engineer J.A. Moore
 Engineer's Registration No. 662
 File No. 68-61 Drawing No. _____
 Date 11-3-48 Scale 1"=400'

STATE OF WEST VIRGINIA
 DEPARTMENT OF MINES
 OIL AND GAS DIVISION
 CHARLESTON

WELL LOCATION MAP
 FILE NO. KAN-1482-FRAC

+ Denotes location of well on United States Topographic Maps, scale 1 to 62,500, latitude and longitude lines being represented by border lines as shown.

- Denotes one inch spaces on border line of original tracing.

47-039

Latitude 30° 25'

Longitude 81° 25'

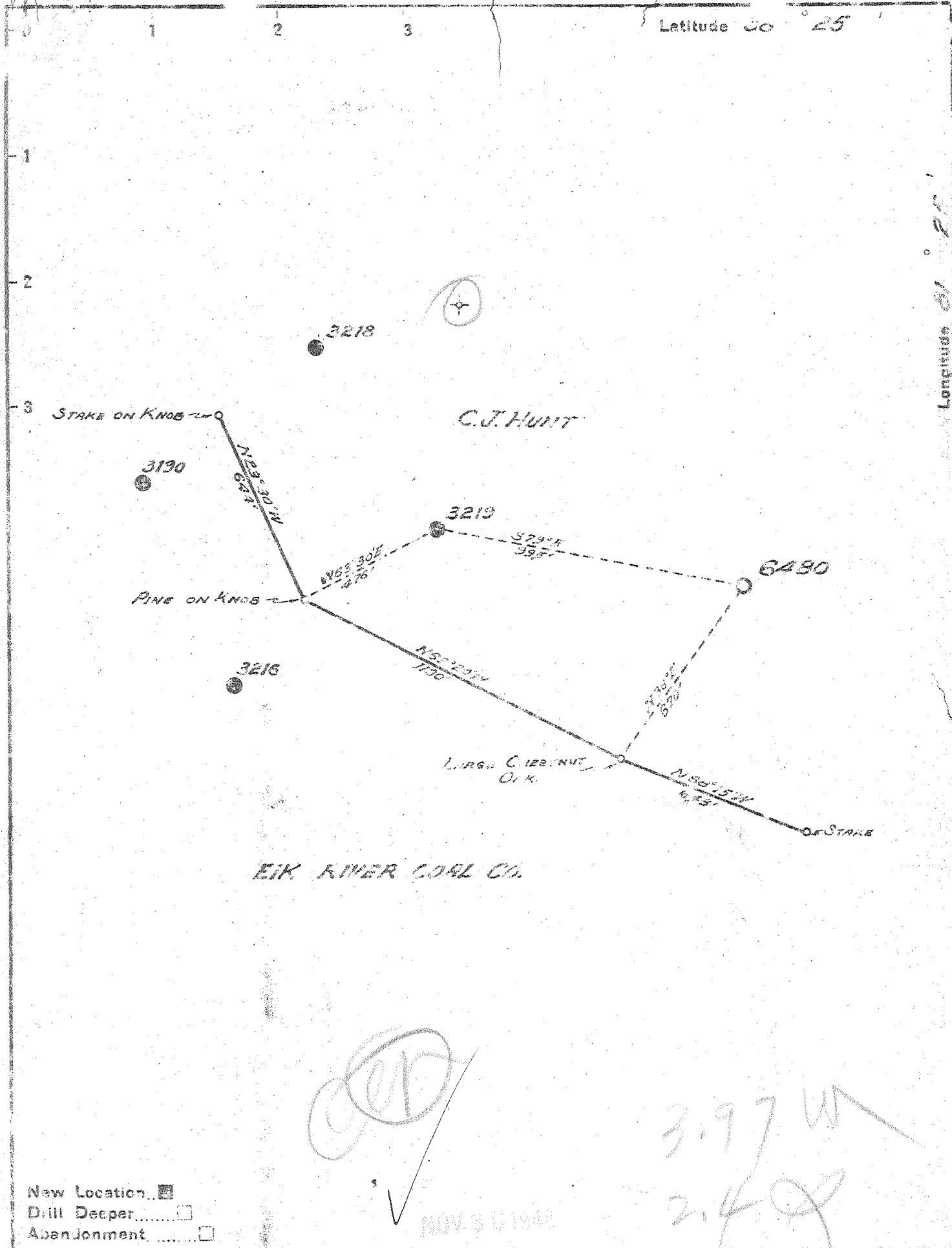

New Location
 Drill Deeper
 Abandonment

NOV 30 1948

Company UNITED FUEL GAS CO.
 Address CHARLESTON, W.VA.
 Farm C.J. HUNT
 Tract _____ Acres 945 Lease No. 27230
 Well (Farm) No. 52 Serial No. 6480
 Elevation (Spirit Level) 1099.9
 Quadrangle CLENDENIN
 County KANAWHA District ELK
 Engineer [Signature]
 Engineer's Registration No. 662
 File No. 66-51 Drawing No. _____
 Date 11-3-48 Scale 1"=400'

STATE OF WEST VIRGINIA
 DEPARTMENT OF MINES
 OIL AND GAS DIVISION
 CHARLESTON

WELL LOCATION MAP
 FILE NO. KAN-1482

Deep Well
 + Denotes location of well on United States Topographic Maps, scale 1 to 62,500, latitude and longitude lines being represented by border lines as shown.
 = Denotes one-inch spaces on border line of original tracing.

C. J. HUNT No. 52 (688) - UNITED FUEL GAS CO. - KAN-1482

2.41 S.
3.96 W.

38-25
81° 25'

4 WC (J-6)

WEST VIRGINIA DEPARTMENT OF MINES
OIL & GAS DIVISION
WELL RECORD

P.

Permit No. Kan 1482
WC-Clendenin Quad.

Gas WELL
CASING & TUBING

Company	United Fuel Gas Co.		
Farm	C.J. Hunt Acres 946	13 3/8	653 653
Location	Indian Creek	10 1/2	1725 1725
Well No.	6480 Elev. 1099.9	8 5/8	2362 Pld.
District	Elk Kanawha County	7	5246 Pld.
Surface Mineral	Marcia E. Widmer et al		
Commenced	4820 Warnell Road, Kansas City, Mo.		Coal at 545' 48";
Completed	12-27-48		554' 48"; 640' 36"
Date shot	6-1-49		
Open flow	6-21-49 Depth, 2036 to 2068		
Volume	with 300# Gnl.		
Rock Pressure	12/10ths W in 2"		
Salt Water	179 M Weir		
	120 lbs. 48 hrs.		
	1099'		

Red Rock	0	20	Slate - <i>Mollanady</i>	1935	1950
Slate	20	30	Injun Sand	1950	1965
Red Rock	30	45	Lime	1965	1975
Blue Slate	45	80	Slate	1975	1993
Red Rock	80	120	Sand - <i>SQUAW</i>	1993	2001
Lime	120	140	Lime	2001	2020
Slate	140	190	Slate	2020	2030
Lime	190	220	Weir	2030	2190
Sand	220	255	Slate	2190	2210
Slate	255	295	Lime	2210	2600
Sand	295	315	Slate & Shells	2600	4055
Slate	315	350	Brown Shale	4055	4250
Lime	350	375	Big White	4250	4721
Sand	375	410	Brown Shale	4721	5070
Slate	410	445	White Slate	5070	5102
Sand	445	475	Brown Shale	5102	5218
Lime	475	495	Corniferous	5218	5330
Slate	495	515	Criskany Sand	5330	5366
Lime	515	530	Lime	5366	5374
Sand	530	545	Criskany	5374	5398
Coal	-545	549	Lime	5398	5403
Slate	549	554	Total depth	5403	
Coal	-554	558	Filled back to 2990'		
Slate	558	585	Gas 1091-1093 show		
Sand	585	605	Gas 1997 Show in Berca		
Slate	605	640	Gas 2060 show in Weir		
Coal	-640	643	Oil 2170-2176 show in Weir		
Sand	643	705	Gas 3628-3630 show in Sl. and Shs.		
Sand	705	755	Criskany dry		
Slate	755	795	Test B.S. 2/10 W 2" 60 M		
Sand	795	815	Shot 6-21-49 with 300# gnl. 2036-2068		
Slate	815	845	Final test after shot 18/10 W 2" 179 M		
Sand	845	880	Open Flow <u>179 M Weir</u>		
Slate	880	910	48 hr. R-P. 120#		
Sand	910	955	Shut in 6-30-49 in 10 1/2" casing.		
Slate	955	1005			
Sand	1005	1050			
Slate	1050	1075			
Salt Sand	1075	1531			
Slate	1531	1547			
Red Rock	1547	1552			
Slate	1552	1560			
Sand - <i>Pass</i>	1560	1580			
Slate & Lime	1580	1640			
Red Rock	1640	1645			
Lime	1645	1690			
Slate & Lime	1690	1700			
Little Lime	1700	1740			
Slate	1740	1741			
Lime Shells	1741	1765			
Pencil Cave	1765	1773			
Big Lime	1773	1935			

5218 5330 5374

Deep Well

1975

April 27, 1984

Date

In Re: Complete Information requested below:

RECEIVED

MAY 16 1984

OIL & GAS DIVISION

DEPT. OF MINES

FRACTURE RECORD

Well Name and No: C. J. Hunt #6480

District: Elk County: Kanawha

Permit No: 039-1482-FRAC Completion Date: 9/26/75

Formation Fractured: Material: WATERFRAC - 30000# 20/40 SD

Top 1973 (INJURY)

Bottom 2137 OPEN HOLE COMP.

Rock Pressure: Test after Fracture:

Before Fracture NOT AVAILABLE Oil

After Fracture " Gas NOT AVAILABLE

Signature

Date 5/10/84

COMPANY Columbia Gas Transmission Corp. P. O. Box 1273 Charleston, West Virginia 25325

RETURN TO: Dept. Mines-Office of Oil & Gas 1615 Washington Street, East Charleston, W.Va. 25311-2192



STATE OF WEST VIRGINIA
DEPARTMENT OF MINES

RECEIVED
SEP 9 - 1975

OIL & GAS DIVISION
DEPT. OF MINES

Oil and Gas Division

OIL AND GAS WELL PERMIT APPLICATION

TO THE DEPARTMENT OF MINES,
Charleston, W. Va.

DATE September 8, 1975

Surface Owner _____

Company Columbia Gas Transmission Corporation

Address _____

Address P.O. Box 1273, Charleston, WV 25325

Mineral Owner Marcia E. Widmer

Farm C. J. Hunt Acres 964

Address 4820 Warnall Rd., Kansas City, MO

Location (waters) Indian Creek

Coal Owner Same as above

Well No. 6480 Elevation 1079.9

Address _____

District Elk County Kanawha

Coal Operator Not Operated

Quadrangle _____

Address _____

THIS PERMIT MUST BE POSTED AT THE WELL SITE

All provisions being in accordance with Chapter 22, of the W. Va. Code, the location is hereby approved for fracturing. This permit shall expire if operations ~~have not~~ commenced by 1-10-76.

Deputy Director - Oil & Gas Division

INSPECTOR TO BE NOTIFIED Martin Nichols

PH: 548-6993 ADDRESS Box 554, Clendenin, WV.

The undersigned well operator is entitled to drill upon the above named farm or tract of land for oil and gas, having fee title thereto, (or as the case may be) under grant or lease dated May 6 1909 by Charles J. Hunt made to Columbia Gas Trans. Corp. and recorded on the 6th day of August 1909, in Kanawha County, Book 17 Page 164

NEW WELL _____ DRILL DEEPER _____ REDRILL FRACTURE ~~XXXXXXXXXX~~
OIL AND GAS WELL ORIGINALLY DRILLED BEFORE JUNE 5, 1969.

The enclosed plat was prepared by a registered engineer or licensed land surveyor and all coal owners and/or operators have been notified as of the above date.

The above named coal owners and/or operator are hereby notified that any objection they wish to make, or are required to make by Section 3 of the Code, must be received by, or filed with the Department of Mines within ten (10) days. *

Copies of this notice and the enclosed plat were mailed by registered mail, or delivered to the above named coal operators or coal owners at their above shown respective address _____ day _____ before, or on the same day with the mailing or delivery of this copy to the Department of Mines at Charleston, West Virginia.

PLEASE SUBMIT COPIES OF ALL
GEOPHYSICAL LOGS DIRECTLY TO:

West Virginia Geological and Economic Survey
P. O. Box 879
Morgantown, W. Va. 26505
AC 304-296-4461

Address
of
Well Operator

Very truly yours, COLUMBIA GAS TRANSMISSION CORP.

(Sign Name) [Signature]
Director, Exploration & Development
Post Office Box 1273

Street
Charleston
City or Town
West Virginia 25325
State

*SECTION 3 . . . If no objections are filed or found by the Department of mines, within said period of ten days from the receipt of notice and plat by the department of mines, to said proposed location, the department shall forthwith issue to the well operator a permit reciting the filing of such plat, that no objections have been made by the coal operators or found thereto by the department and that the same is approved and the well operator authorized to proceed.

_____ KAN - 1482 Frac _____ PERMIT NUMBER

BLANKET BOND

THIS IS AN ESTIMATE ONLY
ACTUAL INFORMATION WILL BE SUBMITTED ON OG-10 UPON COMPLETION

PROPOSED WORK ORDER TO _____ DRILL _____ DEEPEN FRACTURE-STIMULATE _____
 DRILLING CONTRACTOR: (If Known) _____ RESPONSIBLE AGENT: _____
 NAME _____ NAME Mr. Walter Chapman _____
 ADDRESS _____ ADDRESS P.O. Box 610, Clendenin, WV 25045 _____
 TELEPHONE _____ TELEPHONE (304) 965-3317 _____
 ESTIMATED DEPTH OF COMPLETED WELL: _____ ROTARY _____ CABLE TOOLS _____
 PROPOSED GEOLOGICAL FORMATION: _____
 TYPE OF WELL: OIL _____ GAS COMB. _____ STORAGE _____ DISPOSAL _____
 RECYCLING _____ WATER FLOOD _____ OTHER _____

TENTATIVE CASING PROGRAM:

CASING AND TUBING SIZE	USED FOR DRILLING	LEFT IN WELL	CEMENT FILL UP OR SACKS - CUBIC FT.
20 - 16			
13 - 10			
9 - 5/8			
8 - 5/8			
7			
5 1/2			
4 1/2			
3			Perf. Top
2			Perf. Bottom
Liners			Perf. Top
			Perf. Bottom

APPROXIMATE FRESH WATER DEPTHS _____ FEET _____ SALT WATER _____ FEET _____
 APPROXIMATE COAL DEPTHS _____ FEET _____
 IS COAL BEING MINED IN THE AREA? _____ BY WHOM? _____

TO DRILL:

SUBMIT FIVE (5) COPIES OF OG - 1, \$100.00 PERMIT FEE, PERFORMANCE BOND AND PERMANENT COPY OF PLAT.

TO DRILL DEEPER OR REDRILL:

SUBMIT FIVE (5) COPIES OF OG - 1, SHOWING ORIGINAL PERMIT NUMBER AND PERFORMANCE BOND. ON WELLS DRILLED PRIOR TO 1929, A PERMANENT COPY OF THE PLAT AND THE ORIGINAL WELL RECORD MUST ALSO BE SUBMITTED.

TO FRACTURE - STIMULATE:

OIL AND/OR GAS WELL ORIGINALLY DRILLED BEFORE JUNE 5, 1929, FIVE (5) COPIES OG - 1, PERFORMANCE BOND, PERMANENT PLAT AND ORIGINAL WELL RECORD

OIL AND/OR GAS WELL ORIGINALLY DRILLED ON AND/OR AFTER JUNE 5, 1929, FIVE COPIES OG - 1, SHOWING ORIGINAL PERMIT NUMBER, AND PERFORMANCE BOND.

Required forms must be filed within ninety (90) days of completion for bond release. Inspector to be notified twenty-four (24) hours in advance.

The following waiver must be completed by the coal operator if the permit is to be issued within ten days of receipt thereof.

WAIVER: I the undersigned, Agent for _____ Coal Company, Owner or Operator of the coal under this lease have examined and place on our mine maps this proposed well location.

We the _____ Coal Company have no objections to said well being drilled at this location, providing operator has complied with all rules and regulations in Articles 4, 5, and 7, Chapter 22 of the West Virginia Code.

 For Coal Company

 Official Title