

P

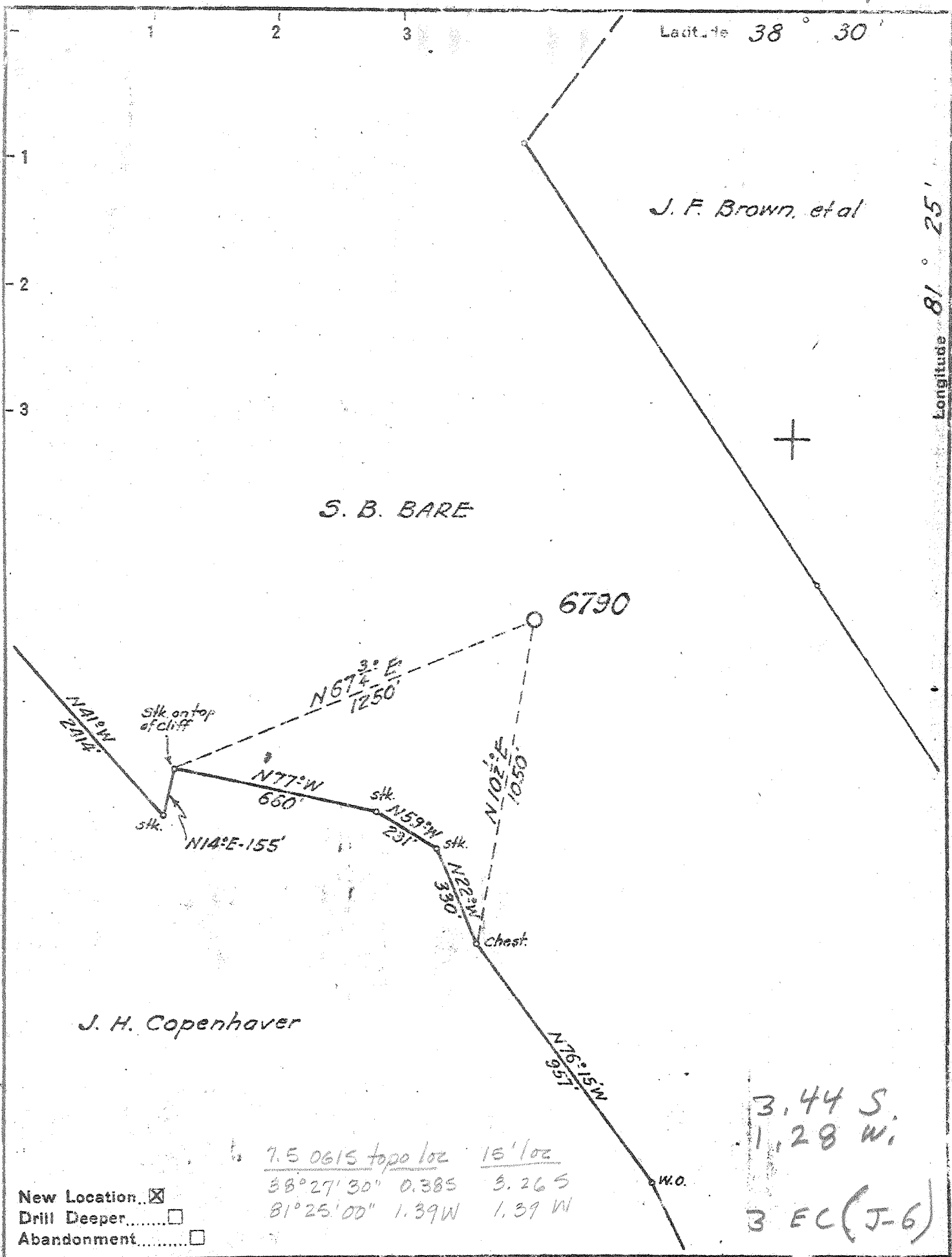

New Location...   
 Drill Deeper...   
 Abandonment...

7.5 0615 topo loc 15' loc  
 38° 27' 30" 0.385 3.26 S  
 81° 25' 00" 1.39 W 1.39 W

3.44 S  
 1.28 W  
 3 EC (J-6)

Company UNITED FUEL GAS CO.  
 Address CHARLESTON, W. VA.  
 Farm S. B. BARE  
 Tract \_\_\_\_\_ Acres 540 Lease No. 4849  
 Well (Farm) No. 19 Serial No. 6790  
 Elevation (Spirit Level) 787.19  
 Quadrangle CLENDENIN - NW  
 County KANAWHA District ELK  
 Engineer [Signature]  
 Engineer's Registration No. 662  
 File No. 72-65 Drawing No. \_\_\_\_\_  
 Date 5-24-51 Scale 1" = 400'

STATE OF WEST VIRGINIA  
 DEPARTMENT OF MINES  
 OIL AND GAS DIVISION  
 CHARLESTON

**WELL LOCATION MAP**  
 FILE NO. KAN-1558

+ Denotes location of well on United States Topographic Maps, scale 1 to 62,500, latitude and longitude lines being represented by border lines as shown.

- Denotes one inch spaces on border line of original tracing.

Deep Well

WEST VIRGINIA DEPARTMENT OF MINES  
OIL & GAS DIVISION  
W E L L R E C O R D

Permit No. Kan 1558  
Clendenin Quad.

Dry Hole  
Casing & tubing

Company	United Fuel Gas Company			
Address	P.O. Box 1273, Charleston, 25, W.Va.	13	150	150
Farm	S.B. Baro #19 Acres 540	10	1423	1423
Location	Elk River	8½	2157	2157
Well No.	6790 Elev. 787.19	70D	5166	5166
Date shot				
District	Elk Kanawha County			
Surface				
Mineral	Kanawha Valley Bank Trus. of J.H. Bannister Est., Charleston, W.Va.			
Commenced	7-19-51			
Completed	11-28-51			
Volume				

Clay	0	35
Lime	35	60
Slate	60	70
Sand	70	150
Slate	150	190
Sand	190	333
Coal	333	335
Slate	335	360
Sand	360	412
Slate	412	455
Sand	455	560
Slate & Shells	560	697
Sand	697	720
Slate & Shells	720	775
Gas Sand	775	820
Slate & Shells	820	935
Salt Sand	935	1408
Black Lime	1408	11418
Red Rock	1410	1421
Lime Shell	1421	1433
Red Rock	1433	1437
Slate & Shells	1437	1505
Maxon Sand	1505	1525
Slate	1525	1540
Little Lime	1540	1568
Pencil Cave	1568	1580
Big Lime	1580	1735
Sand	1735	1764
Slate & Shells	1764	1864
Squaw Sand	1864	2149
Brown Shale	2149	2155
Berca Shell	2155	2163
Slate & Shells	2163	3900
Shale	3900	3930
Slate & Shells	3930	4675
Brown Shale	4675	5153
Corniferous Lime	5153	5253
Oriskany Sand	5253	5264
T.D.	5264	

Gas and water at 5228' 50/10 W 2"