

NOTE:  
Well Location Determined  
By Conventional Field Survey  
And GPS.  
Farm Map 48 50 72 - 63

(+) DENOTES LOCATION OF WELL ON UNITED STATES TOPOGRAPHIC MAPS (7 1/2")

FILE NO. \_\_\_\_\_  
DRAWING NO. 7221  
SCALE 1"=2000'  
MINIMUM DEGREE OF ACCURACY 1:200  
PROVEN SOURCE OF ELEVATION \_\_\_\_\_

I THE UNDERSIGNED, HEREBY CERTIFY THAT THIS PLAT IS CORRECT TO THE BEST OF MY KNOWLEDGE AND BELIEF AND SHOWS ALL THE INFORMATION REQUIRED BY LAW AND THE REGULATIONS ISSUED AND PRESCRIBED BY THE DEPARTMENT OF ENERGY.  
(SIGNED) [Signature]  
R.P.E. \_\_\_\_\_ L.L.S. 798

PLACE SEAL HERE

STATE OF WEST VIRGINIA  
DEPARTMENT OF ENERGY  
OIL AND GAS DIVISION



DATE April 18, 2001  
OPERATOR'S WELL NO. 7221  
API WELL NO. \_\_\_\_\_

WELL TYPE: OIL \_\_\_ GAS X LIQUID INJECTION \_\_\_ WASTE DISPOSAL \_\_\_  
(IF "GAS," ) PRODUCTION \_\_\_ STORAGE X DEEP \_\_\_ SHALLOW \_\_\_  
LOCATION: ELEVATION 1159 WATER SHED Blue Creek

DISTRICT Elk COUNTY Kanawha  
QUADRANGLE Blue Creek, WV COORDINATES LAT: 38° 25' 00" LONG: 81° 24' 18"

SURFACE OWNER Patty E. Hutchinson, Et Al. ACREAGE 84.1  
ORIGINAL OIL & GAS ROYALTY OWNER Robert H. Teter, Et Al LEASE ACREAGE 85  
COAL OWNER Patty E. Hutchinson, Et Al. LEASE NO. 26320

PROPOSED WORK: DRILL \_\_\_ CONVERT \_\_\_ DRILL DEEPER \_\_\_ REDRILL \_\_\_ FRACTURE OR STIMULATE \_\_\_ PLUG OFF OLD FORMATION \_\_\_ PERFORATE NEW FORMATION \_\_\_ OTHER PHYSICAL CHANGE IN WELL (SPECIFY) STORAGE RECONDITION

PLUG AND ABANDON \_\_\_ CLEAN OUT AND REPLUG \_\_\_  
TARGET FORMATION \_\_\_\_\_ ESTIMATED DEPTH \_\_\_\_\_  
WELL OPERATOR COLUMBIA GAS TRANS CORP DESIGNATED AGENT PAUL AMICK  
ADDRESS PO BOX 1273, CHARLESTON, WV ADDRESS PO BOX 1273, CHARLESTON, WV  
25325 - 1273 25325 - 1273

KANAWHA COUNTY NAME PERMIT 1580 F

AUG 31 2001

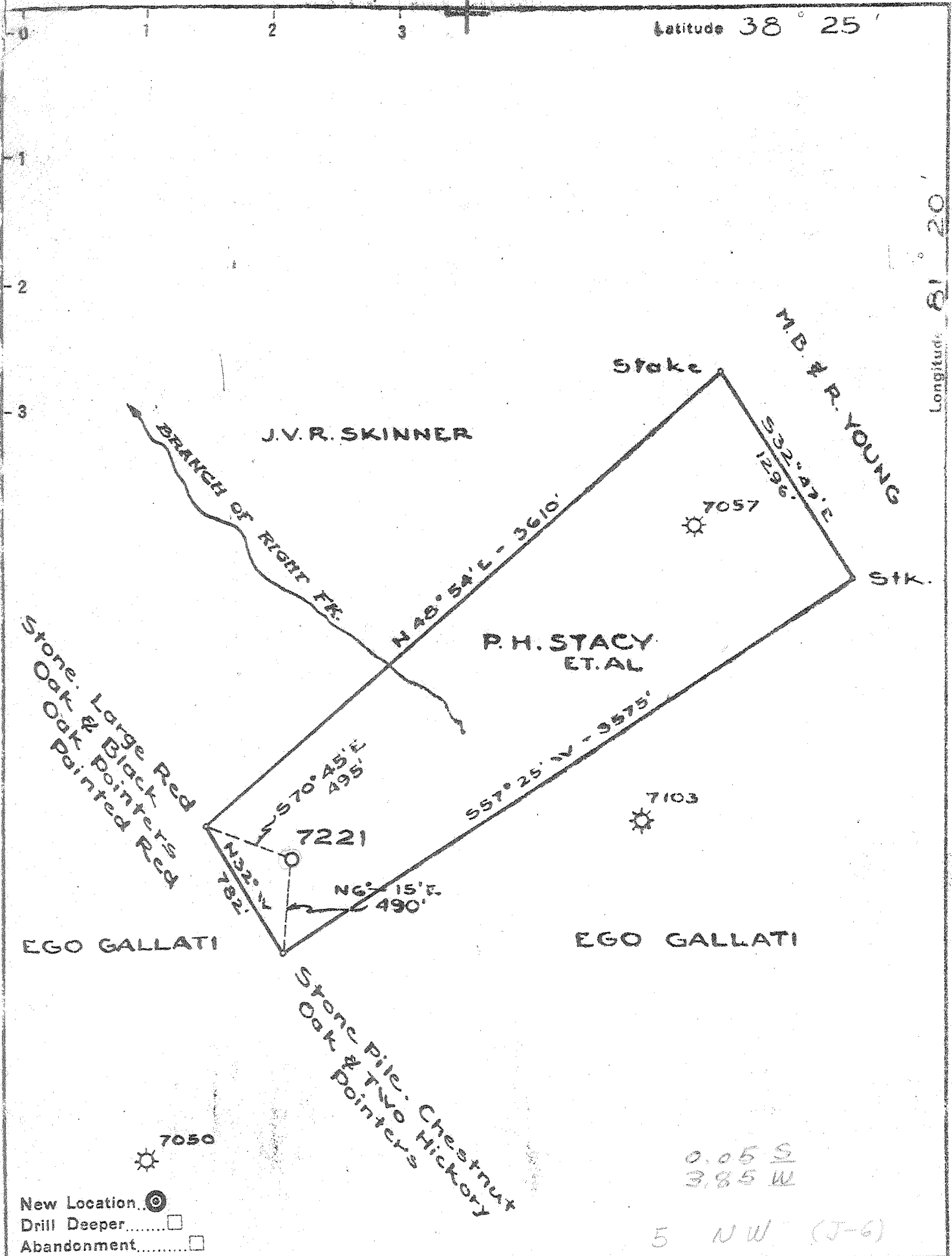

New Location    
 Drill Deeper    
 Abandonment

Company UNITED FUEL GAS  
 Address CHARLESTON, W.VA.  
 Farm P.H. STACY ET AL.  
 Tract \_\_\_\_\_ Acres 85 Lease No. 26320  
 Well (Farm) No. 2 Serial No. X-52A 7221-  
 Elevation (Spirit Level) 1159.20  
 Quadrangle CLENDENIN - C  
 County KANAWHA District ELK  
 Engineer Seymour R. Farrell  
 Engineer's Registration No. 2529  
 File No. 74-63 Drawing No. \_\_\_\_\_  
 Date FEB. 11 - 52 Scale 1" = 660'

STATE OF WEST VIRGINIA  
 DEPARTMENT OF MINES  
 OIL AND GAS DIVISION  
 CHARLESTON

WELL LOCATION MAP  
 FILE NO. KAN - 1580

+ Denotes location of well on United States Topographic Maps, scale 1 to 62,500, latitude and longitude lines being represented by border lines as shown.

- Denotes one inch spaces on border (line of original tracing).

9-0 315  
 Deep Well

Big Lime 1700 - 1885

Corniferous Lime 5353 - 5470

Oriskany 5470 - 5511

TD 5511'

Vol. 1,525,000 cuft. in Orisk.

Comp. Aug. 15, 1952



SECTION 1700 - 1885  
 SECTION 5353 - 5470  
 SECTION 5470 - 5511

SECTION 5511 - 5511'

SECTION 1,525,000 cuft. in Orisk.

Comp. Aug. 15, 1952

SECTION 1700 - 1885  
 SECTION 5353 - 5470  
 SECTION 5470 - 5511  
 SECTION 5511 - 5511'

STATE OF WEST VIRGINIA  
DEPARTMENT OF MINES  
OIL AND GAS DIVISION

*6 Lewisburg*

WELL RECORD

Permit No. KAN-1580

Oil or Gas Well GAS  
(KIND)

Company UNITED FUEL GAS COMPANY  
Address P.O. box 1273, Charleston 25, W. Va.  
Farm P. H. Stacy, et al Acres 85  
Location (waters) Rt. Ft. of Upper 3 Mile  
Well No. 7221 Elev. 1159.20  
District Elk County Kanawha  
The surface of tract is owned in fee by \_\_\_\_\_  
Address \_\_\_\_\_  
Mineral rights are owned by P. H. Stacy  
Box 746 Address Lewisburg, W. Va.  
Drilling commenced 2-28-52  
Drilling completed 8-15-52  
Water Stratafrac Treatment From \_\_\_\_\_ To \_\_\_\_\_  
With \_\_\_\_\_  
Open Flow 6 /10ths Water in \_\_\_\_\_ Inch  
4 /10ths Merc. in \_\_\_\_\_ Inch  
Volume 1,525,000 Cu. Ft.  
Rock Pressure 1205 lbs. 48 hrs.  
Oil \_\_\_\_\_ bbls., 1st 24 hrs.  
Fresh water \_\_\_\_\_ feet  
Salt water \_\_\_\_\_ feet

Casing and Tubing	Used in Drilling	Left in Well	Packers
Size			Kind of Packer
18			
18-3/8		31'	
10	Full	452'	Size of
8-5/8"		1735'	
6"			Depth set
5-7/8"		5387'	
3"			Perf. top
2"		5511'	Perf. bottom
Liners Used			Perf. top
			Perf. bottom

CASING CEMENTED \_\_\_\_\_ SIZE \_\_\_\_\_ No. Ft. \_\_\_\_\_ Date \_\_\_\_\_

COAL WAS ENCOUNTERED AT \_\_\_\_\_ FEET \_\_\_\_\_ INCHES  
\_\_\_\_\_ FEET \_\_\_\_\_ INCHES \_\_\_\_\_ FEET \_\_\_\_\_ INCHES  
\_\_\_\_\_ FEET \_\_\_\_\_ INCHES \_\_\_\_\_ FEET \_\_\_\_\_ INCHES

Formation	Color	Hard or Soft	Top	Bottom	Oil, Gas or Water	Depth Found	Remarks
Sand			0	50	Gas	1940'	88/10 W 2" 223 M
Blue Slate			50	60			
Yellow Clay			60	75	Gas	5483-5488'	14/10 Merc. 2" 1,032 M
Slate			75	85			
Sand			85	105	Test before stratafrac	5/10 W 7"	964 M
Black Slate			105	140	Stratafrac treatment	8-20-52	
Blue Slate			140	150	Test after stratafrac	9-23-52	6/10 Merc
Sand			150	275	4"	1,525 M	
Sandy Slate			275	280			
Slate			280	300			
Sand			300	355	FINAL OPEN FLOW -	1,525 M - Ori.skany	
Slate			355	375	48 Hr. R.P.	1205#	
Sand			375	435			
Slate			435	448			
Black Lime			448	460			
Sand			460	485			
Slate			485	510			
Sand			510	585			
Slate			585	725			
Sand			725	745			
Slate			745	775			
Sand			775	800			
Slate & Shells			800	1005			
Sand			1005	1540			
Red Rock			1540	1570			
Slate			1570	1585			
Red Rock			1585	1615			
Sand			1615	1660			
Little Lime			1660	1693			
Pencil Cave			1693	1700			
Big Lime			1700	1885			
Slate & Shells			1885	1930			
Sand			1930	2135			
Slate & Shells			2135	2463			
Red Rock			2463	2506			
Slate & Shells			2506	3485			
Brown Shale			3485	4385			
Slate			4385	4805			
Brown Shale			4805	5100			
White Slate			5100	5200			

*Handwritten initials and marks*

JAN 1953  
WEST VIRGINIA  
DEPARTMENT OF MINES  
1053722

(Over)

FEB 1 1953

P.H. STACY ET AL. NO. 7221 -

U.F.G. Co. -

KAN-1580

Formation	Color	Hard or Soft	Top	Bottom	Oil, Gas or Water	Depth Found	Remarks
Brown Shale			5238	5353			
- Corniferous Lime			5353	5470			
- Criskany Sand			5470	5511			
Total depth			5511'				
				5353	5470		
				1159	1159		
				4194	4311		

Date: January 9, 1953

APPROVED: UNITED FUEL GAS COMPANY, Owner

By: *L.R. Ferrell*  
(Title)