

**BENCH MARK**  
 U.S.G.S. BRONZE TABLET IN CONCRETE  
 MONUMENT STAMPED TT-22 68 1953  
 NEAR MOUTH OF UTAH HOLLOW ALONG  
 WEST VIRGINIA SECONDARY ROUTE  
 NO. 31 ELEV. 616.00'

**DEGREE OF ACCURACY**  
 ONE PART IN 200.

Fracture	<input type="checkbox"/>
Before 6/5/29	<input type="checkbox"/>
New Location	<input checked="" type="checkbox"/>
Drill Deeper	<input type="checkbox"/>
Redrill	<input type="checkbox"/>
Abandonment	<input type="checkbox"/>

I, the undersigned, hereby certify that this map is correct to the best of my knowledge and belief and shows all the information required by Paragraph 5 of the Rules and Regulations of the Oil and Gas Section of the Mining Laws of West Virginia.

The accuracy of this survey is within the limits and as prescribed in paragraph 5 by the Oil and Gas Division of the Department of Mines Regulations.

PROVEN ELEVATION 616.00'

Company UNITED FUEL GAS CO.  
 Address CHARLESTON W.VA.  
 Farm JOHN H. RANSON, ET AL.  
 Tract \_\_\_\_\_ Acres 302 Lease No. 47677  
 Well (Farm) No. \_\_\_\_\_ Series No. 9452  
 Elevation (Spirit Level) 676.51'  
 Quadrangle CHARLESTON NW  
 County KANAWHA District UNION  
 Engineer O. J. Spinks  
 Engineer's Registration No. 2712  
 File No. 53-67 Drawing No. \_\_\_\_\_  
 Date OCT 4, 1967 Scale 1" = 400'

STATE OF WEST VIRGINIA  
 DEPARTMENT OF MINES  
 OIL AND GAS DIVISION  
 CHARLESTON

**WELL LOCATION MAP**  
 FILE NO. KAN-2179

+ Denotes location of well on United States Topographic Maps, scale 1 to 62,500' lat. reads and longitude lines being represented by border lines as shown.

- Denotes one inch spaces on border line of original tracing.

*Deep Well (Newburg)*

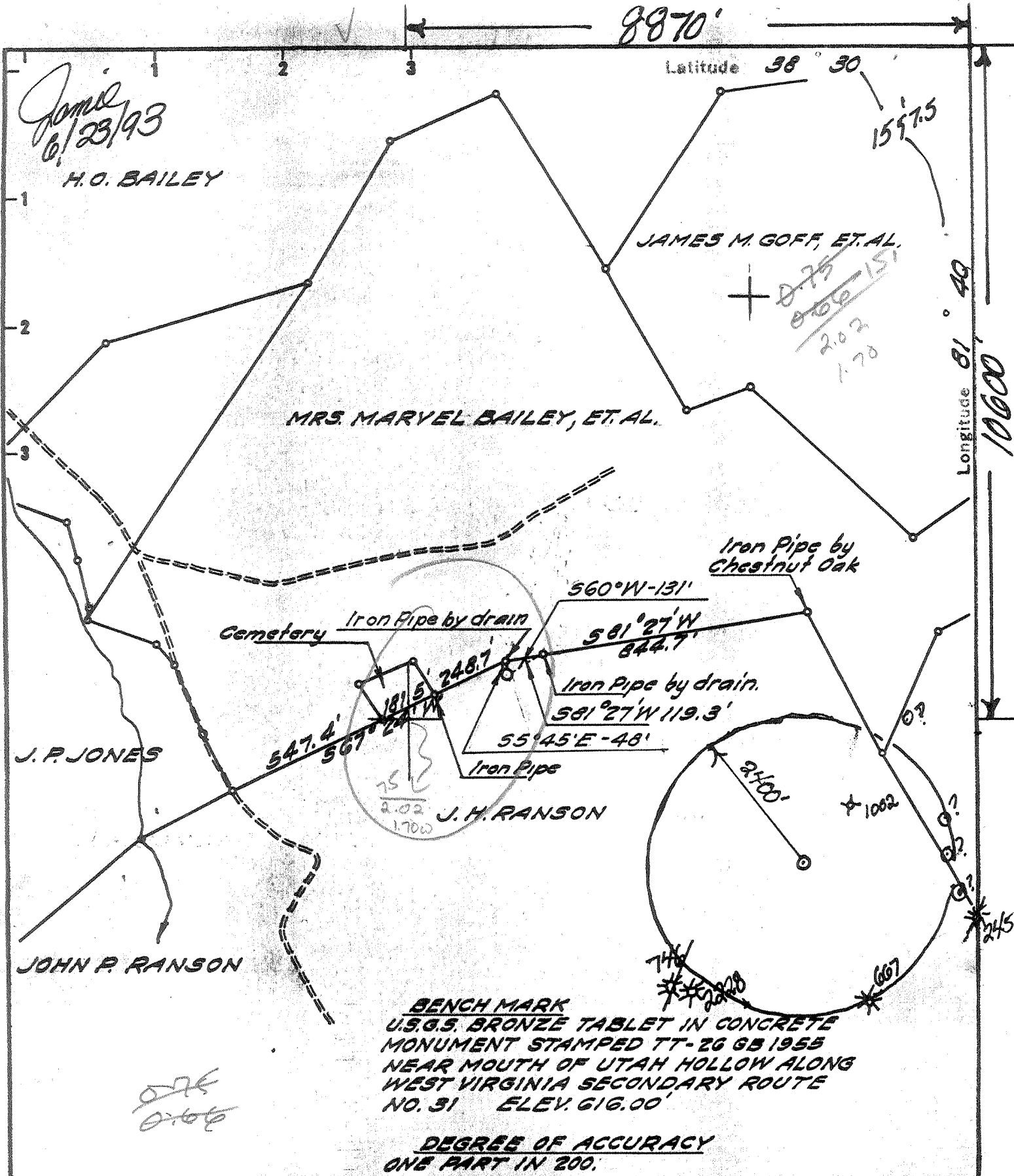

**BENCH MARK**  
 U.S.G.S. BRONZE TABLET IN CONCRETE  
 MONUMENT STAMPED TT-26 GB 1955  
 NEAR MOUTH OF UTAH HOLLOW ALONG  
 WEST VIRGINIA SECONDARY ROUTE  
 NO. 31 ELEV. 616.00'

**DEGREE OF ACCURACY**  
 ONE PART IN 200.

Fracture Before 6/5/29   
 New Location   
 Drill Deeper   
 Redrill   
 Abandonment

I, the undersigned, hereby certify that this map is correct to the best of my knowledge and belief and shows all the information required by Paragraph 5 of the Rules and Regulations of the Oil and Gas Section of the Mining Laws of West Virginia.  
 The accuracy of this survey is within the limits and as prescribed in paragraph 5 by the Oil and Gas Division of the Department of Mines Regulations.  
**PROVEN ELEVATION 616.00'**

Company Viking Energy, Inc. 25360 1095  
 Address P.O. Box 13366, Sissonville, W.V.  
 Farm JOHN H. RANSON, ET AL.  
 Tract \_\_\_\_\_ Acres 302 Lease No. 47677  
 Well (Farm) No. \_\_\_\_\_ Serial No. 9452  
 Elevation (Spirit Level) 676.51'  
 Quadrangle CHARLESTON 15/Pocataloo 7.5  
 County KANAWHA District UNION 9  
 Engineer O.J. Spitzer  
 Engineer's Registration No. 2712  
 File No. 58-67 Drawing No. \_\_\_\_\_  
 Date OCT. 4, 1967 Scale 1" = 400'

STATE OF WEST VIRGINIA  
 Division of Environmental Protection  
 Office of Oil & Gas  
 Nitro  
**WELL LOCATION MAP**  
API Well No. 47-039-02179-7

+ Denotes location of well on United States Topographic Maps, scale 1 to 62,500 latitude and longitude lines being represented by border lines as shown.  
 - Denotes one inch spaces on border line of original tracing.

EVL.



STATE OF WEST VIRGINIA  
DEPARTMENT OF MINES  
OIL AND GAS DIVISION

Rotary   
Spudder   
Cable Tools   
Storage

WELL RECORD

Oil or Gas Well Gas  
(KIND)

Quadrangle Charleston

Permit No. KAN-2179

Company <u>United Fuel Gas Company</u>	Casing and Tubing	Used in Drilling	Left in Well	Packers
Address <u>P.O. Box 1273 Charleston, W. Va. 25325</u>				
Farm <u>John H. Ranson, et al</u> Acres <u>302 Merger</u>	Size			
Location (waters) <u>Martin Branch</u>	16			Kind of Packer
Well No. <u>9452</u> Elev. <u>676.51'</u>	13 <u>3/8</u>			<u>63' Cemented from 63'</u>
District <u>Union</u> County <u>Kanawha</u>	10			to surf.
The surface of tract is owned in fee by	<u>9 5/8"</u>	<u>1777' Cemented from</u>		Size of
Address	<u>7 3/8"</u>	<u>5435' Cemented from</u>		Depth set
Mineral rights are owned by <u>John H. Ranson, et al</u>	<u>5 3/16</u>	<u>5440-4500.</u>		
<u>Route 5</u> Address <u>Charleston, W. Va.</u>	<u>4 1/2</u>			
Drilling commenced <u>Oct. 28, 1967</u>	<u>3</u>			Perf. top
Drilling completed <u>Nov. 4, 1967</u>	<u>2 3/8"</u>		<u>5470'</u>	Perf. bottom
Date Shot From To	Liners Used			Perf. top
With				Perf. bottom

Open Flow /10ths Water in Inch

Volume 63,500,000 - Newburg Cu. Ft.

Rock Pressure 2099.8 DW lbs. hrs.

Oil bbls., 1st 24 hrs.

WELL ACIDIZED (DETAILS)

WELL FRACTURED (DETAILS)

RESULT AFTER TREATMENT (Initial open Flow or bbls.)

ROCK PRESSURE AFTER TREATMENT HOURS

Fresh Water Feet Salt Water Feet

Producing Sand Depth

Formation	Color	Hard or Soft	Top	Bottom	Oil, Gas or Water	Depth	Remarks
Sand - Shale			0	100			
Shale & Red Rock			100	720	Show gas in Big Line		
Sand & Shale			720	1040			
Shale			1040	1340	Gas in Oriskany - 400 M		
Sand & Shale			1340	1495			
Big Lime			1495	1663	Gas 5491' 15,100 M		
Injun Sand			1663	1733			
Shell & Shale			1733	2800			
Shale			2800	4640			
Corniferous Lime			4640	4728	Test before fracture - 15,100		
Oriskany Sand			4728	4762	Fractured Newburg 11-13-67 with 30,000		
Dolomite & Sand			4762	5474	20-40 sand, 1,000 gallons acid, 837		
Newburg			5474	5491	bbls. water.		
Total Depth			5491'		Test after fracture - Back Pressure		
					Test 63,500 M		
					LOGS RUN:		
					Gamma Ray		
					Compensated Density		

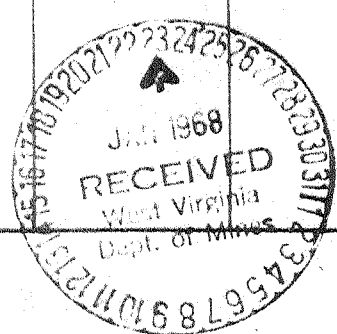

JAN 29 1968

039-2179-F  
 Issued 07/2/93  
 Page of  
 Expires 07/02/95

STATE OF WEST VIRGINIA  
 DEPARTMENT OF ENERGY, DIVISION OF OIL AND GAS  
 WELL WORK PERMIT APPLICATION

- 1) Well Operator: Viking Energy Inc. 51440 (9)
- 2) Operator's Well Number: J. Ranson #1 WV9452 3) Elevation: 676.51'
- 4) Well type: (a) Oil  / or Gas  /  
 (b) If Gas: Production  / Underground Storage  /  
 Deep  / Shallow  *475*
- 5) Proposed Target Formation(s): Oriskany Sand
- 6) Proposed Total Depth: 4762 feet
- 7) Approximate fresh water strata depths: \_\_\_\_\_
- 8) Approximate salt water depths: NA
- 9) Approximate coal seam depths: \_\_\_\_\_
- 10) Does land contain coal seams tributary to active mine? Yes  / No  /
- 11) Proposed Well Work: Perforate and Fracture Oriskany Sand
- 12) Set Temporary Plug. No Casing Remove Plug Run two strings  
tubing produce such CASING AND TUBING PROGRAM zone separately

TYPE	SPECIFICATIONS		FOOTAGE INTERVALS		CEMENT
	Size	Grade	Weight per ft.	For drilling	
Conductor	13 3/8			63'	Left in well: 63' Fill-up (cu. ft.): cemented to surface
Fresh Water	9 5/8			1777'	Left in well: 1777' Fill-up (cu. ft.): cemented to surface
Coal					
Intermediate	7			5435'	Left in well: 5435' Fill-up (cu. ft.): cemented from 5440' to 450'
Production	2 3/8			5470'	
Tubing					
Liners					

PACKERS : Kind \_\_\_\_\_  
 Sizes \_\_\_\_\_  
 Depths set \_\_\_\_\_

For Division of Oil and Gas Use Only

Fee(s) paid:  Well Work Permit  Reclamation Fund  WPCP  
 Plat  WW-9  WW-2B  Bond CD Blanket Agent  
 (Type)

17403

3507

- 1) Date: March 16, 1993
- 2) Operator's well number  
J. Ranson #1 WV9452
- 3) API Well No: 47 - 39 - 2179-PP-FRAC  
State - County - Permit

**STATE OF WEST VIRGINIA  
DIVISION OF ENVIRONMENTAL PROTECTION, OFFICE OF OIL AND GAS**

**NOTICE AND APPLICATION FOR A WELL WORK PERMIT**

- |  |  |
|--|--|
| <p>4) Surface Owner(s) to be served:</p> <p>(a) Name <u>G. F. Carpenter</u><br/>Address <u>Rt 4 Box 354</u><br/><u>Charleston, WV. 25312</u></p> <p>(b) Name _____<br/>Address _____</p> <p>(c) Name _____<br/>Address _____</p> | <p>5) (a) Coal Operator:</p> <p>Name _____<br/>Address _____</p> <p>(b) Coal Owner(s) with Declaration</p> <p>Name <u>None</u><br/>Address _____</p> <p>Name _____<br/>Address _____</p> |
| <p>6) Inspector <u>Carlos Hively</u><br/>Address <u>223 Pinch Ridge Road</u><br/><u>Elk View, WV 25071</u><br/>Telephone (304)-<u>965-6069</u></p>   | <p>(c) Coal Lessee with Declaration</p> <p>Name _____<br/>Address _____</p>  |

**TO THE PERSON(S) NAMED ABOVE TAKE NOTICE THAT:**

\_\_\_\_\_ Included is the lease or leases or other continuing contract or contracts by which I hold the right to extract oil and gas OR  
 Included is the information required by Chapter 22B, Article 1, Section 8(d) of the Code of West Virginia (see page 2)

I certify that as required under Chapter 22B of the West Virginia Code I have served copies of this notice and application, a location plat, and accompanying documents pages 1 through \_\_\_\_\_ on the above named parties, by:

\_\_\_\_\_ Personal Service (Affidavit attached)  
 Certified Mail (Postmarked postal receipt attached)  
 \_\_\_\_\_ Publication (Notice of Publication attached)

I have read and understand Chapter 22B and 38 CSR 11-18, and I agree to the terms and conditions of any permit issued under this application.  
 I certify under penalty of law that I have personally examined and am familiar with the information submitted on this application form and all attachments, and that based on my inquiry of those individuals immediately responsible for obtaining the information, I believe that the information is true, accurate, and complete.  
 I am aware that there are significant penalties for submitting false information, including the possibility of fine and imprisonment.

Well Operator Viking Energy Inc.  
 By: Michael Pinkerton  
 Its: \_\_\_\_\_ Designated Agent  
 Address \_\_\_\_\_ P. O. Box 13366  
 \_\_\_\_\_ Sissonville, WV. 25360  
 Telephone \_\_\_\_\_ 304-984-3389

Subscribed and sworn before me this 16 day of March, 1993

My commission expires \_\_\_\_\_

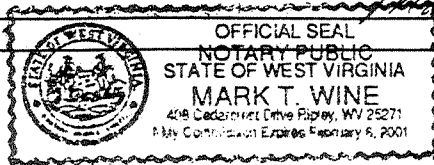

Mark T. Wine Notary Public